

ASBESTECH
6825 Fair Oaks Blvd., Suite 103
Carmichael, California 95608
Tel.(916) 481-8902 Fax (916) 481-3975

Client:

Entek Consulting Group, Inc.
4200 Rocklin Rd., Suite 7
Rocklin, CA 95677

Job:

06-133 Chico USD
Community Day School
Chico, CA

BULK ASBESTOS ANALYSIS REPORT

LAB JOB # 48139-7

Date/Time Collected: 3/29/06

Date Received: 3/30/06

NVLAP # 101442

DOHS # 1153

Date Analyzed: 4/3/06

<u>Sample No.</u>	<u>Color/Description</u>	<u>% Type Asbestos</u>	<u>Other Materials</u>
ECG-06-133-12A	Brown base cove mastic, bldg. A 114-electrical room south wall center area lower part of wall	<1 FIBROUS TREMOLITE	Synthetics Talc
	White joint compound	<1 CHRYSOTILE	Granular Mins.
13A	Beige 12" vinyl floor tile, bldg. A 300-mechanical room (mezzanine) east area of floor	<1 CHRYSOTILE	Granular Mins.
14A	Beige 12" vinyl floor tile, bldg. A 300-mechanical room (mezzanine) east area of floor	NONE DETECTED	Calcite
15A	Yellow carpet glue, bldg. A 123-classroom north area of floor near north doorway	NONE DETECTED	Granular Mins. Synthetics
16A	Gray/white 2'X4' lay-in ceiling panel (new), bldg. A 123 classroom south area center area	NONE DETECTED	Cellulose Fibrous Glass
17A	Mottled beige linoleum sheeting, bldg. A 127-storage room SE area of floor	NONE DETECTED	Vinyl Cellulose
	Gray leveling compound	NONE DETECTED	Granular Mins.

THE ANALYSIS USES POLARIZED LIGHT MICROSCOPY AND DISPERSION STAINING FOLLOWING E.P.A. METHOD 600/R-93/116. NON-FRIABLE MATERIALS WERE ANALYZED APPLYING THE SAME METHOD. THE LOWER DETECTION LIMIT IS <1 % WITH THE PROVISIO THAT PLM MAY NOT DETECT FIBERS <0.25 MICRONS IN DIAMETER THAT MAY BE PRESENT IN SAMPLES SUCH AS FLOOR TILES. IN ACCORDANCE WITH TITLE 22, CCR, SECTION 66261.24(a)(2)(A), THE MCL IS 1 %. SAMPLES WERE NOT COLLECTED BY ASBESTECH. THIS REPORT MUST NOT BE REPRODUCED EXCEPT IN FULL WITHOUT THE APPROVAL OF ASBESTECH. THIS REPORT RELATES ONLY TO THE ITEMS TESTED. THIS REPORT MUST NOT BE USED TO CLAIM PRODUCT ENDORSEMENT BY N.V.L.A.P. OR ANY AGENCY OF THE U.S. GOVERNMENT. ASBESTECH ACCEPTS TECHNICAL RESPONSIBILITY FOR THIS REPORT AND DATE OF ISSUE.

NVLAP

ANALYST SIGNATURE: _____

John J. J. J.

ASBESTECH
6825 Fair Oaks Blvd., Suite 103
Carmichael, California 95608
Tel.(916) 481-8902 Fax (916) 481-3975

Client:

Entek Consulting Group, Inc.
4200 Rocklin Rd., Suite 7
Rocklin, CA 95677

Job:

06-133 Chico USD
Community Day School
Chico, CA

BULK ASBESTOS ANALYSIS REPORT

LAB JOB # 48139-8

Date/Time Collected: 3/29/06

Date Received: 3/30/06

NVLAP # 101442

DOHS # 1153

Date Analyzed: 4/3/06

<u>Sample No.</u>	<u>Color/Description</u>	<u>% Type Asbestos</u>	<u>Other Materials</u>
ECG-06-133-18A	White drywall, bldg. B 201-office north wall near NW corner lower part of wall	NONE DETECTED	Gypsum Fibrous Glass
	White joint compound (B)	NONE DETECTED	Calcite
18B	White drywall, bldg. B 201-conference room NW corner lower part of wall	NONE DETECTED	Gypsum Fibrous Glass
	White joint compound (B)	NONE DETECTED	Calcite
18C	White joint compound (B), bldg. B 206-day room west wall SW corner south of sink cabinetry lower part of wall	NONE DETECTED	Calcite
	White caulk	NONE DETECTED	Calcite
18D	White drywall, bldg. B 205-hall NW corner lower part of wall	NONE DETECTED	Gypsum Fibrous Glass
	White joint compound (B)	NONE DETECTED	Calcite
18E	White drywall, bldg. B 208-classroom SW corner lower part of wall	NONE DETECTED	Gypsum Fibrous Glass
	White joint compound (B)	NONE DETECTED	Calcite

THE ANALYSIS USES POLARIZED LIGHT MICROSCOPY AND DISPERSION STAINING FOLLOWING E.P.A. METHOD 600/R-93/116. NON-FRIABLE MATERIALS WERE ANALYZED APPLYING THE SAME METHOD. THE LOWER DETECTION LIMIT IS <1 % WITH THE PROVISIO THAT PLM MAY NOT DETECT FIBERS <0.25 MICRONS IN DIAMETER THAT MAY BE PRESENT IN SAMPLES SUCH AS FLOOR TILES. IN ACCORDANCE WITH TITLE 22, CCR, SECTION 66261.24(a)(2)(A), THE MCL IS 1 %. SAMPLES WERE NOT COLLECTED BY ASBESTECH. THIS REPORT MUST NOT BE REPRODUCED EXCEPT IN FULL WITHOUT THE APPROVAL OF ASBESTECH. THIS REPORT RELATES ONLY TO THE ITEMS TESTED. THIS REPORT MUST NOT BE USED TO CLAIM PRODUCT ENDORSEMENT BY N.V.L.A.P. OR ANY AGENCY OF THE U.S. GOVERNMENT. ASBESTECH ACCEPTS TECHNICAL RESPONSIBILITY FOR THIS REPORT AND DATE OF ISSUE.

NVLAP

ANALYST SIGNATURE: _____

[Handwritten Signature]

ASBESTECH
6825 Fair Oaks Blvd., Suite 103
Carmichael, California 95608
Tel.(916) 481-8902 Fax (916) 481-3975

Client:

Entek Consulting Group, Inc.
4200 Rocklin Rd., Suite 7
Rocklin, CA 95677

Job:

06-133 Chico USD
Community Day School
Chico, CA

BULK ASBESTOS ANALYSIS REPORT

LAB JOB # 48139-9
Date/Time Collected: 3/29/06
Date Received: 3/30/06

NVLAP # 101442
DOHS # 1153
Date Analyzed: 4/3/06

<u>Sample No.</u>	<u>Color/Description</u>	<u>% Type Asbestos</u>	<u>Other Materials</u>
ECG-06-133-18F	White drywall, bldg. B 211-classroom SE corner lower part of wall	NONE DETECTED	Gypsum Fibrous Glass
	White joint compound (B)	NONE DETECTED	Calcite
18G	White drywall, bldg. B 210-classroom NE corner lower part of wall	NONE DETECTED	Gypsum Fibrous Glass
	White joint compound (B)	NONE DETECTED	Calcite
19A	White knockdown texture coat (B), bldg. B 200-classroom south wall center area lower part of wall	NONE DETECTED	Calcite
19B	White knockdown texture coat (B), bldg. B 206-day room east wall center area lower part of wall	NONE DETECTED	Calcite
19C	White knockdown texture coat (B), bldg. B 205-hall west wall north side of 204-toilet doorway lower part of wall	NONE DETECTED	Calcite
19D	White knockdown texture coat (B), bldg. B 200-classroom east wall north side of 203A-toilet hallway lower part of wall	NONE DETECTED	Calcite

THE ANALYSIS USES POLARIZED LIGHT MICROSCOPY AND DISPERSION STAINING FOLLOWING E.P.A. METHOD 600/R-93/116. NON-FRIABLE MATERIALS WERE ANALYZED APPLYING THE SAME METHOD. THE LOWER DETECTION LIMIT IS <1 % WITH THE PROVISIO THAT PLM MAY NOT DETECT FIBERS <0.25 MICRONS IN DIAMETER THAT MAY BE PRESENT IN SAMPLES SUCH AS FLOOR TILES. IN ACCORDANCE WITH TITLE 22, CCR, SECTION 66261.24(a)(2)(A), THE MCL IS 1 %. SAMPLES WERE NOT COLLECTED BY ASBESTECH. THIS REPORT MUST NOT BE REPRODUCED EXCEPT IN FULL WITHOUT THE APPROVAL OF ASBESTECH. THIS REPORT RELATES ONLY TO THE ITEMS TESTED. THIS REPORT MUST NOT BE USED TO CLAIM PRODUCT ENDORSEMENT BY N.V.L.A.P. OR ANY AGENCY OF THE U.S. GOVERNMENT. ASBESTECH ACCEPTS TECHNICAL RESPONSIBILITY FOR THIS REPORT AND DATE OF ISSUE.

NVLAP

ANALYST SIGNATURE: _____

James J. J. J.

ASBESTECH
6825 Fair Oaks Blvd., Suite 103
Carmichael, California 95608
Tel.(916) 481-8902 Fax (916) 481-3975

Client:

Entek Consulting Group, Inc.
4200 Rocklin Rd., Suite 7
Rocklin, CA 95677

Job:

06-133 Chico USD
Community Day School
Chico, CA

BULK ASBESTOS ANALYSIS REPORT

LAB JOB # 48139-10

Date/Time Collected: 3/29/06

Date Received: 3/30/06

NVLAP # 101442

DOHS # 1153

Date Analyzed: 4/3/06

<u>Sample No.</u>	<u>Color/Description</u>	<u>% Type Asbestos</u>	<u>Other Materials</u>
ECG-06-133-19E	White knockdown texture coat (B), bldg. B 208-classroom west wall south side of north doorway lower part of wall	NONE DETECTED	Calcite
19F	White knockdown texture coat (B), bldg. B 209-special ed/conference south wall center area lower part of wall	NONE DETECTED	Calcite
19G	White knockdown texture coat (B), bldg. B 211-classroom north wall east area lower part of wall	NONE DETECTED	Calcite
19H	White knockdown texture coat (B), bldg. B 210-classroom west wall center area lower part of wall	NONE DETECTED	Calcite
19I	White knockdown texture coat (B), bldg. B 210-classroom east wall south area lower part of wall	NONE DETECTED	Calcite
20A	Gray/white 2'X4' lay-in ceiling panel (B), bldg. B 211-classroom south area of ceiling near south wall	NONE DETECTED	Cellulose Fibrous Glass
20B	Gray/white 2'X4' lay-in ceiling panel (B), bldg. B 205-hall NW area of ceiling	NONE DETECTED	Cellulose Fibrous Glass

THE ANALYSIS USES POLARIZED LIGHT MICROSCOPY AND DISPERSION STAINING FOLLOWING E.P.A. METHOD 600/R-93/116. NON-FRIABLE MATERIALS WERE ANALYZED APPLYING THE SAME METHOD. THE LOWER DETECTION LIMIT IS <1 % WITH THE PROVISIO THAT PLM MAY NOT DETECT FIBERS <0.25 MICRONS IN DIAMETER THAT MAY BE PRESENT IN SAMPLES SUCH AS FLOOR TILES. IN ACCORDANCE WITH TITLE 22, CCR, SECTION 66261.24(a)(2)(A), THE MCL IS 1 %. SAMPLES WERE NOT COLLECTED BY ASBESTECH. THIS REPORT MUST NOT BE REPRODUCED EXCEPT IN FULL WITHOUT THE APPROVAL OF ASBESTECH. THIS REPORT RELATES ONLY TO THE ITEMS TESTED. THIS REPORT MUST NOT BE USED TO CLAIM PRODUCT ENDORSEMENT BY N.V.L.A.P. OR ANY AGENCY OF THE U.S. GOVERNMENT. ASBESTECH ACCEPTS TECHNICAL RESPONSIBILITY FOR THIS REPORT AND DATE OF ISSUE.

NVLAP

ANALYST SIGNATURE: _____

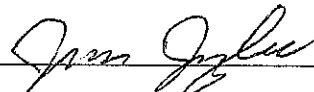

ASBESTECH
6825 Fair Oaks Blvd., Suite 103
Carmichael, California 95608
Tel.(916) 481-8902 Fax (916) 481-3975

Client:

Entek Consulting Group, Inc.
4200 Rocklin Rd., Suite 7
Rocklin, CA 95677

Job:

06-133 Chico USD
Community Day School
Chico, CA

BULK ASBESTOS ANALYSIS REPORT

LAB JOB # 48139-11

Date/Time Collected: 3/29/06

Date Received: 3/30/06

NVLAP # 101442

DOHS # 1153

Date Analyzed: 4/3/06

<u>Sample No.</u>	<u>Color/Description</u>	<u>% Type Asbestos</u>	<u>Other Materials</u>
ECG-06-133-21A	White base cove mastic (B), bldg. B 210-classroom NE corner lower part of wall	NONE DETECTED	Calcite
	White joint compound	NONE DETECTED	Calcite
21B	White base cove mastic (B), bldg. B 209-special ed/conference south wall center area lower part of wall	NONE DETECTED	Calcite
	White joint compound	NONE DETECTED	Calcite
22A	Green linoleum sheeting (B-leaf pattern), bldg. B 203B-toilet (north) east side of doorway threshold	NONE DETECTED	Vinyl Cellulose
	Yellow mastic	NONE DETECTED	Synthetics
23A	Yellow/white linoleum sheeting (B- remnant), bldg. B 206-day room SW corner under wall	NONE DETECTED	Vinyl Cellulose
	Yellow mastic	NONE DETECTED	Synthetics
24A	White floor leveling compound (B-white) bldg. B 200-classroom NE corner of room	NONE DETECTED	Granular Mins.

THE ANALYSIS USES POLARIZED LIGHT MICROSCOPY AND DISPERSION STAINING FOLLOWING E.P.A. METHOD 600/R-93/116. NON-FRIABLE MATERIALS WERE ANALYZED APPLYING THE SAME METHOD. THE LOWER DETECTION LIMIT IS <1 % WITH THE PROVISIO THAT PLM MAY NOT DETECT FIBERS <0.25 MICRONS IN DIAMETER THAT MAY BE PRESENT IN SAMPLES SUCH AS FLOOR TILES. IN ACCORDANCE WITH TITLE 22, CCR, SECTION 66261.24(a)(2)(A), THE MCL IS 1 %. SAMPLES WERE NOT COLLECTED BY ASBESTECH. THIS REPORT MUST NOT BE REPRODUCED EXCEPT IN FULL WITHOUT THE APPROVAL OF ASBESTECH. THIS REPORT RELATES ONLY TO THE ITEMS TESTED. THIS REPORT MUST NOT BE USED TO CLAIM PRODUCT ENDORSEMENT BY N.V.L.A.P. OR ANY AGENCY OF THE U.S. GOVERNMENT. ASBESTECH ACCEPTS TECHNICAL RESPONSIBILITY FOR THIS REPORT AND DATE OF ISSUE.

NVLAP

ANALYST SIGNATURE: _____

John J. J. J.

ASBESTECH
6825 Fair Oaks Blvd., Suite 103
Carmichael, California 95608
Tel.(916) 481-8902 Fax (916) 481-3975

Client:

Entek Consulting Group, Inc.
4200 Rocklin Rd., Suite 7
Rocklin, CA 95677

Job:

06-133 Chico USD
Community Day School
Chico, CA

BULK ASBESTOS ANALYSIS REPORT

LAB JOB # 48139-12

Date/Time Collected: 3/29/06

Date Received: 3/30/06

NVLAP # 101442

DOHS # 1153

Date Analyzed: 4/3/06

<u>Sample No.</u>	<u>Color/Description</u>	<u>% Type Asbestos</u>	<u>Other Materials</u>
ECG-06-133-25A	Yellow flooring adhesive (B-yellow), bldg. B 200-classroom NE corner of room	NONE DETECTED	Granular Mins. Synthetics
26A	Beige linoleum sheeting (B-beige with specks), bldg. B 205-hall SE corner of room under wall	NONE DETECTED	Vinyl Cellulose
	Yellow mastic	NONE DETECTED	Synthetics

THE ANALYSIS USES POLARIZED LIGHT MICROSCOPY AND DISPERSION STAINING FOLLOWING E.P.A. METHOD 600/R-93/116. NON-FRIABLE MATERIALS WERE ANALYZED APPLYING THE SAME METHOD. THE LOWER DETECTION LIMIT IS <1 % WITH THE PROVISIO THAT PLM MAY NOT DETECT FIBERS <0.25 MICRONS IN DIAMETER THAT MAY BE PRESENT IN SAMPLES SUCH AS FLOOR TILES. IN ACCORDANCE WITH TITLE 22, CCR, SECTION 66261.24(a)(2)(A), THE MCL IS 1 %. SAMPLES WERE NOT COLLECTED BY ASBESTECH. THIS REPORT MUST NOT BE REPRODUCED EXCEPT IN FULL WITHOUT THE APPROVAL OF ASBESTECH. THIS REPORT RELATES ONLY TO THE ITEMS TESTED. THIS REPORT MUST NOT BE USED TO CLAIM PRODUCT ENDORSEMENT BY N.V.L.A.P. OR ANY AGENCY OF THE U.S. GOVERNMENT. ASBESTECH ACCEPTS TECHNICAL RESPONSIBILITY FOR THIS REPORT AND DATE OF ISSUE.

NVLAP

ANALYST SIGNATURE: _____



48139

BULK ASBESTOS MATERIAL Analysis Request Form for Entek Consulting Group, Inc.

4200 ROCKLIN ROAD, STE. 7
 ROCKLIN, CA 95677
 (916) 632-6800
 FAX (916) 632-6812

JOB I.D.: 06-133 **CLIENT:** Chico Unified School District

COLLECTED BY: Richard A. Beall

DATE COLLECTED: 03/29/06

DATE SUBMITTED: 03/30/06

LAB SUBMITTED TO: Asbestech

SPECIAL INSTRUCTIONS: Need results by 1700 hrs. on Tuesday, April 4, 2006. Please fax results as soon as available. Please include copy of submittal sheets with final reports.

ANALYSIS REQUESTED: PLM with Dispersion Staining

TURNAROUND TIME: 72 Hours

JOB SITE: Community Day School
 2412 Cohasset Road
 Chico, CA 95926

SAMPLE #	MATERIAL DESCRIPTION/LOCATION
ECG-06-133-01A	Knockdown Texture Coat #1 (Old) - Building A, 100-Conference Room, West wall at northwest area of wall.
ECG-06-133-01B	Knockdown Texture Coat #1 (Old) - Building A, 104-SRO/Probation, South wall lower area near center of wall.
ECG-06-133-01C	Knockdown Texture Coat #1 (Old) - Building A, 105-Assembly, North wall, east area, lower part of wall.
ECG-06-133-01D	Knockdown Texture Coat #1 (Old) - Building A, 106-Classroom, East wall, south area, lower part of wall.
ECG-06-133-01E	Knockdown Texture Coat #1 (Old) - Building A, 112-SDC, East wall, south area, lower part of wall.
ECG-06-133-01F	Knockdown Texture Coat #1 (Old) - Building A, 124-Classroom, West wall, center area, lower part of wall.
ECG-06-133-01G	Knockdown Texture Coat #1 (Old) - Building A, 125-Classroom, East wall, center area of sink cabinet inset, lower part of wall.
ECG-06-133-02A	Drywall & Joint Compound #1 (Old) - Building A, 100-Conference Room, Southwest corner near door.
ECG-06-133-02B	Drywall & Joint Compound #1 (Old) - Building A, 106-Classroom, East wall, south area, lower part of wall.
ECG-06-133-02C	Drywall & Joint Compound #1 (Old) - Building A, 109-SDC, Northwest corner near double doors.
ECG-06-133-02D	Drywall & Joint Compound #1 (Old) - Building A, 112-SDC, East wall, near southeast corner, lower part of wall.
ECG-06-133-02E	Drywall & Joint Compound #1 (Old) - Building A, 122-Storage Room, South wall, near southeast corner, lower part of wall.

for 3-30-06 3

48139

BULK ASBESTOS MATERIAL Analysis Request Form for Entek Consulting Group, Inc.

4200 ROCKLIN ROAD, STE. 7
 ROCKLIN, CA 95677
 (916) 632-6800
 FAX (916) 632-6812

JOB I.D.: 06-133 **CLIENT:** Chico Unified School District

COLLECTED BY: Richard A. Beall

DATE COLLECTED: 03/29/06

DATE SUBMITTED: 03/30/06

LAB SUBMITTED TO: Asbestech

SPECIAL INSTRUCTIONS: Need results by 1700 hrs. on Tuesday, April 4, 2006. Please fax results as soon as available. Please include copy of submittal sheets with final reports.

ANALYSIS REQUESTED: PLM with Dispersion Staining

TURNAROUND TIME: 72 Hours

JOB SITE: Community Day School
 2412 Cohasset Road
 Chico, CA 95926

SAMPLE #	MATERIAL DESCRIPTION/LOCATION
ECG-06-133-02F	Drywall & Joint Compound #1 (Old) - Building A, 300 Mechanical Room (Mezzanine), East wall at ceiling level.
ECG-06-133-03A	Drywall & Joint Compound #2 (New) - Building A, 104-SRO/Probation, Southwest corner, lower part of wall.
ECG-06-133-03B	Drywall & Joint Compound #2 (New) - Building A, 108- Counselor Office, Southeast corner, lower part of wall.
ECG-06-133-04A	2' X 4' Lay-in Ceiling Panels - Building A, 102-Shelly Office, West area of ceiling near west wall.
ECG-06-133-04B	2' X 4' Lay-in Ceiling Panels - Building A, 106-Classroom, Southwest area of ceiling.
ECG-06-133-04C	2' X 4' Lay-in Ceiling Panels - Building A, 112-SDC, West area of ceiling.
ECG-06-133-05A	Knockdown Texture Coat #2 (New) - Building A, 100-Conference Room, East wall, center area, lower part of wall.
ECG-06-133-05B	Knockdown Texture Coat #2 (New) - Building A, 112-SDC, North wall, center area under wall opening, lower part of wall.
ECG-06-133-05C	Knockdown Texture Coat #2 (New) - Building A, 109-SDC, East wall, center area under wall opening, lower part of wall.
ECG-06-133-06A	Basecove Adhesive - Building A, 100-Conference Room, North wall, near northwest corner.
ECG-06-133-06B	Basecove Adhesive - Building A, 104-SRO/Probation, East wall, center area, lower part of wall.
ECG-06-133-06C	Basecove Adhesive - Building A, 106-Classroom, South wall, center area, lower part of wall.
ECG-06-133-07A	Skip Trowel Texture Coat - Building A, 101-Office, North wall, near northeast corner, lower part of wall.

RF 3-30-63

48139

BULK ASBESTOS MATERIAL Analysis Request Form for Entek Consulting Group, Inc.

4200 ROCKLIN ROAD, STE. 7
 ROCKLIN, CA 95677
 (916) 632-6800
 FAX (916) 632-6812

JOB I.D.: 06-133 **CLIENT:** Chico Unified School District

COLLECTED BY: Richard A. Beall

DATE COLLECTED: 03/29/06

DATE SUBMITTED: 03/30/06

LAB SUBMITTED TO: Asbestech

SPECIAL INSTRUCTIONS: Need results by 1700 hrs. on Tuesday, April 4, 2006. Please fax results as soon as available. Please include copy of submittal sheets with final reports.

ANALYSIS REQUESTED: PLM with Dispersion Staining

TURNAROUND TIME: 72 Hours

JOB SITE: Community Day School
 2412 Cohasset Road
 Chico, CA 95926

SAMPLE #	MATERIAL DESCRIPTION/LOCATION
ECG-06-133-07B	Skip Trowel Texture Coat - Building A, 122-Storage Room, South wall, center area, lower part of wall.
ECG-06-133-07C	Skip Trowel Texture Coat, Building A, 105-Assembly, South wall, center area, lower part of wall.
ECG-06-133-08A	Floor Leveling Compound (Gray) - Building A, 106-Classroom, Northeast area of floor, near north entry doorway.
ECG-06-133-09A	Flooring Adhesive (Yellow) - Building A, 106-Classroom, West area of floor, near west wall.
ECG-06-133-09B	Linoleum Sheeting (110-W) - Building A, 107-Hall (East), Center area of floor.
ECG-06-133-10A	Linoleum Sheeting (Mottled White) - Building A, 110-Women's Restroom, Southeast area of floor near east wall.
ECG-06-133-11A	Linoleum Sheeting (Gray w/Blue Specs) - Building A, 116-Storage Closet, East edge of floor, center of doorway entrance.
ECG-06-133-12A	Basecove Mastic (Brown) - Building A, 114-Electrical Room, South wall, center area, lower part of wall.
ECG-06-133-13A	12" Vinyl Floor Tile & Mastic (Yellow) - Building A, 300-Mechanical Room (Mezzanine), East area of floor.
ECG-06-133-14A	12" Vinyl Floor Tile & Adhesive (Yellow) - Building A, 300-Mechanical Room (Mezzanine), East area of floor.
ECG-06-133-15A	Carpet Glue (Yellow) - Building A, 123-Classroom, North area of floor, near north doorway.
ECG-06-133-16A	2' X 4' Lay-in Ceiling Panel (New) - Building A, 123-Classroom, South area, center area of
ECG-06-133-17A	Linoleum Sheeting (Mottled Beige) - Building A, 127-Storage Room, Southeast area of floor.
ECG-06-133-18A	Drywall & Joint Compound (B) - Building B, 201-Office, North wall, near northwest corner, lower part of wall.

48139

BULK ASBESTOS MATERIAL Analysis Request Form for Entek Consulting Group, Inc.

4200 ROCKLIN ROAD, STE. 7
 ROCKLIN, CA 95677
 (916) 632-6800
 FAX (916) 632-6812

JOB I.D.: 06-133 **CLIENT:** Chico Unified School District

COLLECTED BY: Richard A. Beall

DATE COLLECTED: 03/29/06

DATE SUBMITTED: 03/30/06

LAB SUBMITTED TO: Asbestech

SPECIAL INSTRUCTIONS: Need results by 1700 hrs. on Tuesday, April 4, 2006. Please fax results as soon as available. Please include copy of submittal sheets with final reports.

ANALYSIS REQUESTED: PLM with Dispersion Staining

TURNAROUND TIME: 72 Hours

JOB SITE: Community Day School
 2412 Cohasset Road
 Chico, CA 95926

SAMPLE #	MATERIAL DESCRIPTION/LOCATION
ECG-06-133-18B	Drywall & Joint Compound (B) - Building B, 201-Conference Room, Northwest corner, lower part of wall.
ECG-06-133-18C	Drywall & Joint Compound (B) - Building B, 206-Day Room, West wall, southwest corner, south of sink cabinetry, lower part of wall.
ECG-06-133-18D	Drywall & Joint Compound (B) - Building B, 205-Hall, Northwest corner, lower part of wall.
ECG-06-133-18E	Drywall & Joint Compound (B) - Building B, 208-Classroom, Southwest corner, lower part of wall.
ECG-06-133-18F	Drywall & Joint Compound (B) - Building B, 211-Classroom, Southeast corner, lower part of wall.
ECG-06-133-18G	Drywall & Joint Compound (B) - Building B, 210-Classroom, Northeast corner, lower part of wall.
ECG-06-133-19A	Knockdown Texture Coat (B) - Building B, 200-Classroom, South wall, center area, lower part of wall.
ECG-06-133-19B	Knockdown Texture Coat (B) - Building B, 206-Day Room, East wall, center area, lower part of wall.
ECG-06-133-19C	Knockdown Texture Coat (B) - Building B, 205-Hall, West wall, north side of 204-Toilet doorway, lower part of wall.
ECG-06-133-19D	Knockdown Texture Coat (B) - Building B, 200-Classroom, East wall, north side of 203A-Toilet Hallway, lower part of wall.
ECG-06-133-19E	Knockdown Texture Coat (B) - Building B, 208-Classroom, West wall, south side of north doorway, lower part of wall.
ECG-06-133-19F	Knockdown Texture Coat (B) - Building B, 209-Special Ed/Conference, South wall, center area, lower part of wall.
ECG-06-133-19G	Knockdown Texture Coat (B) - Building B, 211-Classroom, North wall, east area, lower part of wall.

48139

BULK ASBESTOS MATERIAL Analysis Request Form for Entek Consulting Group, Inc.

4200 ROCKLIN ROAD, STE. 7
 ROCKLIN, CA 95677
 (916) 632-6800
 FAX (916) 632-6812

JOB I.D.: 06-133 **CLIENT:** Chico Unified School District

COLLECTED BY: Richard A. Beall

DATE COLLECTED: 03/29/06

DATE SUBMITTED: 03/30/06

LAB SUBMITTED TO: Asbestech

SPECIAL INSTRUCTIONS: Need results by 1700 hrs. on Tuesday, April 4, 2006. Please fax results as soon as available. Please include copy of submittal sheets with final reports.

ANALYSIS REQUESTED: PLM with Dispersion Staining

TURNAROUND TIME: 72 Hours

JOB SITE: Community Day School
 2412 Cohasset Road
 Chico, CA 95926

SAMPLE #	MATERIAL DESCRIPTION/LOCATION
ECG-06-133-19H	Knockdown Texture Coat (B) - Building B, 210-Classroom, West wall, center area, lower part of wall.
ECG-06-133-19I	Knockdown Texture Coat (B) - Building B, 210-Classroom, East wall, south area, lower part of wall.
ECG-06-133-20A	2' X 4' Lay-in Ceiling Panel (B) - Building B, 211-Classroom, South area of ceiling near south wall.
ECG-06-133-20B	2' X 4' Lay-in Ceiling Panel (B) - Building B, 205-Hall, Northwest area of ceiling.
ECG-06-133-21A	Basecove Mastic (B) - Building B, 210-Classroom, Northeast corner, lower part of wall.
ECG-06-133-21B	Basecove Mastic (B) - Building B, 209-Special Ed/Conference, South wall, center area, lower part of wall.
ECG-06-133-22A	Linoleum Sheeting (B - Leaf Pattern) - Building B, 203B-Toilet (North), East side of doorway threshold.
ECG-06-133-23A	Linoleum Sheeting (B - Remnant) - Building B, 206-Day Room, Southwest corner, under wall.
ECG-06-133-24A	Floor Leveling Compound (B - White) - Building B, 200-Classroom, Northeast corner of room.
ECG-06-133-25A	Flooring Adhesive (B - Yellow) - Building B, 200-Classroom, Northeast corner of room.
ECG-06-133-26A	Linoleum Sheeting (B - Beige w/Specs) - Building B, 205-Hall, Southeast corner of room under wall.

C:\Entek\Clients.file\1 SpecClients.file\06-133 CommunityDaySchool.file\AsbBulkSample.file\BulkReq032906.wpd

PICKED UP BY: _____

DATE: _____

TIME: _____

DELIVERED TO:  _____

DATE: 3-30-06

TIME: 3

BULK SAMPLE LOCATIONS
MAPS NOT TO SCALE
FOR REFERENCE USE ONLY

BUILDING A

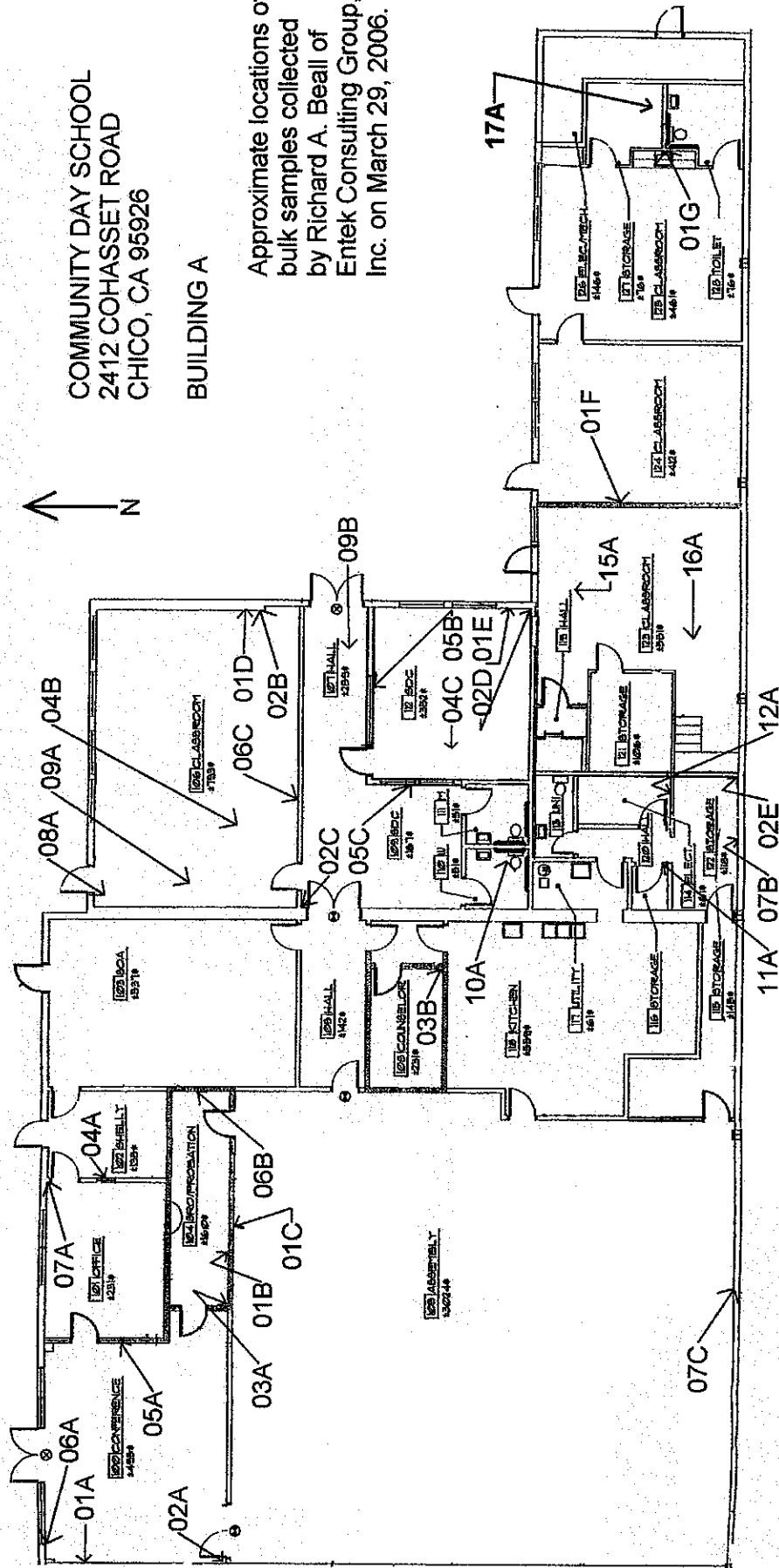
 $\leftarrow z$ 

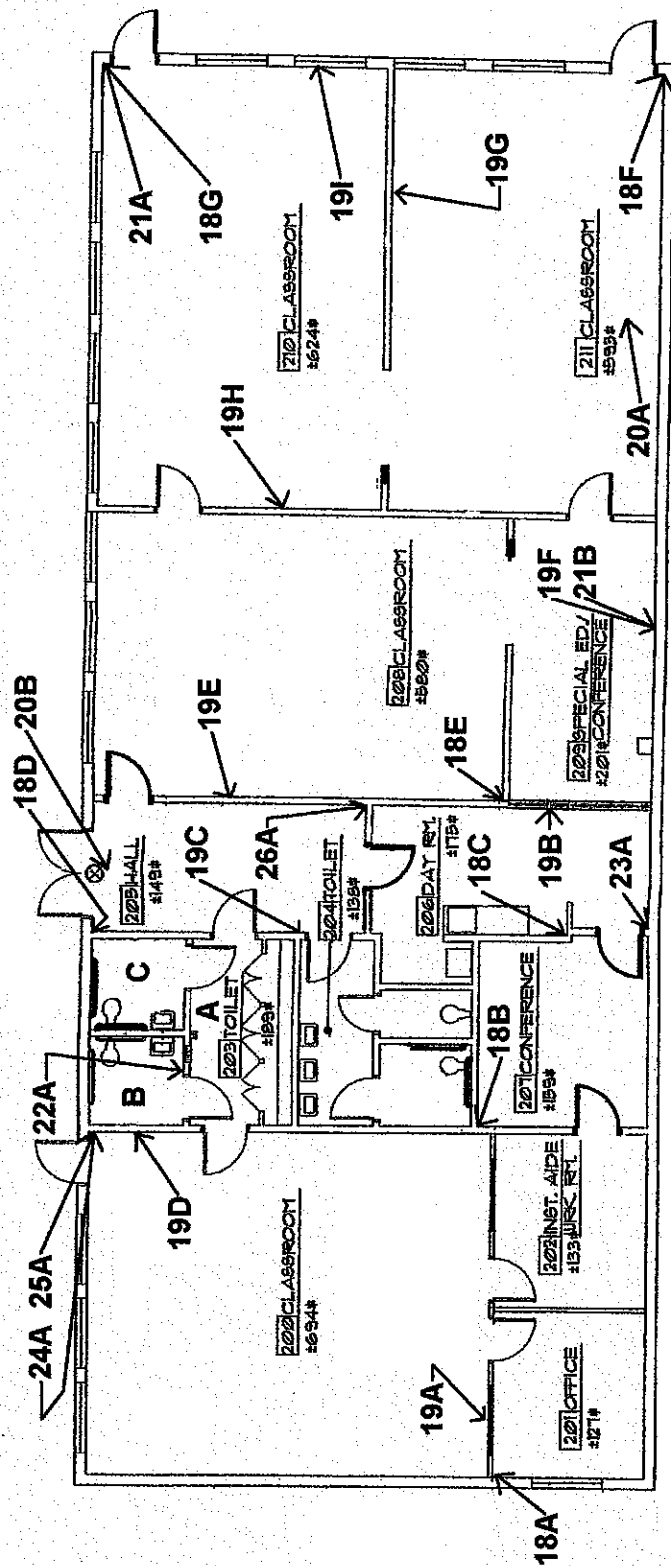

COMMUNITY DAY SCHOOL
2412 COHASSET ROAD
CHICO, CA 95926

BUILDING B

Approximate locations of bulk
samples collected by Richard A.
Beall of Entek Consulting Group,
Inc. on March 29, 2006.

COMMUNITY DAY SCHOOL
2412 COHASSET ROAD
CHICO, CA 95926

BUILDING A

MECHANICAL MEZZANINE

Approximate locations of bulk
samples collected by Richard A
Beall of Entek Consulting Group,
Inc. on March 29, 2006

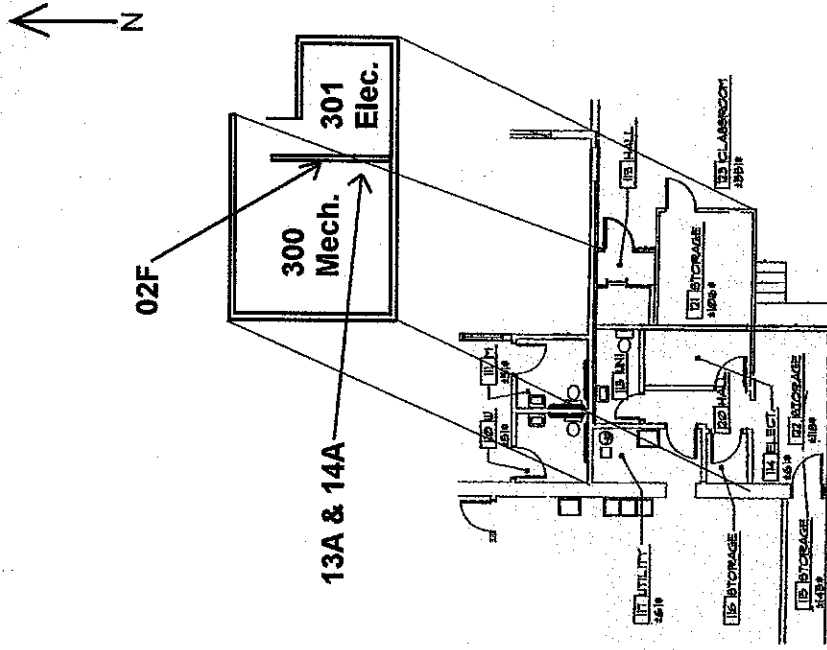

State of California
Division of Occupational Safety and Health

Certified Asbestos Consultant

Richard Anthony Beall



Name

Certification No. **92-0032**

Expires on **07/07/06**

This certification was issued by the Division of
Occupational Safety and Health as authorized by
Sections 7180 et seq. of the Business and
Professions Code



COEH CENTER FOR OCCUPATIONAL
& ENVIRONMENTAL HEALTH

University of California Berkeley



This certifies that

Richard A Beall

has attended the eight hour course

AHERA Refresher for Asbestos Inspectors & Management

Planners

and has completed the requisite training for asbestos accreditation under TSCA Title II

September 19, 2005

Course Date

John R. Schmitt

COEH Director

Date of Exam: September 19, 2005

Expiration Date: September 19, 2006

Barbara A. Plog

Continuing Education Director

Certificate Number: BIMP 1

Cal/OSHA Approval Number: CA-002-08

Center for Occupational and Environmental Health Continuing Education Program
UC Berkeley Mailcode 5120, 2223 Fulton Street, 2nd Floor, Berkeley, CA 94720-5120 Ph: (510) 643-7277 Fax: (510) 643-7291



COEH CENTER FOR OCCUPATIONAL
& ENVIRONMENTAL HEALTH

University of California Berkeley



This certifies that

Richard A Beall

has attended the eight hour course

AHERA Refresher for Asbestos Contractors & Supervisors

and has completed the requisite training for asbestos accreditation under TSCA Title II

March 9, 2006

Course Date

John R. Schmitt

COEH Director

Date of Exam: March 9, 2006

Expiration Date: March 9, 2007

Barbara R. Plog

Continuing Education Director

Certificate Number: CS158

Cal/OSHA Approval Number: CA-002-04

Center for Occupational and Environmental Health Continuing Education Program

UC Berkeley Mailcode 5120, 2223 Fulton Street, 2nd Floor, Berkeley, CA 94720-5120 Ph: (510) 643-7277 Fax: (510) 643-7291



COEH CENTER FOR OCCUPATIONAL
& ENVIRONMENTAL HEALTH

University of California Berkeley



This certifies that

Richard A Beall

has attended the eight hour course

AHERA Refresher for Asbestos Abatement Project Designers

and has completed the requisite training for asbestos accreditation under TSCA Title II

November 2, 2005

Course Date

John R. Schum

COEH Director

Barbara A. Plog

Continuing Education Director

Date of Exam: November 2, 2005

Expiration Date: November 2, 2006

Certificate Number: PD 16

Cal/OSHA Approval Number: CA-002-10

Center for Occupational and Environmental Health Continuing Education Program
UC Berkeley Mailcode 5120, 2223 Fulton Street, 2nd Floor, Berkeley, CA 94720-5120 Ph: (510) 643-7277 Fax: (510) 643-7291

State of California
Division of Occupational Safety and Health

Certified Asbestos Consultant

Douglas R Colley



Name

92-0222

Certification No.

09/17/06

Expires on

This certification was issued by the Division of
Occupational Safety and Health as authorized by
Sections 7180 et seq. of the Business and
Professions Code.

CAL

ENVIRONMENTAL

SERVICES

INC

This is to certify that

Douglas R. Colley

has successfully completed the EPA approved A.H.E.R.A. course for
Asbestos Building Inspector/Management Planner Refresher
as required under TSCA Title II

3/8/2006 to 3/8/2006
Course Date(s)

David Esparza - President

3/8/2007
Expiration Date

CA - 001 - 06

AC-38517
Certificate Number

CA - 001 - 08

Cal/OSHA Course Approval #

CAL INC 2040 Peabody Rd Vacaville, CA 95687 707-446-7996

CAL

ENVIRONMENTAL

SERVICES

INC

This is to certify that

Douglas R. Colley

has successfully completed the EPA approved A.H.E.R.A. course for
Asbestos Contractor Supervisor - Refresher
as required under TSCA Title II

4/21/2005 to 4/21/2006

Course Date(s)

David Esparza

David Esparza - President

4/21/2006
Expiration Date

AC-35752
Certificate Number

CA - 001 - 04
Cal/OSHA Course Approval #

CAL INC 2040 Peabody Rd Vacaville, CA 95687 707-446-7996

CAL

ENVIRONMENTAL

SERVICES

INC

This is to certify that

Douglas R. Colley

has successfully completed the EPA approved A.H.E.R.A. course for

Asbestos Project Designer - Refresher

as required under TSCA Title II

5/19/2005 to 5/19/2006

Course Date(s)

David Esparza

David Esparza - President

5/19/2006

Expiration Date

CA - 001 - 10

Cal/OSHA Course Approval #

AC-36187

Certificate Number

CAL INC 2040 Peabody Rd Vacaville, CA 95687 707-446-7996