

**DIAGRAMS**

Unified School District  
 Chico Junior High School  
 280 Memorial Way  
 Chico, CA 95926

Camellia Way  
 Faculty Parking  
 Bus Entry and Exit

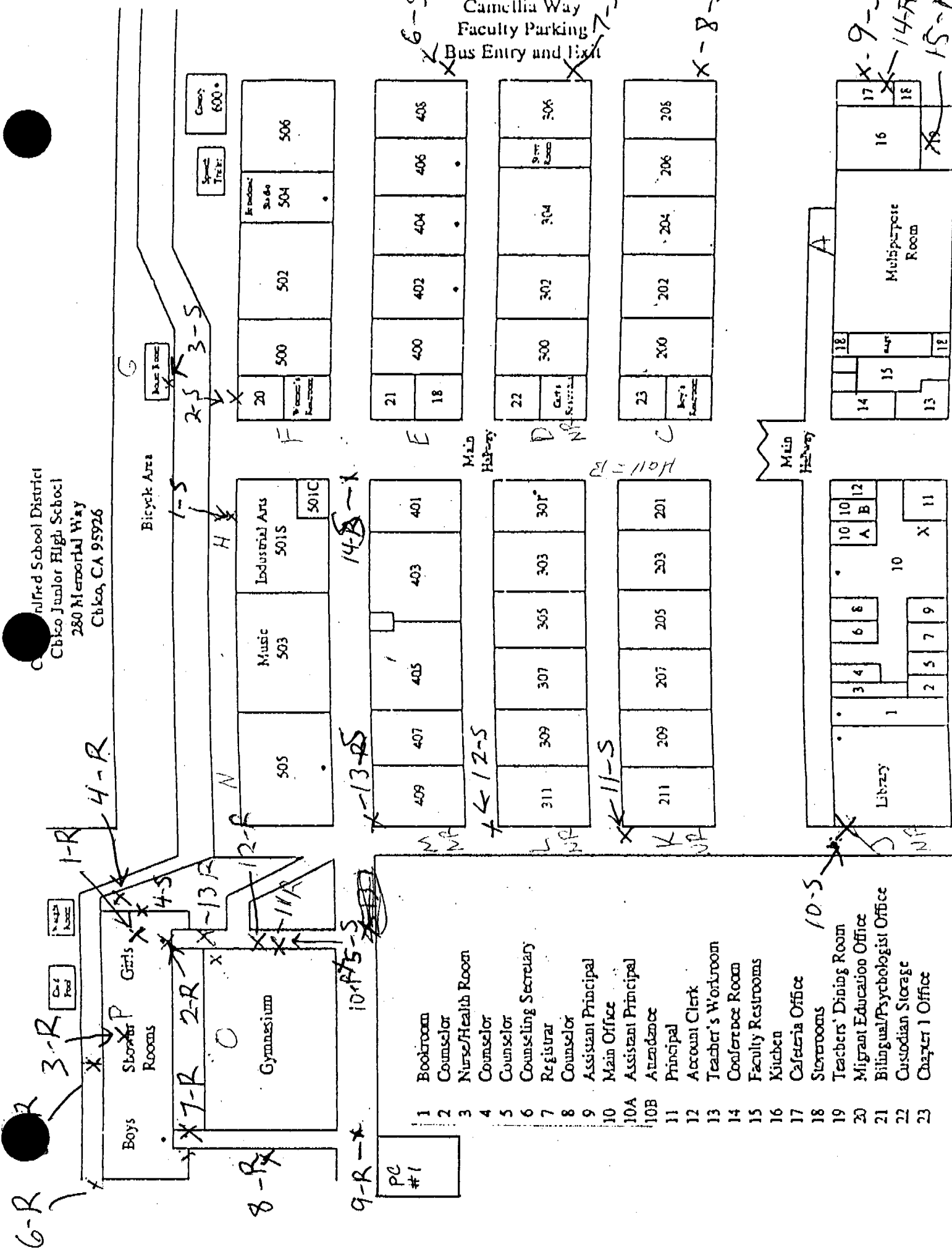

- 1 Bookroom
- 2 Counselor
- 3 Nurse/Health Room
- 4 Counselor
- 5 Counselor
- 6 Counseling Secretary
- 7 Registrar
- 8 Counselor
- 9 Assistant Principal
- 10 Main Office
- 10A Assistant Principal
- 10B Attendance
- 11 Principal
- 12 Account Clerk
- 13 Teacher's Workroom
- 14 Conference Room
- 15 Faculty Restrooms
- 16 Kitchen
- 17 Cafeteria Office
- 18 Storerooms
- 19 Teachers' Dining Room
- 20 Migrant Education Office
- 21 Bilingual/Psychologist Office
- 22 Custodian Storage
- 23 Chapter 1 Office

X = For Pells

**FIELD NOTES**

These levels should be used to establish both immediate and long range plans to act on the recommendations. The Priority Levels were selected for one of the following options:

Priority Level 1 - Isolate area, restrict access and respond as soon as possible.

Priority Level 2 - Schedule Response Action as soon as possible, reduce potential for disturbance.

Priority Level 3 - Schedule response Action as soon as practical, reduce potential for disturbance.

Priority Level 4 - Schedule Response Action as soon as practical.

Priority Level 5 - Schedule Response Action upon upgrade of system or material.

#### Cleaning Levels:

Level 1 - Initial cleaning should be done as soon as possible and additional cleaning should be done once every two months until the ACM is removed.

Level 2 - Initial cleaning should be done as soon as possible and additional cleaning should be done once every six months until the ACM is removed.

Level 3 - The material is non-friable therefore initial or additional cleaning is not necessary.

Level 4 - Initial or additional cleaning is not required for this material.

#### RESPONSE ACTIONS AND PRIORITY LEVELS:

Response Actions have been recommended for all friable or assumed friable ACM that was found during the inspection. The Response Actions were selected from one of the following options:

1. Removal
2. Repair
3. Enclosure
4. Encapsulation
5. Operations and Maintenance Program
6. Periodic Surveillance

Inspector: J.R.  
Site: CSHS

Cert. #

Inspection Date 4-8-98

Material 9" Gypsum VAT Area: Bldg 0 Gym

Material Code	Friable	Accessibility	Type	Current Condition	Potential Condition	Approx. Amount of ACM	Priority Level	Cleaning Level	Response Action
MISC	N	High		Good	Good	350 sq ft	1 2 3 4 5	1 2 3 4	1 2 3 4 5 6

Justification:

Implementation

Start:

End:

Notes:

Inspector: J.R.  
Site: CSHS

Cert. #

Inspection Date 4-8-98

Material Area:

Material Code	Friable	Accessibility	Type	Current Condition	Potential Condition	Approx. Amount of ACM	Priority Level	Cleaning Level	Response Action
							1 2 3 4 5	1 2 3 4	1 2 3 4 5 6

Justification:

Implementation

Start:

End:

Notes:

Inspector:  
Site:

Cert. #

Inspection Date

Material Area:

Material Code	Friable	Accessibility	Type	Current Condition	Potential Condition	Approx. Amount of ACM	Priority Level	Cleaning Level	Response Action
							1 2 3 4 5	1 2 3 4	1 2 3 4 5 6

Justification:

Implementation

Start:

End:

Notes:

Inspector:  
Site:

Cert. #

Inspection Date

Material Area:

Material Code	Friable	Accessibility	Type	Current Condition	Potential Condition	Approx. Amount of ACM	Priority Level	Cleaning Level	Response Action
							1 2 3 4 5	1 2 3 4	1 2 3 4 5 6

Justification:

Implementation

Start:

End:

Notes:

TSI: Thermal System Insulation SUR: Surface MISC: Miscellaneous

Inspector: J.R.  
Site: C.J.H.S.

Cert. #

Inspection Date 4-8-98

RM 502 - Instrument Storage  
RM 503 - Instrument Storage

Material Code	Friable	Accessibility	Type	Current Condition	Potential Condition	Approx. Amount of ACM	Priority Level	Cleaning Level	Response Action
SUR	N	Med		Good	Good	900 lb	1 2 3 4 5 (5)	1 2 3 (4)	1 2 3 4 5 (5)

Justification: Implementation Start: End:

Notes:

Inspector: J.R.  
Site: C.J.H.S.

Cert. #

Inspection Date 4-8-98

Material Code	Friable	Accessibility	Type	Current Condition	Potential Condition	Approx. Amount of ACM	Priority Level	Cleaning Level	Response Action
MISC	N	Low		Good	Good	4200 lb	1 2 3 4 5 (5)	1 2 3 (4)	1 2 3 4 5 (5)

Justification: Implementation Start: End:

Notes:

Inspector: J.R.  
Site: C.J.H.S.

Cert. #

Inspection Date 4-8-98

Material Code	Friable	Accessibility	Type	Current Condition	Potential Condition	Approx. Amount of ACM	Priority Level	Cleaning Level	Response Action
MISC.	N	High		Dang.	Dang.	900 lb	1 2 3 4 5 (5)	1 2 3 (6)	1 2 3 4 5 (6)

Justification: Implementation Start: End:

Notes: 10% Damaged

Inspector: J.R.  
Site: C.J.H.S.

Cert. #

Inspection Date 4-8-98

Material Code	Friable	Accessibility	Type	Current Condition	Potential Condition	Approx. Amount of ACM	Priority Level	Cleaning Level	Response Action
MISC	N	Low		Good	Good	2000 lb	1 2 3 4 5 (5)	1 2 3 (5)	1 2 3 4 5 (5)

Justification: Implementation Start: End:

Notes:

Inspector: S.R.  
Site: CSHS

Cert. #

Inspection Date 4-8-98

Material 1'x1' ACT Area: Bldg. M (400-W) - All Classrooms

Material Code	Friable	Accessibility	Type	Current Condition	Potential Condition	Approx. Amount of ACM	Priority Level	Cleaning Level	Response Action
MISC.	N	Low		Good	Good	5200	1 2 3 4 5	1 2 3 4	1 2 3 4 5

Justification:

Implementation

Start:

End:

Notes:

Inspector: S.R.  
Site: CSHS

Cert. #

Inspection Date 4-8-98

Material 9" TAN VAT Area: Bldg. M (400-W) - All Classrooms

Material Code	Friable	Accessibility	Type	Current Condition	Potential Condition	Approx. Amount of ACM	Priority Level	Cleaning Level	Response Action
MISC.	N	High		Good	Good	5200	1 2 3 4 5	1 2 3 4	1 2 3 4 5

Justification:

Implementation

Start:

End:

Notes:

Inspector: S.R.  
Site: CSHS

Cert. #

Inspection Date 4/8/98

Material Transit Panel Area: Bldg. M (400-W) - Exit Transit Panels @ Windows

Material Code	Friable	Accessibility	Type	Current Condition	Potential Condition	Approx. Amount of ACM	Priority Level	Cleaning Level	Response Action
MISC.	N	Med		Good	Good	2400	1 2 3 4 5	1 2 3 4	1 2 3 4 5

Justification:

Implementation

Start:

End:

Notes: Assumed

Inspector: S.R.  
Site: CSHS

Cert. #

Inspection Date 4-8-98

Material Plaster Wall & Ceiling Area: Bldg. N - RM 503 - Office & Instrument Storage

Material Code	Friable	Accessibility	Type	Current Condition	Potential Condition	Approx. Amount of ACM	Priority Level	Cleaning Level	Response Action
SUR	N	Med		Good	Good	3500	1 2 3 4 5	1 2 3 4	1 2 3 4 5

Justification:

Implementation

Start:

End:

Notes:

TSI: Thermal System Insulation SUR: Surface MISC: Miscellaneous

Inspector: J.R.  
Site: CSHS

Cert. #

Inspection Date 4-8-96

Material <u>Transite Panels</u> Area: <u>Bldg. K (200-W) - Exterior Wall @ Windows</u>									
Material Code	Friable	Accessibility	Type	Current Condition	Potential Condition	Approx. Amount of ACM	Priority Level	Cleaning Level	Response Action
MISC.	N	Med.		Good	Good	2400 sq	1 2 3 4 5	1 2 3 4 5	1 2 3 4 5

Justification:

Implementation

Start:

End:

Notes:

Inspector: J.R.  
Site: C.S.H.S.

Cert. #

Inspection Date 4-8-98

Material <u>1'x1' ACT</u> Area: <u>Bldg. L (300-W) - All Class Rooms</u>									
Material Code	Friable	Accessibility	Type	Current Condition	Potential Condition	Approx. Amount of ACM	Priority Level	Cleaning Level	Response Action
MISC.		Med		Good	Good		1 2 3 4 5	1 2 3 4 5	1 2 3 4 5

Justification:

Implementation

Start:

End:

Notes:

Inspector: J.R.  
Site: CSHS

Cert. #

Inspection Date 4-8-98

Material <u>9" CT. BROWN VAT</u> Area: <u>Bldg # L (300-W) - All Class Room - 301 - 311</u>									
Material Code	Friable	Accessibility	Type	Current Condition	Potential Condition	Approx. Amount of ACM	Priority Level	Cleaning Level	Response Action
MISC.	N	High		Good	Good		1 2 3 4 5	1 2 3 4 5	1 2 3 4 5

Justification:

Implementation

Start:

End:

Notes:

Inspector: J.R.  
Site: C.S.H.S.

Cert. #

Inspection Date 4-8-98

Material <u>Transite Panel</u> Area: <u>Bldg. L (300-W) - Exterior Panel @ Windows</u>									
Material Code	Friable	Accessibility	Type	Current Condition	Potential Condition	Approx. Amount of ACM	Priority Level	Cleaning Level	Response Action
MISC.	N	Med		Good	Good	2400 sq	1 2 3 4 5	1 2 3 4 5	1 2 3 4 5

Justification:

Implementation

Start:

End:

Notes:

TSI: Thermal System Insulation SUR: Surface MISC: Miscellaneous



Inspector: J.R.      Cert. #      Inspection Date 4-8-98  
 Site: CSHS

Material 9" Green VAT      Area: Bldg K (200) - RM 203, 205, 207, 209, 211

Material Code	Friable	Accessibility	Type	Current Condition	Potential Condition	Approx. Amount of ACM	Priority Level	Cleaning Level	Response Action
MISC	N	High		Good	Fail		1 2 3 4 5	1 2 3 4	1 2 3 4 5 6

Justification:      Implementation      Start:      End:

Notes:

Inspector: J.R.      Cert. #      Inspection Date 4-8-98  
 Site: CSHS

Material 1'x1' ACT      Area: Bldg K (200) - All Class Rooms

Material Code	Friable	Accessibility	Type	Current Condition	Potential Condition	Approx. Amount of ACM	Priority Level	Cleaning Level	Response Action
MISC.	N	Low		FASH	FAIL	4200	1 2 3 4 5	1 2 3 4	1 2 3 4 5 6

Justification:      Implementation      Start:      End:

Notes: < 5% damaged

Inspector: J.R.      Cert. #      Inspection Date 4-8-98  
 Site: CSHS

Material 9" LT Brown VAT      Area: Bldg K (200-W) - RM 201

Material Code	Friable	Accessibility	Type	Current Condition	Potential Condition	Approx. Amount of ACM	Priority Level	Cleaning Level	Response Action
MISC.	N	High		Good	Good		1 2 3 4 5	1 2 3 4	1 2 3 4 5 6

Justification:      Implementation      Start:      End:

Notes:

Inspector: J.R.      Cert. #      Inspection Date 4-8-98  
 Site: CSHS

Material 9" Dark Brown VAT      Area: Bldg K (200-W) - RM 201

Material Code	Friable	Accessibility	Type	Current Condition	Potential Condition	Approx. Amount of ACM	Priority Level	Cleaning Level	Response Action
MISC	N	High		Good	Good		1 2 3 4 5	1 2 3 4	1 2 3 4 5 6

Justification:      Implementation      Start:      End:

Notes: Replacement Tiles in Room

TSI: Thermal System Insulation    SUR: Surface    MISC: Miscellaneous

Inspector: J.R.  
Site: CJHS

Cert. #

Inspection Date 4-8-98

Material *Plaster Walls & Ceiling* Area: *Bldg. J (Library)* -

Material Code	Friable	Accessibility	Type	Current Condition	Potential Condition	Approx. Amount of ACM	Priority Level	Cleaning Level	Response Action
SUR	N	Low		Good	Good	14,000	1 2 3 4 5 <input checked="" type="checkbox"/>	1 2 3 4 <input checked="" type="checkbox"/>	1 2 3 4 5 <input checked="" type="checkbox"/>

Justification:

Implementation

Start:

End:

Notes:

Inspector: J.R.,  
Site: CJHS

Cert. #

Inspection Date 4-8-98

Material *ceiling Traveled on Texture* Area: *Bldg. J - Library*

Material Code	Friable	Accessibility	Type	Current Condition	Potential Condition	Approx. Amount of ACM	Priority Level	Cleaning Level	Response Action
SUR	N	Low		Good	Good		1 2 3 4 5 <input checked="" type="checkbox"/>	1 2 3 4 <input checked="" type="checkbox"/>	1 2 3 4 5 <input checked="" type="checkbox"/>

Justification:

Implementation

Start:

End:

Notes:

Inspector: J.R.,  
Site: CJHS

Cert. #

Inspection Date 4-8-98

Material *Pipe Lagging* Area: *Bldg. J - Library*

Material Code	Friable	Accessibility	Type	Current Condition	Potential Condition	Approx. Amount of ACM	Priority Level	Cleaning Level	Response Action
TSI	Y	Low		Good	Good	110 IN. FT.	1 2 3 4 5 <input checked="" type="checkbox"/>	1 2 3 4 <input checked="" type="checkbox"/>	1 2 3 4 5 <input checked="" type="checkbox"/>

Justification:

Implementation

Start:

End:

Notes:

Inspector: J.R.,  
Site: CJHS

Cert. #

Inspection Date 4-8-98

Material *Tank Wrap* Area: *Bldg. J - LIBRARY*

Material Code	Friable	Accessibility	Type	Current Condition	Potential Condition	Approx. Amount of ACM	Priority Level	Cleaning Level	Response Action
TSI	Y	Low		Good	Good	1	1 2 3 4 5 <input checked="" type="checkbox"/>	1 2 3 4 <input checked="" type="checkbox"/>	1 2 3 4 5 <input checked="" type="checkbox"/>

Justification:

Implementation

Start:

End:

Notes:

TSI: Thermal System Insulation SUR: Surface MISC: Miscellaneous

Inspector: J.R.  
Site: CSHS

Cert. #

Inspection Date 4-8-88

Material		Area: Bldg 6 - Rest Room			Current	Potential	Approx.	Priority	Cleaning	Response
Code	Friable	Accessibility	Type	Condition	Condition	Amount of ACM	Level	Level	Action	
SUR	N	Med.		Good	Good	100 ✓	1 2 3 4 5	1 2 3 4	1 2 3 4 5	

Justification:

Implementation

Start:

End:

Notes:

Inspector: J.R.  
Site: CSHS

Cert. #

Inspection Date 4-8-88

Material		Area: Bldg 4 - Industrial Arts -			Current	Potential	Approx.	Priority	Cleaning	Response
Code	Friable	Accessibility	Type	Condition	Condition	Amount of ACM	Level	Level	Action	
SUR	N	High		Good	Good	2000 ✓	1 2 3 4 5	1 2 3 4	1 2 3 4 5	

Justification:

Implementation

Start:

End:

Notes:

Inspector: J.R.  
Site: CSHS

Cert. #

Inspection Date 4-8-88

Material		Area: Bldg 4 - Industrial Art Classroom			Current	Potential	Approx.	Priority	Cleaning	Response
Code	Friable	Accessibility	Type	Condition	Condition	Amount of ACM	Level	Level	Action	
MISC	N	High		Good	Good		1 2 3 4 5	1 2 3 4	1 2 3 4 5	

Justification:

Implementation

Start:

End:

Notes: Rerouted

Inspector: J.R.  
Site: CSHS

Cert. #

Inspection Date

Material		Area: Bldg 4 - Through out			Current	Potential	Approx.	Priority	Cleaning	Response
Code	Friable	Accessibility	Type	Condition	Condition	Amount of ACM	Level	Level	Action	
MISC.	N	Low		Good	Good		1 2 3 4 5	1 2 3 4	1 2 3 4 5	

Justification:

Implementation

Start:

End:

Notes:

TSI: Thermal System Insulation SUR: Surface MISC: Miscellaneous

Inspector: J.R.  
Site: C.S.H.S.

Cert. #

Inspection Date 4-8-98

Material Plaster Walls & Ceiling Area: Bldg. F (500) - RM 20, 21 & Women's Restroom									
Material Code	Friable	Accessibility	Type	Current Condition	Potential Condition	Approx. Amount of ACM	Priority Level	Cleaning Level	Response Action
							1 2 3 4 5	1 2 3 4	1 2 3 4 5 6

Justification:

Implementation

Start:

End:

Notes:

Inspector:  
Site:

Cert. #

Inspection Date

Material 9" INT Rad Area: Bldg. F (500) RM - 20 (Mg)									
Material Code	Friable	Accessibility	Type	Current Condition	Potential Condition	Approx. Amount of ACM	Priority Level	Cleaning Level	Response Action
MISC	N	Low High		Good	Good	4000	1 2 3 4 5	1 2 3 4	1 2 3 4 5 6

Justification:

Implementation

Start:

End:

Notes:

Inspector: J.R.  
Site: C.S.H.S.

Cert. #

Inspection Date 4-8-98

Material Pipe Lagging Area: Bldg. F (500) - RM 502 & 506									
Material Code	Friable	Accessibility	Type	Current Condition	Potential Condition	Approx. Amount of ACM	Priority Level	Cleaning Level	Response Action
							1 2 3 4 5	1 2 3 4	1 2 3 4 5 6

Justification:

Implementation

Start:

End:

Notes: Material NOT Accessible because of New FCP's 2'x4'

Inspector: J.R.  
Site: C.S.H.S.

Cert. #

Inspection Date

Material Thermal Panels Area: Bldg. F (500) - Extension Wall @ Windows									
Material Code	Friable	Accessibility	Type	Current Condition	Potential Condition	Approx. Amount of ACM	Priority Level	Cleaning Level	Response Action
MISC	N	High		Good	Good	42000	1 2 3 4 5	1 2 3 4	1 2 3 4 5 6

Justification:

Implementation

Start:

End:

Notes:

TSI: Thermal System Insulation SUR: Surface MISC: Miscellaneous

Inspector: J.R.  
Site: CSHS

Cert. #

Inspection Date 4-8-98

Material Plaster Walls & Ceiling Area: Bldg. E (100) - RM 22, 18.

Material Code	Friable	Accessibility	Type	Current Condition	Potential Condition	Approx. Amount of ACM	Priority Level	Cleaning Level	Response Action
SUR	N	Med		Good	Good	1200 sq	1 2 3 4 5	1 2 3 5	1 2 3 4 5 6

Justification:

Implementation

Start:

End:

Notes:

Inspector: J.R.  
Site: CSHS

Cert. #

Inspection Date 4-8-98

Material Transite Panels Area: Bldg. E (400) - External Wall @ Windows

Material Code	Friable	Accessibility	Type	Current Condition	Potential Condition	Approx. Amount of ACM	Priority Level	Cleaning Level	Response Action
MISC.	N	Med		Good	Good	4,200	1 2 3 4 5	1 2 3 5	1 2 3 4 5 6

Justification:

Implementation

Start:

End:

Notes:

Inspector: J.R.  
Site: CSHS

Cert. #

Inspection Date 4-8-98

Material Transite Panels Area: Bldg. C (200) - External Wall @ Windows

Material Code	Friable	Accessibility	Type	Current Condition	Potential Condition	Approx. Amount of ACM	Priority Level	Cleaning Level	Response Action
MISC.	N	Med.		Good	Good		1 2 3 4 5	1 2 3 5	1 2 3 4 5 6

Justification:

Implementation

Start:

End:

Notes:

Inspector: J.R.  
Site: CSHS

Cert. #

Inspection Date 4-8-98

Material 1'x1' ALT Area: Bldg. F (500) - All to Class Rooms

Material Code	Friable	Accessibility	Type	Current Condition	Potential Condition	Approx. Amount of ACM	Priority Level	Cleaning Level	Response Action
MISC	N	Low		Good	Good	4,200 sq	1 2 3 4 5	1 2 3 5	1 2 3 4 5 6

Justification:

Implementation

Start:

End:

Notes: Material Above New FCP 2'x4'

TSI: Thermal System Insulation SUR: Surface MISC: Miscellaneous

Inspector: J.R.  
Site: CSHS

Cert. #

Inspection Date 4-8-98

Material 1'x1' ACT Area: Bldg D<sup>(300)</sup> - All Rooms

Material Code	Friable	Accessibility	Type	Current Condition	Potential Condition	Approx. Amount of ACM	Priority Level	Cleaning Level	Response Action
MISC	N	Low		Good	Good	4200	1 2 3 4 5	1 2 3 4	1 2 3 4 5

Justification:

Implementation

Start:

End:

Notes: Material Above new FCP 2'x4'

Inspector: S.R.  
Site: CSHS

Cert. #

Inspection Date 11-8-98

Material Plaster Area: Bldg D<sup>(300)</sup> - Girls RR., RM 24

Material Code	Friable	Accessibility	Type	Current Condition	Potential Condition	Approx. Amount of ACM	Priority Level	Cleaning Level	Response Action
SUR	N	Med.		Good	Good	1200	1 2 3 4 5	1 2 3 4	1 2 3 4 5

Justification:

Implementation

Start:

End:

Notes:

Inspector: J.R.  
Site: CSHS

Cert. #

Inspection Date 11-8-98

Material Transit Panels Area: Bldg D<sup>(300)</sup> - Entrance Wall @ Windows

Material Code	Friable	Accessibility	Type	Current Condition	Potential Condition	Approx. Amount of ACM	Priority Level	Cleaning Level	Response Action
MISC	N	Med.		Good	Good	1100	1 2 3 4 5	1 2 3 4	1 2 3 4 5

Justification:

Implementation

Start:

End:

Notes: Material is Assumed.

Inspector: S.R.  
Site: CSHS

Cert. #

Inspection Date 11-8-98

Material 1'x1' ACT Area: Bldg E (400) - All Glass Rooms

Material Code	Friable	Accessibility	Type	Current Condition	Potential Condition	Approx. Amount of ACM	Priority Level	Cleaning Level	Response Action
MISC	N	Low		Good	Good	1200	1 2 3 4 5	1 2 3 4	1 2 3 4 5

Justification:

Implementation

Start:

End:

Notes: Material Above New FCP 2'x4'

TSI: Thermal System Insulation SUR: Surface MISC: Miscellaneous

Inspector: J.R.  
Site: CJHS

Cert. #

Inspection Date 4-8-98

Material *Plaster Ceiling & Walls* Area: *Bldg. B - Throughout & Main Hallway*

Material Code	Friable	Accessibility	Type	Current Condition	Potential Condition	Approx. Amount of ACM	Priority Level	Cleaning Level	Response Action
SUR	N	Med.		FAIL	Fair	16000	1 2 3 4 5	1 2 3 4	1 2 3 4 5 6

Justification:

Implementation

Start:

End:

Notes: *Material has water damage stains*

Inspector: J.R.  
Site: CJHS

Cert. #

Inspection Date 4-8-98

Material *9" VAT Red* Area: *Bldg. B - Janitor Closet*

Material Code	Friable	Accessibility	Type	Current Condition	Potential Condition	Approx. Amount of ACM	Priority Level	Cleaning Level	Response Action
MISC	N	Low		Good	Good	110	1 2 3 4 5	1 2 3 4	1 2 3 4 5 6

Justification:

Implementation

Start:

End:

Notes:

Inspector: J.R.  
Site: CJHS

Cert. #

Inspection Date 4-8-98

Material *2'x4' ACT* Area: *Bldg. C (200) - All Rooms*

Material Code	Friable	Accessibility	Type	Current Condition	Potential Condition	Approx. Amount of ACM	Priority Level	Cleaning Level	Response Action
MISC	N	Low		Good	Good	4200	1 2 3 4 5	1 2 3 4	1 2 3 4 5 6

Justification:

Implementation

Start:

End:

Notes: *Material Above New FCP 2'x4'*

Inspector: J.R.  
Site: CJHS

Cert. #

Inspection Date 4-8-98

Material *Plaster Walls & Ceiling* Area: *Bldg. C (200) - ~~Room~~ Boys RR - RM 21*

Material Code	Friable	Accessibility	Type	Current Condition	Potential Condition	Approx. Amount of ACM	Priority Level	Cleaning Level	Response Action
MISC	N	Low		Good	Good	1100	1 2 3 4 5	1 2 3 4	1 2 3 4 5 6

Justification:

Implementation

Start:

End:

Notes:

TSI: Thermal System Insulation SUR: Surface MISC: Miscellaneous

Inspector: J.R.

Cert. #

Inspection Date

4-8-98

Site: CSMS

Material 9" White VAT Area: Bldg. A - Kitchen Office

Material Code	Friable	Accessibility	Type	Current Condition	Potential Condition	Approx. Amount of ACM	Priority Level	Cleaning Level	Response Action
MISC.	N	High		Fair	Fair	40 #	1 2 3 5	1 2 4	1 2 3 5 6

Justification:

Implementation

Start:

End:

Notes:

Inspector: J.R.

Cert. #

Inspection Date 4-8-98

Site: CSMS

Material 9" VAT - Red Area: Bldg. A - Kitchen Office

Material Code	Friable	Accessibility	Type	Current Condition	Potential Condition	Approx. Amount of ACM	Priority Level	Cleaning Level	Response Action
MISC.	N	High		Fair	Fair	5 #	1 2 3 5	1 2 4	1 2 3 5 6

Justification:

Implementation

Start:

End:

Notes:

Inspector: J.R.

Cert. #

Inspection Date 4-8-98

Site: CSMS

Material 9" Green VAT Area: Bldg. A - MPR, Teachers Lounge, <sup>Snack Bar</sup> ~~Fire Rooms~~ <sup>HVAC</sup> ~~5~~ <sub>6) Stage</sub>

Material Code	Friable	Accessibility	Type	Current Condition	Potential Condition	Approx. Amount of ACM	Priority Level	Cleaning Level	Response Action
MISC.	N	High		Good	Good	6000 # <del>1900 #</del>	1 2 3 4 5	1 2 3 4	1 2 3 4 5 6

Justification:

Implementation

Start:

End:

Notes:

Inspector: J.R.

Cert. #

Inspection Date 4-8-98

Site: CSMS

Material Mudded Joints Area: Bldg. A - <sup>HVAC Rooms by Stage</sup> ~~Hot Water Fore room~~

Material Code	Friable	Accessibility	Type	Current Condition	Potential Condition	Approx. Amount of ACM	Priority Level	Cleaning Level	Response Action
ELB	Y	Med		Good	Good	3 #	1 2 3 4 5	1 2 3 4	1 2 3 4 5 6

Justification:

Implementation

Start:

End:

Notes:

TSI: Thermal System Insulation SUR: Surface MISC: Miscellaneous



Inspector: *J.R.*  
 Site: *CSHS*

Cert. #

Inspection Date *4-8-98*

Material *Pipe Lapping* Area: *Bldg A - HVAC Rooms by Stage*

Material Code	Friable	Accessibility	Type	Current Condition	Potential Condition	Approx. Amount of ACM	Priority Level	Cleaning Level	Response Action
<i>TSD</i>	<i>Y</i>	<i>Low</i>	<i>N/A</i>	<i>Good</i>	<i>Good</i>	<i>30 in. Et</i>	<i>1 2 3 4 5</i>	<i>1 2 3 4</i>	<i>1 2 3 4 5</i>

Justification:

Implementation

Start:

End:

Notes:

Inspector: *J.D.*  
 Site: *CSHS*

Cert. #

Inspection Date *4-8-98*

Material *9" Lt. Green VAT* Area: *Bldg A - Kitchen*

Material Code	Friable	Accessibility	Type	Current Condition	Potential Condition	Approx. Amount of ACM	Priority Level	Cleaning Level	Response Action
<i>MISC.</i>	<i>N</i>	<i>High</i>		<i>Good</i>	<i>Good</i>	<i>1100</i>	<i>1 2 3 4 5</i>	<i>1 2 3 4</i>	<i>1 2 3 4 5</i>

Justification:

Implementation

Start:

End:

Notes:

Inspector: *J.R.*  
 Site: *CSHS*

Cert. #

Inspection Date

Material *Truss-Ledon Ceiling* Area: *Bldg A - MPR, Teachers Lounge*

Material Code	Friable	Accessibility	Type	Current Condition	Potential Condition	Approx. Amount of ACM	Priority Level	Cleaning Level	Response Action
<i>SUR</i>	<i>Y</i>	<i>Low</i>		<i>Damage Paint</i>	<i>Damage Paint</i>	<i>6000</i>	<i>1 2 3 4 5</i>	<i>1 2 3 4</i>	<i>1 2 3 4 5</i>

Justification:

Implementation

Start:

End:

Notes:

Inspector: *Jim Ross*  
 Site: *CSHS*

Cert. #

Inspection Date *4-8-98*

Material *Plaster Walls & Ceiling* Area: *Bldg A - Throughout*

Material Code	Friable	Accessibility	Type	Current Condition	Potential Condition	Approx. Amount of ACM	Priority Level	Cleaning Level	Response Action
<i>SUR</i>	<i>N</i>	<i>High</i>		<i>Good</i>	<i>Good</i>	<i>7,000,000</i>	<i>1 2 3 4 5</i>	<i>1 2 3 4</i>	<i>1 2 3 4 5</i>

Justification:

Implementation

Start:

End:

Notes:

TSI: Thermal System Insulation SUR: Surface MISC: Miscellaneous

**INSPECTOR'S QUALIFICATIONS**

DEPARTMENT OF INDUSTRIAL RELATIONS  
DIVISION OF OCCUPATIONAL SAFETY AND HEALTH  
ASBESTOS CONSULTANT CERTIFICATION UNIT

2211 Park Towne Circle, Suite 1  
Sacramento, CA 95825  
(916) 574-2993 FAX (916) 493-0572



608302035C 128 132

September 19, 1997

James Rich  
E.O.S. Environmental Inc.  
2110 21st Street, Suite 150  
Sacramento, CA 95818

Dear Certified Asbestos Consultant or Technician:

Enclosed is your certification card. To maintain your certification, please abide by the rules printed on the back of the certification card.

Your certification is valid for a period of one year. If you wish to renew your certification, you must apply for renewal at least 60 days before the expiration date shown on your card.

Please hold and do not send copies of your required AHERA refresher renewal certificates to the Division until you apply for renewal of your certification.

Please inform the Division of any changes in your mailing address or work address within 15 days.

Sincerely,

Rick Axon, CIH  
Senior Industrial Hygienist

RA/dor

Attachment

cc: File

State of California  
Division of Occupational Safety and Health  
Certified Asbestos Consultant

James M. Rich

Name

Certification No. 88-2035

Expires on 11/8/98

This certification was issued by the Division of Occupational Safety and Health as authorized by Section 7700 et seq. of the Business and Professions Code.