

**ENTEK  
CONSULTING GROUP, INC.**

4200 Rocklin Road, Suite 7 Rocklin, CA 95677

Telephone (916) 632-6800

Fax (916) 632-6812

**Limited Asbestos EPA NESHAP Inspection  
Final Report**

**Chico Junior High School  
Building O Restrooms  
280 Memorial Way  
Chico, California 95926  
Entek, Inc. Project #07-517**

**PREPARED FOR**

**Mr. Michael Weissenborn  
Facilities Department  
Chico Unified School District  
2455 Carmichael Drive  
Chico, California 95928**

**PREPARED BY**

**William W. Esparza  
CAC #99-2579  
Entek Consulting Group, Inc.  
4200 Rocklin Road, Suite 7  
Rocklin, California 95677**

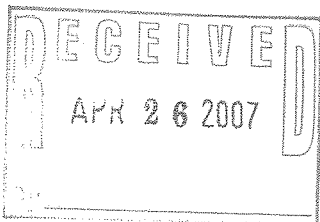

**April 25, 2007**

## TABLE OF CONTENTS

Executive Summary .....	3
Introduction .....	3
Building Description .....	4
Asbestos Inspection and Sample Collection Protocols .....	4
Asbestos Bulk Sample Results .....	5
Discussion of Asbestos and Recommendations .....	6
Limitations .....	6
Appendices	
A. Asbestos Related Documents	
B. Back Up Documentation	

## **Executive Summary**

This summary is a synopsis of the entire report. The report must be read in its entirety, and the reader must review all the detailed information provided prior to making any interpretations, or conclusions pertaining to that information. Any conclusions made by the reader about the information provided in this report which are contradictory or not included in this report are the responsibility of the reader.

### Asbestos

The United States Environmental Protection Agency, National Emissions Standards for Hazardous Air Pollutants (US EPA NESHAP), 40 CFR Part 61 - Nov. 20, 1990, requires an owner or operator of a demolition or renovation project to thoroughly inspect the affected facility or part of the facility where the demolition or renovation operation will occur for the presence of asbestos-containing materials (ACM) prior to the commencement of that project. The authority to enforce the asbestos NESHAP requirements have been delegated to the California Environmental Protection Agency, Air Resources Board (ARB) by the US EPA. This report meets or exceeds all requirements stated in the California ARB regulations.

On April 9, 2007, Entek Consulting Group, Inc. (Entek) conducted a limited asbestos survey which included interior and exterior areas of the restrooms, the sports storage room and the adjoining corridor in Building O at Chico Junior High School located at 280 Memorial Way in Chico, California. The survey was conducted in preparation for an upcoming renovation project.

There were several materials observed during this inspection which are considered "suspect" under US EPA guidelines. Under current US EPA guidelines for conducting building inspections for ACM, all "suspect" materials must be **assumed** to contain asbestos until otherwise determined by laboratory testing.

## **Introduction**

This report communicates the results of a limited asbestos survey performed by Entek which included interior and exterior areas of the restrooms, the sports storage room and the adjoining corridor in Building O at Chico Junior High School located at 280 Memorial Way in Chico, California.

Mr. William W. Esparza conducted this survey on April 9, 2007. Mr. Esparza is an AHERA-accredited building inspector and a Cal/OSHA Certified Asbestos Consultant. This report was prepared for Mr. Michael Weissenborn of Chico Unified School District, located at 2455 Carmichael Drive, Chico, California.

This survey was conducted for the purpose of complying with the US EPA NESHAP, 40 CFR Part 61, which requires an owner or operator of a demolition or renovation project to thoroughly inspect the affected facility or part of the facility where the demolition or renovation operation will occur for the presence of ACM prior to commencement of that project, and to comply with Cal/OSHA §1532.1 requirements.

### **Building Description**

Building O at Chico Junior High School is comprised of a gymnasium, two restrooms, several storage rooms and an adjoining corridor. The proposed renovation project will only affect the restrooms, the sports storage room and the adjoining corridor on the southeast portion of the building. This portion of the building is single-story and appears to be an addition after the original construction.

The exterior on the addition to the southeast corner of Building O is constructed of stucco. The roof, which has a separate elevation from the rest of the building, is a built-up roof with a rolled cap sheet. One penetration vent is located on this roof.

With the exception of the north interior wall of the girl's restroom, which is constructed of brick and mortar, all other interior walls and ceilings are constructed of drywall with joint compound applied at joints and nail heads. The walls and ceilings in the restrooms are finished with a troweled texture, while the walls of the sports storage room are covered by wood paneling. The corridor adjoining the restrooms and sports storage room with the gymnasium is constructed of stucco. The floors in this portion of the building are unfinished concrete, however, 9" vinyl floor tiles and adhesive are present on the concrete in the restrooms.

### **Asbestos Inspection and Sample Collection Protocols**

Entek included only those areas that will be affected by the proposed renovation of Building O located at Chico Junior High School in Chico, California.

Entek did not use any demolition methods to look in wall or ceiling cavities during this investigation.

Bulk samples were collected of various interior materials suspected to contain asbestos by either utilizing a power drill and coring tube or by cutting the materials with a razor knife. The sample collection was performed on April 9, 2007 by Mr. William W. Esparza. Sample locations were determined by convenience to the materials and each materials' relative locations. Approximate locations of all samples collected during this inspection are indicated on the "Bulk Asbestos Material Analysis Request Form for Entek", which served as the chain of custody for the samples, and on the building diagrams attached to this report.

The samples were submitted to Asbestech Laboratory, located in Carmichael, California, and subsequently analyzed by polarized light microscopy (PLM) with dispersion staining. Copies of Asbestech's laboratory reports and accreditations are attached.

### Asbestos Bulk Sample Results

There were several materials observed which are considered "suspect" under US EPA guidelines. Under current US EPA guidelines for conducting building inspections for ACM, all "suspect" materials must be **assumed** to contain asbestos until otherwise determined by laboratory testing.

A total of twelve bulk samples were collected of all the materials considered to be "suspect" and which were observed during this investigation. All of the samples collected were analyzed by PLM with dispersion staining. Please refer to the attached laboratory analysis reports for more detailed information. Those materials sampled and found to be non-asbestos-containing are listed below.

<b>Suspect Materials Found NOT TO Contain Asbestos or Considered Non-Suspect</b>		
<b>Material</b>	<b>Asbestos Content</b>	<b>Location</b>
Wallboard and Joint Compound	None Detected	Restrooms and Sports Stg
Wall Texture	None Detected	Boy's and Girl's Restrooms
Wallboard and Joint Compound	None Detected	Sports Storage Room
Stucco	None Detected	Interior Corridor
Stucco	None Detected	Ext of Restrooms and Sports Stg.
Built-Up Roof	None Detected	Ext of Restrooms and Sports Stg.
Roof Penetration Mastic	None Detected	Ext of Restrooms and Sports Stg.

One material observed during this investigation had been previously sampled during the original AHERA inspection of the school in 1988 and is known to contain asbestos. The known Asbestos-Containing Material is listed below.

<b>Suspect Materials Found to Contain &gt;1% Asbestos</b>			
<b>Material and Category</b>	<b>Asbestos Content</b>	<b>Estimated Amount</b>	<b>Location</b>
9" Vinyl Floor Tile & Mastic (CAT-I)	1-5% Chrysotile	140 Ft <sup>2</sup>	Restrooms



The acronyms, if used above, are terms taken from the US EPA NESHAP. RACM stands for Regulated Asbestos Containing Material, CAT-I & CAT-II stand for Category I or Category II Non-Friable Asbestos Containing Material respectively. The acronym ACCM stands for Asbestos Containing Construction Material as defined in Title 8, 1529.

Copies of laboratory reports and sample location drawings are attached to this report for the samples listed above.

## **Discussion of Asbestos and Recommendations**

### US EPA

The US EPA NESHAP (40 CFR Part 61 - Nov. 20, 1990) requires materials containing greater than one percent asbestos be removed prior to renovation or demolition of a regulated building, if those materials are friable, or likely to become friable due to the forces expected to act upon them during a renovation/demolition. In California there are "delegated" counties or districts which enforce the NESHAP regulations, and may have regulations more restrictive than the US EPA. The property included in this inspection is located in Butte County. This area is delegated to the California ARB which enforces the NESHAP regulations.

### Cal/OSHA

Disturbance of any ACM could generate airborne asbestos fibers and would be regulated by Cal/OSHA. Cal/OSHA worker health and safety regulations apply during any disturbance of ACM or ACCM by a person while in the employ of another. This is true regardless of friability or quantity disturbed.

For compliance with Title 8, California Administrative Code, Construction Safety Order 1529, Asbestos Regulations, the asbestos abatement contractor must send written notice at least one day (24 hours) prior to start of any work which will impact any amount of asbestos to the local office for the State of California, Department of Occupational Safety and Health, and perform all work in accordance with Cal/OSHA requirements.

## **Limitations**

Entek had only a limited knowledge of the areas included in the upcoming renovation project, and as a result, limited the inspection survey to areas expected and identified by Chico Unified School District as most likely to be impacted by the project.

Entek also did not perform any destructive sampling to look into ceiling and wall cavities. As a result it may be possible for materials to be hidden in these areas which are not included in this report. Entek also did not employ any destructive measures on floors of interior spaces or exterior areas covered with asphalt, concrete, or dirt. If any new

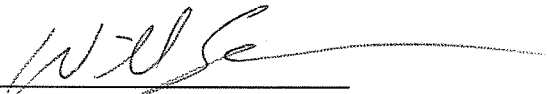

materials not listed as having been sampled, or listed as assumed for containing asbestos in this report are discovered, it must be assumed that the materials are asbestos-containing until properly inspected and tested for asbestos content.

Prepared by:   
William W. Esparza  
Project Manager  
Cal/OSHA CAC #99-2579

## **APPENDIX A**

### **ASBESTOS RELATED DOCUMENTS**

- Asbestos Bulk Sample Locations Drawing
- Bulk Asbestos Material Analysis Report Forms for Entek
- Bulk Asbestos Analysis Reports From Asbestech
- Bulk Asbestos Material Analysis Request Forms for Entek



Chico Junior High School  
Building O Restrooms  
280 Memorial Way  
Chico, CA 95926

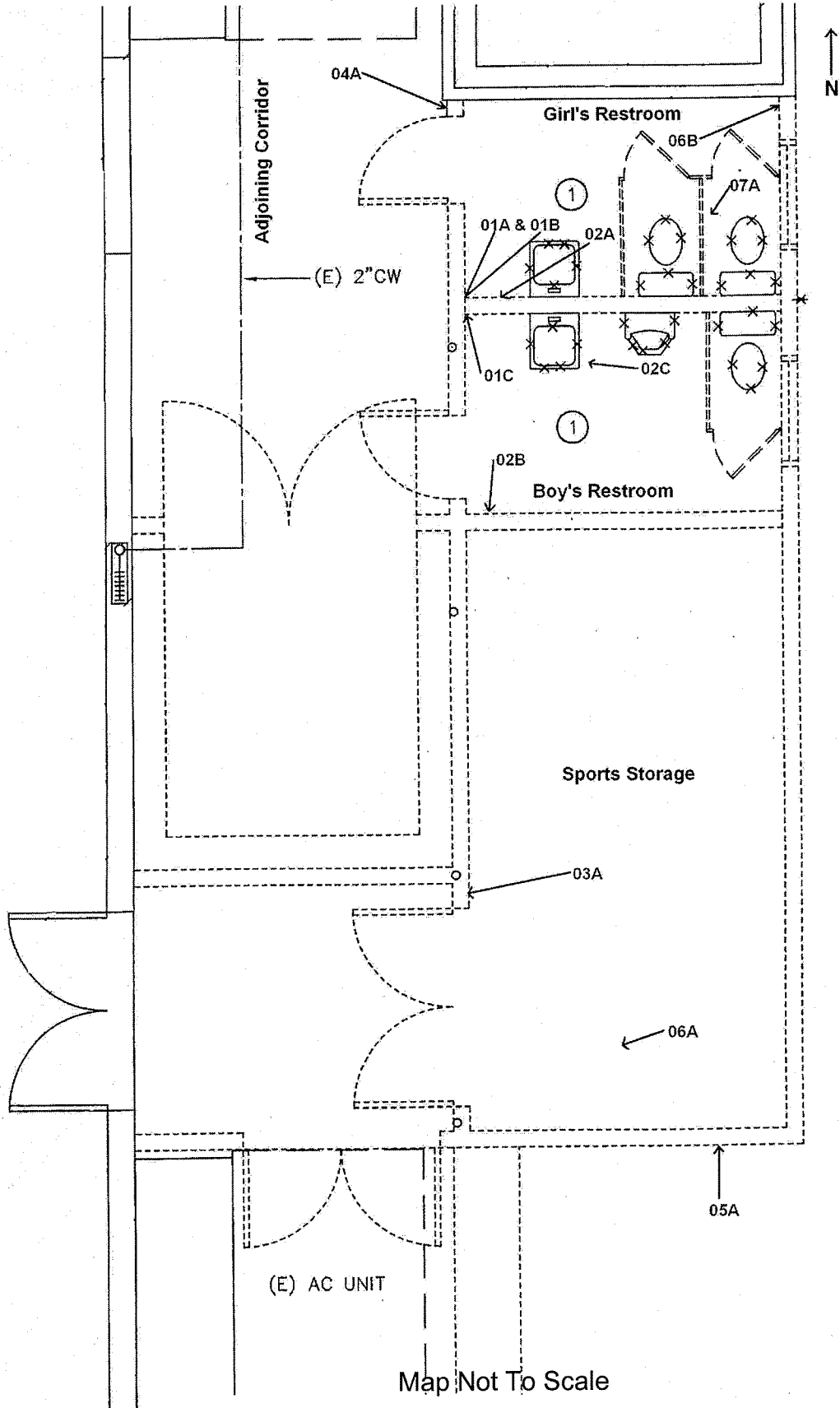

<p>Entek Consulting Group, Inc. 4200 Rocklin Road, Suite 7 Rocklin, CA 95677</p>	<p>All Samples Begin With ECG-07-517- Collected By: William Esparza April 9, 2007</p>
--	---



**BULK ASBESTOS MATERIAL** *Analysis Report Form for Entek Consulting Group, Inc.*

4200 ROCKLIN ROAD, STE. 7  
ROCKLIN, CA 95677  
(916) 632-6800  
FAX (916) 632-6812

**JOB I.D.:**                      **CLIENT:** Chico Unified School District                      **COLLECTED BY:** HMS, Inc.

**DATE COLLECTED:** 3-28-88                      **ANALYSIS CONDUCTED:** Asbestos by PLM with Dispersion Staining

**JOB SITE:**      Chico Junior High School  
                    280 Memorial Way  
                    Chico, CA 95926

SAMPLE #	RESULTS	MATERIAL DESCRIPTION/LOCATION
CJH-05	1-5% CHRYSOTILE	9" VFT Dark Green & Backing

Z:\Clients\Chico USD\07-517ChicoJHS-BldgORestroomBulkRep032888.wpd



**BULK ASBESTOS MATERIAL** *Analysis Report Form for Entek Consulting Group, Inc.*

4200 ROCKLIN ROAD, STE. 7  
 ROCKLIN, CA 95677  
 (916) 632-6800  
 FAX (916) 632-6812

**JOB I.D.:** 07-517      **CLIENT:** Chico Unified School District      **COLLECTED BY:** William Esparza

**DATE COLLECTED:** 4-9-07      **ANALYSIS CONDUCTED:** Asbestos by PLM with Dispersion Staining

**JOB SITE:** Chico Junior High School  
 Building O Restroom  
 280 Memorial Way  
 Chico, CA 95926

SAMPLE #	RESULTS	MATERIAL DESCRIPTION/LOCATION
ECG-07-517-01A	NONE DETECTED	Drywall and Joint Compound Building O, Girl's Restroom, South West Corner
ECG-07-517-01B	NONE DETECTED	Drywall and Joint Compound Building O, Girl's Restroom, South West Corner at Ceiling
ECG-07-517-01C	NONE DETECTED	Drywall and Joint Compound Building O, Boy's Restroom, North West Corner
ECG-07-517-02A	NONE DETECTED	Wall Texture Building O, Girl's Restroom. South Wall
ECG-07-517-02B	NONE DETECTED	Wall Texture Building O, Boy's Restroom, South Wall
ECG-07-517-02C	NONE DETECTED	Wall Texture Building O, Boy's Restroom Ceiling
ECG-07-517-03A	NONE DETECTED	Drywall and Joint Compound Building O, Sports Storage, West Wall at Ceiling
ECG-07-517-04A	NONE DETECTED	Gray Stucco Building O, Corridor, East Wall Near Girl's Restroom
ECG-07-517-05A	NONE DETECTED	Gray Stucco Building O, Exterior South Wall of Sports Storage
ECG-07-517-06A	NONE DETECTED	Black Built-Up Roof Tar, Felt & Rolled Cap Sheet Building O, Center of Restrooms
ECG-07-517-06B	NONE DETECTED	Black Built-Up Roof Tar, Felt, & Rolled Cap Sheet Building O, Flashing of Restrooms
ECG-07-517-07A	NONE DETECTED	Roof Penetration Mastic Building O, Roof Over Restroom

Z:\Clients\Chico USD\07-517\ChicoJHS-BldgORestroom\BulkRep040907.wpd

FORENSIC ANALYTICAL SPECIALTIES INC. - ASBESTOS ANALYSIS LABORATORY REQUEST FORM

BULK SAMPLES 3777 Depot Rd: Suite 408 Hayward, Ca. 94545 (415) 887-8828 Page 1 of 6

HAZARD MANAGEMENT SERVICES, INC

Client Number: Report Number  
 Received By: Date Rec'd  
 District or Business: School Chico Junior High  
 Bldg: OR

Bill To: P.O. Box 7012, Modesto, Ca 95355  
 Billing Address:

3-28-88 date

Collected by: Date Sent to Lab by:  
 LAB Request: % Asbestos By PLM

Sample #HMS-	Report Number	Date/Time/By	Materials/Location	% Asbestos
CJH-01			M: VET-9" - white & Backing L: Kitchen Office	1-5%
CJH-02			M: VET-9" - Red & Backing L: Kitchen Office	1-5%
CJH-03			M: VET-9" - Green & Backing L: Kitchen	Trace
CJH-04A			M: Hard Plaster L: Kitchen Office	<1%
CJH-04B			M: Hard Plaster L: Kitchen Snack Bar	<1%
CJH-04C			M: Hard Plaster L: Kitchen wall	<1%
CJH-04D			M: Hard Plaster L: MPR wall	<1%
CJH-05			M: VET-9" - Dark Green & Backing L: Snack Bar	1-5%
CJH-06			M: TSI - Mudded Joint L: Water heater room	1-5%
CJH-07			M: TSI - P.W. Straight L: Water heater room	<1%

ASBESTECH  
 6825 Fair Oaks Blvd., Suite 103  
 Carmichael, California 95608  
 Tel.(916) 481-8902 Fax (916) 481-3975

**Client:**  
 Entek Consulting Group, Inc.  
 4200 Rocklin Rd., Suite 7  
 Rocklin, CA 95677

**Job:**  
 07-517 Chico USD  
 Chico JHS, Bldg. O Restroom  
 Chico, Ca

**BULK ASBESTOS ANALYSIS REPORT**

LAB JOB # 50067-1  
 Date/Time Collected: 4/9/07  
 Date Received: 4/11/07

NVLAP # 101442  
 DOHS # 1153  
 Date Analyzed: 4/12/07

<u>Sample No.</u>	<u>Color/Description</u>	<u>% Type Asbestos</u>	<u>Other Materials</u>
ECG-07-517-01A	White drywall, bldg. O girl's restroom SW corner	NONE DETECTED	Gypsum Cellulose
	White joint compound 1	NONE DETECTED	Granular Mins.
	White joint compound 2	NONE DETECTED	Granular Mins.
01B	White drywall, bldg. O girl's restroom SW corner at ceiling	NONE DETECTED	Gypsum Cellulose
	White joint compound	NONE DETECTED	Granular Mins.
01C	White drywall, bldg. O boy's restroom NW corner	NONE DETECTED	Gypsum Cellulose
	White joint compound	NONE DETECTED	Granular Mins.
02A	White wall texture, bldg. O girl's restroom south wall	NONE DETECTED	Granular Mins.
02B	White wall texture, bldg. O boy's restroom south wall	NONE DETECTED	Granular Mins.
02C	White wall texture, bldg. O boy's restroom ceiling	NONE DETECTED	Granular Mins.

THE ANALYSIS USES POLARIZED LIGHT MICROSCOPY AND DISPERSION STAINING FOLLOWING E.P.A. METHOD 600/R-93/116. NON-FRIABLE MATERIALS WERE ANALYZED APPLYING THE SAME METHOD. THE LOWER DETECTION LIMIT IS <1 % WITH THE PROVISO THAT PLM MAY NOT DETECT FIBERS <0.25 MICRONS IN DIAMETER THAT MAY BE PRESENT IN SAMPLES SUCH AS FLOOR TILES. IN ACCORDANCE WITH TITLE 22, CCR, SECTION 66261.24(a)(2)(A), THE MCL IS 1 %. SAMPLES WERE NOT COLLECTED BY ASBESTECH. THIS REPORT MUST NOT BE REPRODUCED EXCEPT IN FULL WITHOUT THE APPROVAL OF ASBESTECH. THIS REPORT RELATES ONLY TO THE ITEMS TESTED. THIS REPORT MUST NOT BE USED TO CLAIM PRODUCT ENDORSEMENT BY N.V.L.A.P. OR ANY AGENCY OF THE U.S. GOVERNMENT. ASBESTECH ACCEPTS TECHNICAL RESPONSIBILITY FOR THIS REPORT AND DATE OF ISSUE.

NVLAP

LABORATORY DIRECTOR: TOM CONLON

ANALYST: JIM JUNGLES

ASBESTECH  
 6825 Fair Oaks Blvd., Suite 103  
 Carmichael, California 95608  
 Tel.(916) 481-8902 Fax (916) 481-3975

**Client:**  
 Entek Consulting Group, Inc.  
 4200 Rocklin Rd., Suite 7  
 Rocklin, CA 95677

**Job:**  
 07-517 Chico USD  
 Chico JHS, Bldg. O Restroom  
 Chico, Ca

**BULK ASBESTOS ANALYSIS REPORT**

LAB JOB # 50067-2  
 Date/Time Collected: 4/9/07  
 Date Received: 4/11/07

NVLAP # 101442  
 DOHS # 1153  
 Date Analyzed: 4/12/07

<i>Sample No.</i>	<i>Color/Description</i>	<i>% Type Asbestos</i>	<i>Other Materials</i>
ECG-07-517-03A	White drywall, bldg. O sports storage west wall at ceiling	NONE DETECTED	Gypsum Cellulose
	White joint compound	NONE DETECTED	Calcite
04A	Gray stucco, bldg. O corridor east wall near girl's restroom	NONE DETECTED	Granular Mins.
05A	Gray stucco, bldg. O exterior south wall of sports storage	NONE DETECTED	Granular Mins.
06A	Black built up roof tar, felt & rolled cap sheet, bldg. O center of restrooms	NONE DETECTED	Tar Binder Fibrous Glass Granular Mins.
06B	Black built up roof tar, felt & rolled cap sheet, bldg. O flashing of restrooms	NONE DETECTED	Tar Binder Cellulose Granular Mins.
07A	Roof penetration mastic, bldg. O roof over restroom	NONE DETECTED	Tar Binder Cellulose Granular Mins.

THE ANALYSIS USES POLARIZED LIGHT MICROSCOPY AND DISPERSION STAINING FOLLOWING E.P.A. METHOD 600/R-93/116. NON-FRIABLE MATERIALS WERE ANALYZED APPLYING THE SAME METHOD. THE LOWER DETECTION LIMIT IS <1 % WITH THE PROVISIO THAT PLM MAY NOT DETECT FIBERS <0.25 MICRONS IN DIAMETER THAT MAY BE PRESENT IN SAMPLES SUCH AS FLOOR TILES. IN ACCORDANCE WITH TITLE 22, CCR, SECTION 66261.24(a)(2)(A), THE MCL IS 1 %. SAMPLES WERE NOT COLLECTED BY ASBESTECH. THIS REPORT MUST NOT BE REPRODUCED EXCEPT IN FULL WITHOUT THE APPROVAL OF ASBESTECH. THIS REPORT RELATES ONLY TO THE ITEMS TESTED. THIS REPORT MUST NOT BE USED TO CLAIM PRODUCT ENDORSEMENT BY N.V.L.A.P. OR ANY AGENCY OF THE U.S. GOVERNMENT. ASBESTECH ACCEPTS TECHNICAL RESPONSIBILITY FOR THIS REPORT AND DATE OF ISSUE.

NVLAP

LABORATORY DIRECTOR: TOM CONLON

ANALYST: JIM JUNGLES

**BULK ASBESTOS MATERIAL Analysis Request Form for Entek Consulting Group, Inc.**

4200 ROCKLIN ROAD, STE. 7  
 ROCKLIN, CA 95677  
 (916) 632-6800  
 FAX (916) 632-6812

**JOB I.D.:** 07-517      **CLIENT:** Chico Unified School District      **COLLECTED BY:** William Esparza

**DATE COLLECTED:** 04/09/07      **DATE SUBMITTED:** 04/11/07      **LAB SUBMITTED TO:** Asbestech

**SPECIAL INSTRUCTIONS:**

**ANALYSIS REQUESTED:** PLM with Dispersion Staining      **TURNAROUND TIME:** 24 Hours

**JOB SITE:** Chico Junior High School  
 Building O, Restroom  
 280 Memorial Way,  
 Chico, California

SAMPLE #	MATERIAL DESCRIPTION/LOCATION
ECG-07-517-01A	Drywall and Joint Compound, Building O, Girl's Restroom, SW Corner
ECG-07-517-01B	Drywall and Joint Compound, Building O, Girl's Restroom, SW Corner at Ceiling
ECG-07-517-01C	Drywall and Joint Compound, Building O, Boy's Restroom, NW Corner
ECG-07-517-02A	Wall Texture, Building O, Girl's Restroom, South Wall
ECG-07-517-02B	Wall Texture, Building O, Boy's Restroom, South Wall
ECG-07-517-02C	Wall Texture, Building O, Boy's Restroom, Ceiling
ECG-07-517-03A	Drywall and Joint Compound, Building O, Sports Storage, West Wall at Ceiling
ECG-07-517-04A	Stucco, Building O, Corridor, East Wall Near Girl's Restroom
ECG-07-517-05A	Stucco, Building O, Exterior, South Wall of Sports Storage
ECG-07-517-06A	Built-Up Roof Tar, Felt and Rolled Cap Sheet, Building O, Center of Restrooms
ECG-07-517-06B	Built-Up Roof Tar, Felt and Rolled Cap Sheet, Building O, Flashing of Restrooms
ECG-07-517-07A	Roof Penetration Mastic, Building O, Roof over Restroom

C:\Entek\Clients\Chico USD\07-517 Chico Jr Hi RR Mod\Bulk Asbestos Request 04-11-07.wpd

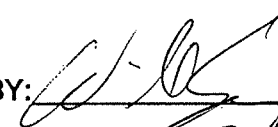
**DELIVERED BY:** 

**DATE:** 4/11/07 1245  
 4/11/07 12<sup>45</sup> PM

**RECEIVED BY:** 

## **APPENDIX C**

# **SUPPORTING DOCUMENTATION**

- Inspector Accreditations and Certifications
- Laboratory Accreditations for Asbestos Analysis



State of California  
Division of Occupational Safety and Health  
Certified Asbestos Consultant

**William Esparza**



Name

99-2579

Certification No.

05/03/07

Expires on

This certification was issued by the Division of Occupational Safety and Health as authorized by Sections 7180 et seq. of the Business and Professions Code.

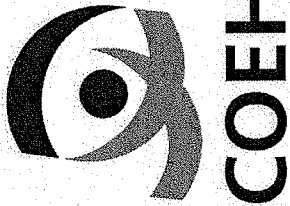

**COEH** CENTER FOR OCCUPATIONAL  
& ENVIRONMENTAL HEALTH

University of California Berkeley



This certifies that

*William Esparza*

has attended the eight hour course

**AHERA Refresher for Asbestos Inspectors & Management**

**Planners**

and has completed the requisite training for asbestos accreditation under TSCA Title II

February 5, 2007

Course Date

*John R. Schum*

COEH Director

Date of Exam: February 5, 2007

Expiration Date: February 5, 2008

*Barbara A. Plog*

Continuing Education Director

Certificate Number: BIMP305

Cal/OSHA Approval Number: CA-002-06 / CA-002-08

Center for Occupational and Environmental Health Continuing Education Program

UC Berkeley Mailcode 5120, 2223 Fulton Street, 2nd Floor, Berkeley, CA 94720-5120 Ph: (510) 643-7277 Fax: (510) 643-7291



**National Voluntary  
Laboratory Accreditation Program**



**SCOPE OF ACCREDITATION TO ISO/IEC 17025:1999**

**ASBESTECH**

6825 Fair Oaks Blvd., Suite 103

Carmichael, CA 95608

Mr. Tommy Conlon

Phone: 916-481-8902 Fax: 916-481-3975

E-Mail: [tgconlonesq@cs.com](mailto:tgconlonesq@cs.com)

URL: <http://www.asbestechlab.com>

**BULK ASBESTOS FIBER ANALYSIS (PLM)**

**NVLAP LAB CODE 101442-0**

***NVLAP Code    Designation / Description***

18/A01            EPA-600/M4-82-020: Interim Method for the Determination of Asbestos in Bulk Insulation Samples

2006-07-01 through 2007-06-30

*Effective dates*

*Sally S. Bruce*

For the National Institute of Standards and Technology

United States Department of Commerce  
National Institute of Standards and Technology

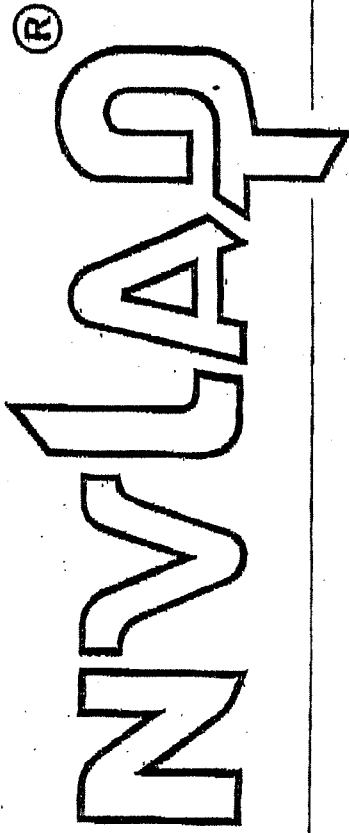

---

## Certificate of Accreditation to ISO/IEC 17025:1999

---

NVLAP LAB CODE: 101442-0

**ASBESTECH**  
Carmichael, CA

is recognized by the National Voluntary Laboratory Accreditation Program for conformance with criteria set forth in  
NIST Handbook 150:2001 and all requirements of ISO/IEC 17025:1999.  
Accreditation is granted for specific services, listed on the Scope of Accreditation, for:

**BULK ASBESTOS FIBER ANALYSIS**

2006-07-01 through 2007-06-30

Effective dates

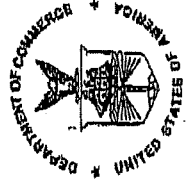

*Dolly A. Bruce*  
For the National Institute of Standards and Technology