

**SIX MONTH SURVEILLANCE
HOMOGENEOUS ACBM RECORDS**

Date of Inspection: 07/07/2006

District: Chico Unified School District

Inspector: Leroy Christophersen

School: Chico Senior High School

Building: A

Material Class	Material	Homo. Mat. #	% Asb.	Ft ² /L.F.	Location	Condition: Code & Comments	Friable Yes/No
M	2' X 4' FCP	1	NONE DETECTED	5,735 S	ADMINISTRATION AREA	(13) SAMPLE HMS-CHS-01 COLLECTED ON 3-28-88.	N/A
M	12" VFT BEIGE	2	TRACE	5,700 S	RECEPTION AREA	(1) (4)	N
M	12" ACT	3	NONE DETECTED	3,550 S	PRINCIPLES OFFICE, COMPTROLLER, DW, AND CLASSROOMS 102-107	(13) SAMPLE HMS-CHS-03 COLLECTED ON 3-28-88.	N/A
T	MUD JOINTS	7	5-10%	20 JOINTS	DARK ROOM ATTIC (CLASSROOM 111)	CANNOT FIND 12/2/04	N
T	MESH WRAP	8	12-20%	½ L	DARK ROOM ATTIC (CLASSROOM 111)	(11) INACCESSIBLE.	N
M	TRANSITE PANELS	95	ASSUMED	1,300 S	ALONG WALKWAYS, JANITORS CLOSETS, RESTROOMS, AND STAIRWELLS	(1) (4)	N

School: Chico Senior High School

Building: A (Unit 200) Upstairs

Material Class	Material	Homo. Mat. #	% Asb.	Ft ² /L.F.	Location	Condition: Code & Comments	Friable Yes/No
M	12" VFT BEIGE	2	TRACE	5,800 S	UPSTAIRS CLASSROOMS	(1) (4)	N
M	2' X 4' FCP	6	NONE DETECTED	10,000 S	UPSTAIRS CLASSROOMS	(13) SAMPLE HMS-CHS-06 COLLECTED ON 3-28-88.	N/A

CONDITION CODE

General Condition: (1) Good (2) Damaged (3) Significantly Damaged (25% or more)

Change in Condition: (4) No (5) Yes (If Yes, explain under comments)

Abated: (6) Repaired (7) Removed (8) Encapsulated (9) Enclosed (10) Isolated & Restricted

Miscellaneous: (11) Inaccessible, no inspection data (12) Other (Explain under comments) (13) Non-Asbestos/Not Inspected

CONSULT ORIGINAL AND SUPPLEMENTARY INSPECTION REPORTS FOR MATERIALS WITH TRACE AMOUNTS OF ASBESTOS

**^SIX MONTH SURVEILLANCE
HOMOGENEOUS ACBM RECORDS**

Date of Inspection: 07/07/2006

District: Chico Unified School District

Inspector: Leroy Christophersen

School: Chico Senior High School

Building: B (Unit 100)

Material Class	Material	Homo. Mat. #	% Asb.	Ft ² /L.F.	Location	Condition: Code & Comments	Friable Yes/No
M	2' X 4' FCP	13	NONE DETECTED	10,000 S	ALL CLASSROOMS	(13) SAMPLE HMS-CHS-13 COLLECTED ON 3-28-88.	N/A
M	12" VFT	14	1-5%	9,430 S	ALL CLASSROOMS	(7) REMOVED AND REPLACED WITH 12" VFT TAN IN JUNE, 2003.	N/A
M	TRANSITE PANELS	95	ASSUMED	1,300 S	ALONG WALKWAYS, JANITORS CLOSETS, RESTROOMS, AND STAIRWAYS	(1) (4)	N
M	12" VFT TAN	152	NON ASBESTOS	9,430 S	THROUGHOUT	(13) LETTER ON FILE 06/2005	N

School: Chico Senior High School

Building: C (Unit 300)

Material Class	Material	Homo. Mat. #	% Asb.	Ft ² /L.F.	Location	Condition: Code & Comments	Friable Yes/No
M	12" VFT	14	1-5%	9,513 S	ALL CLASSROOMS	(7) ABATED IN JUNE, 2003 ACCORDING TO CHICO USD RECORDS.	N
M	TRANSITE PANELS	95	ASSUMED	1,300 S	EXTERIOR OF BUILDING	(1) (4) PANELS PAINTED WHITE 11/19/03.	N
M	12" VFT TAN	150	NON ASBESTOS	9,513 S	ALL CLASSROOMS	(13) LETTER ON FILE 06/2005	N

CONDITION CODE

General Condition: (1) Good (2) Damaged (3) Significantly Damaged (25% or more)

Change in Condition: (4) No (5) Yes (If Yes, explain under comments)

Abated: (6) Repaired (7) Removed (8) Encapsulated (9) Enclosed (10) Isolated & Restricted

Miscellaneous: (11) Inaccessible, no inspection data (12) Other (Explain under comments) (13) Non-Asbestos/Not Inspected

CONSULT ORIGINAL AND SUPPLEMENTARY INSPECTION REPORTS FOR MATERIALS WITH TRACE AMOUNTS OF ASBESTOS

**SIX MONTH SURVEILLANCE
HOMOGENEOUS ACBM RECORDS**

Date of Inspection: 07/07/2006

District: Chico Unified School District

Inspector: Leroy Christophersen

School: Chico Senior High School

Building: D & H (Unit 700 Music & Home EC)

Material Class	Material	Homo. Mat. #	% Asb.	Ft ² /L.F.	Location	Condition: Code & Comments	Friable Yes/No
T	BOILER INSULATION	37	25-35%	48 S	HOME EC & BOILER ROOM	(7)	N/A
S	TROWELED ON CEILING	38	1-5%	300 S	INSTRUMENT STORAGE ROOM & BAND ROOM OFFICE	(1) (4)	N
M	9" VFT YELLOW	39	5-10%	1,410 S	MUSIC WING HALL, CHORAL ROOM UNDER RISERS, BAND ROOM OFFICE, & CHORAL ROOM STORAGE	(7)	N
M	TRANSITE PEG BOARD	41	15-20%	1,000 S	BAND PRACTICE ROOM & CUSTODIAL ROOM	(7) REMOVED ON JUNE, 2003.	N/A
T	PIPEWRAP STRAIGHT	80	75-80%	58 L	HOME EC STORAGE CLOSET	(7) REMOVED ON JUNE, 2003.	N/A
T	PIPEWRAP STRAIGHT	81	75-80%	120 L	2 ND HOME EC STORAGE CLOSET	(7) REMOVED ON JUNE, 2003.	N/A
T	PIPEWRAP CORNER	82	75-80%	>1 EACH	HOME EC STORAGE CLOSET	(7) REMOVED ON JUNE, 2003.	N/A
M	FIRE DOOR	83	25-35%	1 EACH	HOME EC HEATER ROOM	(7) REMOVED ON JUNE, 2003.	N/A

CONDITION CODE

General Condition: (1) Good (2) Damaged (3) Significantly Damaged (25% or more)

Change in Condition: (4) No (5) Yes (If Yes, explain under comments)

Abated: (6) Repaired (7) Removed (8) Encapsulated (9) Enclosed (10) Isolated & Restricted

Miscellaneous: (11) Inaccessible, no inspection data (12) Other (Explain under comments) (13) Non-Asbestos/Not Inspected

CONSULT ORIGINAL AND SUPPLEMENTARY INSPECTION REPORTS FOR MATERIALS WITH TRACE AMOUNTS OF ASBESTOS

**SIX MONTH SURVEILLANCE
HOMOGENEOUS ACBM RECORDS**

Date of Inspection: 07/07/2006

District: Chico Unified School District

Inspector: Leroy Christophersen

School: Chico Senior High School

Building: D & H (Unit 700 Music & Home EC)
(Continued)

Material Class	Material	Homo. Mat. #	% Asb.	Ft ² /L.F.	Location	Condition: Code & Comments	Friable Yes/No
T	PIPEWRAP STRAIGHT	84	5-10%	58 L	HOME EC HEATER ROOM	(7)	N/A
M	HOLDING TANK	94	ASSUMED	72 S	HOME EC HEATER ROOM	(7) REMOVED ON JUNE, 2003.	N/A
T	PIPEWRAP AIRCELL	97	ASSUMED	70 L	UNDER CHORAL RISERS	(7)	N/A
M	TRANSITE PIPE	98	ASSUMED	8 L	HOME EC HEATER ROOM	(7)	N/A
M	12" VFT GREY	100	ASSUMED	810 S	MUSIC WING HALL	(7) REMOVED ON JUNE, 2003 AND REPLACED WITH 12" VFT TAN .	N/A
M	12" VFT TAN	150	NON ASBESTOS	1,200 S	MUSIC WING HALL	(13) LETTER ON FILE 06/2005	N

School: Chico Senior High School

Building: L (Unit 400 Library)

Material Class	Material	Homo. Mat. #	% Asb.	Ft ² /L.F.	Location	Condition: Code & Comments	Friable Yes/No
M	12" VFT	14	1-5%	1,000 S	LIBRARY ENTRY & OFFICE AREA	(7) REMOVED AND REPLACED WITH 12" MOTTLED VFT.	N/A
M	2' X 4' FCP	17	NONE DETECTED	11,155 S	ALL ROOMS	(13) SAMPLE HMS-CHS-17 COLLECTED ON 3-28-88.	N/A
T	MUD JOINTS	19	5-10%	20 JOINTS	LIBRARY ATTIC	(10)	N
M	12" VFT MOTTLED	151	NON ASBESTOS	850 S	LIBRARY ENTRANCE/OFFICE	(13) LETTER ON FILE 06/2005	N

CONDITION CODE

General Condition: (1) Good (2) Damaged (3) Significantly Damaged (25% or more)

Change in Condition: (4) No (5) Yes (If Yes, explain under comments)

Abated: (6) Repaired (7) Removed (8) Encapsulated (9) Enclosed (10) Isolated & Restricted

Miscellaneous: (11) Inaccessible, no inspection data (12) Other (Explain under comments) (13) Non-Asbestos/Not Inspected

CONSULT ORIGINAL AND SUPPLEMENTARY INSPECTION REPORTS FOR MATERIALS WITH TRACE AMOUNTS OF ASBESTOS

**SIX MONTH SURVEILLANCE
HOMOGENEOUS ACBM RECORDS**

Date of Inspection: 07/07/2006

District: Chico Unified School District

Inspector: Leroy Christophersen

School: Chico Senior High School

Building: F (Unit 500)

Material Class	Material	Homo. Mat. #	% Asb.	Ft ² /L.F.	Location	Condition: Code & Comments	Friable Yes/No
T	MUD JOINTS	52	5-10%	125 JOINTS	FINE ARTS	(12) UNABLE TO LOCATE	N
M	2' X 4' FCP	59	NONE DETECTED	4,500 S	ALL CLASSROOMS	(13) SAMPLE HMS-CHS-59 COLLECTED ON 3-28-88.	N/A
T	MUD JOINTS	60	5-10%	12 L	CLASSROOM F-1	(12) UNABLE TO LOCATE	N
M	9" VFT	61	TRACE	4,500 S	ALL CLASSROOMS	(7) REMOVED DURING 2004 MODERNIZATION	N
M	TRANSITE PANELS	95	ASSUMED	150 S	2 KILNS	(7) REMOVED DURING 2004 MODERNIZATION	N
M	KILN BRICK, TAN	151	NONE DETECTED	10.5 S	INSIDE OLDER TRANSITE PANELS ENCASED KILN	(13) SAMPLE HMS-R1303-01A COLLECTED ON 4-13-04.	N/A
M	KILN BRICK, WHITE	152	NONE DETECTED	10.5 S	LARGER OLDER TRANSITE PANEL ENCASED KILN	(13) SAMPLE HMS-R1303-02A COLLECTED ON 4-13-04.	N/A
M	KILN BRICK, WHITE	153	NONE DETECTED	10.5 S	METAL ENCASED CRESS ELECTRIC KILN MODEL A-22-H	(13) SAMPLE HMS-R1303-03A COLLECTED ON 4-13-04.	N/A
M	KILN BRICK	154	NONE DETECTED	10.5 S	SMALL KILN APPROXIMATELY 2' HIGH BY 14" SQUARE WITH B-19 ON SIDE	(13) SAMPLE HMS-R1303-04A COLLECTED ON 4-13-04.	N/A
M	KILN BRICK	155	NONE DETECTED	10.5 S	3' SQUARE KILN	(13) SAMPLE HMS-R1303-05A COLLECTED ON 4-13-04.	N/A
S	STUCCO	156	<1% CHRYSOTILE	220 S	EXTERIOR WALL AT SOUTH SIDE OF CERAMICS LAB ROOM 505	(1) (4) SAMPLE HMS-R1303-06A COLLECTED ON 4-13-04.	N
M	VINYL COVERED TAGBOARD	157	NONE DETECTED	800 S	CERAMICS LAB ROOM 505D	(13) SAMPLE HMS-R1303-07A COLLECTED ON 4-13-04.	N/A

CONDITION CODE

General Condition: (1) Good (2) Damaged (3) Significantly Damaged (25% or more)

Change in Condition: (4) No (5) Yes (If Yes, explain under comments)

Abated: (6) Repaired (7) Removed (8) Encapsulated (9) Enclosed (10) Isolated & Restricted

Miscellaneous: (11) Inaccessible, no inspection data (12) Other (Explain under comments) (13) Non-Asbestos/Not Inspected

CONSULT ORIGINAL AND SUPPLEMENTARY INSPECTION REPORTS FOR MATERIALS WITH TRACE AMOUNTS OF ASBESTOS

**SIX MONTH SURVEILLANCE
HOMOGENEOUS ACBM RECORDS**

Date of Inspection: 07/07/2006

District: Chico Unified School District

Inspector: Leroy Christophersen

School: Chico Senior High School

Building: S (Unit 600 Science)

Material Class	Material	Homo. Mat. #	% Asb.	Ft ² /L.F.	Location	Condition: Code & Comments	Friable Yes/No
M	2' X 4' FCP	22	NONE DETECTED	8,000 S	ALL ROOMS	(13) SAMPLE HMS-CHS-22 COLLECTED ON 3-28-88.	N/A
T	MUD JOINTS	23	5-10%	40 JOINTS	ALL ROOMS	(12) UNABLE TO LOCATE.	N
M	9" VFT	24	1-5%	8,100 S	ALL ROOMS	(7) REMOVED 2004 EXCEPT SCIENCE LAB	N
T	PIPE WRAP STRAIGHT	26	65-70%	12 L	ROOM 5 (STORE ROOM)	(7) REMOVED 2004	N
M	BLACK COUNTER TOPS	99	ASSUMED	UNDETERMINED	IN ALL SCIENCE ROOMS	(7) REMOVED 6/14/04	N

CONDITION CODE

General Condition: (1) Good (2) Damaged (3) Significantly Damaged (25% or more)
Change in Condition: (4) No (5) Yes (If Yes, explain under comments)
Abated: (6) Repaired (7) Removed (8) Encapsulated (9) Enclosed (10) Isolated & Restricted
Miscellaneous: (11) Inaccessible, no inspection data (12) Other (Explain under comments) (13) Non-Asbestos/Not Inspected

CONSULT ORIGINAL AND SUPPLEMENTARY INSPECTION REPORTS FOR MATERIALS WITH TRACE AMOUNTS OF ASBESTOS

**SIX MONTH SURVEILLANCE
HOMOGENEOUS ACBM RECORDS**

Date of Inspection: 07/07/2006

District: Chico Unified School District

Inspector: Leroy Christophersen

School: Chico Senior High School

Building: LH-800 (MPR/KIT)

Material Class	Material	Homo. Mat. #	% Asb.	Ft ² /L.F.	Location	Condition: Code & Comments	Friable Yes/No
T	PIPEWRAP STRAIGHT	45	35-40%	3 L	CUSTODIAL ROOM & RESTROOMS	(1) (4)	N
T	MUD JOINTS	52	5-10%	10 EACH	UNDER STAGE	(1) (4)	N
M	9" VFT GREY	55	1-5%	6,800 S	KITCHEN & MPR	(2) MISSING & CRACKED IN KITCHEN	N
S	TROWELED ON CEILING	57	1-5%	900 S	ALL ROOMS	(1) (5) WATER STAINED	N
M	TRANSITE PANELS	95	ASSUMED	364 S	SNACK BAR, STAGE, AND CAFE	(12) CANNOT LOCATE	N
M	9" VFT	101	ASSUMED	250 S	UNDER STAGE	(1) (4)	N
T	MUD JOINTS	102	5-10%	10 EACH	TEACHER'S LOUNGE RESTROOMS	(1) (4)	N
M	TRANSITE PIPE	103	ASSUMED	12 L	WATER HEATER ROOM (2 PIPES)	(1) (4)	N
M	12" VFT BEIGE		NON-DETECT		KITCHEN DISWASHER	(2) (12) CUSD SAMPLE CHS01 DATED 6/30/06	N/A

CONDITION CODE

General Condition: (1) Good (2) Damaged (3) Significantly Damaged (25% or more)

Change in Condition: (4) No (5) Yes (If Yes, explain under comments)

Abated: (6) Repaired (7) Removed (8) Encapsulated (9) Enclosed (10) Isolated & Restricted

Miscellaneous: (11) Inaccessible, no inspection data (12) Other (Explain under comments) (13) Non-Asbestos/Not Inspected

CONSULT ORIGINAL AND SUPPLEMENTARY INSPECTION REPORTS FOR MATERIALS WITH TRACE AMOUNTS OF ASBESTOS

**SIX MONTH SURVEILLANCE
HOMOGENEOUS ACBM RECORDS**

Date of Inspection: 07/07/2006

District: Chico Unified School District

Inspector: Leroy Christophersen

School: Chico Senior High School

Building: 900 GYM

Material Class	Material	Homo. Mat. #	% Asb.	Ft ² /L.F.	Location	Condition: Code & Comments	Friable Yes/No
S	WALLS & CEILING PLASTER	46	NONE DETECTED	2,000 S	ALL ROOMS EXCEPT BOILER	(13) SAMPLE HMS-CHS-46A-C COLLECTED ON 3-28-88. ADDITIONAL SAMPLES HMS-93103-03A-C COLLECTED ON 7-8-93.	N/A
T	PIPEWRAP STRAIGHT	50	50-55%	2,700 S	GIRL'S & BOY'S LOCKER ROOM AND BOILER ROOM CRAWL SPACE	(12) CANNOT LOCATE	N

CONDITION CODE

General Condition: (1) Good (2) Damaged (3) Significantly Damaged (25% or more)

Change in Condition: (4) No (5) Yes (If Yes, explain under comments)

Abated: (6) Repaired (7) Removed (8) Encapsulated (9) Enclosed (10) Isolated & Restricted

Miscellaneous: (11) Inaccessible, no inspection data (12) Other (Explain under comments) (13) Non-Asbestos/Not Inspected

CONSULT ORIGINAL AND SUPPLEMENTARY INSPECTION REPORTS FOR MATERIALS WITH TRACE AMOUNTS OF ASBESTOS

**SIX MONTH SURVEILLANCE
HOMOGENEOUS ACBM RECORDS**

Date of Inspection: 07/07/2006

District: Chico Unified School District

Inspector: Leroy Christophersen

School: Chico Senior High School

Building: IT-1000

Material Class	Material	Homo. Mat. #	% Asb.	Ft ² /L.F.	Location	Condition: Code & Comments	Friable Yes/No
T	PIPEWRAP STRAIGHT	45	35-40%	700 L	AUTO SHOP, LOFT, AND WOOD SHOP	(7) REMOVED IN 2004	N
T	BREECHING INSULATION	90	15-20% AMOSITE	100 S	WOOD FINISHING ROOM	(7) REMOVED IN 2004	N
M	9" VFT TAN	152	ASSUMED	1,800 S	HALLWAYS AND CLASSROOMS IT2 & IT6	(7) REMOVED IN 2004	N
M	DRYWALL & JOINT COMPOUND	158	<1% CHRYSOTILE (COMPOSITE)	400 S	NORTH & SOUTH WALL OF PROJECT AND HAM ROOMS OFF ELECTRONICS, SOUTH WEST CORNER WALL OF NORTH OFFICE BY RESTROOMS, OFFICE BY TOILET ROOM TO MECHANICAL DRAWING, AND FINISH ROOM	(7) REMOVED IN 2004	N
M	WHITE DOOR INSULATION	159	10-15% CHRYSOTILE 10-15% AMOSITE	40 S	PROJECT AND HAM ROOM	(7) REMOVED IN 2004	N
S	UPPER WALL PLASTER	165	NONE DETECTED	UNDETERMINED	TOILET ROOM	(7) REMOVED IN 2004	N/A

CONDITION CODE

General Condition: (1) Good (2) Damaged (3) Significantly Damaged (25% or more)

Change in Condition: (4) No (5) Yes (If Yes, explain under comments)

Abated: (6) Repaired (7) Removed (8) Encapsulated (9) Enclosed (10) Isolated & Restricted

Miscellaneous: (11) Inaccessible, no inspection data (12) Other (Explain under comments) (13) Non-Asbestos/Not Inspected

CONSULT ORIGINAL AND SUPPLEMENTARY INSPECTION REPORTS FOR MATERIALS WITH TRACE AMOUNTS OF ASBESTOS

**SIX MONTH SURVEILLANCE
HOMOGENEOUS ACBM RECORDS**

Date of Inspection: 07/07/2006

District: Chico Unified School District

Inspector: Leroy Christophersen

School: Chico Senior High School

Building: AG-1100

Material Class	Material	Homo Mat. #	% Asb.	Ft ² /L.F.	Location	Condition: Code & Comments	Friable Yes/No
S	WALL PLASTER	46	1-5%	950 S	AG CLASSROOM 2 (SPACE 3)	(1) (4)	N
M	TRANSITE PANELS	48	15-20%	200 S	AG SHOP WELD BOOTHS & TABLES	(7) REMOVED 2004 MODERNIZATION	N
M	12" VFT MOTTLED & YELLOW MASTIC	89	NONE DETECTED	400 S	CLASSROOM 2	(13) REPRESENTED BY SAMPLE HMS-R1303-12A COLLECTED ON 4-13-04.	N
M	TRANSITE PIPES	96	ASSUMED	12 L	AG SHOP (2 PIPES)	(7) REMOVED 2004	N
M	WALL PLASTER	160	NONE DETECTED	150 S	SOUTH WEST CORNER AREA BY DOOR OF TOILET ROOM OF CLASSROOM 1	(13) SAMPLE HMS-R1303-15A COLLECTED ON 4-13-04.	N/A
S	STUCCO	161	NONE DETECTED	UNDETERMINED	EXTERIOR SOUTH ENTRY DOOR AND EAST WALL BY COKE MACHINE	(13) SAMPLES HMS-R1303-16A & B COLLECTED ON 4-13-04.	N/A
M	LINOLEUM LIKE COUNTER TOP W/ASPHALT LIKE BACKING - GREEN	162	NONE DETECTED	UNDETERMINED	AG-2 - CLASSROOM 3	(13) SAMPLE HMS-R1303-17A COLLECTED ON 4-13-04.	N/A
M	BROWN COLORED GLOSS LIKE FLOOR FINISH	163	NONE DETECTED	UNDETERMINED	HALLWAY BY CLASSROOM 2	(13) SAMPLE HMS-R1303-13A COLLECTED ON 4-13-04.	N/A
M	GREEN COLORED GLOSS LIKE FLOOR FINISH	164	NONE DETECTED	UNDETERMINED	TOILET ROOM OFF AG SHOP CLASSROOM 1	(13) SAMPLE HMS-R1303-14A COLLECTED ON 4-13-04.	N/A

CONDITION CODE

General Condition: (1) Good (2) Damaged (3) Significantly Damaged (25% or more)

Change in Condition: (4) No (5) Yes (If Yes, explain under comments)

Abated: (6) Repaired (7) Removed (8) Encapsulated (9) Enclosed (10) Isolated & Restricted

Miscellaneous: (11) Inaccessible, no inspection data (12) Other (Explain under comments) (13) Non-Asbestos/Not Inspected

CONSULT ORIGINAL AND SUPPLEMENTARY INSPECTION REPORTS FOR MATERIALS WITH TRACE AMOUNTS OF ASBESTOS

**SIX MONTH SURVEILLANCE
HOMOGENEOUS ACBM RECORDS**

Date of Inspection: 07/07/2006

District: Chico Unified School District

Inspector: Leroy Christophersen

School: Chico Senior High School

Building: 20 Portable Classrooms and 2 Portable Restrooms on West Campus

Material Class	Material	Homo. Mat. #	% Asb.	Ft ² /L.F.	Location	Condition: Code & Comments	Friable Yes/No
					20 PORTABLE CLASSROOMS AND 2 PORTABLE RESTROOMS	DISTRICT CERTIFICATION REQUIRED  (LETTERS ON FILE)	

CONDITION CODE

General Condition: (1) Good (2) Damaged (3) Significantly Damaged (25% or more)

Change in Condition: (4) No (5) Yes (If Yes, explain under comments)

Abated: (6) Repaired (7) Removed (8) Encapsulated (9) Enclosed (10) Isolated & Restricted

Miscellaneous: (11) Inaccessible, no inspection data (12) Other (Explain under comments) (13) Non-Asbestos/Not Inspected

CONSULT ORIGINAL AND SUPPLEMENTARY INSPECTION REPORTS FOR MATERIALS WITH TRACE AMOUNTS OF ASBESTOS



Bulk Asbestos Analysis

(EPA Method 600/R-93-116, Visual Area Estimation)

Chico Unified School Dist
Leroy Christophersen

2455 Carmichael Drive
Chico, CA 95928

Client ID: 2921
Report Number: B087311
Date Received: 06/30/06
Date Analyzed: 07/03/06
Date Printed: 07/03/06
First Reported: 07/03/06

Job ID/Site: Chico High School - PO# 050289

FASI Job ID: 2921

Date(s) Collected: 06/29/2006

Total Samples Submitted: 1

Total Samples Analyzed: 1

Sample ID	Lab Number	Asbestos Type	Percent in Layer	Asbestos Type	Percent in Layer	Asbestos Type	Percent in Layer
CHS01	10537595						
Layer: Beige Tile				ND			
Layer: Yellow Mastic				ND			
Total Composite Values of Fibrous Components:		Asbestos (ND)					
Cellulose (Trace)							

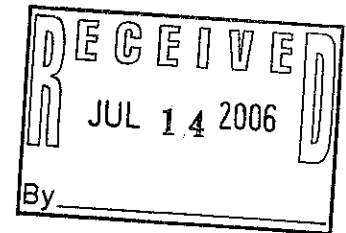

James Flores, Laboratory Supervisor, Hayward Laboratory

Note: Limit of Quantification ('LOQ') = 1%. 'Trace' denotes the presence of asbestos below the LOQ. 'ND' = 'None Detected'.

Analytical results and reports are generated by Forensic Analytical at the request of and for the exclusive use of the person or entity (client) named on such report. Results, reports or copies of same will not be released by Forensic Analytical to any third party without prior written request from client. This report applies only to the sample(s) tested. Supporting laboratory documentation is available upon request. This report must not be reproduced except in full, unless approved by Forensic Analytical. The client is solely responsible for the use and interpretation of test results and reports requested from Forensic Analytical. This report must not be used by the client to claim product endorsement by NVLAP or any other agency of the U.S. Government. Forensic Analytical is not able to assess the degree of hazard resulting from materials analyzed. Forensic Analytical reserves the right to dispose of all samples after a period of thirty (30) days, according to all state and federal guidelines, unless otherwise specified. All samples were received in acceptable condition unless otherwise noted.

2921



Forensic Analytical

Analysis Request Form

Client Name & Address: Chico Unified School District <hr/> 2455 Carmichael Drive <hr/> Chico, CA 95928	P.O. #: 050289 Date: 6/29/06 <hr/> Turn Around Time: _____ hr/ 12hr <u>24hr</u> 48 hr / ext: _____ <hr/> Due Date: / / Due Time: : : am/pm <input checked="" type="checkbox"/> PCM: <input checked="" type="checkbox"/> Standard / <input type="checkbox"/> Point Count <input type="checkbox"/> PCM: NIOSH 7400
Contact: Leroy Christophersen <hr/> Phone #: 530-891-3195 <hr/> Fax#: (530) 891-3190	<input type="checkbox"/> TEM Air: <input type="checkbox"/> AHERA / <input type="checkbox"/> Yamate2 / <input type="checkbox"/> NIOSH 7402 <input type="checkbox"/> TEM Bulk: <input type="checkbox"/> Quantitative / <input type="checkbox"/> Qualitative / <input type="checkbox"/> Chatfield <input type="checkbox"/> TEM Water: <input type="checkbox"/> Potable / <input type="checkbox"/> Non-Potable / <input type="checkbox"/> Wt % <input type="checkbox"/> TEM Microvac <input type="checkbox"/> Special Project:
Site: Chico High School <hr/> Job:	<input type="checkbox"/> Metals Analysis: Method _____ <hr/> Matrix: _____ <hr/> Analytes: _____

Comments:

Sample ID	Date/Time	Sample Location/Description	FOR AIR SAMPLES ONLY				Sample Area or Air Volume
			Type	Time On/Off	Avg. LPM	Total Time	
CHS 01	6/29	UNDER DISH WASHER / Beige & white	A P C				
			A P C				
			A P C				
			A P C				
			A P C				
			A P C				
			A P C				
			A P C				
			A P C				

Sampled by: Leroy Date: 6/29/06 Time: 8:30AM
 Shipped via: Fed Ex Airborne UPS US Mail Courier Drop Off Other:

Relinquished by: Date / Time:	Relinquished by: Date / Time:	Relinquished by: Date / Time:
--------------------------------------	--------------------------------------	--------------------------------------

Received by: <u>Nicole IAWORN</u> Date / Time: <u>06-30-06 10:43AM</u> Condition Acceptable? <input checked="" type="checkbox"/> Yes <input type="checkbox"/> No	Received by: Date / Time: Condition Acceptable? <input type="checkbox"/> Yes <input type="checkbox"/> No	Received by: Date / Time: Condition Acceptable? <input type="checkbox"/> Yes <input type="checkbox"/> No
--	--	--

EXISTING (1-A)
 BASIC PLANS (2-A)
 FINAL PLANS (3-A)

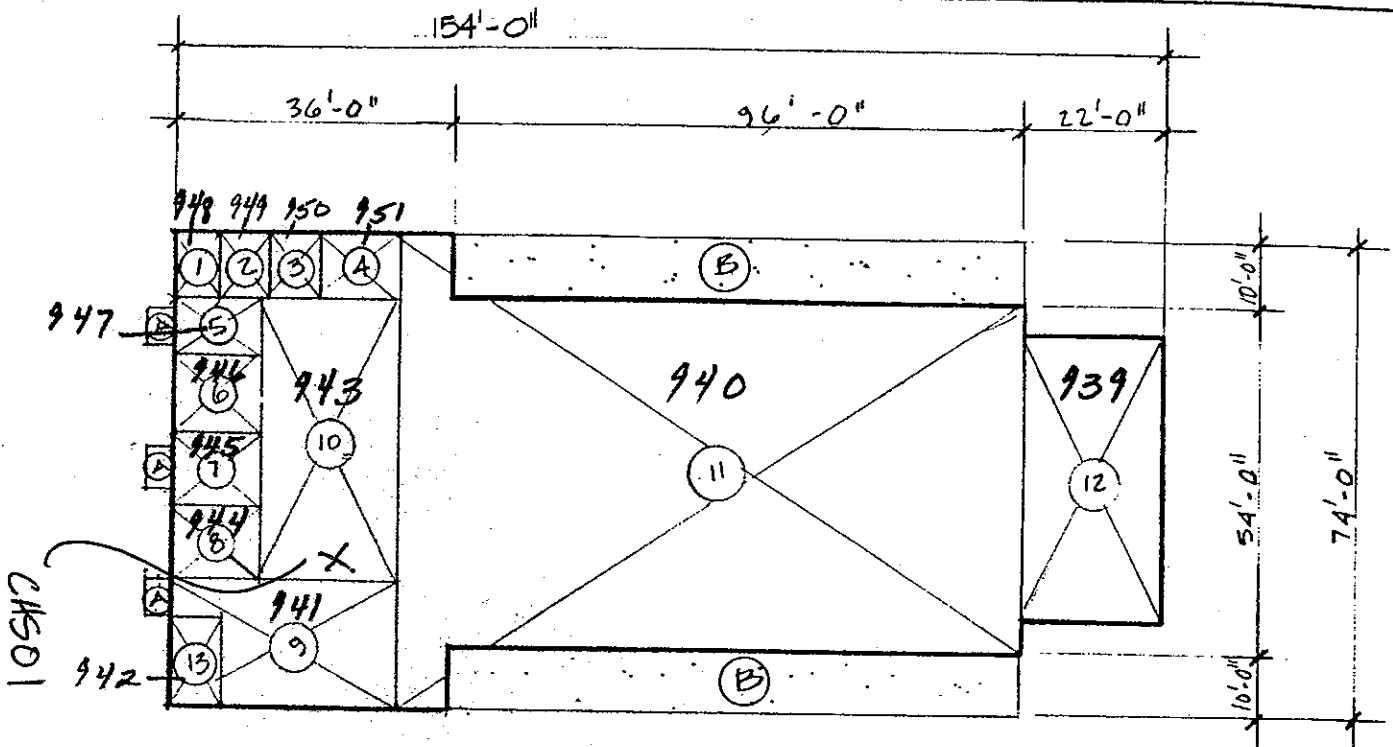

UNIT ^{LH} "800"
 1" = 30'-0"

1. GARBAGE	—	10° x 6°	=	65.0
2. OFFICE	—	10° x 82	=	81.2
3. COLD BOX	—	10° x 8°	=	80.0
4. SNACK BAR	—	10° x 134	=	133.3
5. RECEIVING	—	14° x 94	=	130.7
6. STORAGE	—	14° x 122	=	170.2
7. BOILER	—	14° x 11°	=	154.0
8. TOILET	—	14° x 116	=	161.0
9. TEACHER'S DIN.	—	(28° x 20°) - 112	=	448.0
10. KITCHEN	—	44° x 14°	=	616.0
11. CAFETERIA	—	(104° x 54°) + (8° x 20°)	=	5776.0
12. PLATFORM	—	22° x 44°	=	968.0
13. TOILET	—	8° x 14°	=	112.0
A. COVERED CORR.	—	10° x 3 x 4° x 6°	=	23.76 72
B. " "	—	10° x 2 x 10° x 96°	=	632.60 1920
TOTAL				= 7552.76
				10,887.40

Maintenance and Operations
2455 Carmichael Drive
Chico, CA 95928
Phone: (530) 891-3195
Fax: (530) 891-3190

Chico Unified School District

Fed Ex Airbill #8358 1795 1054

June 29, 2006

Forensic Analytical Specialties, Inc.
3777 Depot Road, Suite 409
Hayward, CA 94545

Re: Chico Senior High School

To Whom It May Concern:

Please test the enclosed sample from under the dishwasher in the kitchen at Chico Senior High School for asbestos. We would like a 48-hour turnaround on the sample. Please e-mail the results as soon as they are available to lchristo@chicousd.org.

Site Sampled:	Chico Senior High School
Location:	Kitchen/Dishwasher
Date Sampled:	June 29, 2006
Number of Samples:	One - #CHS01

Thank you for your prompt response to this request.

Sincerely,

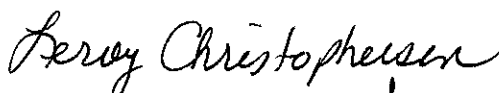

Leroy Christophersen
Safety & Loss Coordinator

Enclosure (1)
dlg



ENTEK CONSULTING GROUP, INC.

4200 Rocklin Road, Suite 7 Rocklin, CA 95677

Telephone (916) 632-6800

Fax (916) 632-6812

February 15, 2006

Mr. Mike Weisenborn, Facilities Planner
Chico Unified School District
2455 Carmichael Drive
Chico, CA 95928

Re: Limited Pre-Renovation Survey for Asbestos-Containing Materials (ACM's) and Lead Containing Paints for the **Elevator Addition Project** to be Conducted at Chico Senior High School, 901 The Esplanade, Chico, CA

Dear Mr. Weisenborn:

This letter reports results of the limited pre-renovation survey for ACM's and lead-containing paint conducted on February 3, 2006, by Entek Consulting Group, Inc. (Entek, Inc.) at the location referenced above. This survey was conducted at your request to inspect and survey suspect materials which may contain asbestos and/or lead, that may be disturbed during the planned elevator addition project. Our understanding is that the elevator is to be added at the southwest stairway of the Administration Building (Building 200), located at Chico Senior High School.

This investigation was limited to sampling of "suspect" materials associated with the stairway which may be disturbed during the renovation, other interior and exterior components of the building were not included in this investigation. Copies of the drawings made in the course of this survey are attached to this report indicating the location of the scheduled renovation work and the general location of samples collected during this inspection.

INSPECTION PROTOCOL

The following inspection process was generally followed by HMS, Inc. at the above mentioned site:

Bulk samples of ceiling plaster, brick and mortar, and built-up roofing were collected. Samples of these suspected ACM's were collected using a ½" copper core and a power drill or hand tools. Sample locations are indicated on the sample submission report and the attached field drawings created during the inspection.

Paint chip samples were collected and tested for lead from painted surfaces of the interior of the stairway and from an exterior bench that may be affected by the renovation. Samples of the paints were collected using a chisel to sample layered material down to the substrate.

The suspect ACM samples were analyzed by polarized light microscopy (PLM) and the paint chip samples were analyzed by flame atomic absorption spectrometry (AA). All sample analysis was performed by Asbestech of Carmichael, CA, a NIST/NVLAP/CA DOHS ELAP accredited laboratory.

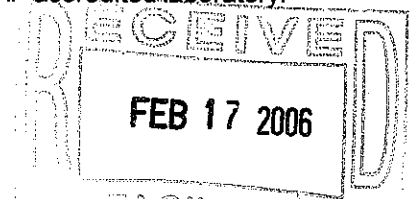



Mr. Mike Weisenborn
Facilities Planner
Chico Unified School District
February 15, 2006
Page 2 of 5

BULK SAMPLE RESULTS - ASBESTOS

A total of four (4) bulk samples were collected of the materials considered to be "suspect asbestos-containing materials" under United States Environmental Protection Agency (US EPA) guidelines. Under current US EPA guidelines for conducting building inspections for ACM, all "suspect" building materials must be **assumed** to contain asbestos until otherwise determined by laboratory testing. Transite panels were visually noted during this investigation above and below the windows of the stairway, this material is assumed to contain asbestos.

The acronyms, if used below, are terms taken from the US EPA Asbestos National Emission Standards for Hazardous Air Pollutants (NESHAP) regulation. RACM stands for Regulated Asbestos Containing Material, CAT-1 & CAT-2 stand for Category I or Category II Non-Friable Asbestos Containing Material respectively. Additionally, if used below, these terms are taken from the Cal-OSHA regulations. ACM stands for Asbestos-Containing Material and ACCM stands for Asbestos-Containing Construction Material.

Suspect Materials Found **NOT TO** Contain Asbestos:

Built-Up Roofing (Found on the Stairway Roof)

Brick & Mortar (Found in Construction of the Interior & Exterior Walls Throughout the Subject Area)

Suspect Materials Found **TO** Contain <1% Asbestos (verified by point count analysis):

Stucco Ceiling Surfacing (Found on Stairway Ceiling)

<1% Chrysotile
NESHAP, N/A
Cal-OSHA, ACCM

Suspect Materials Assumed **TO** Contain >1% Asbestos:

Transite Panels (Found Under & Above Windows in the Stairway)

Assumed
NESHAP, CAT-2
Cal-OSHA, ACM

RECOMMENDATIONS REGARDING ASBESTOS REMOVAL/NOTIFICATION PRIOR TO RENOVATION

US EPA COMPLIANCE

The US EPA NESHAP (40 CFR Part 61 - Nov. 20, 1990) requires materials containing greater than one percent asbestos be removed prior to renovation or demolition of a regulated building if those materials are friable, or likely to become friable due to the forces expected to act upon them during the renovation/demolition. The California Air Resources Board (CARB) has been "delegated" the authority to enforce the NESHAP regulations in Butte County. Additionally, a ten (10) day notification to both EPA Region IX and CARB is required prior to all demolitions, and prior to renovations involving greater than 160 square or 260 linear feet of regulated material.



Mr. Mike Weisenborn
 Facilities Planner
 Chico Unified School District
 February 15, 2006
 Page 3 of 5

The Stucco Ceiling Surfacing material found to <1% asbestos during this investigation is not regulated by EPA Region IX or CARB. The transite panels found on this survey would not be regulated by EPA Region IX or CARB unless they are rendered friable during the renovation.

OSHA COMPLIANCE

Disturbance of any material containing asbestos could generate airborne asbestos fibers and would be regulated by Cal-OSHA. Cal-OSHA worker health and safety regulations apply during any disturbance of material containing asbestos by a person while in the employ of another. This is true regardless of friability, content percentage, or the quantity disturbed. In addition, Cal-OSHA requires contracting firms that remove greater than 100 square feet of ACCM on a work site, be registered with the Division to conduct such work. ACCM is defined as a material containing greater than 0.1% asbestos.

The Stucco Ceiling Surfacing material found to <1% asbestos during this investigation is regulated by Cal-OSHA as an ACCM, the transite panels are regulated as ACM. Therefore, notification, worker protection, and registration requirements would apply to disturbance of these materials.

BULK SAMPLE RESULTS - LEAD

A total of four (4) bulk samples were collected of the materials considered to be "suspect lead-containing materials" under Cal-OSHA regulations. Under current Cal-OSHA guidelines for conducting building inspections for lead, all "suspect" building materials must be **assumed** to contain lead until otherwise determined by laboratory testing.

Paints or Coatings Found **TO** Contain Lead **Below** the Recovery Level <100 ppm:

White Paint on Wood Window Frames	<100 ppm
White Paint on Concrete Pony Walls	<100 ppm

Paints or Coatings Found **TO** Contain Lead **Below** the 5,000 ppm:

Red Paint on Metal "Park Bench" Frame	420 ppm
Red Paint on Wood "Park Bench" Slats	110 ppm

RECOMMENDATIONS REGARDING LEAD

The various definitions of lead in paint should be discussed to assist in the interpretation of the report.

HUD Guidelines Definition

HUD defines LBP as "any varnish, paint, stain, or other applied coating that has 1.0 milligrams per square centimeter (mg/cm²), or 5,000 micrograms per gram (µg/g) by dry weight or more of lead." The terms "leaded paint" and "lead-containing paint" are synonymous with "lead-based paint". 5,000 µg/g is equivalent to 5,000 parts per million (ppm), and equivalent to 0.50% by weight.



Mr. Mike Weisenborn
Facilities Planner
Chico Unified School District
February 15, 2006
Page 4 of 5

RECOMMENDATIONS REGARDING LEAD (continued)

Consumer Products Safety Commission (CPSC) Definition

In 1978, the CPSC defined lead-paint as that having greater than 0.06% (600 ppm), with restrictions of use for residential housing, toys, and furniture.

California Occupational Safety and Health Administration (Cal/OSHA)

Currently, Cal/OSHA has not established a definition for LBP, nor have they established minimum concentrations where their regulations do not apply. Cal/OSHA regulates all construction activities involving materials containing lead, including LBP. These regulations are found in Title 8 Section 1532.1. Since Cal/OSHA has not established a concentration of lead in paint where their regulations do not apply, any disturbance to products containing lead come under the jurisdiction of Cal/OSHA requirements.

Cal/OSHA Pre-Job Notification is required when any of the trigger tasks listed in subsection (d)(2) are to be conducted **and** the amount of material to be disturbed equals or exceeds 100 square or linear feet **and** this material contains 5,000 ppm/1.0 mg/cm² lead or more. These notifications must be made to the nearest Division District Office 24 hours in advance of the work by letter, facsimile, electronic mail, or telephone followed by written notification within 24 hours of placing the call. The required content of, and exceptions to these notifications may, be found in subsections (p)(1) through (p)(4) of the regulation.

It is important to keep in mind that although the HUD Guideline uses a criteria of 5,000 ppm or 1.0 mg/cm², there still may be lead present in those coatings reported as negative, in which case the Cal/OSHA regulations would apply.

California Environmental Protection Agency (Cal/EPA)

Cal/EPA has requirements for disposal of lead, including lead in paint on building components. Generally, if the paint is loose and peeling on an architectural component to be removed, the paint chips must be separated and handled as a hazardous waste material if the concentration of lead in the paint is greater than 1,000 ppm, or the equivalent in milligrams/kilograms (mg/kg) by the SW 846 Method. The separated paint chips are also considered a hazardous waste if the Soluble Threshold Limit Concentration (STLC) is greater than 5 milligrams of lead per liter (mg/L). Waste streams found to contain lead concentrations of less than 1,000 ppm but greater than 350 ppm are not hazardous waste in California, although this material must be disposed of at a Class 1 hazardous waste landfill permitted to accept such waste. The requirements for hazardous waste manifesting and utilization of a registered hazardous waste hauler do not apply to these wastes.

The paints sampled during this investigation associated with the stairway were found to contain lead at less than the detection limit of 100 ppm, as such the lead regulations would not apply to work involving the stairway structure. The regulations would apply to work involving the red bench, if the bench is not removed essentially intact.



Mr. Mike Weisenborn
Facilities Planner
Chico Unified School District
February 15, 2006
Page 5 of 5

DISCLAIMERS

This survey included only minor destructive sampling, it is possible other materials exist which may be impacted in the future. Any materials not listed in this report which are encountered during renovation should be tested prior to impact by a non-abatement contractor. The general contractor selected for this project should be advised to contact the representative for the District immediately upon discovery of any new material which will be impacted during the renovation project, which has not been previously tested or is considered a "suspect" material for asbestos or lead.

It has been our pleasure working with you on this investigation. If you desire any further services or have questions please call at (916) 632-6800.

Sincerely,

A handwritten signature in black ink, appearing to read "R. C. Howell".

Robert C. Howell
Senior Project Manager
Certified Asbestos Consultant
DOSH #92-0849
Lead Inspector/Assessor
DHS #2340

Enclosures



ENTEK CONSULTING GROUP, INC.

4200 Rocklin Road, Suite 7 Rocklin, CA 95677 Telephone (916) 632-6800 Fax (916) 632-6812

BULK MATERIAL Analysis Report Form for Entek Consulting Group, Inc.

4200 Rocklin Road, Suite 7
Rocklin, CA 95677
(916) 632-6800
FAX (916) 632-6821

JOB ID.: ECG-06-065 **CLIENT:** Chico Unified School District

COLLECTED BY: Robert Howell

DATE COLLECTED: 02/03/06

DATE REPORTED: 02/07/06

LAB SUBMITTED TO: Asbestech

ANALYSIS PERFORMED: PLM with Dispersion Staining

JOB SITE: Chico Senior High School
901 The Esplanade
Chico, CA

SAMPLE #	RESULTS	MATERIAL DESCRIPTION/LOCATION
ECG-06-065-01A	NONE DETECTED	Built-Up Roofing/Admin Building (Building 200) Southwest Stairwell
ECG-06-065-01B	NONE DETECTED	Built-Up Roofing/Admin Building (Building 200) Southwest Stairwell
ECG-06-065-02A	<1% Chrysotile	Stucco Ceiling Surfacing/ Admin Building (Building 200) 2 nd Floor, Southwest Stairwell
ECG-06-065-03A	NONE DETECTED	Brick & Mortar/Admin Building (Building 200) 1 st Floor Southwest Stairwell

C:\Entek\ECG\Clients\ChicoUSD\BulkAsbReport.wpd

ASBESTECH
6825 Fair Oaks Blvd., Suite 103
Carmichael, California 95608
Tel.(916) 481-8902 Fax (916) 481-3975

Client:

Entek Consulting Group, Inc.
4200 Rocklin Rd., Suite 7
Rocklin, CA 95677

Job:

ECG-06-065 Chico USD
Chico Senior HS
Chico, Ca

BULK ASBESTOS ANALYSIS REPORT

LAB JOB # 47829

Date/Time Collected: 2/3/06

Date Received: 2/6/06

NVLAP # 101442

DOHS # 1153

Date Analyzed: 2/7/06

<u>Sample No.</u>	<u>Color/Description</u>	<u>% Type Asbestos</u>	<u>Other Materials</u>
ECG-06-065-01A	Black built up roofing, admin. bldg. (200) SW stairwell	NONE DETECTED	Tar Binder Cellulose
01B	Black built up roofing, admin. bldg. (200) SW stairwell	NONE DETECTED	Tar Binder Fibrous Glass
02A	White stucco ceiling surfacing, admin. bldg. (200) 2 nd floor SW stairwell	<1 CHRYSOTILE	Granular Mins.
03A	Red brick, admin. bldg. (200) 1st floor SW stairwell	NONE DETECTED	Granular Mins.
	Gray mortar	NONE DETECTED	Granular Mins.

THE ANALYSIS USES POLARIZED LIGHT MICROSCOPY AND DISPERSION STAINING FOLLOWING E.P.A. METHOD 600/R-93/116. NON-FRIABLE MATERIALS WERE ANALYZED APPLYING THE SAME METHOD. THE LOWER DETECTION LIMIT IS <1 % WITH THE PROVISIO THAT PLM MAY NOT DETECT FIBERS <0.25 MICRONS IN DIAMETER THAT MAY BE PRESENT IN SAMPLES SUCH AS FLOOR TILES. IN ACCORDANCE WITH TITLE 22, CCR, SECTION 66261.24(a)(2)(A), THE MCL IS 1 %. SAMPLES WERE NOT COLLECTED BY ASBESTECH. THIS REPORT MUST NOT BE REPRODUCED EXCEPT IN FULL WITHOUT THE APPROVAL OF ASBESTECH. THIS REPORT RELATES ONLY TO THE ITEMS TESTED. THIS REPORT MUST NOT BE USED TO CLAIM PRODUCT ENDORSEMENT BY N.V.L.A.P. OR ANY AGENCY OF THE U.S. GOVERNMENT. ASBESTECH ACCEPTS TECHNICAL RESPONSIBILITY FOR THIS REPORT AND DATE OF ISSUE.

NVLAP

ANALYST SIGNATURE:



ASBESTECH
6825 Fair Oaks Blvd., Suite 103
Carmichael, California 95608
Tel.(916) 481-8902 Fax (916) 481-3975

Client:

Entek Consulting Group, Inc.
4200 Rocklin Rd., Suite 7
Rocklin, CA 95677

Job:

ECG-06-065 Chico USD
Chico Senior HS
Chico, Ca

BULK ASBESTOS ANALYSIS REPORT

LAB JOB # 47883

Date/Time Collected: 2/3/06

Date Received: 2/6/06

NVLAP # 101442

DOHS # 1153

Date Analyzed: 2/15/06

<u>Sample No.</u>	<u>Color/Description</u>	<u>% Type Asbestos</u>	<u>Other Materials</u>
ECG-06-065-02A	White stucco ceiling surfacing, admin. bldg. (200) 2 nd floor SW stairwell	<1 CHRYOSOTILE	Granular Mins.

NOTE: This sample was analyzed by quantitative Point Counting using a Chalkley Point Array over 400 non-empty points.

THE ANALYSIS USES POLARIZED LIGHT MICROSCOPY AND DISPERSION STAINING FOLLOWING E.P.A. METHOD 600/R-93/116. NON-FRIABLE MATERIALS WERE ANALYZED APPLYING THE SAME METHOD, THE LOWER DETECTION LIMIT IS <1 % WITH THE PROVISION THAT PLM MAY NOT DETECT FIBERS <0.25 MICRONS IN DIAMETER THAT MAY BE PRESENT IN SAMPLER SUCH AS FLOOR TILES, IN ACCORDANCE WITH TITLE 22, CCR, SECTION 66261.24(h)(2)(A), THE MCL IS 1 %. SAMPLES WERE NOT COLLECTED BY ASBESTECH, THIS REPORT MUST NOT BE REPRODUCED EXCEPT IN FULL WITHOUT THE APPROVAL OF ASBESTECH. THIS REPORT RELATES ONLY TO THE ITEMS TESTED. THIS REPORT MUST NOT BE USED TO CLAIM PRODUCT ENDORSEMENT BY N.V.L.A.P. OR ANY AGENCY OF THE U.S. GOVERNMENT, ASBESTECH ACCEPTS TECHNICAL RESPONSIBILITY FOR THIS REPORT AND DATE OF ISSUE.

NVLAP

ANALYST SIGNATURE: _____





BULK ASBESTOS MATERIAL Analysis Request Form for Entek Consulting Group, Inc.

4200 ROCKLIN ROAD, STE. 7
ROCKLIN, CA 95677
(916) 632-6800
FAX (916) 632-6812

JOB I.D.: ECG-06-065 **CLIENT:** Chico Unified School District **COLLECTED BY:** Robert Howell

DATE COLLECTED: 02/03/06 **DATE SUBMITTED:** 02/06/06 **LAB SUBMITTED TO:** Asbestech

SPECIAL INSTRUCTIONS: Please FAX the Written Report when Available.

ANALYSIS REQUESTED: PLM with Dispersion Staining **TURNAROUND TIME:** 24 Hr.

JOB SITE: Chico Senior High School
901 The Esplanade
Chico, CA

SAMPLE #	MATERIAL DESCRIPTION/LOCATION
ECG-06-065-01A	Built-Up Roofing/Admin Building (Building 200) Southwest Stairwell
ECG-06-065-01B	Built-Up Roofing/Admin Building (Building 200) Southwest Stairwell
ECG-06-065-02A	Stucco Ceiling Surfacing/ Admin Building (Building 200) 2 nd Floor, Southwest Stairwell
ECG-06-065-03A	Brick & Mortar/Admin Building (Building 200) 1 st Floor Southwest Stairwell

C:\Entek\ECG\Clients\ChicoUSD\BulkReq020306.wpd

DELIVERED BY: 

DATE: 2/6/06

RECEIVED BY: 

DATE: 2-6-06



TEK, INC.
36326812
Feb-14-2006 4:49PM

Fax Call Report

Job	Date	Time	Type	Identification	Duration	Pages	Result
496	2/14/2006	4:48:28PM	Send	481-3975	1:01	1	OK

02/07/2006 15:34 9164813975 ASBESTECH PAGE 01/01

ASBESTECH
6825 Fair Oaks Blvd., Suite 103
Carmichael, California 95608
Tel.(916) 481-8902 Fax (916) 481-3975

<i>Client:</i> Entek Consulting Group, Inc. 4200 Rocklin Rd., Suite 7 Rocklin, CA 95677	<i>Job:</i> ECO-06-065 Chico USD Chico Sanfor HS Chico, CA
--	---

BULK ASBESTOS ANALYSIS REPORT

LAB JOB # 47829
Date/Time Collected: 2/3/06
Date Received: 2/6/06
MVLAP # 101442
DOHS # 1153
Date Analyzed: 2/7/06

Sample No.	Color/Description	% Type Asbestos	Other Material
ECO-06-065-01A	Black built up roofing, admin. bldg. (200) SW stairwell	NONE DETECTED	Tar Binder Cellulose
01B	Black built up roofing, admin. bldg. (200) SW stairwell	NONE DETECTED	Tar Binder Fibrous Glass
02A	White stucco ceiling surfacing, admin. bldg. (200) 2 nd floor SW stairwell	<1 CHRYSOTILE	Granular Mins.
03A	Red brick, admin. bldg. (200) 1st floor SW stairwell	NONE DETECTED	Granular Mins.
	Gray mortar	NONE DETECTED	Granular Mins.

PLEASE PERFORM POINT COUNT ANALYSIS FOR SAMPLE 02A.

RE ML
2/14/06

THE ANALYSIS USED POLARIZED LIGHT MICROSCOPY AND SEMI-QUANTITATIVE ANALYSIS FOLLOWING EPA METHOD 8460A.11. NON-FIBRIL MATERIALS WERE ANALYZED APPLYING THE SAME METHOD. THE LOWER DETECTION LIMIT IS FOR THE METHOD THAT CAN ONLY DETECT FIBRILS <11 MICRONS IN DIAMETER. THEY MAY BE PRESENT IN A MORE SUCCINIFORM STATE. IN ACCORDANCE WITH PUBLIC LAW 101, SECTION 102, ANALYSIS OF THE FOLLOWING SAMPLES WERE NOT COLLECTED BY ASBESTECH. THIS REPORT MUST NOT BE REPRODUCED EXCEPT BY FAX, WITHOUT THE APPROVAL OF ASBESTECH. THIS REPORT RELATES ONLY TO THE ITEMS TESTED. THIS REPORT MUST NOT BE USED TO CLAIM PRODUCTS ENDOREMENT BY MVLAP OR ANY AGENCY OF THE U.S. GOVERNMENT. ASBESTECH ACCEPTS TECHNICAL RESPONSIBILITY FOR THIS REPORT AND DATE OF ISSUE.

MVLAP

ANALYST SIGNATURE: *[Signature]*



ENTEK CONSULTING GROUP, INC.

4200 Rocklin Road, Suite 7 Rocklin, CA 95677 Telephone (916) 632-6800 Fax (916) 632-6812

BULK MATERIAL Analysis Report Form for Entek Consulting Group, Inc.

4200 Rocklin Road, Suite 7
Rocklin, CA 95677
(916) 632-6800
FAX (916) 632-6821

JOB I.D.: ECG-06-065 **CLIENT:** Chico Unified School District **COLLECTED BY:** Robert Howell

DATE COLLECTED: 02/03/06 **DATE REPORTED:** 02/07/06 **LAB SUBMITTED TO:** Asbestech

ANALYSIS PERFORMED: AA-Lead Paint Chip

JOB SITE: Chico Senior High School
901 The Esplanade
Chico, CA

SAMPLE #	LEAD RESULTS PPM/ WT%	MATERIAL DESCRIPTION/LOCATION
ECG-06-065-01Pb	<100/ <0.01%	White Paint/on Wood Window Frame in Admin Building (Building 200) 2 nd Floor, Southwest Stairwell
ECG-06-065-02Pb	<100/ <0.01%	White Paint/on Concrete Pony Wall in Admin Building (Building 200) 2 nd Floor, Southwest Stairwell
ECG-06-065-03Pb	420/ 0.042%	Red Paint/on Metal Bench Frame, Outside Admin Building (Building 200) Southwest Stairwell
ECG-06-065-04Pb	110/ 0.011%	Red Paint/on Wood Bench Backrest, Outside Admin Building (Building 200) Southwest Stairwell

C:\Entek\ECG\Clients\ChicoUSD\BulkReportPb1.wpd

ASBESTECH
6825 Fair Oaks Blvd., Suite 103
Carmichael, California 95608
Tel (916) 481-8902
Fax (916) 481-3975

FLAME ATOMIC ABSORPTION SPECTROMETRY
LEAD (Pb) IN PAINT SAMPLES
METHOD SW846-3050B-7420

CLIENT:
Entek Consulting Group, Inc.
4200 Rocklin Rd., Suite 7
Rocklin, CA 95677

CA DOHS ELAP#1153
ELPAT#101801

JOB I.D.: ECG-06-065 Chico USD, Chico Senior HS,
Chico, Ca

DATE RECEIVED: 2/6/06

LAB JOB NO: 6513

DATE ANALYZED: 2/7/06

DATE REPORTED: 2/7/06

SAMPLE DATE	SAMPLE NUMBER	DESCRIPTION	PPM	RESULT IN WT%	RL	Q.C. BATCH
2/3/06	ECG-06-065-01Pb	White paint on wood window frame in admin. bldg. (200) 2 nd floor SW stairwell	<100	<0.010	0.010%	26
2/3/06	ECG-06-065-02Pb	White paint on concrete pony wall in admin. bldg. (200) 2 nd floor SW stairwell	<100	<0.010	0.010%	26
2/3/06	ECG-06-065-03Pb	Red paint on metal bench frame outside admin. bldg. (200) SW stairwell	420	0.042	0.010%	26
2/3/06	ECG-06-065-04Pb	Red paint on wood bench backrest outside admin. bldg. (200) SW stairwell	110	0.011	0.010%	26

Analytical results and reports are generated at the request and for the exclusive use of the client. This report applies only to the items tested. Samples were not collected by ASBESTECH. This report must not be reproduced except in full, and only with the express permission of ASBESTECH. This report must not be used to claim product endorsement by any agency of the U.S. Government.

ANALYST

LABORATORY DIRECTOR



BULK MATERIAL Analysis Request Form for Entek Consulting Group, Inc.

4200 Rocklin Road, Suite 7
Rocklin, CA 95677
(916) 632-6800
FAX (916) 632-6812

JOB I.D.: ECG-06-065 **CLIENT:** Chico Unified School District **COLLECTED BY:** Robert Howell

DATE COLLECTED: 02/03/06 **DATE SUBMITTED:** 02/06/06 **LAB SUBMITTED TO:** Asbestech

SPECIAL INSTRUCTIONS: Please Fax results, Thanks. (916) 632-6812.

ANALYSIS REQUESTED: Atomic Absorption - Lead **TURNAROUND TIME:** 24 Hr.

JOB SITE: Chico Senior High School
901 The Esplanade
Chico, CA

SAMPLE #	MATERIAL DESCRIPTION/LOCATION
ECG-06-065-01Pb	White Paint/on Wood Window Frame in Admin Building (Building 200) 2 nd Floor, Southwest Stairwell
ECG-06-065-02Pb	White Paint/on Concrete Pony Wall in Admin Building (Building 200) 2 nd Floor, Southwest Stairwell
ECG-06-065-03Pb	Red Paint/on Metal Bench Frame, Outside Admin Building (Building 200) Southwest Stairwell
ECG-06-065-04Pb	Red Paint/on Wood Bench Backrest, Outside Admin Building (Building 200) Southwest Stairwell

C:\Entek\ECG\Clients\ChicoUSD\PbAnalReq020306.wpd

DELIVERED BY: *ROH*

DATE: 2/6/06

RECEIVED BY: *OP*

DATE: 2-6-6 445

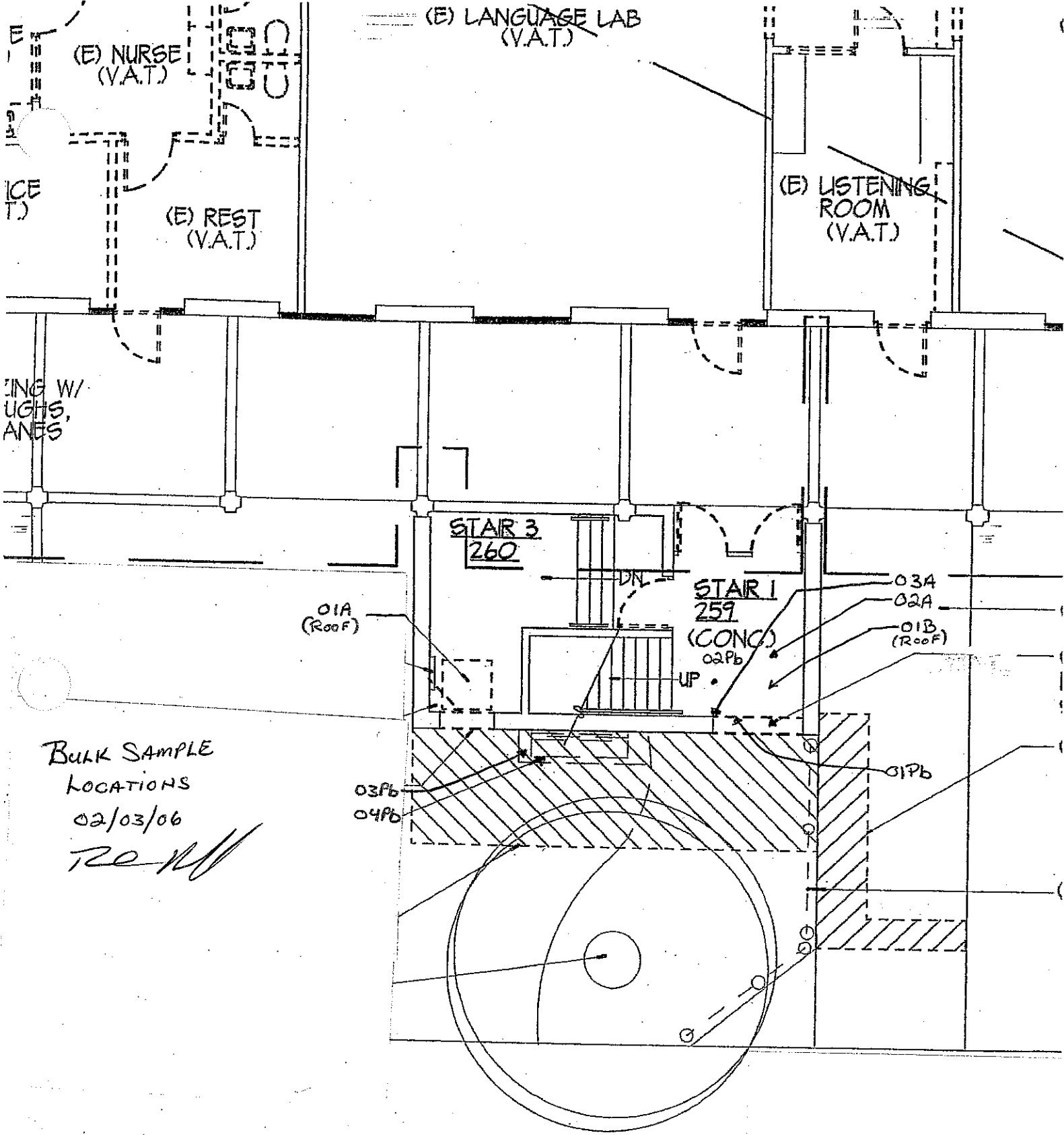

Bulk SAMPLE
 LOCATIONS
 02/03/06
re M

Scale: 1/8" = 1'-0"

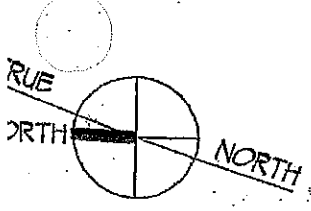

CHICO SR. HIGH SCHOOL
 ADMIN. BUILDING

Jun 29 05 10:26p

Asbestech

916-481-3975

p. 1

California
Department of
Health Services

STATE OF CALIFORNIA
DEPARTMENT OF HEALTH SERVICES
ENVIRONMENTAL LABORATORY ACCREDITATION PROGRAM

ENVIRONMENTAL LABORATORY CERTIFICATION

Is hereby granted to

ASBESTECH

6825 FAIR OAKS BLVD # 103

CARMICHAEL, CA 95608

Scope of certification is limited to the
"List of Approved Fields of Testing and Analytes"
which accompanies this Certificate.

Continued certification status depends on successful completion of site visit,
proficiency testing studies, and payment of applicable fees.

This Certificate is granted in accordance with provisions of
Section 100825, et seq. of the Health and Safety Code.

Certificate No: 1153
Expiration Date: 03/31/2006
Effective Date: 03/01/2004

Berkeley, California
subject to forfeiture or revocation.

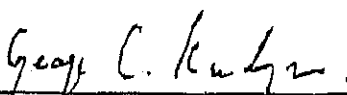
George C. Kulasingam, Ph.D.
Program Chief
Environmental Laboratory Accreditation Program

National Institute
of Standards and Technology



National Voluntary
Laboratory Accreditation Program

ISO/IEC 17025:1999
ISO 9002:1994

Scope of Accreditation



BULK ASBESTOS FIBER ANALYSIS

Page: 1 of 1

NVLAP LAB CODE 101442-0

ASBESTECH

6825 Fair Oaks Blvd., Suite 103

Carmichael, CA 95608

Mr. Tommy Conlon

Phone: 916-481-8902 Fax: 916-481-3975

E-Mail: tgconlonesq@cs.com

URL: <http://www.asbestechlab.com>

NVLAP Code

Designation

18/A01

EPA-600/M4-82-020: Interim Method for the Determination of Asbestos in Bulk Insulation Samples

June 30, 2006

Effective through

A handwritten signature in black ink, appearing to read "H. P. W. P.", is written over a horizontal line.

For the National Institute of Standards and Technology

United States Department of Commerce
National Institute of Standards and Technology

NVLAP[®]

ISO/IEC 17025:1999
ISO 9002:1994

Certificate of Accreditation

ASBESTECH
CARMICHAEL, CA

*is recognized by the National Voluntary Laboratory Accreditation Program
for satisfactory compliance with criteria set forth in NIST Handbook 150:2001,
all requirements of ISO/IEC 17025:1999, and relevant requirements of ISO 9002:1994.
Accreditation is awarded for specific services, listed on the Scope of Accreditation, for:*

BULK ASBESTOS FIBER ANALYSIS

June 30, 2006

Effective through

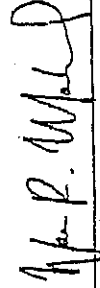

For the National Institute of Standards and Technology
NVLAP Lab Code: 101442-0

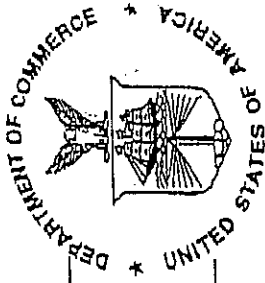

Environmental Lead Proficiency Analytical Testing Program
 Laboratory Performance
 ELPAT Round 53

Page 3 of 4
 12/22/2005
 Lab ID: 101801

Overall Performance Summary Concluding with 53

The following table contains overall proficiency results for 2 and 4 rounds respectively (where applicable).

Sample	Round	Round Performance	2 Rounds	2 Round %	4 Rounds	4 Round %	Proficiency Status
Paint	50	4/4					
	51	4/4					
	52	4/4					
	53	4/4	8/8	100%	16/16	100%	P
Soil	50	4/4					
	51	4/4					
	52	4/4					
	53	4/4	8/8	100%	16/16	100%	P
Dust	50	4/4					
	51	4/4					
	52	3/4					
	53	4/4	7/8	88%	15/16	94%	P

Please note:

The denominators represent the total number of samples analyzed.

The numerators represent the number of acceptable results.

P – Proficient; NP – Non-proficient.

A laboratory is rated proficient (P) for the applicable FoT/Method(s), if

- 1) for the last two consecutive PT rounds, all samples are analyzed and the results are 100% acceptable or
- 2) three-fourths (75%) or more of the accumulated results over four PT rounds are acceptable.

If a lab receives samples and does not report the data, the results will be treated as outliers.

Environmental Lead Proficiency Analytical Testing Program
 Laboratory Performance
 ELPAT Round 52

Page 3 of 4
 10/3/2005
 Lab ID: 101801

Overall Performance Summary Concluding with 52

The following table contains overall proficiency results for 2 and 4 rounds respectively (where applicable). For more information in regard to proficiency analytical testing requirements and the determination of proficiency please see Policy Module 6C, Section 6C.1 and 6C.2 respectively, located at the following link: <http://www.aiha.org/LaboratoryServices/html/2005labAccredPolicyTOC.htm>

Sample	Round	Round Performance	2 Rounds	2 Round %	4 Rounds	4 Round %	Proficiency Status
Paint	49	4/4					
	50	4/4					
	51	4/4					
	52	4/4	8/8	100%	16/16	100%	P
Soil	49	4/4					
	50	4/4					
	51	4/4					
	52	4/4	8/8	100%	16/16	100%	P
Dust	49	4/4					
	50	4/4					
	51	4/4					
	52	3/4	7/8	88%	15/16	94%	P

** Please note: P – Proficient; NP – Non-proficient.

Environmental Lead Proficiency Analytical Testing Program
 Laboratory Performance
 ELPAT Round 53

Page 3 of 4
 12/22/2005
 Lab ID: 101801

Overall Performance Summary Concluding with 53

The following table contains overall proficiency results for 2 and 4 rounds respectively (where applicable).

Sample	Round	Round Performance	2 Rounds	2 Round %	4 Rounds	4 Round %	Proficiency Status
Paint	50	4/4					
	51	4/4					
	52	4/4					
	53	4/4	8/8	100%	18/18	100%	P
Soil	50	4/4					
	51	4/4					
	52	4/4					
	53	4/4	8/8	100%	16/16	100%	P
Dust	50	4/4					
	51	4/4					
	52	3/4					
	53	4/4	7/8	88%	15/16	94%	P

Please note:

The denominators represent the total number of samples analyzed.

The numerators represent the number of acceptable results.

P – Proficient; NP – Non-proficient.

A laboratory is rated proficient (P) for the applicable FoT/Method(s), if

- 1) for the last two consecutive PT rounds, all samples are analyzed and the results are 100% acceptable or
- 2) three-fourths (75%) or more of the accumulated results over four PT rounds are acceptable.

If a lab receives samples and does not report the data, the results will be treated as outliers.

State of California Department of Health Services

Lead-Related
Construction
Certificate

Certificate
Type

Expiration
Date

Inspector Assessor	07/17/2006
Project Monitor	07/17/2006



Robert C. Howell

ID # 2340

State of California
Division of Occupational Safety and Health
Certified Asbestos Consultant

Robert Carter Howell



Name

Certification No. **92-0849**

Expires on **01/15/07**

The certification was issued by the Division of Occupational Safety and Health as authorized by Sections 7100 et seq. of the Business and Professions Code