

ENTEK CONSULTING GROUP, INC.

4200 Rocklin Road, Suite 7 Rocklin, CA 95677

Telephone (916) 632-6800

Fax (916) 632-6812

July 31, 2007

Mr. Leroy A. Christophersen, PHR
Safety & Loss Control Coordinator
Chico Unified School District
2455 Carmichael Drive
Chico, CA 95928

RE: Triennial AHERA Three-Year Reinspection

Dear Mr. Christophersen:

Enclosed is the data obtained from the AHERA Three-Year Reinspections Entek Consulting Group (Entek) conducted between April 11, 2007 and May 10, 2007. The documents included with this letter are the "Three-Year Reinspection Homogeneous ACBM Material Records" covering all buildings known from the original inspection to contain ACBM. The sites inspected were Academy for Change, Bidwell Junior High, Chapman Elementary, Chico Country Day, Chico Junior High School, Chico Senior High School, Citrus Elementary, Cohasset Elementary, Corporation Yard, District Office, Fair View High School, Hooker Oak Elementary, Loma Vista Elementary, Marigold Elementary, McManus Elementary, Neal Dow Elementary, Nord Elementary, Parkview Elementary, Pleasant Valley High School, Rosedale Elementary, Shasta Elementary, and Sierra View Elementary Schools. These are also provided on the enclosed diskette as per our contract. In an effort to assist with your Six-Month Surveillances, Entek has included on the CD blank forms with the current data from the Three-Year Reinspections.

You should review the updated Homogeneous Materials Reports to familiarize yourself with the current status of asbestos containing materials and identified suspect asbestos materials. It is the District's responsibility to assure that the school's site copy of the Management Plan is up to date and consistent with the District's Management Plan for that site. This is very important, and if not done can cause the District to be penalized during an EPA site visit or investigation.

Entek wants to remind you that materials containing "trace" amounts of asbestos must be considered in the event of renovations or demolitions. Although building materials containing trace amounts of asbestos (<1%) are not regulated under EPA, Cal/OSHA does regulate work practices with materials containing 0.1% asbestos. The original AHERA inspection contains information regarding materials with trace amounts of asbestos.

Entek collected two (2) asbestos bulk samples during the reinspections. One sample was collected at Loma Vista Elementary School and one at Chico High School. See the results of each sample in the following tables.

Loma Vista Elementary School; Unit A, North Building

Suspect Materials Found or Assumed TO Contain >1% Asbestos Content (RACM)			
Material	Asbestos Content	Location	Entek Sample Number
White 12" Floor Tile	1-5% Chrysotile	South East Corner of Room 16 Near Room 13	ECG-07-465-01A

Suspect Materials Found NOT TO Contain Asbestos or Considered Non-Suspect			
Material	Asbestos Content	Location	Entek Sample Number
Yellow Mastic	None Detected	South East Corner of Room 16 Near Room 13	ECG-07-465-01A



Bulk Asbestos Analysis

(EPA Method 600/R-93-116, Visual Area Estimation)

Chico Unified School Dist
Leroy Christophersen

2455 Carmichael Drive
Chico, CA 95928

Client ID: 2921
Report Number: B104006
Date Received: 09/19/07
Date Analyzed: 09/21/07
Date Printed: 09/21/07
First Reported: 09/21/07

Job ID/Site: Chapman - Re-roof - PO#070280

Date(s) Collected: 09/14/2007

FASI Job ID: 2921
Total Samples Submitted: 14
Total Samples Analyzed: 14

Sample ID	Lab Number	Asbestos Type	Percent in Layer	Asbestos Type	Percent in Layer	Asbestos Type	Percent in Layer
CHP01	10681949						
Layer: Black Tar			ND				
Layer: Black Felt			ND				
Layer: Black Tar			ND				
Layer: Black Felt			ND				
Layer: Black Tar			ND				
Layer: Black Felt			ND				
Layer: Black Tar			ND				
Layer: Black Felt			ND				
Total Composite Values of Fibrous Components:		Asbestos (ND)					
Cellulose (Trace) Fibrous Glass (45 %)							
Comment: Bulk complex sample.							
CHP02	10681950						
Layer: Black Tar			ND				
Layer: Black Felt			ND				
Layer: Black Tar			ND				
Layer: Black Felt			ND				
Layer: Black Tar			ND				
Layer: Black Felt			ND				
Total Composite Values of Fibrous Components:		Asbestos (ND)					
Cellulose (Trace) Fibrous Glass (45 %)							
Comment: Bulk complex sample.							
CHP03	10681951						
Layer: Black Tar			ND				
Layer: Black Felt			ND				
Layer: Black Tar			ND				
Layer: Black Felt			ND				
Layer: Black Tar			ND				
Layer: Black Felt			ND				
Total Composite Values of Fibrous Components:		Asbestos (ND)					
Cellulose (Trace) Fibrous Glass (45 %)							
Comment: Bulk complex sample.							

Client Name: Chico Unified School Dist

Report Number: B104006

Date Printed: 09/21/07

Sample ID	Lab Number	Asbestos Type	Percent in Layer	Asbestos Type	Percent in Layer	Asbestos Type	Percent in Layer
CHP04	10681952						
Layer: Black Tar			ND				
Layer: Black Felt			ND				
Layer: Black Tar			ND				
Layer: Black Felt			ND				
Layer: Black Tar			ND				
Layer: Black Felt			ND				
Layer: Black Tar			ND				
Layer: Black Felt			ND				
Total Composite Values of Fibrous Components:		Asbestos (ND)					
Cellulose (Trace) Fibrous Glass (45 %)							
Comment: Bulk complex sample.							
CHP05	10681953						
Layer: Black Tar			ND				
Layer: Black Felt			ND				
Layer: Black Tar			ND				
Layer: Black Felt			ND				
Layer: Black Tar			ND				
Layer: Black Felt			ND				
Layer: Black Tar			ND				
Layer: Black Felt			ND				
Total Composite Values of Fibrous Components:		Asbestos (ND)					
Cellulose (Trace) Fibrous Glass (45 %)							
Comment: Bulk complex sample.							
CHP06	10681954						
Layer: Black Tar			ND				
Layer: Black Felt			ND				
Layer: Black Tar			ND				
Layer: Black Felt			ND				
Layer: Black Tar			ND				
Layer: Black Felt			ND				
Total Composite Values of Fibrous Components:		Asbestos (ND)					
Cellulose (Trace) Fibrous Glass (45 %)							
Comment: Bulk complex sample.							

Client Name: Chico Unified School Dist

Report Number: B104006

Date Printed: 09/21/07

Sample ID	Lab Number	Asbestos Type	Percent in Layer	Asbestos Type	Percent in Layer	Asbestos Type	Percent in Layer
CHP07	10681955						
Layer: Black Tar			ND				
Layer: Black Felt			ND				
Layer: Black Tar			ND				
Layer: Black Felt			ND				
Layer: Black Tar			ND				
Layer: Black Felt			ND				
Layer: Black Tar			ND				
Layer: Black Felt			ND				
Layer: Black Tar			ND				
Layer: Black Felt			ND				
Layer: Black Tar			ND				
Layer: Black Felt			ND				
Layer: Black Tar			ND				
Layer: Black Felt			ND				
Layer: Black Tar			ND				
Layer: Black Felt			ND				

Total Composite Values of Fibrous Components: Asbestos (ND)

Cellulose (Trace) Fibrous Glass (50 %)

Comment: Bulk complex sample.

CHP08	10681956						
Layer: Black Tar			ND				
Layer: Black Felt			ND				
Layer: Black Tar			ND				
Layer: Black Felt			ND				
Layer: Black Tar			ND				
Layer: Black Felt			ND				
Layer: Black Tar			ND				
Layer: Black Felt			ND				

Total Composite Values of Fibrous Components: Asbestos (ND)

Cellulose (Trace) Fibrous Glass (45 %)

Comment: Bulk complex sample.

CHP09	10681957						
Layer: Black Tar			ND				
Layer: Black Felt			ND				
Layer: Black Tar			ND				
Layer: Black Felt			ND				
Layer: Black Tar			ND				
Layer: Black Felt			ND				
Layer: Black Tar			ND				
Layer: Black Felt			ND				

Total Composite Values of Fibrous Components: Asbestos (ND)

Cellulose (Trace) Fibrous Glass (45 %)

Comment: Bulk complex sample.

Client Name: Chico Unified School Dist

Report Number: B104006

Date Printed: 09/21/07

Sample ID	Lab Number	Asbestos Type	Percent in Layer	Asbestos Type	Percent in Layer	Asbestos Type	Percent in Layer
CHP10	10681958						
Layer: Black Tar			ND				
Layer: Black Felt			ND				
Layer: Black Tar			ND				
Layer: Black Felt			ND				
Layer: Black Tar			ND				
Layer: Black Felt			ND				
Total Composite Values of Fibrous Components:		Asbestos (ND)					
Cellulose (Trace) Fibrous Glass (45 %)							
Comment: Bulk complex sample.							
CHP11	10681959						
Layer: Black Tar			ND				
Layer: Black Felt			ND				
Layer: Black Tar			ND				
Layer: Black Felt			ND				
Layer: Black Tar			ND				
Layer: Black Felt			ND				
Layer: Black Tar			ND				
Layer: Black Felt			ND				
Layer: Black Tar			ND				
Layer: Black Felt			ND				
Total Composite Values of Fibrous Components:		Asbestos (ND)					
Cellulose (Trace) Fibrous Glass (45 %)							
Comment: Bulk complex sample.							
CHP12	10681960						
Layer: Black Tar			ND				
Layer: Black Felt			ND				
Layer: Black Tar			ND				
Layer: Black Felt			ND				
Layer: Black Tar			ND				
Layer: Black Felt			ND				
Total Composite Values of Fibrous Components:		Asbestos (ND)					
Cellulose (Trace) Fibrous Glass (45 %)							
Comment: Bulk complex sample.							

Client Name: Chico Unified School Dist

Report Number: B104006

Date Printed: 09/21/07

Sample ID	Lab Number	Asbestos Type	Percent in Layer	Asbestos Type	Percent in Layer	Asbestos Type	Percent in Layer
CHP13	10681961						
Layer: Black Tar			ND				
Layer: Black Felt			ND				
Layer: Black Tar			ND				
Layer: Black Felt			ND				
Layer: Black Tar			ND				
Layer: Black Felt			ND				
Layer: Black Tar			ND				
Layer: Black Felt			ND				
Layer: Black Tar			ND				
Layer: Black Felt			ND				

Total Composite Values of Fibrous Components: Asbestos (ND)

Cellulose (Trace) Fibrous Glass (45 %)

Comment: Bulk complex sample.

CHP14	10681962						
Layer: Black Tar			ND				
Layer: Black Felt			ND				
Layer: Black Tar			ND				
Layer: Black Felt			ND				
Layer: Black Tar			ND				
Layer: Black Felt			ND				
Layer: Black Tar			ND				
Layer: Black Felt			ND				

Total Composite Values of Fibrous Components: Asbestos (ND)

Cellulose (Trace) Fibrous Glass (45 %)

Comment: Bulk complex sample.



James Flores, Laboratory Supervisor, Hayward Laboratory

Note: Limit of Quantification ('LOQ') = 1%. 'Trace' denotes the presence of asbestos below the LOQ. 'ND' = 'None Detected'.

Analytical results and reports are generated by Forensic Analytical at the request of and for the exclusive use of the person or entity (client) named on such report. Results, reports or copies of same will not be released by Forensic Analytical to any third party without prior written request from client. This report applies only to the sample(s) tested. Supporting laboratory documentation is available upon request. This report must not be reproduced except in full, unless approved by Forensic Analytical. The client is solely responsible for the use and interpretation of test results and reports requested from Forensic Analytical. This report must not be used by the client to claim product endorsement by NVLAP or any other agency of the U.S. Government. Forensic Analytical is not able to assess the degree of hazard resulting from materials analyzed. Forensic Analytical reserves the right to dispose of all samples after a period of thirty (30) days, according to all state and federal guidelines, unless otherwise specified. All samples were received in acceptable condition unless otherwise noted.



Forensic Analytical

Analysis Request Form

Client Name & Address: Chico Unified School District 2455 Carmichael Drive Chico, CA 95928		P.O. #: 070280 Date: 9/18/07
Contact: Leroy Christophersen Phone #: 530-891-3195 Fax#: (530) 891-3190		Turn Around Time: _____ hr/ 12hr / 24hr / <u>48 hr</u> / ext: _____ Due Date: / / Due Time: : am/pm <input checked="" type="checkbox"/> PLM: <input checked="" type="checkbox"/> Standard / <input type="checkbox"/> Point Count <input type="checkbox"/> PCM: NIOSH 7400
Site: <u>Chapman</u> Job: <u>Re-roof</u>		<input type="checkbox"/> TEM Air: <input type="checkbox"/> AHERA / <input type="checkbox"/> Yamate2 / <input type="checkbox"/> NIOSH 7402 <input type="checkbox"/> TEM Bulk: <input type="checkbox"/> Quantitative / <input type="checkbox"/> Qualitative / <input type="checkbox"/> Chatfield <input type="checkbox"/> TEM Water: <input type="checkbox"/> Potable / <input type="checkbox"/> Non-Potable / <input type="checkbox"/> Wt % <input type="checkbox"/> TEM Microvac <input type="checkbox"/> Special Project: <input type="checkbox"/> Metals Analysis: Method _____ Matrix: _____ Analytes: _____
Comments:		

Sample ID	Date/Time	Sample Location/Description	FOR AIR SAMPLES ONLY				Sample Area or Air Volume
			Type	Time On/Off	Avg. LPM	Total Time	
CHP01	9/14/07	Unit E roof	A P C				
CHP02	9/14/07	Unit E roof	A P C				
CHP03			A P C				
CHP04			A P C				
CHP05			A P C				
CHP06			A P C				
CHP07			A P C				
CHP08		Unit H roof	A P C				
CHP09			A P C				

Sampled by: <u>Leroy Christophersen</u> Date: <u>9/18/07</u> Time: _____	
Shipped via: <input type="checkbox"/> Fed Ex <input type="checkbox"/> Airborne <input type="checkbox"/> UPS <input type="checkbox"/> US Mail <input type="checkbox"/> Courier <input type="checkbox"/> Drop Off <input type="checkbox"/> Other:	
Relinquished by: Date / Time: Received by: <u>[Signature]</u> Date / Time: Condition Acceptable? <input type="checkbox"/> Yes <input type="checkbox"/> No	Relinquished by: Date / Time: Received by: Date / Time: Condition Acceptable? <input type="checkbox"/> Yes <input type="checkbox"/> No
Relinquished by: Date / Time: Received by: Date / Time: Condition Acceptable? <input type="checkbox"/> Yes <input type="checkbox"/> No	

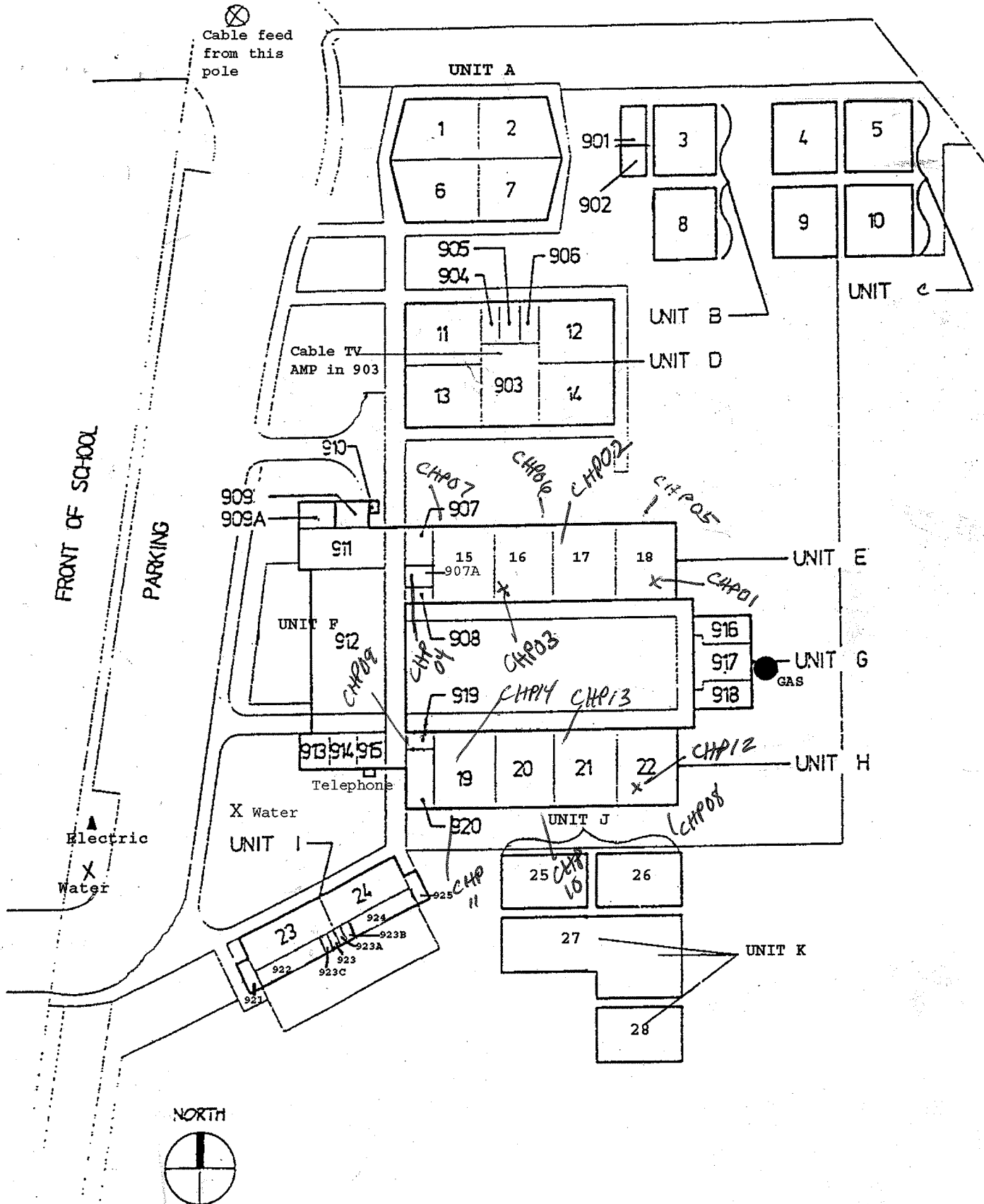

CHAPMAN ELEMENTARY SCHOOL

Updated 9/2006

Maintenance and Operations
2455 Carmichael Drive
Chico, CA 95928
Phone: (530) 891-3195
Fax: (530) 891-3190

Chico Unified School District

September 18, 2007

Fed Ex Airbill #8527 7025 2166

Forensic Analytical Specialties, Inc.
3777 Depot Road, Suite 409
Hayward, CA 94545

Re: Chapman Elementary School

To Whom It May Concern:

Please test the enclosed samples from the Chapman Elementary School Unit E & Unit H Roofs for asbestos. We would like a 48-hour turnaround on the samples. Please fax the results to us as soon as soon as they are available. Our fax number is (530) 891-3190.

Site Sampled:	Chapman Elementary School
Location:	Unit E Roof
Date Sampled:	September 14, 2007
Number of Samples:	Seven (7) - #CHP01, CHP02, CHP03, CHP04 CHP05, CHP06, CHP07
Location:	Unit H Roof
Date Sampled:	September 14, 2007
Number of Samples:	Seven (7) - #CHP08, CHP09, CHP10, CHP11 CHP12, CHP13, CHP14

Thank you for your prompt response to this request.

Sincerely,



Leroy Christophersen
Safety & Loss Control Coordinator

LC:dlg

Enclosures: (14 Samples)



Mr. Leroy A. Christophersen, PHR
Safety & Loss Control Coordinator
Chico Unified School District
July 31, 2007
Page Two

Chico High School, Building LH-800, MPR

Suspect Materials Found NOT TO Contain Asbestos or Considered Non-Suspect			
Material	Asbestos Content	Location	Entek Sample Number
White Linoleum on Columns	None Detected	Building LH-800, MPR	ECG-07-465-02A
Yellow Mastic	None Detected	Building LH-800, MPR	ECG-07-465-02A

When you provide your annual notification to parents and staff, include information regarding this three-year reinspection. Enclosed is a suggested format for your notification letter. Please note that you must include in your Management Plans a description of the steps you take to notify. It is also important that your Management Plans be updated after any and all actions conducted which impact asbestos containing materials.

Please remember that Entek did not inspect new buildings or portable classrooms which were placed on the District sites since the original EPA AHERA inspection. It is the District's responsibility to obtain letters of certification from the Architect, Construction Superintendent, or manufacturer of new building materials, indicating there is no asbestos in the new buildings (constructed after October 12, 1988) or new building materials. A copy of these certification letters must be included in your Management Plans, both at the school site and at the LEA Designees office site. It is still required of School Districts to send a copy of these certification letters to the US EPA AHERA unit; Region IX in San Francisco.

It is not necessary to send a copy of the three-year reinspection to the OPSC or EPA. However, the report should be included in your Management Plan. I want to thank you for your cooperation. If you have any questions, please feel free to contact me at (916) 632-6800.

Sincerely,

William Esparza
Certified Asbestos Consultant
DOSH #99-2579

Enclosures

Below is a suggested letter to district personnel, building occupants, and parents that meets the AHERA requirement of annual notification. Regardless of the notification letter used, a signed and dated copy should be included in the Management Plan. The AHERA designee must also include in the Management Plan a brief statement describing the steps taken to notify. Include the date(s) of the six-month surveillances, and include any other actions taken with regards to asbestos.

Date:

To: Parents, PTA, Teachers, Maintenance, Staff

From: AHERA Designee

RE: Asbestos Hazard Emergency Response Act (AHERA) Asbestos Inspections and Management Plans.

Chico Unified School District has hired Entek Consulting Group, Inc. (Entek), to complete the required three-year reinspection of all asbestos-containing building materials in the District. The reinspections for Academy for Change, Bidwell Junior High, Chapman Elementary, Chico Country Day, Chico Junior High School, Chico Senior High School, Citrus Elementary, Cohasset Elementary, Corporation Yard, District Office, Fair View High School, Hooker Oak Elementary, Loma Vista Elementary, Marigold Elementary, McManus Elementary, Neal Dow Elementary, Nord Elementary, Parkview Elementary, Pleasant Valley High School, Rosedale Elementary, Shasta Elementary, and Sierra View Elementary Schools were completed between April 11, 2007 and May 10, 2007 by an accredited inspector, and the reinspection data has been incorporated into the Management Plan.

Also, during the past year the District has performed the required six-month surveillances on _____. This information is also incorporated into the Management Plan.

A copy of the District's Management Plan is available for review during normal office hours in the office of the _____. If copies of the plan are desired, a nominal duplicating fee may be charged.

Authorized Signature

Date

State of California
Division of Occupational Safety and Health

Certified Asbestos Consultant

William Esparza

Name



Certification No. **99-2579**

Expires on **05/03/08**

This certification was issued by the Division of
Occupational Safety and Health as authorized by
Sections 7180 et seq. of the Business and
Professions Code

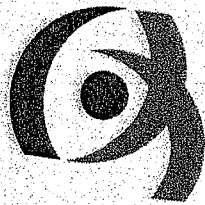

COEH CENTER FOR OCCUPATIONAL
& ENVIRONMENTAL HEALTH

University of California Berkeley

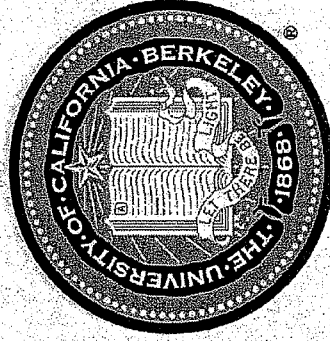

This certifies that

William Esparza

has attended the eight hour course

AHERA Refresher for Asbestos Inspectors & Management

Planners

and has completed the requisite training for asbestos accreditation under TSCA Title II

February 5, 2007

Course Date

John R. Schum

COEH Director

Date of Exam: February 5, 2007

Expiration Date: February 5, 2008

Barbara A. Plog

Continuing Education Director

Certificate Number: BIMP305

Cal/OSHA Approval Number: CA-002-06 / CA-002-08

Center for Occupational and Environmental Health Continuing Education Program

UC Berkeley Mailcode 5120, 2223 Fulton Street, 2nd Floor, Berkeley, CA 94720-5120 Ph: (510) 643-7277 Fax: (510) 643-7291

ASBESTECH
6825 Fair Oaks Blvd., Suite 103
Carmichael, California 95608
Tel.(916) 481-8902 Fax (916) 481-3975

Client:

Entek Consulting Group, Inc.
4200 Rocklin Rd., Suite 7
Rocklin, CA 95677

Job:

07-465 Chico USD
Loma Vista Elementary
Unit A, North Bldg., Chico, Ca

BULK ASBESTOS ANALYSIS REPORT

LAB JOB # 50277

Date/Time Collected: 5/10/07

Date Received: 5/21/07

NVLAP # 101442

DOHS # 1153

Date Analyzed: 5/22/07

<u>Sample No.</u>	<u>Color/Description</u>	<u>% Type Asbestos</u>	<u>Other Materials</u>
ECG-07-465-01A	White 12" floor tile, SE corner of room 16 near room 13	1-5 CHRYSOTILE	Granular Mins.
	Yellow mastic	NONE DETECTED	Synthetics

THE ANALYSIS USES POLARIZED LIGHT MICROSCOPY AND DISPERSION STAINING FOLLOWING E.P.A. METHOD 600/R-93/116. NON-FRIABLE MATERIALS WERE ANALYZED APPLYING THE SAME METHOD. THE LOWER DETECTION LIMIT IS <1 % WITH THE PROVISIO THAT PLM MAY NOT DETECT FIBERS <0.25 MICRONS IN DIAMETER THAT MAY BE PRESENT IN SAMPLES SUCH AS FLOOR TILES. IN ACCORDANCE WITH TITLE 22, CCR, SECTION 66261.24(a)(2)(A), THE MCL IS 1 %. SAMPLES WERE NOT COLLECTED BY ASBESTECH. THIS REPORT MUST NOT BE REPRODUCED EXCEPT IN FULL WITHOUT THE APPROVAL OF ASBESTECH. THIS REPORT RELATES ONLY TO THE ITEMS TESTED. THIS REPORT MUST NOT BE USED TO CLAIM PRODUCT ENDORSEMENT BY N.V.L.A.P. OR ANY AGENCY OF THE U.S. GOVERNMENT. ASBESTECH ACCEPTS TECHNICAL RESPONSIBILITY FOR THIS REPORT AND DATE OF ISSUE.

NVLAP

LABORATORY DIRECTOR: TOM CONLON

ANALYST: JIM JUNGLES

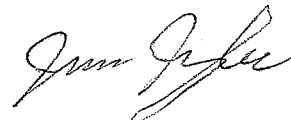

50277

BULK ASBESTOS MATERIAL *Analysis Request Form for Entek Consulting Group, Inc.*

4200 ROCKLIN ROAD, STE. 7
ROCKLIN, CA 95677
(916) 632-6800
FAX (916) 632-6812

JOB I.D.: 07-465 **CLIENT:** Chico Unified School District

COLLECTED BY: William Esparza

DATE COLLECTED: 05/10/07

DATE SUBMITTED: 05/21/07

LAB SUBMITTED TO: Asbestech

SPECIAL INSTRUCTIONS:

ANALYSIS REQUESTED: PLM with Dispersion Staining

TURNAROUND TIME: 24 Hours

JOB SITE: Loma Vista Elementary School
Unit A (North Building)
2404 Marigold Avenue,
Chico, California 95926

SAMPLE #	MATERIAL DESCRIPTION/LOCATION
ECG-07-465-01A	12" Floor Tile and Mastic, SE Corner of Room 16, Near Room 13

C:\Entek\Clients\Chico USD\07-465 Chico 3 Year Inspections\Bulk Asbestos Request 05-10-07.wpd

DELIVERED BY: Shannon Johnson

DATE: 5-21-07

RECEIVED BY: PAH

DATE: 5/21/7

ASBESTECH
6825 Fair Oaks Blvd., Suite 103
Carmichael, California 95608
Tel.(916) 481-8902 Fax (916) 481-3975

Client:

Entek Consulting Group, Inc.
4200 Rocklin Rd., Suite 7
Rocklin, CA 95677

Job:

07-465 Chico USD
Chico HS, Bldg. LH-800, MPR
Chico, Ca

BULK ASBESTOS ANALYSIS REPORT

LAB JOB # 50276

Date/Time Collected: 5/11/07

Date Received: 5/21/07

NVLAP # 101442

DOHS # 1153

Date Analyzed: 5/22/07

<u>Sample No.</u>	<u>Color/Description</u>	<u>% Type Asbestos</u>	<u>Other Materials</u>
ECG-07-465-02A	White linoleum on columns	NONE DETECTED	Vinyl Cellulose
	Yellow mastic	NONE DETECTED	Synthetics

THE ANALYSIS USES POLARIZED LIGHT MICROSCOPY AND DISPERSION STAINING FOLLOWING E.P.A. METHOD 600/R-93/116. NON-FRIABLE MATERIALS WERE ANALYZED APPLYING THE SAME METHOD. THE LOWER DETECTION LIMIT IS <1 % WITH THE PROVISIO THAT PLM MAY NOT DETECT FIBERS <0.25 MICRONS IN DIAMETER THAT MAY BE PRESENT IN SAMPLES SUCH AS FLOOR TILES. IN ACCORDANCE WITH TITLE 22, CCR, SECTION 66261.24(a)(2)(A), THE MCL IS 1 %. SAMPLES WERE NOT COLLECTED BY ASBESTECH. THIS REPORT MUST NOT BE REPRODUCED EXCEPT IN FULL WITHOUT THE APPROVAL OF ASBESTECH. THIS REPORT RELATES ONLY TO THE ITEMS TESTED. THIS REPORT MUST NOT BE USED TO CLAIM PRODUCT ENDORSEMENT BY N.V.L.A.P. OR ANY AGENCY OF THE U.S. GOVERNMENT. ASBESTECH ACCEPTS TECHNICAL RESPONSIBILITY FOR THIS REPORT AND DATE OF ISSUE.

NVLAP

LABORATORY DIRECTOR: TOM CONLON

ANALYST: JIM JUNGLES



50276

BULK ASBESTOS MATERIAL *Analysis Request Form for Entek Consulting Group, Inc.*

4200 ROCKLIN ROAD, STE. 7
ROCKLIN, CA 95677
(916) 632-6800
FAX (916) 632-6812

JOB I.D.: 07-465 **CLIENT:** Chico Unified School District

COLLECTED BY: William Esparza

DATE COLLECTED: 05/11/07

DATE SUBMITTED: 05/21/07

LAB SUBMITTED TO: Asbestech

SPECIAL INSTRUCTIONS:

ANALYSIS REQUESTED: PLM with Dispersion Staining

TURNAROUND TIME: 24 Hours

JOB SITE: Chico Senior High School
Building LH-800, Multi-Purpose Room
901 The Esplanade,
Chico, California 95926

SAMPLE #	MATERIAL DESCRIPTION/LOCATION
ECG-07-465-02A	Linoleum on Columns

C:\Entek\Clients\Chico USD\07-465 Chico 3 Year Inspections\Bulk Asbestos Request 05-11-07.wpd

DELIVERED BY: Shannon Johanson

DATE: 5-21-07

RECEIVED BY: Roll

DATE: 5/24/7 10¹² m

RECORD OF FRIABLE AND NON-FRIABLE ACM
(FORM B)

Inspection Date(s) April 30, 2007

THREE-YEAR REINSPECTION

SCHOOL Chapman Elementary School					CDS CODE 04-61424-6002968	
ADDRESS (NUMBER) (STREET) (CITY) (ZIP) 1071 E. 16 th Street Chico, CA 95928					SCHOOL PHONE NUMBER (530) 891-3100	

-IMPORTANT-

Each building and functional space with friable ACBM or friable assumed ACBM listed on this form requires completion of FORM C (PHYSICAL AND HAZARD ASSESSMENT OF FRIABLE ACBM OR FRIABLE ASSUMED ACBM). Indicate location of material on blueprint, diagram or narrative in square or linear feet, and attach a copy (Sec. 763.93).

LINE	BUILDING NAME & FUNCTIONAL SPACE (Indicate Address if Different From Above)	CHECK ONE			CHECK ONE			
		SUR- FACING	TSI	MISC	ACBM		ASSUMED ACBM	
					FRIABLE	NON- FRIABLE	FRIABLE	NON- FRIABLE
1.	UNIT A (FKA G) - ROOMS 1, 2, 6 & 7			X				X
2.	THROUGHOUT		X		X			
3.	UNIT B - ROOMS 3, 8, 901, & 902 DISTRICT MUST CERTIFY							
4.	UNIT C - ROOMS 4, 5, 9, & 10 DISTRICT MUST CERTIFY							
5.	UNIT D (FKA F) - ROOMS 11-14 & 903-906			X		X		X
6.	UNIT E (FKA C) - ROOMS 15-18 & 907-908			X				X
7.	UNIT F (FKA A) - ROOMS 909-915	X		X		X		X
8.	UNIT G (FKA D) - ROOMS 916-918							
9.	UNIT H (FKA B) - ROOMS 19-22 & 919-920			X				X
10.	UNIT I (FKA E) - ROOMS 23, 24, & 921-925 DISTRICT MUST CERTIFY							
11.	UNIT J - ROOMS 25 & 26 (LEASED PORTABLES) DISTRICT MUST CERTIFY							
12.	UNIT K - ROOMS 27 & 28 DISTRICT MUST CERTIFY							
13.								
14.								
15.								

See attached "Homogeneous Materials Records" for all materials and their locations by building. On Form B all buildings are listed, and a summary of all non-friable and friable material is provided. Friable materials and their locations are listed separately under each building on Form B.

THREE-YEAR REINSPECTION HOMOGENEOUS ACBM RECORDS

Date of Inspection: April 30, 2007

District: Chico Unified School District

Inspector: William Esparza

School: Chapman Elementary School

Building: Unit A (FKA G)

Material Class	Material	Homo. Mat. #	% Asb.	FI ² /L.F.	Location	Condition: Code & Comments	Friable Yes/No
T	MUD JOINT	1	1-5%	UNDETERMINED	THROUGHOUT	(1) (4) SAMPLE HMS-CPM-03 COLLECTED ON 4/9/88.	Y
M	TRANSITE PANELS	2	ASSUMED	UNDETERMINED	THROUGHOUT	(11) COULD NOT LOCATE.	N
M	12" VFT CREAM	3	ASSUMED	400 S	CLASSROOMS 1, 2, 6, & 7	(1)	N

CONDITION CODE

General Condition: (1) Good (2) Damaged (3) Significantly Damaged (25% or more)
Change in Condition: (4) No (5) Yes (If Yes, explain under comments)
Abated: (6) Repaired (7) Removed (8) Encapsulated (9) Enclosed (10) Isolated & Restricted
Miscellaneous: (11) Inaccessible, no inspection data (12) Other (Explain under comments) (13) Non-Asbestos/Not Inspected

CONSULT ORIGINAL AND SUPPLEMENTARY INSPECTION REPORTS FOR MATERIALS WITH TRACE AMOUNTS OF ASBESTOS

THREE-YEAR REINSPECTION HOMOGENEOUS ACBM RECORDS

Date of Inspection: April 30, 2007

District: Chico Unified School District

Inspector: William Esparza

School: Chapman Elementary School

Building: Unit D (FKA F)

Material Class	Material	Homo. Mat. #	% Asb.	Ft ² /L.F.	Location	Condition: Code & Comments	Friable Yes/No
M	9" VFT	4	1-5%	UNDETERMINED	THROUGHOUT EXCEPT IN LIBRARY	(1) (4)	N/A
M	9" VFT	5	1-5%	UNDETERMINED	THROUGHOUT EXCEPT IN LIBRARY	(1) (4)	N/A
M	TRANSITE PANELS	6	ASSUMED	400 S	EXTERIOR	(1) (4)	N

CONDITION CODE

General Condition: (1) Good (2) Damaged (3) Significantly Damaged (25% or more)
 Change in Condition: (4) No (5) Yes (If Yes, explain under comments)
 Abated: (6) Repaired (7) Removed (8) Encapsulated (9) Enclosed (10) Isolated & Restricted
 Miscellaneous: (11) Inaccessible, no inspection data (12) Other (Explain under comments) (13) Non-Asbestos/Not Inspected

CONSULT ORIGINAL AND SUPPLEMENTARY INSPECTION REPORTS FOR MATERIALS WITH TRACE AMOUNTS OF ASBESTOS

THREE-YEAR REINSPECTION HOMOGENEOUS ACBM RECORDS

Date of Inspection: April 30, 2007

District: Chico Unified School District

Inspector: William Esparza

School: Chapman Elementary School

Building: Unit E (FKA C)

Material Class	Material	Homo. Mat. #	% Asb.	Ft ² /L.F.	Location	Condition: Code & Comments	Friable Yes/No
M	TRANSITE PANELS	7	ASSUMED	400 S	EXTERIOR	(1) (4)	N
M	12" VFT CREAM	8	ASSUMED	3,600 S	CLASSROOMS 15-18	(1)	N

CONDITION CODE

General Condition: (1) Good (2) Damaged (3) Significantly Damaged (25% or more)
 Change in Condition: (4) No (5) Yes (If Yes, explain under comments)
 Abated: (6) Repaired (7) Removed (8) Encapsulated (9) Enclosed (10) Isolated & Restricted
 Miscellaneous: (11) Inaccessible, no inspection data (12) Other (Explain under comments) (13) Non-Asbestos/Not Inspected

CONSULT ORIGINAL AND SUPPLEMENTARY INSPECTION REPORTS FOR MATERIALS WITH TRACE AMOUNTS OF ASBESTOS

THREE-YEAR REINSPECTION HOMOGENEOUS ACBM RECORDS

Date of Inspection: April 30, 2007

District: Chico Unified School District

Inspector: William Esparza

School: Chapman Elementary School

Building: Unit F (FKA A)

Material Class	Material	Homo. Mat. #	% Asb.	Ft ² /L.F.	Location	Condition: Code & Comments	Friable Yes/No
M	9" VFT BROWN	9	10-15%	UNDETERMINED	KITCHEN	(1) (6) BROKEN TILES AT BACK ENTRANCE HAVE BEEN REPAIRED.	N
M	12" VFT CREAM	10	ASSUMED	3,600 S	MPR, CORRIDOR, AND OFFICES	(1)	N
M	12" ACT	11	ASSUMED	3,600 S	MPR, CORRIDOR, AND OFFICES	(1)	N
S	PLASTER	12	NONE DETECTED	UNDETERMINED	KITCHEN	(13)	N/A

CONDITION CODE

General Condition: (1) Good (2) Damaged (3) Significantly Damaged (25% or more)
 Change in Condition: (4) No (5) Yes (If Yes, explain under comments)
 Abated: (6) Repaired (7) Removed (8) Encapsulated (9) Enclosed (10) Isolated & Restricted
 Miscellaneous: (11) Inaccessible, no inspection data (12) Other (Explain under comments) (13) Non-Asbestos/Not Inspected

CONSULT ORIGINAL AND SUPPLEMENTARY INSPECTION REPORTS FOR MATERIALS WITH TRACE AMOUNTS OF ASBESTOS

THREE-YEAR REINSPECTION HOMOGENEOUS ACBM RECORDS

Date of Inspection: April 30, 2007

District: Chico Unified School District

Inspector: William Esparza

School: Chapman Elementary School

Building: Unit H (FKA B)

Material Class	Material	Homo. Mat. #	% Asb.	Ft ² /L.F.	Location	Condition: Code & Comments	Friable Yes/No
M	TRANSITE PANELS	13	ASSUMED	400 S	EXTERIOR	(1) (4)	N
M	12" VFT	14	ASSUMED	3,600 S	CLASSROOMS 19-22	(1)	N

CONDITION CODE

General Condition: (1) Good (2) Damaged (3) Significantly Damaged (25% or more)
Change in Condition: (4) No (5) Yes (If Yes, explain under comments)
Abated: (6) Repaired (7) Removed (8) Encapsulated (9) Enclosed (10) Isolated & Restricted
Miscellaneous: (11) Inaccessible, no inspection data (12) Other (Explain under comments) (13) Non-Asbestos/Not Inspected

CONSULT ORIGINAL AND SUPPLEMENTARY INSPECTION REPORTS FOR MATERIALS WITH TRACE AMOUNTS OF ASBESTOS

ENTEK CONSULTING GROUP, INC.
ASSESSMENT OF TSI and/or FRIABLE MATERIAL

District: Chico Unified School District

Date: April 30, 2007

School: Chapman Elementary School

Inspector: William Esparza

Building & Location(s): Unit A (FKA G) - Throughout

HMS-CPM-03 Collected on 4/9/88

% Asbestos-1-5%

Homogeneous Mat. #1

Material description: Mud Joint

Total amount of material this location: Undetermined

Amount of friable material this location: Undetermined

Damage	Local		Distributed		Damaged	0%
Type of Damage	Air Erosion		Water		Flaking	
	Deterioration		Physical		Delamination	

Probable cause(s) of damage:

POTENTIAL FOR DISTURBANCE			RESPONSE ACTIONS		PREVENTIVE MEASURES	
	H	M	L	Isolate/Restrict		Fix leaks
Accessibility			X	Repair/Cleanup		Prevent water contact
Vibration			X	Enclose		Do not drill, cut, sand, or grind
Air Erosion			X	Remove	X	Do not affix signs
Water			X	Encapsulate		Avoid contact
Occupancy			X	O & M	X	

Assessment of Material Condition

Significantly Damaged
(Poor)

☐

Damaged
(Fair)

☐

Not damaged
(Good)

☐

Potential Damage: High High Mod Low High Mod Low

Hazard Ranking: 1 2 3 4 5 6 7

									X

Comments & Observations:

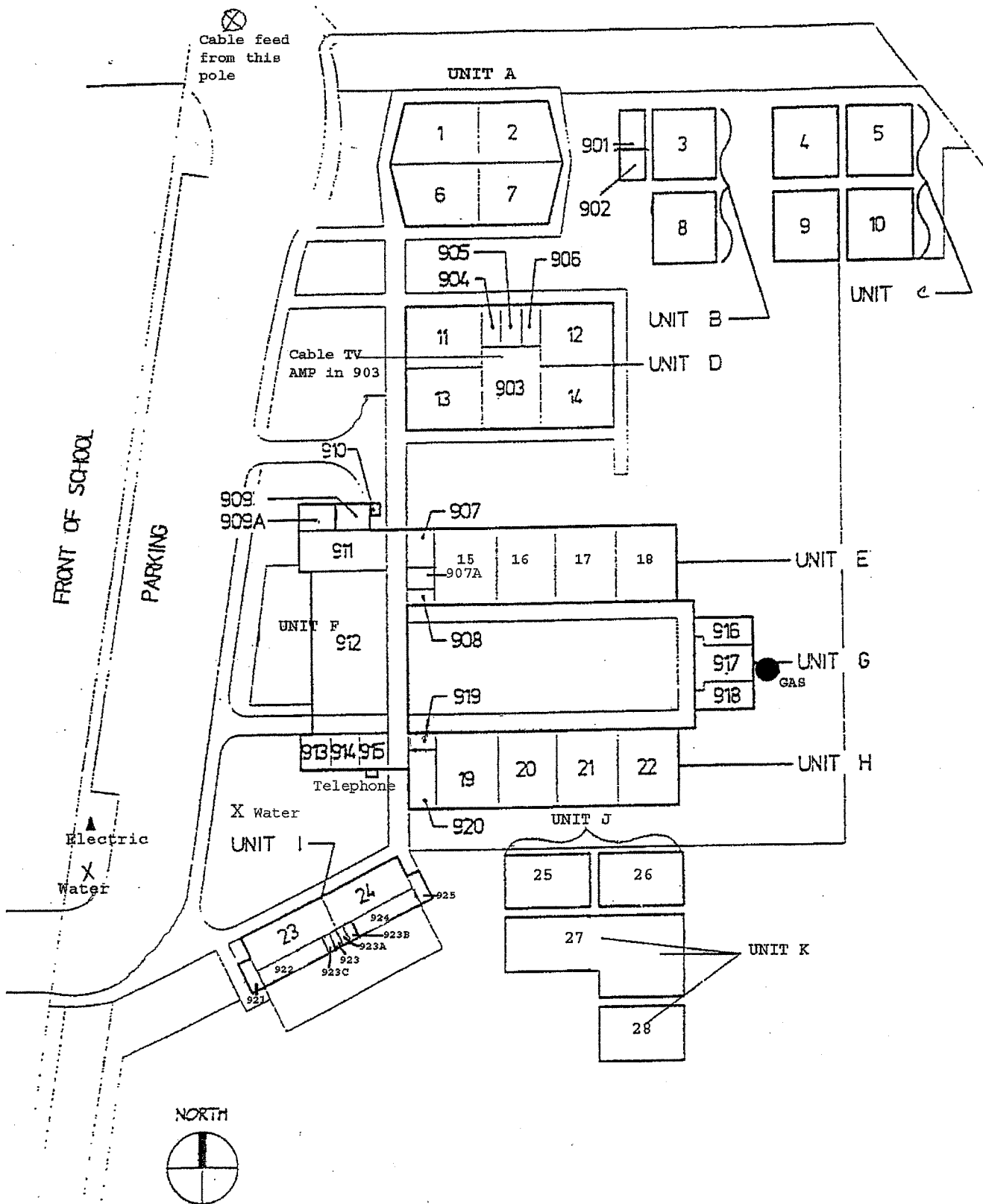

CHAPMAN ELEMENTARY SCHOOL

Updated 9/2006

Three-Year Reinspection
 Conducted By: William Esparza
 Entek Consulting Group, Inc.
 April 30, 2007



Bulk Asbestos Analysis

(EPA Method 600/R-93-116, Visual Area Estimation)

Chico Unified School Dist
Leroy Christophersen

2455 Carmichael Drive
Chico, CA 95928

Client ID: 2921
Report Number: B099242
Date Received: 05/17/07
Date Analyzed: 05/21/07
Date Printed: 05/21/07
First Reported: 05/21/07

Job ID/Site: Chapman Elementary School - PO# 070280

FASI Job ID: 2921

Date(s) Collected: 05/16/2007

Total Samples Submitted: 3

Total Samples Analyzed: 3

Sample ID	Lab Number	Asbestos Type	Percent in Layer	Asbestos Type	Percent in Layer	Asbestos Type	Percent in Layer
CH01	10641701						
Layer: Grey Plaster			ND				
Layer: Paint			ND				
Total Composite Values of Fibrous Components:		Asbestos (ND)					
Cellulose (Trace)							
CH02	10641702						
Layer: Grey Plaster			ND				
Layer: Paint			ND				
Total Composite Values of Fibrous Components:		Asbestos (ND)					
Cellulose (Trace)							
CH03	10641703						
Layer: Grey Plaster			ND				
Layer: Paint			ND				
Total Composite Values of Fibrous Components:		Asbestos (ND)					
Cellulose (Trace)							

James Flores, Laboratory Supervisor, Hayward Laboratory

Note: Limit of Quantification ('LOQ') = 1%. 'Trace' denotes the presence of asbestos below the LOQ. 'ND' = 'None Detected'.

Analytical results and reports are generated by Forensic Analytical at the request of and for the exclusive use of the person or entity (client) named on such report. Results, reports or copies of same will not be released by Forensic Analytical to any third party without prior written request from client. This report applies only to the sample(s) tested. Supporting laboratory documentation is available upon request. This report must not be reproduced except in full, unless approved by Forensic Analytical. The client is solely responsible for the use and interpretation of test results and reports requested from Forensic Analytical. This report must not be used by the client to claim product endorsement by NVLAP or any other agency of the U.S. Government. Forensic Analytical is not able to assess the degree of hazard resulting from materials analyzed. Forensic Analytical reserves the right to dispose of all samples after a period of thirty (30) days, according to all state and federal guidelines, unless otherwise specified. All samples were received in acceptable condition unless otherwise noted.



Forensic Analytical

Analysis Request Form

Client Name & Address: Chico Unified School District 2455 Carmichael Drive Chico, CA 95928		P.O. #: 070280 Date: 5/16/07
Contact: Leroy Christophersen Phone #: 530-891-3195 Fax#: / christo@mail.chicoasd.org (530) 891-3190		Turn Around Time: ___ hr/ 12hr / 24hr / <u>48 hr</u> ext: _____ Due Date: ___ / ___ / ___ Due Time: ___ : ___ am/pm
Site: CHAPMAN		<input checked="" type="checkbox"/> PLM: <input checked="" type="checkbox"/> Standard / <input type="checkbox"/> Point Count <input type="checkbox"/> PCM: NIOSH 7400
Job:		<input type="checkbox"/> TEM Air: <input type="checkbox"/> AHERA / <input type="checkbox"/> Yamate2 / <input type="checkbox"/> NIOSH 7402 <input type="checkbox"/> TEM Bulk: <input type="checkbox"/> Quantitative / <input type="checkbox"/> Qualitative / <input type="checkbox"/> Chatfield <input type="checkbox"/> TEM Water: <input type="checkbox"/> Potable / <input type="checkbox"/> Non-Potable / <input type="checkbox"/> Wt % <input type="checkbox"/> TEM Microvac <input type="checkbox"/> Special Project:
		<input type="checkbox"/> Metals Analysis: Method _____ Matrix: _____ Analytes: _____

Comments:

Point Count is "Trace" results

Sample ID	Date/Time	Sample Location/Description	FOR AIR SAMPLES ONLY				Sample Area or Air Volume
			Type	Time On/Off	Avg. LPM	Total Time	
CH01	5/16	Principal office dry wall	A P C				
CH02	5/16	Hallway dry wall	A P C				
CH03	5/16	Principal office dry wall.	A P C				
			A P C				
			A P C				
			A P C				
			A P C				
			A P C				
			A P C				

Sampled by: Leroy Date: 5/16/07 Time: 10:00 AM
 Shipped via: ☐ Fed Ex ☐ Airborne ☐ UPS ☐ US Mail ☐ Courier ☐ Drop Off ☐ Other:

Relinquished by: Date / Time:	Relinquished by: Date / Time:	Relinquished by: Date / Time:
Received by: <u>[Signature]</u> Date / Time:	Received by: Date / Time:	Received by: Date / Time:
RECEIVED MAY 17 2007 Condition Acceptable? <input type="checkbox"/> Yes <input type="checkbox"/> No	Condition Acceptable? <input type="checkbox"/> Yes <input type="checkbox"/> No	Condition Acceptable? <input type="checkbox"/> Yes <input type="checkbox"/> No

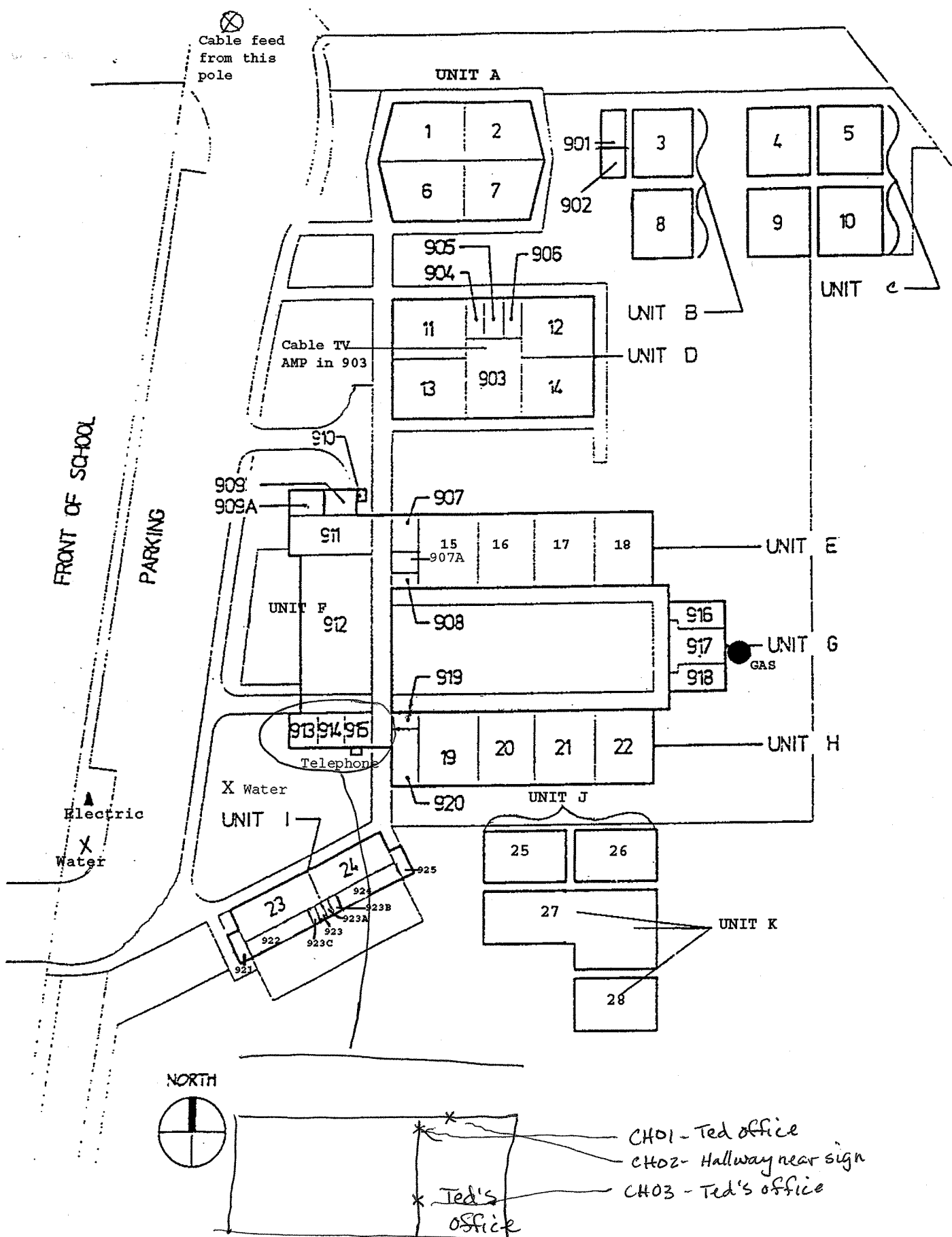

CHAPMAN ELEMENTARY SCHOOL

Updated 9/2006

Maintenance and Operations
2455 Carmichael Drive
Chico, CA 95928
Phone: (530) 891-3195
Fax: (530) 891-3190

Chico Unified School District

Fed Ex Airbill #8358 1795 1216

May 16, 2007

Forensic Analytical Specialties, Inc.
3777 Depot Road, Suite 409
Hayward, CA 94545

Re: Chapman Elementary School

To Whom It May Concern:

Please test the enclosed samples from Chapman Elementary School Administration for Asbestos. We would like a 48-hour turnaround on the samples. Please e-mail the results as soon as they are available to lchristo@chicousd.org.

Site Sampled:	Chapman Elementary School
Location:	Administration
Date Sampled:	May 16, 2007
Number of Samples:	(Three)#CH01 – Principal's Office Drywall #CH02 – Hallway Drywall #CH03 – Principal's Office Drywall

Thank you for your prompt response to this request.

Sincerely,



Leroy Christophersen
Safety & Loss Coordinator

Enclosures (3)
dlg