

HMS, Inc.

HAZARD MANAGEMENT SERVICES, INC.

4200 Rocklin Rd., Ste. 11A
Rocklin, CA 95677-2860
(916) 632-6800 • (916) 632-6841 Fax

May 7, 2004

MAY 7 2004

Mr. Kip Hansen
Chico Unified School District
1163 E. Seventh Street
Chico, CA 95928

RE: Fifth Triennial AHERA Three-Year Reinspection

Dear Mr. Hansen:

Enclosed is the data obtained from the fifth AHERA three-year reinspections Hazard Management Services, Inc. (HMS, Inc.) conducted between April 14-20, 2004. The documents included with this letter are the "Three-Year Reinspection Homogeneous ACBM Material Records" covering all Elementary buildings known from the original inspection to contain ACBM. The sites enclosed are Cohasset, Loma Vista, McManus, Neal Dow, Nord, Parkview, Partridge, and Shasta Elementary Schools.

You should review the updated Homogeneous Materials Reports to familiarize yourself with the current status of asbestos containing materials and identified suspect asbestos materials. It is the District's responsibility to assure that the school's site copy of the Management Plan is up to date and consistent with the District's Management Plan for that site. This is very important and if not done can cause the District to be penalized during an EPA site visit or investigation.

HMS, Inc. wants to remind you that materials containing "trace" amounts of asbestos must be considered in the event of renovations or demolitions. Although building materials containing trace amounts of asbestos (<1%) are not regulated under EPA, Cal/OSHA does regulate work practices with materials containing 0.1% asbestos. The original AHERA inspection contains information regarding materials with trace amounts of asbestos.

When you provide your annual notification to parents and staff, include information regarding this three-year reinspection. Enclosed is a suggested format for your notification letter. Please note that you must include in your Management Plans a description of the steps you take to notify. It is also important that your Management Plans be updated after any and all actions conducted which impact asbestos containing materials.

Please remember that HMS, Inc. did not inspect new buildings or portable classrooms which were placed on the District sites since the original EPA AHERA inspection. It is the District's responsibility to obtain letters of certification from the Architect, Construction Superintendent, or manufacturer of new building materials, indicating there is no asbestos in the new buildings (constructed after October 12, 1988) or new building materials. A copy of these certification letters must be included in your management plans, both at the school site and at the LEA Designees office site. It is still required of School Districts to send a copy of these certification letters to the US EPA AHERA unit, Region IX in San Francisco.

HMS, Inc.

Mr. Kip Hansen
Chico Unified School District
May 7, 2004
Page Two

It is not necessary to send a copy of the three-year reinspection to the OPSC or EPA. However, the report should be included in your Management Plan. I want to thank you for your cooperation. If you have any questions, please feel free to contact me at (916) 632-6800.

Sincerely,



John Angi
Certified Asbestos Consultant
CAC #03-3330

Enclosures

D:\Shannon's Doc\REINSPT\ChicoUSD\2004\00.01.Final.Ltr.wpd

**RECORD OF FRIABLE AND NONFRIABLE ACM
(FORM B)**

Inspection Date(s) April 15, 2004

THREE-YEAR REINSPECTION

SCHOOL Partridge Elementary School					CDS CODE 04-61424-6003016
ADDRESS (NUMBER) (STREET) (CITY) (ZIP) 290 East Avenue Chico, CA 95973					SCHOOL PHONE NUMBER (530) 891-3124

-IMPORTANT-

Each building and functional space with friable ACBM or friable assumed ACBM listed on this form requires completion of FORM C (PHYSICAL AND HAZARD ASSESSMENT OF FRIABLE ACBM OR FRIABLE ASSUMED ACBM). Indicate location of material on blueprint, diagram or narrative in square or linear feet, and attach a copy (Sec. 763.93).

LINE	BUILDING NAME & FUNCTIONAL SPACE (Indicate Address if Different From Above)	CHECK ONE			CHECK ONE			
		SUR- FACING	TSI	MISC	ACBM		ASSUMED ACBM	
					FRIABLE	NON-FRIABLE	FRIABLE	NON-FRIABLE
1.	A	X	X	X		X		X
2.	B	X		X		X		
3.	C	X	X	X		X		X
4.	D			X				X
5.	Portables 1, 2, & 20			X				X
6.	Portables 18 & 19			X				X
7.								
8.								
9.								
10.								
11.								
12.								
13.								
14.								
15.								
16.								
17.								

See attached "Homogeneous Materials Records" for all materials and their locations by building. On Form B all buildings are listed, and a summary of all non-friable and friable material is provided. Friable materials and their locations are listed separately under each building on Form B.

**THREE-YEAR REINSPECTION
HOMOGENEOUS ACBM RECORDS**

Date of Inspection: April 15, 2004

District: Chico Unified School District

Inspector: John Angi

School: Partridge Elementary School

Building: A

Material Class	Material	Homo. Mat. #	% Asb.	Ft ² /L.F.	Location	Condition: Code & Comments	Friable Yes/No
M	9" VFT	4	1-5%	9,000 S	ALL ROOMS	(1) (4)	N
S	AC PLASTER	5	1-5%	3,488 S	ALL ROOMS	(2) (4) CRACKS IN THE HALLWAY CEILING.	N
T	LARGE MUD JOINT	6	ASSUMED	22 JOINTS	BOILER ROOM	(1) (4) MINOR DAMAGE.	N
T	SMALL MUD JOINT	7	ASSUMED	26 JOINTS	BOILER ROOM	(1) (4) MINOR DAMAGE.	N
M	TRANSITE PANELS	60	ASSUMED	8 PANELS	UNDER ENTRY WINDOWS	(1) (4)	N

CONDITION CODE

General Condition: (1) Good (2) Damaged (3) Significantly Damaged (25% or more)
Change in Condition: (4) No (5) Yes (if Yes, explain under comments)
Abated: (6) Repaired (7) Removed (8) Encapsulated (9) Enclosed (10) Isolated & Restricted
Miscellaneous: (11) Inaccessible, no inspection data (12) Other (Explain under comments) (13) Non-Asbestos/Not Inspected

CONSULT ORIGINAL AND SUPPLEMENTARY INSPECTION REPORTS FOR MATERIALS WITH TRACE AMOUNTS OF ASBESTOS

**THREE-YEAR REINSPECTION
HOMOGENEOUS ACBM RECORDS**

Date of Inspection: April 15, 2004

District: Chico Unified School District

Inspector: John Angi

School: Partridge Elementary School

Building: B

Material Class	Material	Homo. Mat. #	% Asb.	F ² /L.F.	Location	Condition: Code & Comments	Friable Yes/No
M	9" VFT	4	1-5%	2,800 S	ALL CLASSROOMS	(1) (4) (6) ROOM 13 REPAIRED 2/00 WORK ORDER NUMBER E23746.	N
S	PLASTER	5	1-5%	1,600 S	ALL CLASSROOMS, BOTH RESTROOMS, AND CUSTODIAN ROOM	(1) (4)	N

CONDITION CODE

General Condition: (1) Good (2) Damaged (3) Significantly Damaged (25% or more)
Change in Condition: (4) No (5) Yes (if Yes, explain under comments)
Abated: (6) Repaired (7) Removed (8) Encapsulated (9) Enclosed (10) Isolated & Restricted
Miscellaneous: (11) Inaccessible, no inspection data (12) Other (Explain under comments) (13) Non-Asbestos/Not Inspected

CONSULT ORIGINAL AND SUPPLEMENTARY INSPECTION REPORTS FOR MATERIALS WITH TRACE AMOUNTS OF ASBESTOS

**THREE-YEAR REINSPECTION
HOMOGENEOUS ACBM RECORDS**

Date of Inspection: April 15, 2004

District: Chico Unified School District

Inspector: John Angi

School: Partridge Elementary School

Building: C

Material Class	Material	Homo. Mat. #	% Asb.	FF/L.F.	Location	Condition: Code & Comments	Friable Yes/No
T	PIPE WRAP STRAIGHT	3	70-75%	150 L	KITCHEN, WATER HEATER ROOM, AND MULTI-PURPOSE ROOM STORAGE	(1) (4)	N
M	9" VFT	4	1-5%	6,000 S	ENTIRE WING	(1) (4)	N
S	AC PLASTER	5	1-5%	1,400 S	HALLWAY OUTSIDE MULTI-PURPOSE ROOM	(1) (4)	N
T	MUD JOINT	7	ASSUMED	4 JOINTS	KITCHEN (BY DISHWASHER)	(1) (4) (6) REPAIRED 05-01-00.	N
M	TRANSITE PIPE	99	ASSUMED	6 L	KITCHEN WATER HEATER ROOM	(1) (4)	N

CONDITION CODE

General Condition: (1) Good (2) Damaged (3) Significantly Damaged (25% or more)
Change in Condition: (4) No (5) Yes (If Yes, explain under comments)
Abated: (6) Repaired (7) Removed (8) Encapsulated (9) Enclosed (10) Isolated & Restricted
Miscellaneous: (11) Inaccessible, no inspection data (12) Other (Explain under comments) (13) Non-Asbestos/Not Inspected

CONSULT ORIGINAL AND SUPPLEMENTARY INSPECTION REPORTS FOR MATERIALS WITH TRACE AMOUNTS OF ASBESTOS

**THREE-YEAR REINSPECTION
HOMOGENEOUS ACBM RECORDS**

Date of Inspection: April 15, 2004

District: Chico Unified School District

Inspector: John Angi

School: Partridge Elementary School

Building: D

Material Class	Material	Homo. Mat. #	% Asb.	Ft ² /L.F.	Location	Condition: Code & Comments	Friable Yes/No
M	LINOLEUM BEIGE	10	NONE DETECTED	200 S	GIRL'S & BOY'S RESTROOMS	(13) SAMPLE HMS-PAR-08 COLLECTED ON 3-30-88.	N/A
M	2' X 8' ACT	50	ASSUMED	480 S	SFA TRAILER & SPEECH TRAILER	(1) (4) WOOD - NON SUSPECT ASBESTOS CONTAINING BUILDING MATERIAL.	N
M	2' X 4' FCP'S	65	NONE DETECTED	900 S	LIBRARY, COMPUTER ROOM, AND ROOMS 15-17	(13) SAMPLE HMS-CUSD-PART-200A COLLECTED 4-11-95.	N/A
M	DRYWALL	66	NONE DETECTED	400 S	COMPUTER ROOM	(13) SAMPLE HMS-CUSD-PART-201A COLLECTED 4-11-95.	N/A
M	12" VFT WHITE	103	ASSUMED	600 S	ROOMS 15-17	(1)	N

CONDITION CODE

General Condition: (1) Good (2) Damaged (3) Significantly Damaged (25% or more)
Change in Condition: (4) No (5) Yes (if Yes, explain under comments)
Abated: (6) Repaired (7) Removed (8) Encapsulated (9) Enclosed (10) Isolated & Restricted
Miscellaneous: (11) Inaccessible, no inspection data (12) Other (Explain under comments) (13) Non-Asbestos/Not Inspected

CONSULT ORIGINAL AND SUPPLEMENTARY INSPECTION REPORTS FOR MATERIALS WITH TRACE AMOUNTS OF ASBESTOS

**THREE-YEAR REINSPECTION
HOMOGENEOUS ACBM RECORDS**

Date of Inspection: April 15, 2004

District: Chico Unified School District

Inspector: John Angi

School: Partridge Elementary School

Building: Portables 18 & 19

Material Class	Material	Homo. Mat. #	% Asb.	F ² /L.F.	Location	Condition: Code & Comments	Friable Yes/No
M	12" VFT	51	ASSUMED	300 S	PORTABLES 18 & 19	(1) (4)	N
M	2' X 4' FCP'S	52	ASSUMED	1,000 S	PORTABLES 18 & 19	(1) (4)	N

CONDITION CODE

- General Condition: (1) Good (2) Damaged (3) Significantly Damaged (25% or more)
Change in Condition: (4) No (5) Yes (If Yes, explain under comments)
Abated: (6) Repaired (7) Removed (8) Encapsulated (9) Enclosed (10) Isolated & Restricted
Miscellaneous: (11) Inaccessible, no inspection data (12) Other (Explain under comments) (13) Non-Asbestos/Not Inspected

CONSULT ORIGINAL AND SUPPLEMENTARY INSPECTION REPORTS FOR MATERIALS WITH TRACE AMOUNTS OF ASBESTOS

**THREE-YEAR REINSPECTION
HOMOGENEOUS ACBM RECORDS**

Date of Inspection: April 15, 2004

District: Chico Unified School District

Inspector: John Angi

School: Partridge Elementary School

Building: Portables 1, 2, & 20

Material Class	Material	Homo. Mat. #	% Asb.	F ² /L.F.	Location	Condition: Code & Comments	Friable Yes/No
M	2' X 4' FCP'S	53	ASSUMED	600 S	PORTABLE #1	(1) (4)	N
M	2' X 4' FCP'S	54	ASSUMED	600 S	PORTABLE #20	(1) (4) FIBERGLASS - NON SUSPECT ASBESTOS CONTAINING BUILDING MATERIAL.	N
M	2' X 4' FCP'S	55	ASSUMED	600 S	ROOM #2	(1) (4)	N
M	12" VFT	61	ASSUMED	600 S	PORTABLE #1	(1) (4) SLIGHT CRACKS AT ENTRY WAY.	N
M	12" VFT	62	ASSUMED	600 S	PORTABLE #20	(1) (4)	N
M	9" VFT	63	ASSUMED	200 S	ROOM #2	(1) (4)	N
M	LINOLEUM TAN	100	ASSUMED	60 S	STORAGE AND GIRL'S & BOY'S RESTROOMS	(1)	N
M	GYP SUM BOARD	101	ASSUMED	300 S	STORAGE AND GIRL'S & BOY'S RESTROOMS	(1)	N

CONDITION CODE

- General Condition:** (1) Good (2) Damaged (3) Significantly Damaged (25% or more)
Change in Condition: (4) No (5) Yes (If Yes, explain under comments)
Abated: (6) Repaired (7) Removed (8) Encapsulated (9) Enclosed (10) Isolated & Restricted
Miscellaneous: (11) Inaccessible, no inspection data (12) Other (Explain under comments) (13) Non-Asbestos/Not Inspected

CONSULT ORIGINAL AND SUPPLEMENTARY INSPECTION REPORTS FOR MATERIALS WITH TRACE AMOUNTS OF ASBESTOS

FIRE/EARTHQUAKE DRILL EVACUATION ROUTE

*3rd floor evacuation by
9:20 on 1/24/07*

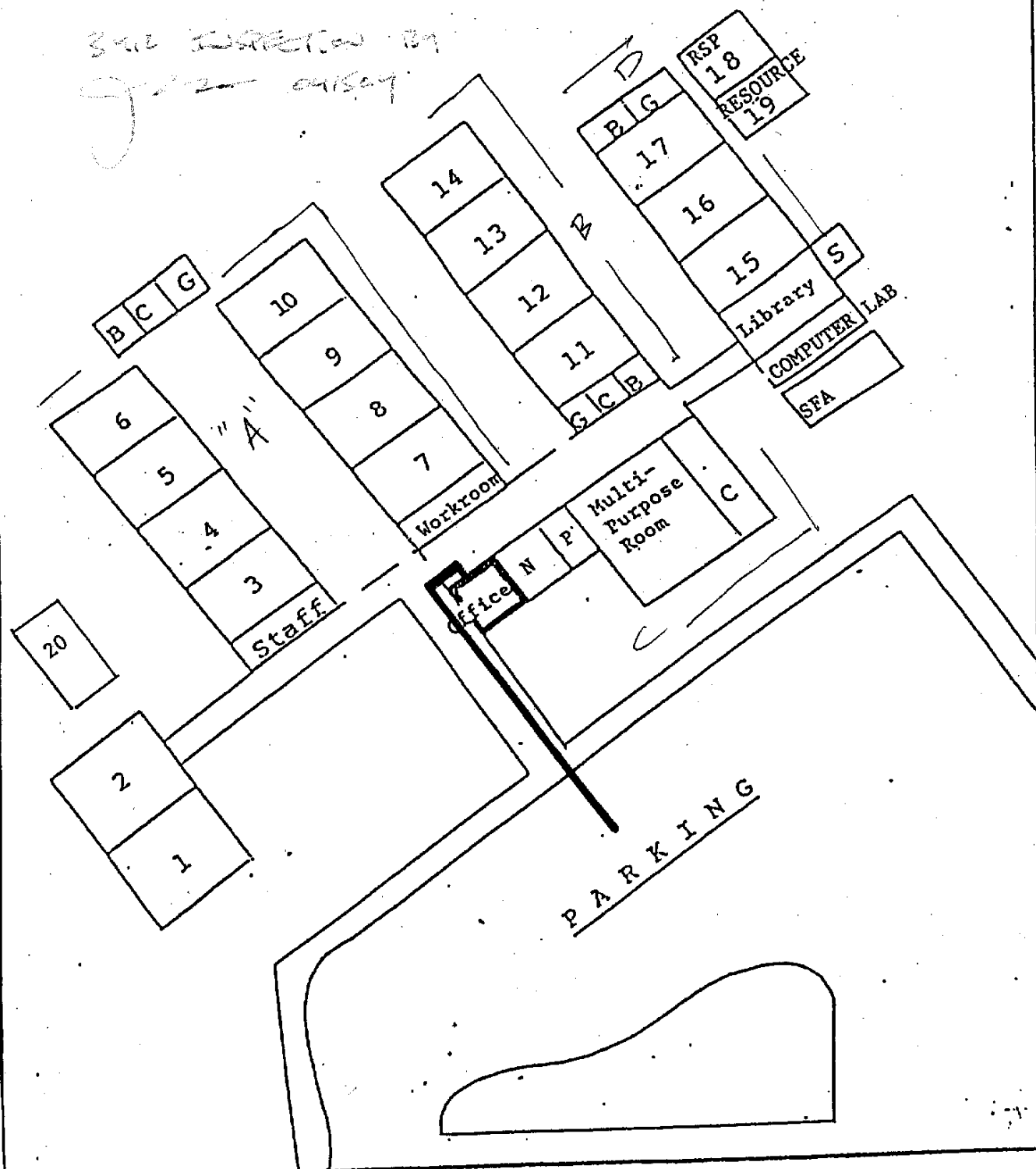

EAST AVENUE

State of California
Division of Occupational Safety and Health

Certified Asbestos Consultant

John A. Angi

Name

03-3330

Certification No.

4/23/2005

Expires on



This certification was issued by the Division of Occupational Safety and Health as authorized by Sections 7180 et seq. of the Business and Professions Code

Hazard Management Services, Inc.

This is to confirm that

John A. Angi

has attended the eight-hour

**AHERA Refresher Course for Asbestos Inspectors and
Management Planners**

and has completed the requisite training for asbestos accreditation under TSCA Title II

September 10, 2003

Certificate number: 14

Valid until: September 10, 2004

Cal/OSHA approval number: CA-025-06/CA-025-08



Tom Wangerin, MS, CAC
AHERA Training Director
Hazard Management Services, Inc.
367 Civic Drive, Suite 7
Pleasant Hill, CA 94523-1936
925-363-3442