

NEAL DOW ELEMENTARY SCHOOL  
CHICO UNIFIED SCHOOL DISTRICT  
CHICO, BUTTE CO., CALIFORNIA

DIAGRAM OF BUILDING AREA

<input checked="" type="checkbox"/> EXISTING	(1-A)
<input type="checkbox"/> BASIC PLANS	(2-A)
<input type="checkbox"/> FINAL PLANS	(3-A)

LEASED PORTABLE  
960 #1 APP.# 43407  
APPR. 2/87

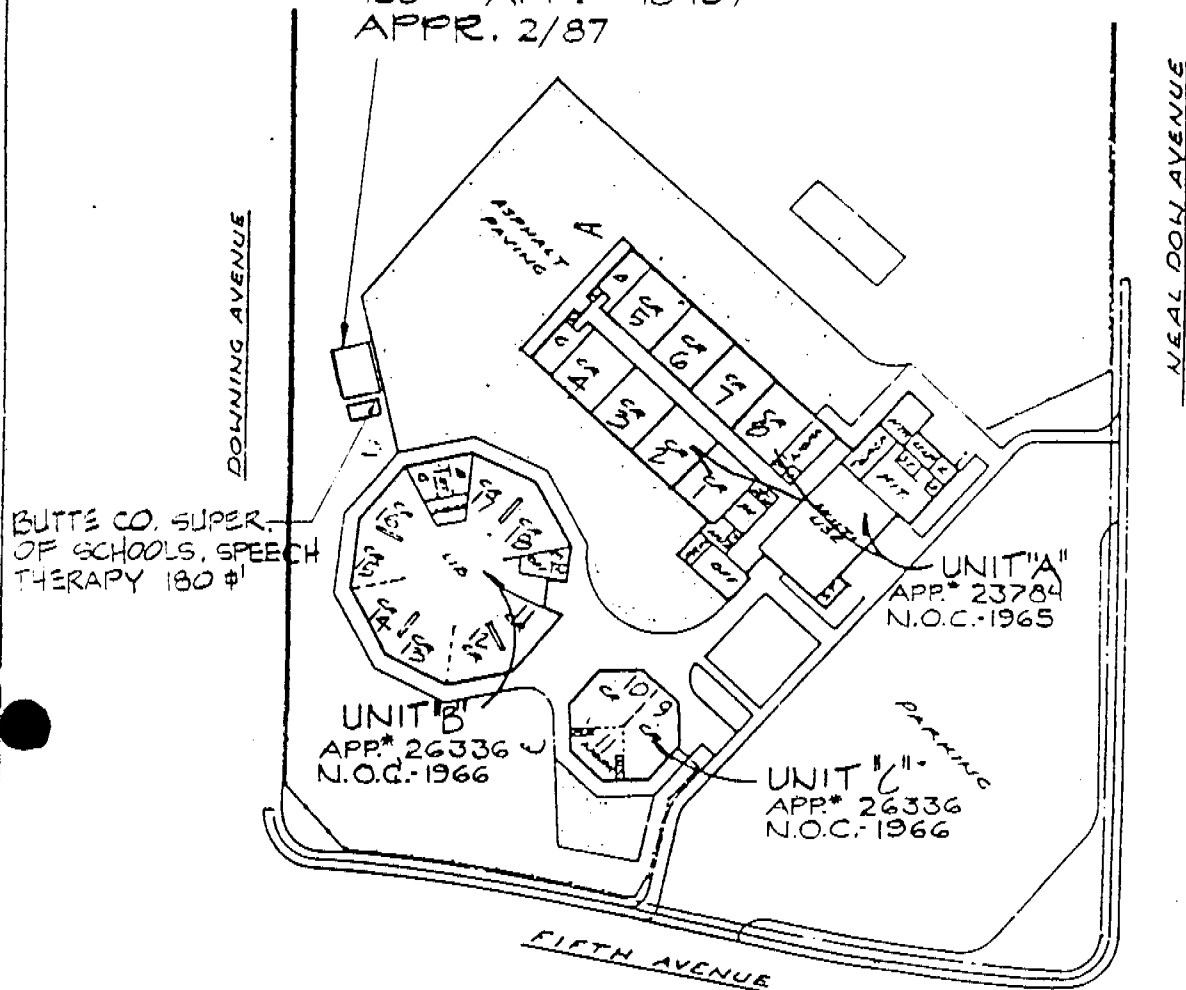

NEAL DOW SCHOOL  
Scale 1" = 50'

THIS DRAWING IS MEASURED IN ACCORDANCE WITH ART. 2022  
CHAPTER 8, TITLE 5, CALIF. ADMIN. CODE  
ARCHITECT

DATE: 3-24-87 SHEET 1 OF 7  
OFFICE OF THE STATE ARCHITECT

NEAL DOW ELEMENTARY SCHOOL  
 CHICO UNIFIED SCHOOL DISTRICT  
 CHICO, BUTTE CO., CALIFORNIA

DIAGRAM OF BUILDING AREA

- |  |       |
|--|-------|
| <input checked="" type="checkbox"/> EXISTING | (1-A) |
| <input type="checkbox"/> BASIC PLANS         | (2-A) |
| <input type="checkbox"/> FINAL PLANS         | (3-A) |

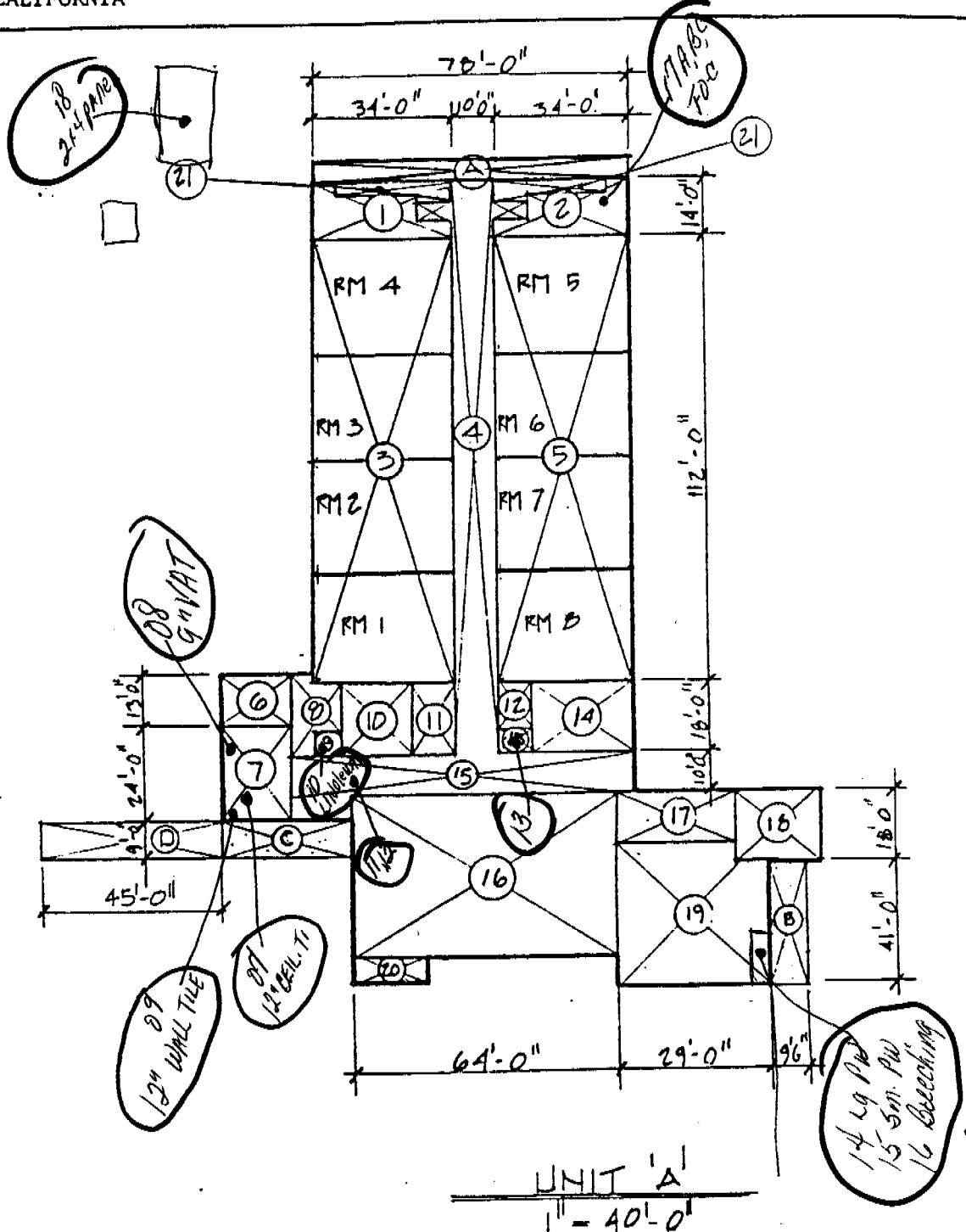

ABOVE IS MEASURED IN ACCORDANCE WITH ART. 2022  
 SUBCHAPTER 8, TITLE 5, CALIF. ADMIN. CODE  
 ARCHITECT

DATE: 3-24-87 SHEET 2 OF 7  
 OFFICE OF THE STATE ARCHITECT

## UNIT 'A' AREAS

1. TOILET	$(21.5 \times 10.25) + (4.83 \times 13) + (7.75 \times 4.5)$	=	318.03
2. TOILET	$(21.5 \times 10.25) + (4.83 \times 13) + (7.75 \times 4.5)$	=	318.03
3. CLASSRMS. (4)	$34' \times 112'$	=	3808
4. CLOSED CORR.	$10' \times 144' + (4.5 \times 775 \times 2)$	=	1509.75
5. CLASSRMS (4)	$34' \times 112'$	=	3800
6. PRINCIPAL	$13' \times 16' - 7\frac{3}{4}"$	=	216.5
7. OFFICE	$24' 6" \times 16' - 7\frac{3}{4}"$	=	408
8. NURSE	$12' \times 13' + 6' \times 7'$	=	196
9. TOILET	$6' - 4" \times 6' - 2"$	=	39
10. AUDIO VISUAL	$17' - 6" \times 18'$	=	315
11. TOILETS	$10' \times 18'$	=	180
12. SPEECH	$12' \times 8'$	=	96
13. JANITOR	$6' \times 8'$	=	48
14. LIBRARY STAFF RM.	$18' \times 26'$	=	468
15. CLOSED CORR.	$10' \times 18' 6" + 14' \times 5'$	=	256
16. MULTI-USE	$40' \times 64'$	=	2560
17. TEACHERS Supply Rm.	$13' \times 26'$	=	338
18. HEATER	$22' \times 18'$	=	396
19. KITCHEN	$29' \times 38' 6"$	=	1116.5
20. STORAGE	$7' 4" \times 18'$	=	132
21. PIPE STOR. & JAN.	$(21.5 \times 2.75) + (7.75 \times 4.0) \times 2$	=	180.25
TOTAL			<u>16,709.06' ±</u>
A COVERED CORR.	$5' \times 78' \times \frac{1}{3}$		128.7'
B	$9' - 6" \times 4' \times \frac{1}{3}$		128.5'
C	$9' \times 30' \times \frac{1}{3}$		89.1'
D	$9' \times 45' \times \frac{1}{3}$		133.65'
TOTAL			<u>479.95' ±</u>

NEAL DOW ELEMENTARY SCHOOL  
CHICO UNIFIED SCHOOL DISTRICT  
CHICO, BUTTE CO., CALIFORNIA

DIAGRAM OF BUILDING AREA

☒ EXISTING (1-A)  
☐ BASIC PLANS (2-A)  
☐ FINAL PLANS (3-A)

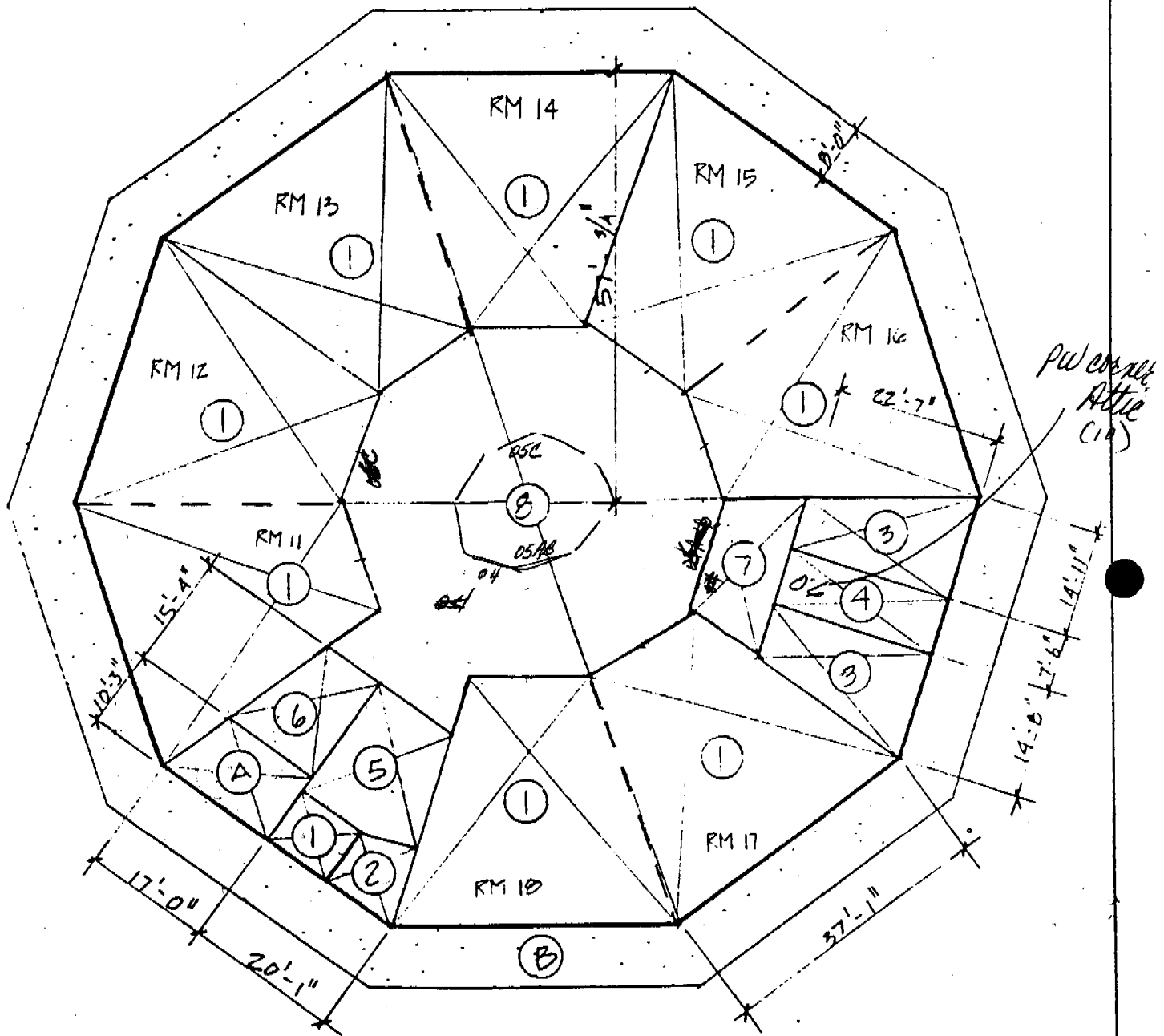

UNIT 1/8"  
1" = 20'-0"

THIS DRAWING IS MEASURED IN ACCORDANCE WITH ART. 2022  
SUBCHAPTER 8, TITLE 5, CALIF. ADMIN. CODE  
ARCHITECT

DATE: 3-24-87 SHEET 4 OF 7  
OFFICE OF THE STATE ARCHITECT

NEAL DOW ELEMENTARY SCHOOL  
CHICO UNIFIED SCHOOL DISTRICT  
CHICO, BUTTE CO., CALIFORNIA

DIAGRAM OF BUILDING AREA

☒ EXISTING (1-A)  
☐ BASIC PLANS (2-A)  
☐ FINAL PLANS (3-A)

BUILDING AREA - UNIT B

NO.	DESCRIPTION	WIDTH	LENGTH	FACTOR	AREA (S.F.)
1	CLASSRMS. (8)	25.87	30.33	8	6277.0968
2	STORAGE	7.5	22.58	1	169.35
3	BOYS AND GIRLS LAV.	22.16	22.58	1	500.3728
4	MENS AND WOMENS LAV.	7.5	20.08	1	150.6
5	WORK RM.	14	17.5	1	245
6	ENTRY	11	16	1	176
7	REFERENCE LIBRARY	20	13	1	260
8	LIBRARY	7.25	22.5	10	1631.25

SUB TOTAL = 9409.66

A	COVERED CORRIDOR	20	13	.33	85.8
B	COVERED CORRIDOR	39.5	8	.33	104.2

SUB TOTAL = 190.08

TOTAL

9,599.74

ABOVE IS MEASURED IN ACCORDANCE WITH ART. 2022  
SUBCHAPTER 8, TITLE 5, CALIF. ADMN. CODE  
ARCHITECT

DATE: 3-24-87 SHEET 5 OF 7  
OFFICE OF THE STATE ARCHITECT

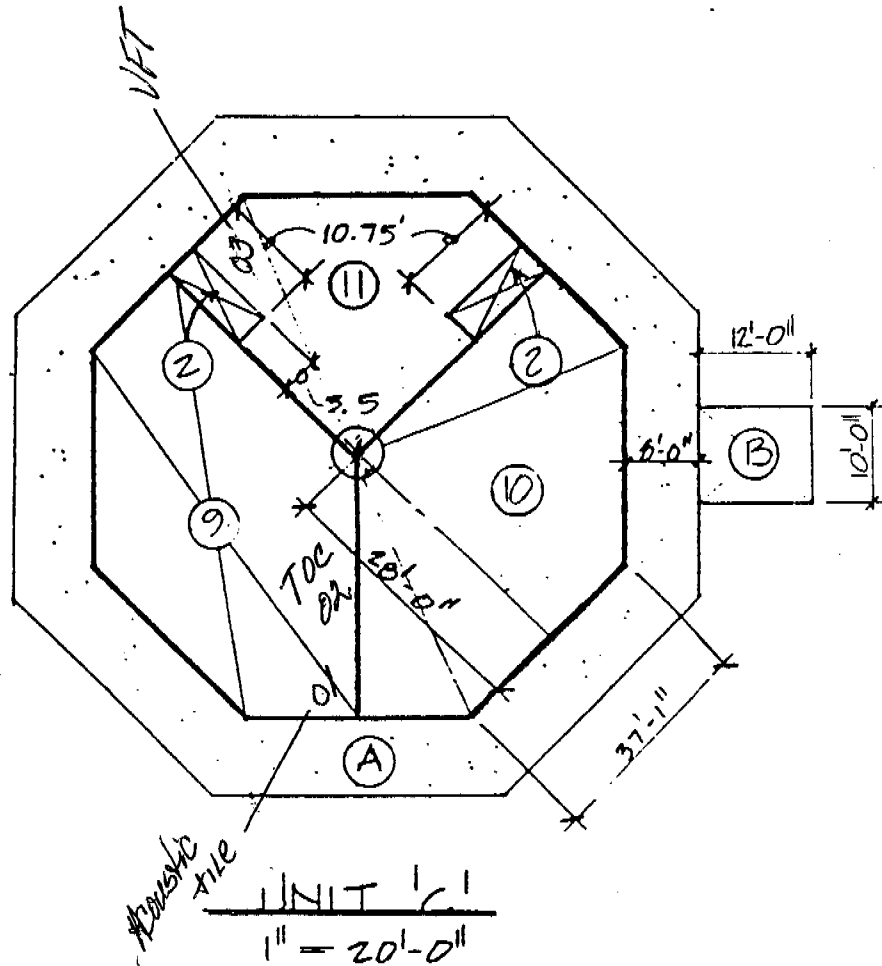

2. TOILETS	10.75' X 3.5' X 2	=	75.25
9. WORK RM.	14.58 X 28' X 1/2 X 6	=	1392.72
10. CLASSRM (KINDER.)	" " " "	=	1392.72
11. CLASSRM (KINDER.)	(14.58 X 28' X 1/2 X 4) - 75.25	=	853.23
TOTAL		=	3713.92' ±

A COVERED CORR.	39.5' X 8' X 8' X 1/3	=	834.24
B	12.0' X 10' X 1/3	=	39.6
TOTAL		=	873.84

SUMMARY OF AREAS

UNIT	
<i>Portables</i>	
UNIT "A"	1140.00
COVERED CORRIDORS @ 1/3	16,709.08
	479.95
UNIT "B"	
COVERED CORRIDORS @ 1/3	9,409.66
	190.00
UNIT "C"	
COVERED CORRIDORS @ 1/3	3,713.92
	873.84
TOTAL . . . .	31,376.53

TOTAL ~ 39316



Neal Dow Elementary  
Inspected 3/29/88



Neal Dow Elementary  
Boiler room



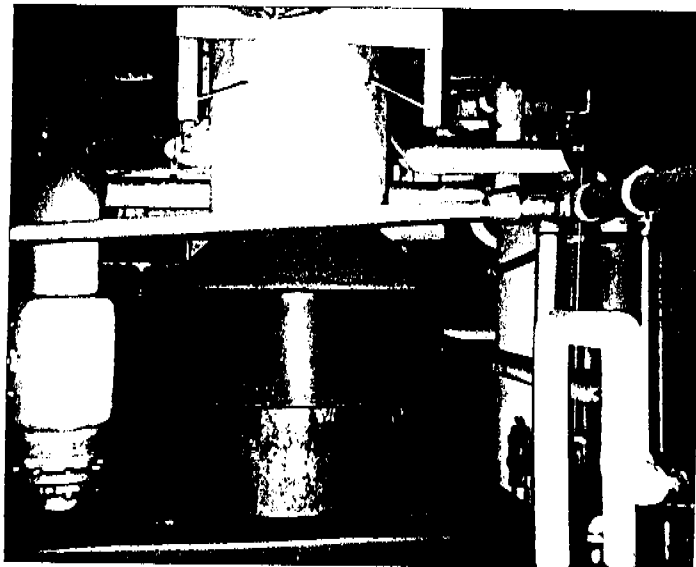

Neal Dow Elementary  
Boiler room

## HAZARD MANAGEMENT SERVICES, INC.

## Inspection Form I-1

DISTRICT \_\_\_\_\_

Page \_\_\_\_\_ of \_\_\_\_\_

SCHOOL NEAL DOWDate 3/29/88Building UNIT AInspector JESLocation BOILER RM  
(functional area)

HMS-Dow-16

Material: Surfacing TST Misc.% Asbestos 20-30Description PIPECHINEAmount of Material (NF / F) 10' L X 2' DIA (ft<sup>2</sup> / lf) Assumed ACM: Y / N # of samplesCONDITION: % damaged: 65/0 Extent of damage: 1  
0% <1% 1-10% 11-25% >25% none local distributed

Type damage: air; deterioration; water; physical; flaking

DESCRIPTION: \_\_\_\_\_

## POTENTIAL FOR DISTURBANCE:

Accessibility:	H	<u>M</u>	L
Vibration	H	M	<u>L</u>
Air Erosion	H	M	<u>L</u>
Water	H	M	<u>L</u>

## PREVENTATIVE MEASURES:

1. Fix Leaks
2. Prevent water contact
3. Do not DCSG
4. Do not affix signs/deco's
5. Avoid contact

COMMENTS: \_\_\_\_\_

## REMEDIAL ACTIONS

isolate/restrict repair/cleanup

enclose

encapsulate

remove

O&M

## ACBM Condition - Assessment

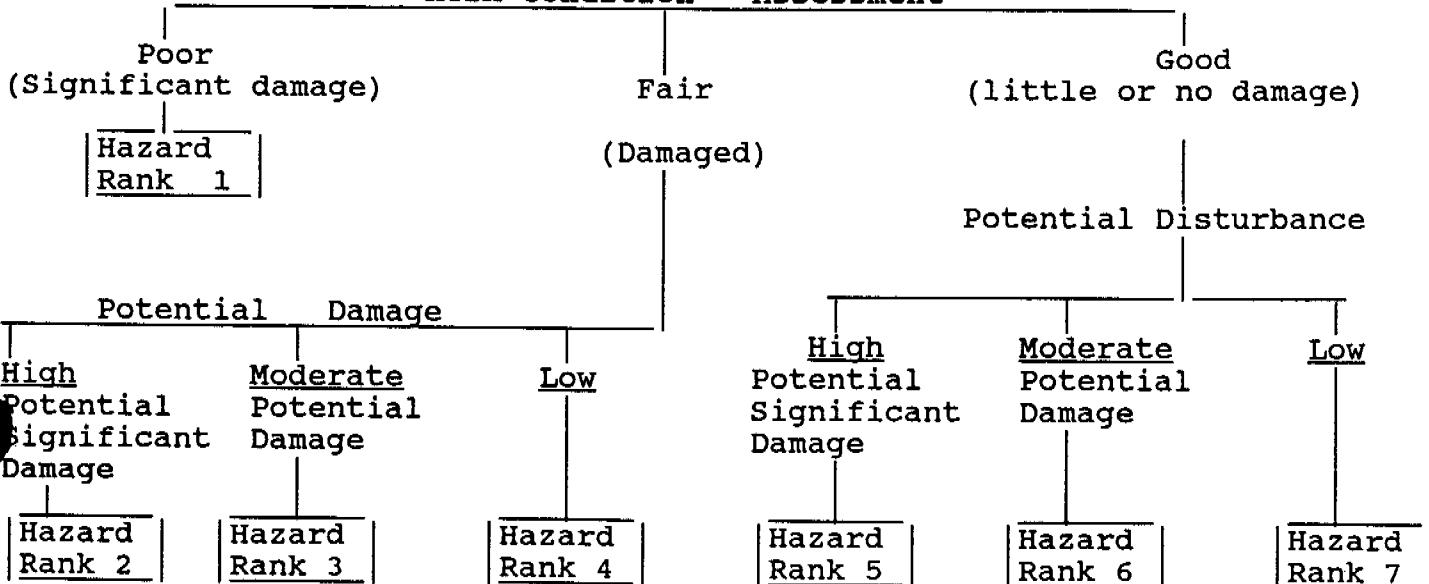

## HAZARD MANAGEMENT SERVICES, INC.

## Inspection Form I-1

DISTRICT \_\_\_\_\_  
 SCHOOL NEAL DOW  
 Building UNIT A  
 Location BOILER RM  
 (functional area)

Page \_\_\_\_\_ of \_\_\_\_\_

Date 3/29/88Inspector JESHMS-DOW-15

Material: Surfacing (TSI) Misc.  
 Description SM. DIA. PW STRAIGHT

% Asbestos 30-35

Amount of Material (NF / F) 70/0 (ft<sup>2</sup> (1f)) Assumed ACM: Y / N # of samples 1

CONDITION: % damaged: 0% <1% 1-10% 11-25% >25% (none) local distributed

Type damage: air; deterioration; water; physical; flaking

## DESCRIPTION:

## POTENTIAL FOR DISTURBANCE:

Accessibility: H (M) L  
 Vibration : H (M) (D)  
 Air Erosion : H M (D)  
 Water : H M (D)

## PREVENTATIVE MEASURES:

1. Fix Leaks
2. Prevent water contact
- (3) Do not DCSG
4. Do not affix signs/deco's
- (5) Avoid contact

## COMMENTS:

## REMEDIAL ACTIONS

isolate/restrict repair/cleanup

enclose

encapsulate

remove

O&M

## ACBM Condition - Assessment

Poor  
 (Significant damage)

Hazard  
 Rank 1

Fair  
 (Damaged)

Good  
 (little or no damage)

## Potential Disturbance

## Potential Damage

High  
 Potential  
 Significant  
 Damage

Hazard  
 Rank 2

Moderate  
 Potential  
 Damage

Hazard  
 Rank 3

Low

Hazard  
 Rank 4

High  
 Potential  
 Significant  
 Damage

Hazard  
 Rank 5

Moderate  
 Potential  
 Damage

Hazard  
 Rank 6

Low

Hazard  
 Rank 7

## HAZARD MANAGEMENT SERVICES, INC.

## Inspection Form I-1

DISTRICT \_\_\_\_\_

Page \_\_\_\_\_ of \_\_\_\_\_

SCHOOL NEAL DOWDate 3/29/88Building UNIT AInspector JESLocation BOILER RM  
(functional area)HMS DW - 14Material: Surfacing (TSI) Misc. % Asbestos 35-40  
Description LARGE DIA. PIPE WRAP STRAIGHTAmount of Material (NF / F) 105/0 (ft<sup>2</sup> / lf) Assumed ACM: Y / N # of samples 1CONDITION: % damaged: Extent of damage:  
0% <1% 1-10% 11-25% >25% (none) local distributed

Type damage: air; deterioration; water; physical; flaking

## DESCRIPTION:

## POTENTIAL FOR DISTURBANCE:

Accessibility:	H	<u>M</u>	L
Vibration :	H	M	<u>L</u>
Air Erosion :	H	M	<u>L</u>
Water :	H	M	<u>L</u>

## PREVENTATIVE MEASURES:

1. Fix Leaks
2. Prevent water contact
3. Do not DCSG
4. Do not affix signs/deco's
5. Avoid contact

## COMMENTS:

\_\_\_\_\_  
 \_\_\_\_\_  
 \_\_\_\_\_  
 \_\_\_\_\_  
 \_\_\_\_\_

## REMEDIAL ACTIONS

isolate/restrict repair/cleanup

enclose

encapsulate

remove

O&M

## ACBM Condition - Assessment

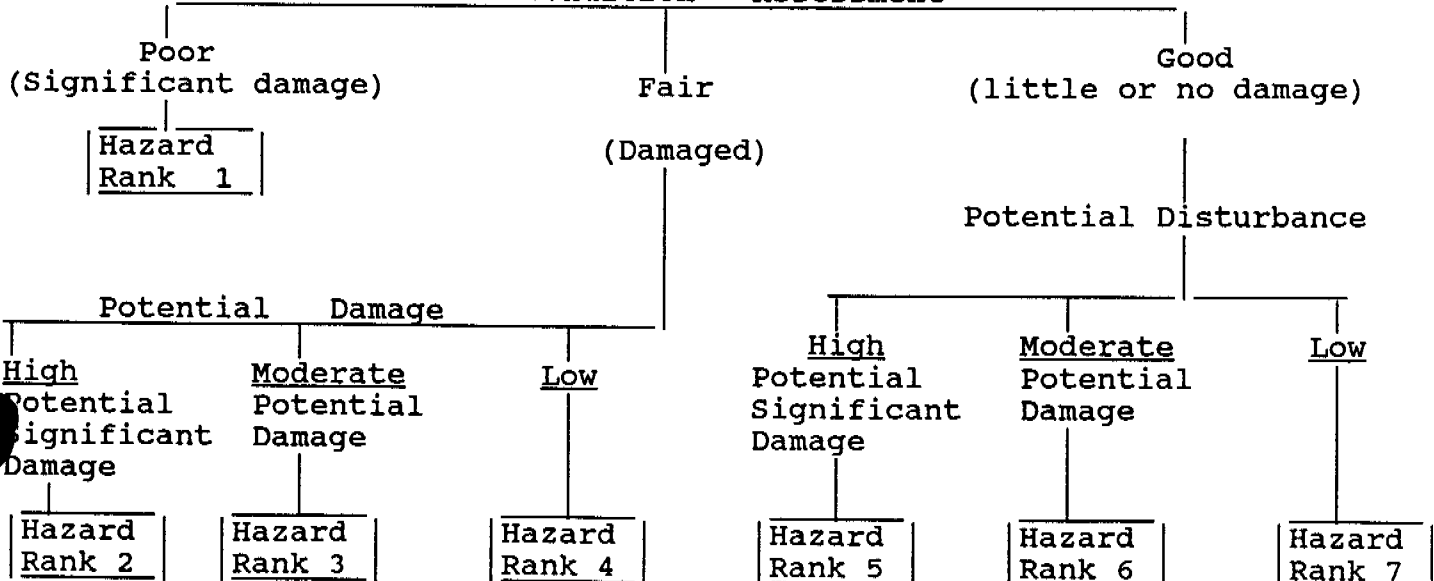

## HAZARD MANAGEMENT SERVICES, INC.

## Inspection Form I-1

DISTRICT \_\_\_\_\_

Page \_\_\_\_\_ of \_\_\_\_\_

SCHOOL NEAL DOWDate 3/29/88Building UNIT AInspector JESLocation ADMIN. ATTIC HALLWAY  
(functional area)HMS-DOW - 12Material: Surfacing (TSI) Misc.  
Description PIPE WRAP CORNER% Asbestos 25-30Amount of Material (NF / F) 4/0 (ft<sup>2</sup> 1f) Assumed ACM: Y / N # of samples 1

CONDITION: % damaged: Extent of damage:

0% <1% 1-10% 11-25% >25% none local distributed

Type damage: air; deterioration; water; physical; flaking

## DESCRIPTION:

## POTENTIAL FOR DISTURBANCE:

Accessibility: H M (L)  
 Vibration : H M (L)  
 Air Erosion : H M (L)  
 Water : H M (L)

## PREVENTATIVE MEASURES:

1. Fix Leaks
2. Prevent water contact
3. Do not DCSG
4. Do not affix signs/deco's
5. Avoid contact

## COMMENTS:

## REMEDIAL ACTIONS

isolate/restrict repair/cleanup

enclose

encapsulate

remove

O&M

## ACBM Condition - Assessment

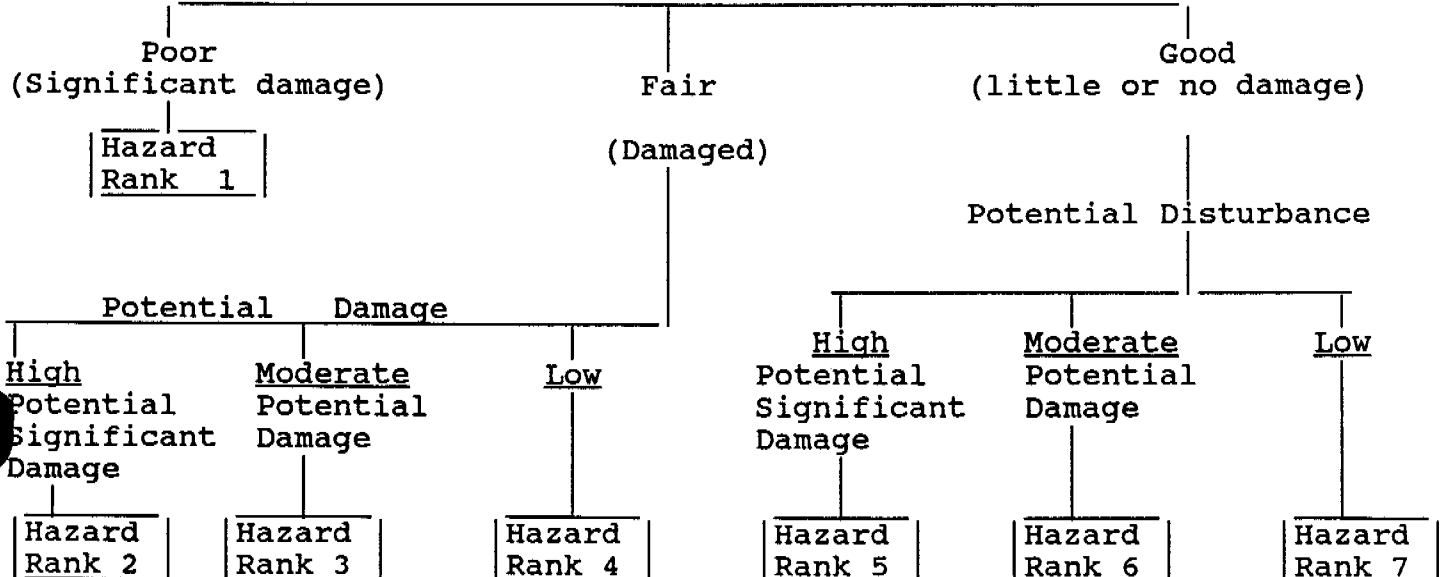

## HAZARD MANAGEMENT SERVICES, INC.

## Inspection Form I-1

DISTRICT \_\_\_\_\_

Page \_\_\_\_\_ of \_\_\_\_\_

SCHOOL NEAL DOWDate 3/29/88Building UNIT BInspector JESLocation ATTIC  
(functional area)HMS-DOW-06Material: Surfacing TSI Misc. \_\_\_\_\_  
Description MUDDY JOINT% Asbestos 25-30Amount of Material (NF / F) 10/0 (ft<sup>2</sup> 1f) Assumed ACM: Y / N # of samples 1

CONDITION: % damaged:

Extent of damage:

☒ 0%    ☐ <1%    ☐ 1-10%    ☐ 11-25%    ☐ >25%    
 ☒ none    ☐ local    ☐ distributed

Type damage: air; deterioration; water; physical; flaking

DESCRIPTION: \_\_\_\_\_  
\_\_\_\_\_  
\_\_\_\_\_

## POTENTIAL FOR DISTURBANCE:

## PREVENTATIVE MEASURES:

Accessibility: H M ☒ L  
 Vibration : H M ☒ L  
 Air Erosion : H M ☒ L  
 Water : H M ☒ L

1. Fix Leaks
2. Prevent water contact
3. Do not DCSG
4. Do not affix signs/deco's
- ☒ 5. Avoid contact

COMMENTS: \_\_\_\_\_  
\_\_\_\_\_  
\_\_\_\_\_  
\_\_\_\_\_  
\_\_\_\_\_

## REMEDIAL ACTIONS

isolate/restrict    repair/cleanup

enclose

encapsulate

remove

☒ O&M

## ACBM Condition - Assessment

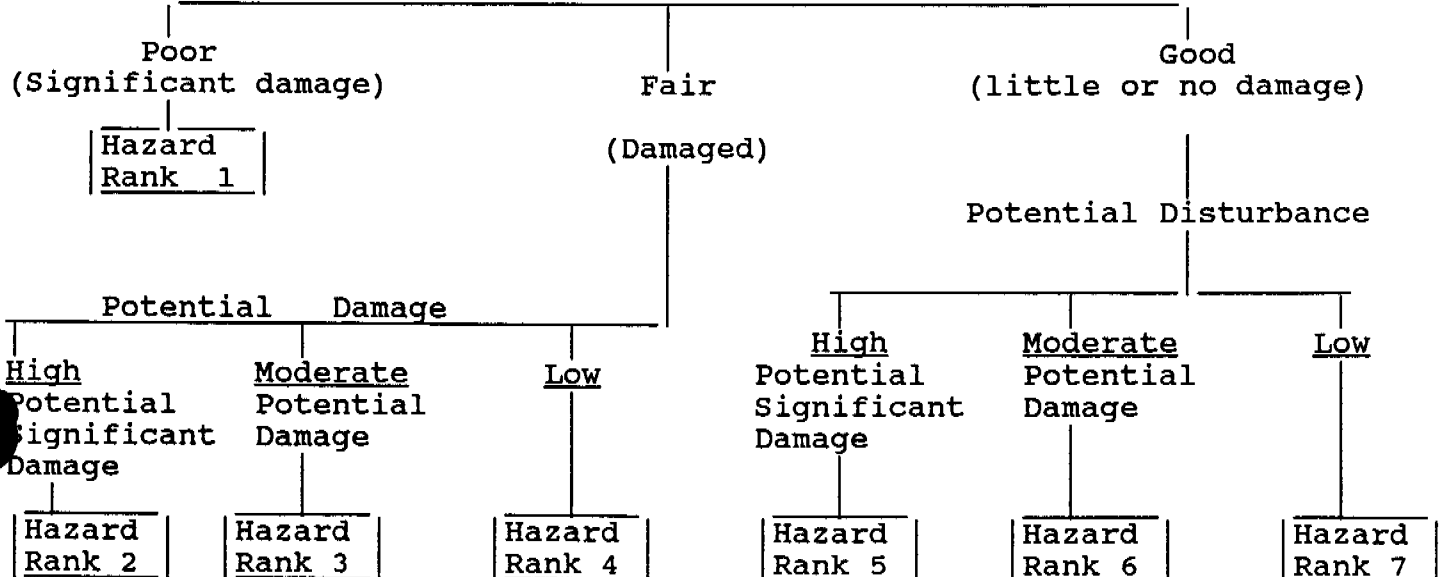

## HAZARD MANAGEMENT SERVICES, INC.

## Inspection Form I-1

DISTRICT \_\_\_\_\_

Page \_\_\_\_ of \_\_\_\_

SCHOOL NEAL DOW ELEMENTARYDate 3/29/88Building UNIT CInspector JESLocation KINDERGARDEN CENTER SECTION  
(functional area) RM 9HMS-DOW- 02A, B, C,Material: Surfacing TSI% Asbestos 1-5Description TROWELED ON DETLINGAmount of Material (NF / F) 700/0 (ft<sup>2</sup>/lf) Assumed ACM: Y / N # of samples 3

CONDITION: % damaged:

Extent of damage:

0% <1% 1-10% 11-25% >25% none local distributed

Type damage: air; deterioration; water; physical; flaking

DESCRIPTION:

No damage.

## POTENTIAL FOR DISTURBANCE:

## PREVENTATIVE MEASURES:

Accessibility: H M L  
 Vibration : H M L  
 Air Erosion : H M L  
 Water : H M L

1. Fix Leaks
2. Prevent water contact
3. Do not DCSG
4. Do not affix signs/deco's
5. Avoid contact

COMMENTS:

Do not contact

## REMEDIAL ACTIONS

isolate/restrict repair/cleanup

enclose

encapsulate

remove

O&M

## ACBM Condition - Assessment

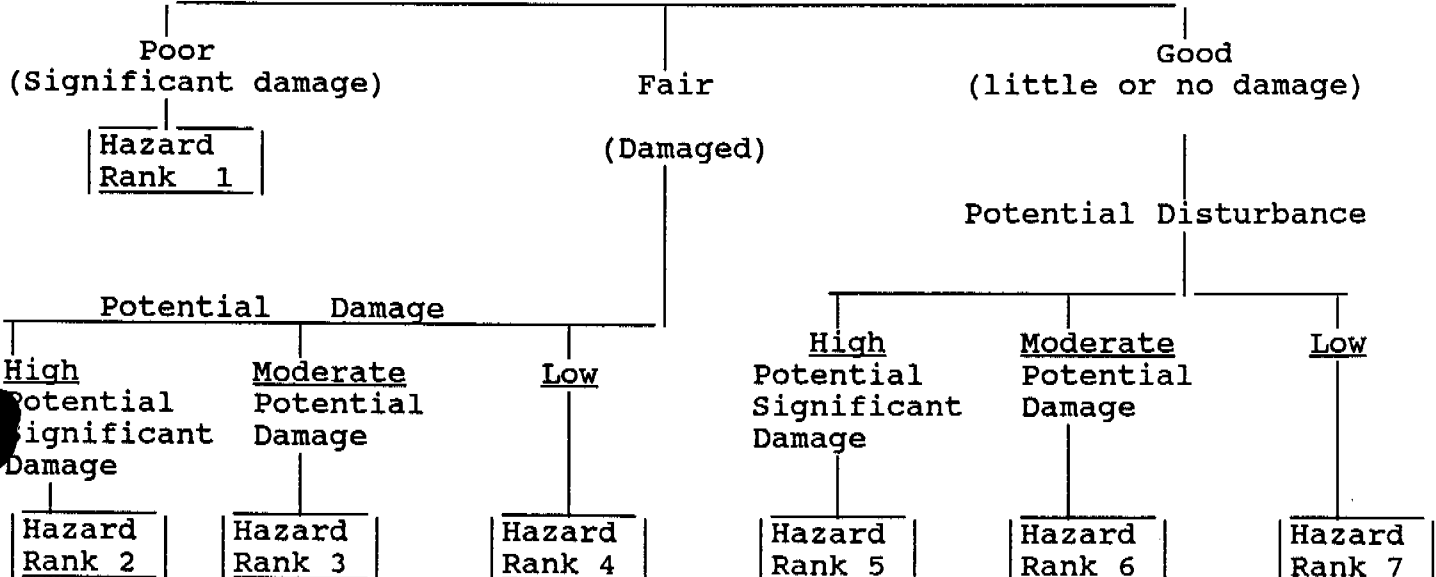

## HAZARD MANAGEMENT SERVICES, INC.

## Inspection Form I-1

DISTRICT \_\_\_\_\_

Page \_\_\_\_ of \_\_\_\_

SCHOOL NEAL DOWDate 3/29/88Building UNIT CInspector JESLocation RM 9  
(functional area)HMS-DOW-03Material: Surfacing TSI Misc  
Description VFT 9" BEIGE% Asbestos 1-5Amount of Material (NF / F) 240/0 (ft<sup>2</sup>/lf) Assumed ACM: Y / N # of samples 1CONDITION: % damaged: Extent of damage:  
0% <1% 1-10% 11-25% >25% none local distributed

Type damage: air; deterioration; water; physical; flaking

DESCRIPTION: \_\_\_\_\_  
\_\_\_\_\_  
\_\_\_\_\_

## POTENTIAL FOR DISTURBANCE:

Accessibility: H M L  
Vibration : H M L  
Air Erosion : H M L  
Water : H M L

## PREVENTATIVE MEASURES:

1. Fix Leaks
2. Prevent water contact
3. Do not DCSG
4. Do not affix signs/deco's
5. Avoid contact

COMMENTS: \_\_\_\_\_  
\_\_\_\_\_  
\_\_\_\_\_  
\_\_\_\_\_  
\_\_\_\_\_REMEDIAL ACTIONS  
isolate/restrict repair/cleanup  
enclose encapsulate  
remove O&M

## ACBM Condition - Assessment

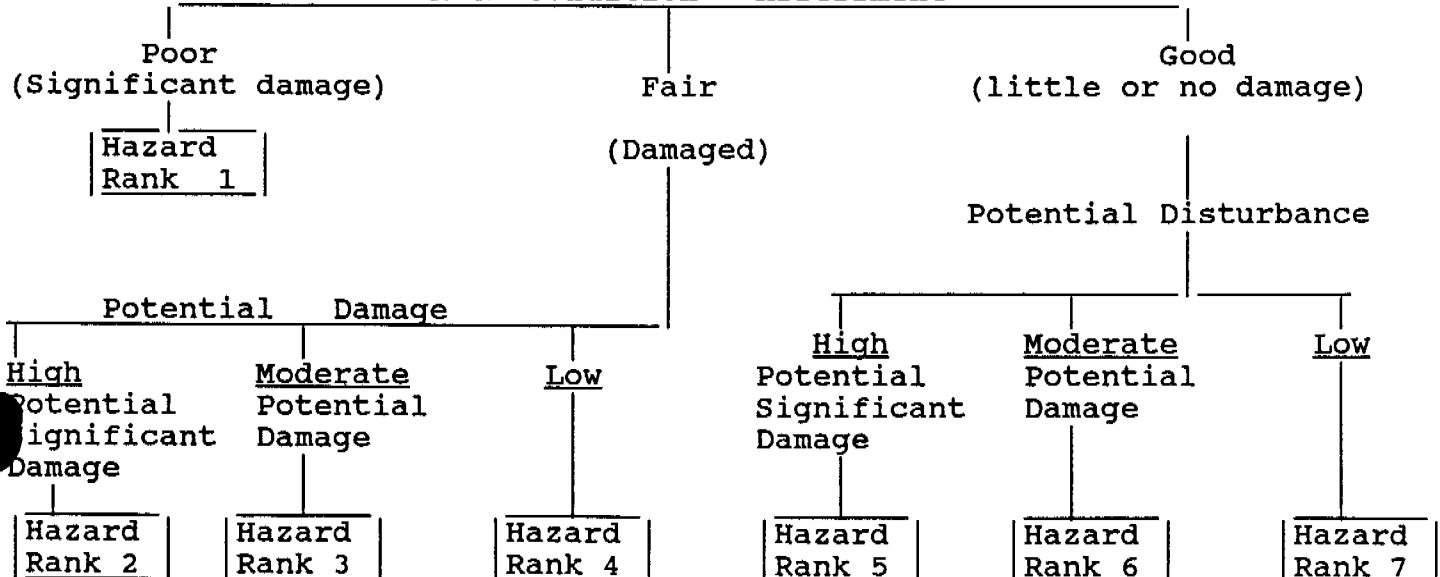



## HAZARD MANAGEMENT SERVICES, INC.

## Inspection Form I-1

DISTRICT \_\_\_\_\_

Page \_\_\_\_\_ of \_\_\_\_\_

SCHOOL NEAL DOWDate 3/29/88Building UNIT-BInspector JESLocation ROUNDHOUSE QUAD / CENTER CEILING  
(functional area)

HMS-DOW - OSA B C

Material: Surfacing TSI MISC % Asbestos 1-5  
Description TOCAmount of Material (NF / F) 260 / 0 (ft<sup>2</sup> / lf) Assumed ACM: Y / N # of samples 3CONDITION: % damaged: Extent of damage:  
0% <1% 1-10% 11-25% >25% none local distributed

Type damage: air; deterioration; water; physical; flaking

DESCRIPTION:  
\_\_\_\_\_  
\_\_\_\_\_  
\_\_\_\_\_

## POTENTIAL FOR DISTURBANCE:

## PREVENTATIVE MEASURES:

Accessibility:	H	M	<u>L</u>
Vibration	H	M	<u>L</u>
Air Erosion	H	M	<u>L</u>
Water	H	M	<u>L</u>

1. Fix Leaks
2. Prevent water contact
3. Do not DCSG
4. Do not affix signs/deco's
5. Avoid contact

COMMENTS:  
\_\_\_\_\_  
\_\_\_\_\_  
\_\_\_\_\_  
\_\_\_\_\_  
\_\_\_\_\_

REMEDIAL ACTIONS  
isolate/restrict repair/cleanup

enclose encapsulate

remove O&M

## ACBM Condition - Assessment

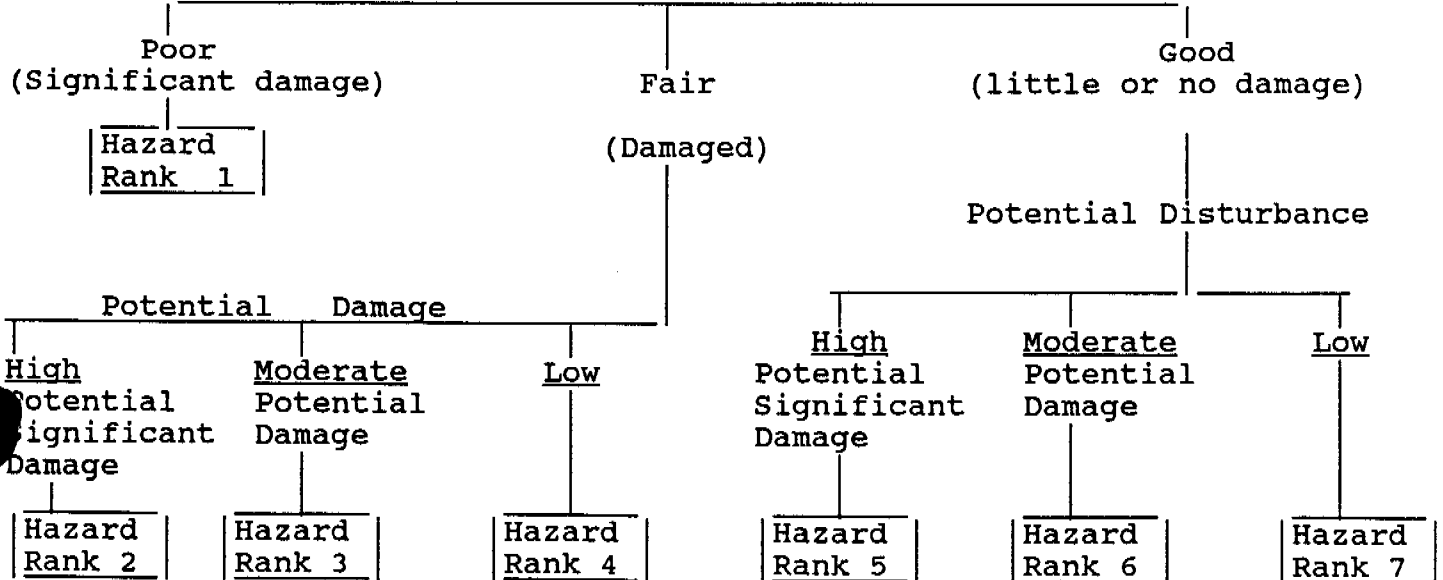

## HAZARD MANAGEMENT SERVICES, INC.

## Inspection Form I-1

DISTRICT \_\_\_\_\_

Page \_\_\_\_ of \_\_\_\_

SCHOOL NEAL DOWDate 3/29/88Building UNIT AInspector JESLocation ADMIN. OFFICE & HALLWAY  
(functional area)HMS-DOW - 08Material: Surfacing TSI MISC % Asbestos 1-5  
Description VFT 9" BEIGEAmount of Material (NF / F) 18,407/0 (ft<sup>2</sup>/lf) Assumed ACM: Y / N # of samples 1CONDITION: % damaged: Extent of damage:  
0% <1% 1-10% 11-25% >25% none local distributed

Type damage: air; deterioration; water; physical; flaking

## DESCRIPTION:

## POTENTIAL FOR DISTURBANCE:

## PREVENTATIVE MEASURES:

Accessibility: H M L  
Vibration : H M L  
Air Erosion : H M L  
Water : H M L

1. Fix Leaks
2. Prevent water contact
3. Do not DCSG
4. Do not affix signs/deco's
5. Avoid contact

## COMMENTS:

## REMEDIAL ACTIONS

isolate/restrict repair/cleanup

enclose encapsulate

remove

O&M

## ACBM Condition - Assessment

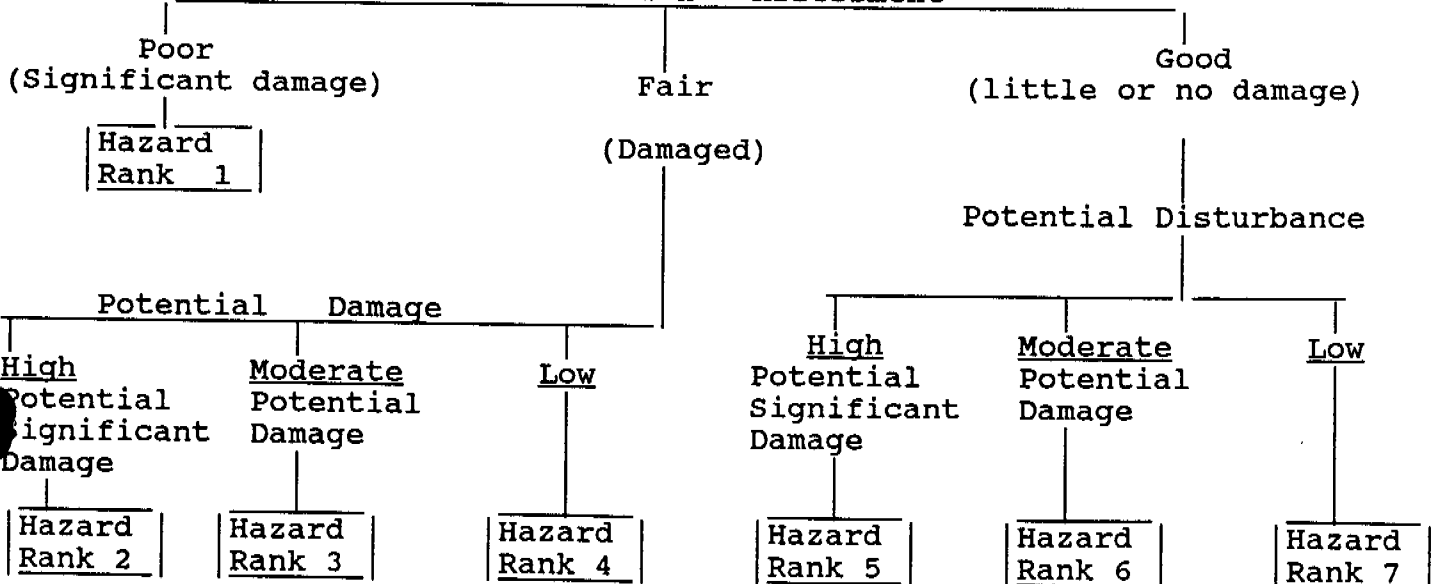

## HAZARD MANAGEMENT SERVICES, INC.

## Inspection Form I-1

DISTRICT \_\_\_\_\_

Page \_\_\_\_\_ of \_\_\_\_\_

SCHOOL NEAL DOWDate 3/29/88Building UNIT AInspector JESLocation NURSES OFFICE RR  
(functional area)HMS DOW-10Material: Surfacing TSI Misc % Asbestos 5-10  
Description LINOLEUMAmount of Material (NF / F) 36/0 (ft<sup>2</sup>) lf) Assumed ACM: Y / N # of samples 1CONDITION: % damaged: Extent of damage:  
0% <1% 1-10% 11-25% >25% none local distributed

Type damage: air; deterioration; water; physical; flaking

## DESCRIPTION:

## POTENTIAL FOR DISTURBANCE:

## PREVENTATIVE MEASURES:

Accessibility: H M L  
Vibration : H M L  
Air Erosion : H M L  
Water : H M L

1. Fix Leaks
2. Prevent water contact
3. Do not DCSG
4. Do not affix signs/deco's
5. Avoid contact

## COMMENTS:

## REMEDIAL ACTIONS

isolate/restrict repair/cleanup

enclose

encapsulate

remove

O&M

## ACBM Condition - Assessment

Poor  
(Significant damage)

Fair

Good  
(little or no damage)Hazard  
Rank 1

(Damaged)

## Potential Disturbance

## Potential Damage

High  
Potential  
Significant  
DamageModerate  
Potential  
Damage

Low

High  
Potential  
Significant  
DamageModerate  
Potential  
Damage

Low

Hazard  
Rank 2Hazard  
Rank 3Hazard  
Rank 4Hazard  
Rank 5Hazard  
Rank 6Hazard  
Rank 7

HMS, Inc.  
HAZARD MANAGEMENT SERVICES, INC.  
209-577-8209

---

DATE: May 4, 1988

TO: Asbestos Hazard Emergency Response Act (AHERA) Clients

FROM: James E Sharp, President

RE: Adjusted Asbestos Inspection Schedule

This is an update on HMS, Inc.'s schedule to inspect your school facilities for asbestos in compliance with the Environmental Protection Agency's Asbestos Hazard Emergency Response Act (AHERA). As you know there have been several interpretations of the rules which have caused delays. Since both the EPA and the Office of Local Assistance regulate how the inspections are to be conducted and how the management plans are to be submitted, we have maintained constant communications with both agencies. I think they have their act together now.

Another factor which has caused delay is the add-ons we have experienced in over half of the districts we have inspected. The AHERA regulation says that all buildings owned, leased, or otherwise used as school buildings shall be inspected. This includes district offices, maintenance buildings, bus garages, dormitories, nightwatchmen's homes (if owned by the school), outdoor education facilities, etc. If you own buildings that are abandoned or leased out to others, you do not have to inspect them unless you use them for storage or if any maintenance or custodial personnel provide services there. Of course, if you plan to reoccupy a site, you must inspect it thirty days prior to reoccupancy. Please carefully evaluate your sites so we can accurately anticipate the time and personnel necessary to keep our schedules.

Many of you have already sent in your SP-1A's or similar drawings. We use these to evaluate the time and personnel necessary to complete a districts inspections. I'm sure you are aware that many of these drawings are old and inaccurate. Usually, there have been portables added (sometimes removed), but the add-ons must be inspected. One or two additional portables have little impact, but one district had seventeen extra portables. Of greater impact is the addition of maintenance facilities, outdoor education centers, or other sites which you may not think need to be inspected. Please evaluate all the facilities within your district's uses so that we know, in advance, how to plan our time.

Below you will find a current schedule for our AHERA inspections.

HMS, Inc.  
HAZARD MANAGEMENT SERVICES, INC.  
209-577-8209

---

TO: AHERA Clients

FROM: James E Sharp, President  
Hazard Management Services, Inc.

DATE: July 11, 1988

RE: OLA-AHERA Forms

Within the past few days you have received from the Office of Local Assistance copies of the AHERA MANAGEMENT PLAN REQUIRED FORMS. These long-awaited forms will now enable us to complete your asbestos inspection and management plan reports. It will be necessary for you to complete the first two sections of the AHERA General Data Form A for each site in your District. Then you must send these forms to HMS, Inc. immediately (no later than July 30, 1988).

You will have to make copies of this form so that you complete one for each site. For instance, if you have four separate schools, a district office, a maintenance yard, a bus garage and, perhaps, a separate Special Ed site, you would have to complete eight of the Form A sheets.

You must complete the GENERAL DATA section of the sheet which includes the name of the LEA, the school name, address and phone number, its CDS code, its enrollment and the number of school employees. Hazard Management Services, Incorporated (HMS, Inc.) will complete the number of buildings at each site.

In the LEA AHERA DESIGNEE section you must name the person who will be in charge of your ongoing management plan. You must complete the designee's name, address and phone number. HMS, Inc. will complete the designee's training data.

HMS, Inc. will complete the remainder of the OLA Management Plan (FORMS B-H). In order to tailor the data for your district we will be in contact with you or your AHERA designee. As soon as we complete the forms, they will be returned to you for appropriate signatures so that you can send them to the Office of Local Assistance.

If you have not received these forms please call David Smith of OLA at (916) 445-5177. If you still have questions, please call HMS, Inc. at (209) 577-8209 in Modesto or (916) 723-4350 in Sacramento.

Please complete your sections of Form A and send it to HMS, Inc. immediately. Thank you.

HMS, Inc.  
HAZARD MANAGEMENT SERVICES, INC.  
209-577-8209

---

TO: AHERA Clients

FROM: James E Sharp, President  
Hazard Management Services, Inc.

DATE: July 11, 1988

RE: AHERA-required School Documents

Hazard Management Services, Incorporated (HMS, Inc.) has been unable to secure certain documents from many of our clients which are needed to develop AHERA management plans. Perhaps we have been asking the wrong people because it has become evident in many schools that previous inspections and asbestos abatement projects have occurred but we have not received records which document these activities.

In order for your AHERA management plan to be correctly completed records of asbestos inspections and asbestos abatement activities must be included. Under 40 CFR Part 763 of AHERA the following documentation of asbestos-related activity prior to December 14, 1987 is required:

1. Date of inspection;
2. Location and square or linear footage of sampled material;
3. Laboratory analysis report;
4. Records of any abatement work undertaken. These abatement records should include, if applicable, the names and addresses of contractors, start and completion dates of the work, and air sampling analysis reports.

If your district has undertaken any abatement activities since December 14, 1987, then you must have all abatement related documentation required by AHERA under Section 763.94. Your records should include the following:

1. Description of action and method used;
2. Location of the abatement activity;
3. Reasons for selecting the measure or action;
4. Start and completion dates of the work;
5. Names and addresses of all contractors;
6. Contractor certification and accreditation documentation;

TO: AHERA Clients  
DATE: July 11, 1988  
RE: AHERA-required School Documents  
Page Two

7. Name and location of waste disposal site (waste manifest);
8. Name and signature of person(s) doing clearance air sampling;
9. Dates and locations of air samples;
10. Laboratory report including a statement that the laboratory meets the applicable requirements of AHERA.

All districts were required to maintain records of inspections for asbestos that were done to satisfy the Asbestos-in-Schools rule of May 27, 1982. We ask that you send us copies of these records so that we may incorporate them into the management plan as required. Send us, also, copies of your records documenting abatement activity prior to and after December 14, 1987. If you have no records, please notify us in writing.

Thank you for your cooperation. If you have any questions regarding these records or other AHERA-related matters, please feel free to call us at (209) 577-8209.

Send copies of records to P.O. Box 7012, Modesto, CA 95355-7012.

Sincerely,

Shirley Cartwright  
Project Coordinator

jrs

HMS, Inc.  
HAZARD MANAGEMENT SERVICES, INC.  
209-577-8209

---

DATE: August 15, 1988

FROM: James E Sharp, President, Hazard Management Services, Incorporated (HMS, Inc.)

TO: AHERA Clients

RE: LEA AHERA Designee

Thank you for sending your OLA AHERA forms to us. Those districts which have not yet selected an LEA AHERA Designee, please notify our office as soon as you have made your decision. Remember, this should be the person in charge of asbestos matters for the entire district. The most common selections are superintendents, assistant superintendents in charge of business, and heads of maintenance. Once again, please make this decision soon and notify our office promptly. We strongly recommend your LEA AHERA Designee attend the two-hour training program (mandatory for all maintenance and custodial personnel) which will be taking place soon.