



Bulk Asbestos Analysis

(EPA Method 600/R-93-116, Visual Area Estimation)

Chico Unified School Dist
Leroy Christophersen

2455 Carmichael Drive
Chico, CA 95928



Client ID: 2921
Report Number: B094136
Date Received: 01/08/07
Date Analyzed: 01/10/07
Date Printed: 01/10/07
First Reported: 01/10/07

Job ID/Site: Neal Dow Elementary School - PO# 050289

Date(s) Collected: 01/04/2007

FASI Job ID: 2921

Total Samples Submitted: 8

Total Samples Analyzed: 8

Sample ID	Lab Number	Asbestos Type	Percent in Layer	Asbestos Type	Percent in Layer	Asbestos Type	Percent in Layer
ND01	10597255						
Layer: Black Tar Stones			ND				
Layer: Black Felt			ND				
Layer: Black Tar			ND				
Layer: Black Felt			ND				
Layer: Black Tar			ND				
Layer: Black Felt			ND				
Layer: Black Tar			ND				
Layer: Black Felt			ND				
Total Composite Values of Fibrous Components:		Asbestos (ND)					
Cellulose (Trace)	Fibrous Glass (45 %)						
Comment: Bulk complex sample.							
ND02	10597256						
Layer: Black Tar Stones			ND				
Layer: Black Felt			ND				
Layer: Black Tar			ND				
Layer: Black Felt			ND				
Layer: Black Tar			ND				
Layer: Black Felt			ND				
Layer: Black Tar			ND				
Layer: Black Felt			ND				
Total Composite Values of Fibrous Components:		Asbestos (ND)					
Cellulose (Trace)	Fibrous Glass (45 %)						
Comment: Bulk complex sample.							
ND03	10597257						
Layer: Black Tar Stones			ND				
Layer: Black Felt			ND				
Layer: Black Tar			ND				
Layer: Black Felt			ND				
Layer: Black Tar			ND				
Layer: Black Felt			ND				
Layer: Black Tar			ND				
Layer: Black Felt			ND				
Total Composite Values of Fibrous Components:		Asbestos (ND)					
Cellulose (Trace)	Fibrous Glass (45 %)						
Comment: Bulk complex sample.							



Client Name: Chico Unified School Dist

Report Number: B094136

Date Printed: 01/10/07

Sample ID	Lab Number	Asbestos Type	Percent in Layer	Asbestos Type	Percent in Layer	Asbestos Type	Percent in Layer
ND04	10597258						
Layer: Black Tar Stones			ND				
Layer: Black Felt			ND				
Layer: Black Tar			ND				
Layer: Black Felt			ND				
Layer: Black Tar			ND				
Layer: Black Felt			ND				
Layer: Black Tar			ND				
Layer: Black Felt			ND				

Total Composite Values of Fibrous Components: Asbestos (ND)

Cellulose (Trace) Fibrous Glass (45 %)

Comment: Bulk complex sample.

ND05	10597259						
Layer: Black Tar			ND				
Layer: Black Felt			ND				
Layer: Black Tar			ND				
Layer: Black Felt			ND				
Layer: Black Tar			ND				
Layer: Black Felt			ND				
Layer: Black Tar			ND				
Layer: Black Felt			ND				
Layer: Black Tar			ND				
Layer: Black Felt			ND				

Total Composite Values of Fibrous Components: Asbestos (ND)

Cellulose (Trace) Fibrous Glass (50 %)

Comment: Bulk complex sample.

ND06	10597260						
Layer: Black Tar			ND				
Layer: Black Felt			ND				
Layer: Black Tar			ND				
Layer: Black Felt			ND				
Layer: Black Tar			ND				
Layer: Black Felt			ND				
Layer: Black Tar			ND				
Layer: Black Felt			ND				
Layer: Black Tar			ND				
Layer: Black Felt			ND				

Total Composite Values of Fibrous Components: Asbestos (ND)

Cellulose (Trace) Fibrous Glass (50 %)

Comment: Bulk complex sample.



Forensic Analytical

Client Name: Chico Unified School Dist

Report Number: B094136

Date Printed: 01/10/07

Sample ID	Lab Number	Asbestos Type	Percent in Layer	Asbestos Type	Percent in Layer	Asbestos Type	Percent in Layer
ND07	10597261						
Layer: Black Tar			ND				
Layer: Black Felt			ND				
Layer: Black Tar			ND				
Layer: Black Felt			ND				
Layer: Black Tar			ND				
Layer: Black Felt			ND				
Layer: Black Tar			ND				
Layer: Black Felt			ND				
Layer: Black Tar			ND				
Layer: Black Felt			ND				

Total Composite Values of Fibrous Components: Asbestos (ND)

Cellulose (Trace) Fibrous Glass (50 %)

Comment: Bulk complex sample.

ND08	10597262						
Layer: Black Tar			ND				
Layer: Black Felt			ND				
Layer: Black Tar			ND				
Layer: Black Felt			ND				
Layer: Black Tar			ND				
Layer: Black Felt			ND				
Layer: Black Tar			ND				
Layer: Black Felt			ND				
Layer: Black Tar			ND				
Layer: Black Felt			ND				

Total Composite Values of Fibrous Components: Asbestos (ND)

Cellulose (Trace) Fibrous Glass (50 %)

Comment: Bulk complex sample.

James Flores, Laboratory Supervisor, Hayward Laboratory

Note: Limit of Quantification ('LOQ') = 1%. 'Trace' denotes the presence of asbestos below the LOQ. 'ND' = 'None Detected'.

Analytical results and reports are generated by Forensic Analytical at the request of and for the exclusive use of the person or entity (client) named on such report. Results, reports or copies of same will not be released by Forensic Analytical to any third party without prior written request from client. This report applies only to the sample(s) tested. Supporting laboratory documentation is available upon request. This report must not be reproduced except in full, unless approved by Forensic Analytical. The client is solely responsible for the use and interpretation of test results and reports requested from Forensic Analytical. This report must not be used by the client to claim product endorsement by NVLAP or any other agency of the U.S. Government. Forensic Analytical is not able to assess the degree of hazard resulting from materials analyzed. Forensic Analytical reserves the right to dispose of all samples after a period of thirty (30) days, according to all state and federal guidelines, unless otherwise specified. All samples were received in acceptable condition unless otherwise noted.



Forensic Analytical

Analysis Request Form

Client Name & Address: Chico Unified School District 2455 Carmichael Drive Chico, CA 95928		P.O. #: 050289 Date: 11/4/07
Contact: Leroy A. Christophersen Phone #: 530 891-3195 Fax#: (530) 891-3190		Turn Around Time: _____ hr/ 12hr / 24hr / 48 hr / ext: _____ Due Date: / / Due Time: : am/pm <input checked="" type="checkbox"/> PLM: <input checked="" type="checkbox"/> Standard / <input type="checkbox"/> Point Count <input type="checkbox"/> PCM: NIOSH 7400
Site: Neal Doro Job: Roof project		<input type="checkbox"/> TEM Air: <input type="checkbox"/> AHERA / <input type="checkbox"/> Yamate2 / <input type="checkbox"/> NIOSH 7402 <input type="checkbox"/> TEM Bulk: <input type="checkbox"/> Quantitative / <input type="checkbox"/> Qualitative / <input type="checkbox"/> Chatfield <input type="checkbox"/> TEM Water: <input type="checkbox"/> Potable / <input type="checkbox"/> Non-Potable / <input type="checkbox"/> Wt % <input type="checkbox"/> TEM Microvac <input type="checkbox"/> Special Project:
Comments:		<input type="checkbox"/> Metals Analysis: Method _____ Matrix: _____ Analytes: _____

Sample ID	Date/Time	Sample Location/Description	FOR AIR SAMPLES ONLY				Sample Area or Air Volume
			Type	Time On/Off	Avg. LPM	Total Time	
ND01	11/4/07	Roof material - black	A P C				
ND02			A P C				
ND03			A P C				
ND04			A P C				
ND05			A P C				
ND06			A P C				
ND07			A P C				
ND08			A P C				
			A P C				

Sampled by: Leroy Christophersen Date: 11/4/07 Time: _____		
Shipped via: <input type="checkbox"/> Fed Ex <input checked="" type="checkbox"/> Airborne <input type="checkbox"/> UPS <input type="checkbox"/> US Mail <input type="checkbox"/> Courier <input type="checkbox"/> Drop Off <input type="checkbox"/> Other:		
Relinquished by: Date / Time:	Relinquished by: Date / Time:	Relinquished by: Date / Time:
Received by: [Signature] Date / Time: 11/8/07 10:30 Condition Acceptable? <input checked="" type="checkbox"/> Yes <input type="checkbox"/> No	Received by: Date / Time: Condition Acceptable? <input type="checkbox"/> Yes <input type="checkbox"/> No	Received by: Date / Time: Condition Acceptable? <input type="checkbox"/> Yes <input type="checkbox"/> No

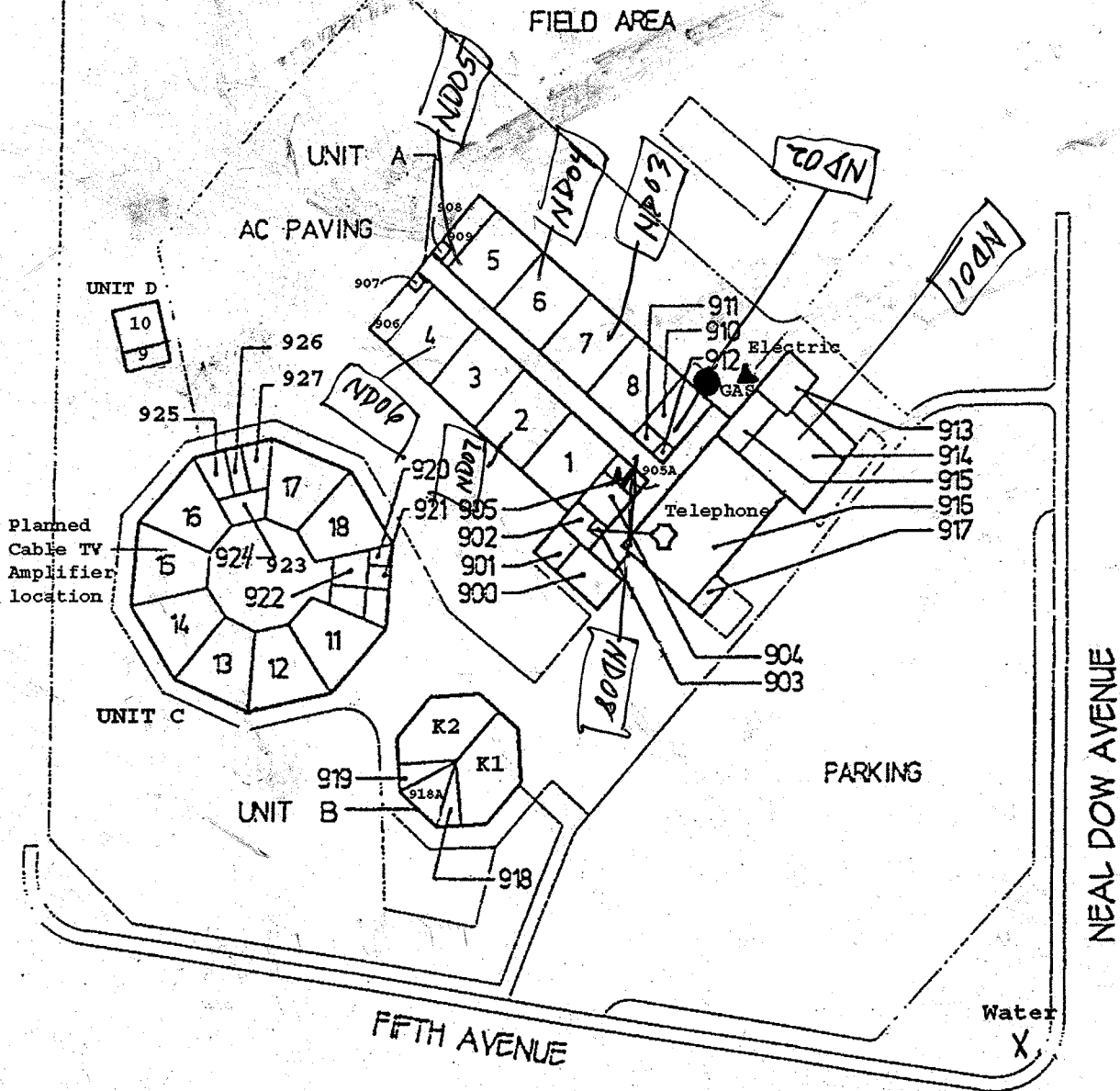

NEAL DOW ELEMENTARY SCHOOL

Updated 9/2006

Maintenance and Operations
2455 Carmichael Drive
Chico, CA 95928
Phone: (530) 891-3195
Fax: (530) 891-3190

Chico Unified School District

Fed Ex Airbill #8358 1795 1179

January 05, 2007

Forensic Analytical Specialties, Inc.
3777 Depot Road, Suite 409
Hayward, CA 94545

Re: Neal Dow Elementary School

To Whom It May Concern:

Please test the enclosed samples from the Neal Dow Elementary School Unit A roof for Asbestos. We would like a 48-hour turnaround on the sample. Please e-mail the results as soon as they are available to lcristo@chicousd.org.

Site Sampled:

Neal Dow elementary School

Location: Unit A Roof

Date Sampled:

January 4, 2007

Number of Samples:

Eight (8) ND01 – ND08

Thank you for your prompt response to this request.

Sincerely,

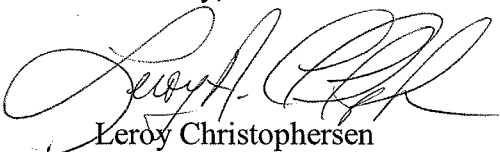

Leroy Christophersen
Safety & Loss Coordinator

Enclosures



Bulk Asbestos Analysis

(EPA Method 600/R-93-116, Visual Area Estimation)

Chico Unified School Dist
Leroy Christophersen

2455 Carmichael Drive
Chico, CA 95928

Client ID: 2921
Report Number: B102231
Date Received: 07/31/07
Date Analyzed: 08/02/07
Date Printed: 08/02/07
First Reported: 08/02/07

Job ID/Site: Neal Dow Elementary School, Unit A kitchen/MPR tile - PO# 070280

FASI Job ID: 2921

Date(s) Collected: 07/30/2007

Total Samples Submitted: 1

Total Samples Analyzed: 1

Sample ID	Lab Number	Asbestos Type	Percent in Layer	Asbestos Type	Percent in Layer	Asbestos Type	Percent in Layer
ND001	10666277						
Layer: Beige Tile		Chrysotile	3 %				
Layer: Black Mastic		Chrysotile	7 %				
Total Composite Values of Fibrous Components:		Asbestos (3%)					
Cellulose (Trace)							

James Flores, Laboratory Supervisor, Hayward Laboratory

Note: Limit of Quantification ('LOQ') = 1%. 'Trace' denotes the presence of asbestos below the LOQ. 'ND' = 'None Detected'.

Analytical results and reports are generated by Forensic Analytical at the request of and for the exclusive use of the person or entity (client) named on such report. Results, reports or copies of same will not be released by Forensic Analytical to any third party without prior written request from client. This report applies only to the sample(s) tested. Supporting laboratory documentation is available upon request. This report must not be reproduced except in full, unless approved by Forensic Analytical. The client is solely responsible for the use and interpretation of test results and reports requested from Forensic Analytical. This report must not be used by the client to claim product endorsement by NVLAP or any other agency of the U.S. Government. Forensic Analytical is not able to assess the degree of hazard resulting from materials analyzed. Forensic Analytical reserves the right to dispose of all samples after a period of thirty (30) days, according to all state and federal guidelines, unless otherwise specified. All samples were received in acceptable condition unless otherwise noted.



Forensic Analytical

Analysis Request Form

Client Name & Address: Chico Unified School District		P.O. #: 070280	Date: 7/30/07
2455 Carmichael Drive		Turn Around Time: _____ hr/ 12hr / 24hr / <u>48 hr</u> / ext: _____	
Chico, CA 95928		Due Date: ____/____/____ Due Time: ____:____ am/pm	
Contact: Leroy Christophersen	Phone #: 530-891-3195	<input checked="" type="checkbox"/> PLM: <input checked="" type="checkbox"/> Standard / <input type="checkbox"/> Point Count <input type="checkbox"/> PCM: NIOSH 7400	
Fax#: (530) 891-3190	<input type="checkbox"/> TEM Air: <input type="checkbox"/> AHERA / <input type="checkbox"/> Yamate2 / <input type="checkbox"/> NIOSH 7402		
Site: Neal Dow	<input type="checkbox"/> TEM Bulk: <input type="checkbox"/> Quantitative / <input type="checkbox"/> Qualitative / <input type="checkbox"/> Chatfield		
Job:	<input type="checkbox"/> TEM Water: <input type="checkbox"/> Potable / <input type="checkbox"/> Non-Potable / <input type="checkbox"/> Wt %		
Comments:		<input type="checkbox"/> TEM Microvac	
		<input type="checkbox"/> Special Project:	
		<input type="checkbox"/> Metals Analysis: Method _____	
		Matrix: _____	
		Analytes: _____	

Sample ID	Date/Time	Sample Location/Description	FOR AIR SAMPLES ONLY				Sample Area or Air Volume
			Type	Time On/Off	Avg. LPM	Total Time	
ND001	7/30	Kitchen Tile/Creme	A P C				
			A P C				
			A P C				
			A P C				
			A P C				
			A P C				
			A P C				
			A P C				
			A P C				

Sampled by: <u>Bob Michael</u>		Date: <u>7/30/07</u> Time: _____	
Shipped via: <input type="checkbox"/> Fed Ex <input type="checkbox"/> Airborne <input type="checkbox"/> UPS <input type="checkbox"/> US Mail <input type="checkbox"/> Courier <input type="checkbox"/> Drop Off <input type="checkbox"/> Other:			
Relinquished by:	Relinquished by:	Relinquished by:	
Date / Time:	Date / Time:	Date / Time:	
Received by: <u>[Signature]</u>	Received by: <u>[Signature]</u>	Received by: <u>[Signature]</u>	
Date / Time: <u>7/31/07</u>	Date / Time: <u>10:30</u>	Date / Time:	
Condition Acceptable? <input checked="" type="checkbox"/> Yes <input type="checkbox"/> No	Condition Acceptable? <input type="checkbox"/> Yes <input type="checkbox"/> No	Condition Acceptable? <input type="checkbox"/> Yes <input type="checkbox"/> No	

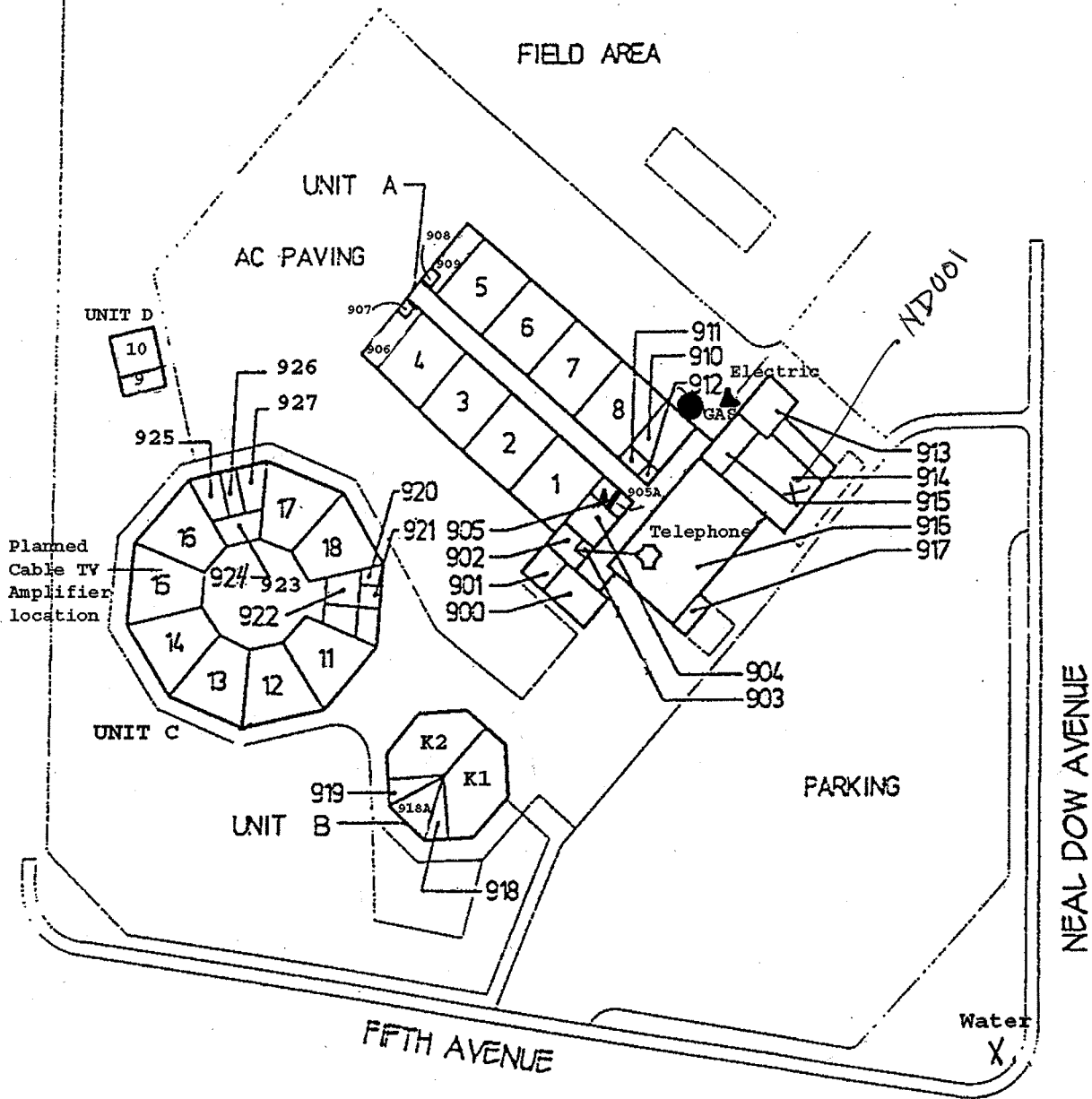

NEAL DOW ELEMENTARY SCHOOL

Updated 9/2006

Maintenance and Operations
2455 Carmichael Drive
Chico, CA 95928
Phone: (530) 891-3195
Fax: (530) 891-3190

Chico Unified School District

Fed Ex Airbill #

July 30, 2007

Forensic Analytical Specialties, Inc.
3777 Depot Road, Suite 409
Hayward, CA 94545

Re: Neal Dow Elementary School

To Whom It May Concern:

Please test the enclosed samples from the Neal Dow Elementary School Unit A kitchen/MPR tile for Asbestos. We would like a 48-hour turnaround on the sample. Please e-mail the results as soon as they are available to lchristo@chicousd.org.

Site Sampled:

Neal Dow elementary School

Location: Unit A Roof

Date Sampled:

July 30, 2007

Number of Samples:

One ND001

Thank you for your prompt response to this request.

Sincerely,



Leroy Christophersen
Safety & Loss Coordinator

Enclosures