



**Administrative Offices** 1163 E. Seventh Street Chico, CA 95928-5999  
phone: (530) 891-3000 • fax: (530) 891-3220 • [www.ChicoUSD.org](http://www.ChicoUSD.org)

## Appendix B - Scope of work and School Diagrams

CHAPMAN ELEMENTARY	1071 East 16th Street	Chico, CA 95928	(530) 891-3100
ACADEMY FOR CHANGE	290 East Avenue	Chico, CA 95926	(530) 895-4047
FAIR VIEW HIGH (CONTINUATION)	290 East Avenue	Chico, CA 95926	(530) 891-3092
Center for Alternative Learning	290 East Ave	Chico, CA 95926	(530) 891-3092
CITRUS AVENUE ELEMENTARY	1350 Citrus Avenue	Chico, CA 95926	(530) 891-3107
MCMANUS (JOHN A.) ELEMENTARY	988 East Avenue	Chico, CA 95926	(530) 891-3128

# Citrus

Room	MDF/IDF Location	Switches	used/ports	Copper Uplink	Fiber Uplink	New Wireless AP	New Cat 6 Cabling	New Fiber	New Data Cabinet
928	MDF	3750G-12S			6				
928	MDF	3560-48PS					8		
928	MDF	3560-48PS							
914	IDF	3560-48PS			1	1		upgrade 50u	
914	IDF	3560-48PS			1			upgrade 50u	
23	IDF	3560-48PS			1		14	upgrade 50u	
13	IDF	3560-48PS			1		14	upgrade 50u	
13	IDF	3560-48PS			1			upgrade 50u	
21	IDF	3560-48PS			1		14	upgrade 50u	
12	Lab	3560-48PS		1	new 6 strd		2	Install 50u	
1							14		
2							14		
3							14		
4							14		
5							14		
6						1	14		
7							14		
8						1	14		
9							14		
10							14		
11	new lab					1	48		
14							14		
15							14		
16							14		
17							14		
18						1	14		
MPR							14		
933						1	14		
admin							8		
24						1	14		
25							14		
<b>Total</b>								<b>374</b>	

**Notes:**

All existing fiber upgraded to 50u

IDF in Hall (Unit C) upgrade existing copper to 50u fiber

New Wireless AP's get two Cat 6 drops each

Demo existing CAT 5 and CAT5e and replace with CAT6

Rooms to have 12 available drops plus 2 for wireless except Main Office

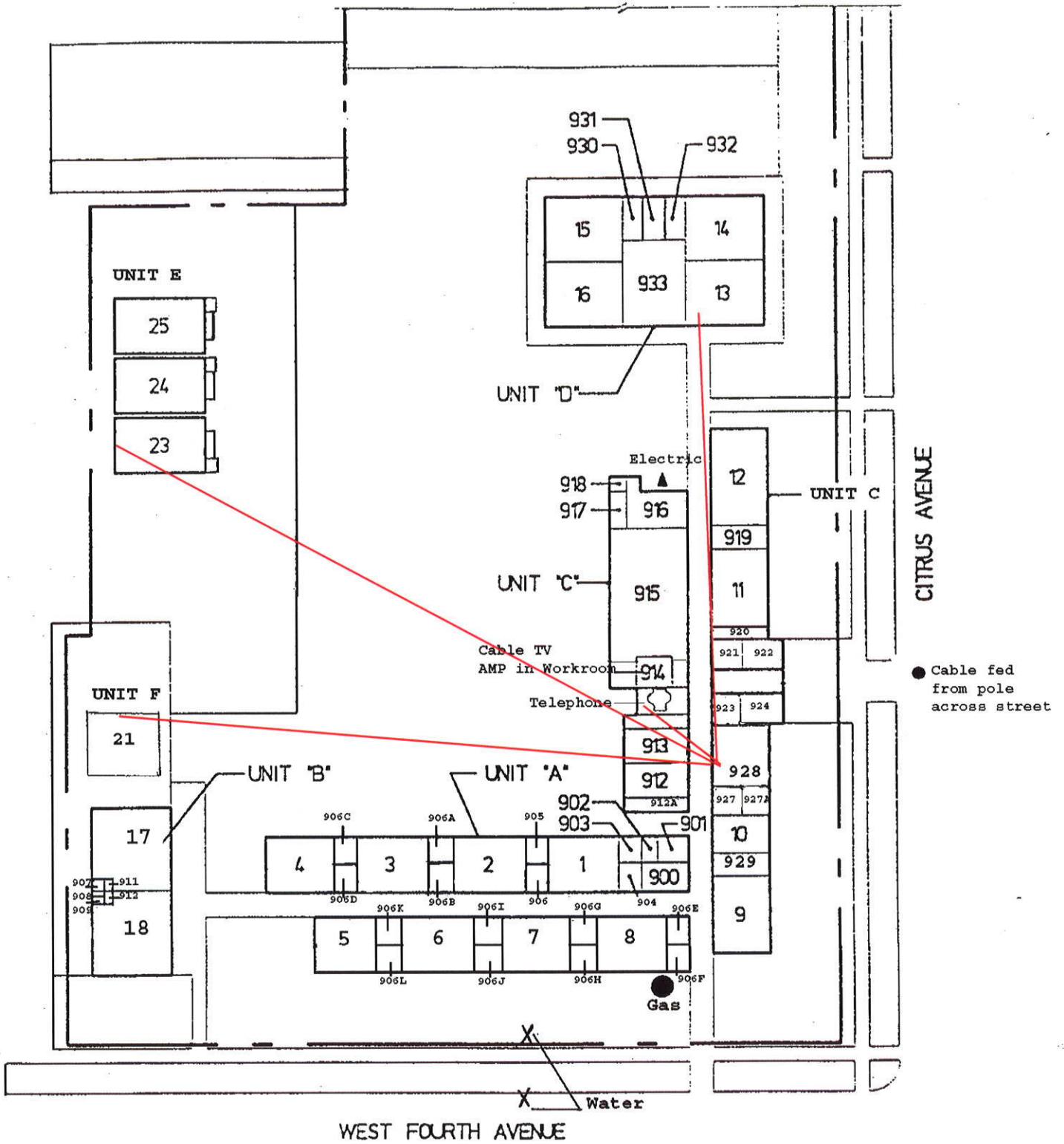

# CITRUS ELEMENTARY SCHOOL

Updated 9/2006

# Chapman

Room	MDF/IDF Location	Switches	used/ports	Copper Uplink	Fiber Uplink	New Wireless AP	New Cat 6 Cabling	New Fiber	New Data C24	
903	MDF Library	3750G-12S		5	3	1	14			
903	MDF Library	3550-48								
903	MDF Library	3560-24PS								
7	IDF 7	3550-48		1		1	14		new upgrade 50u	
907	IDF 907	3550-48		1					new upgrade 50u	
907	IDF 907	3550-48		1					new upgrade 50u	
907	IDF 907	3560-24PS		1					new upgrade 50u	
3	IDF 3	3560-24PS		1			14		new upgrade 50u	
4	IDF 4	3550-48			1	1	14		upgrade 50u	
27	IDF 27	3560-48PS			1	1	14		upgrade 50u	
24	IDF 24	3560-24PS			1	1	14		upgrade 50u	
1							14			
2							14			
5							14			
6							14			
8							14			
9							14			
10							14			
11							14			
12							14			
13							14			
14							14			
15							14			
16							14			
17						1	14			
18							14			
19							14			
20							14			
21						1	14			
22							14			
23							14			
25							14			
26							14			
28							14			
admin							16			
mpr						1	8			
<b>Total</b>								430		

**Notes:**

- All existing fiber upgraded to 50u
- IDF in Hall (Unit C) upgrade existing copper to 50u fiber
- New Wireless AP's get two Cat 6 drops each
- Demo existing CAT 5 and CAT5e and replace with CAT6
- Rooms to have 12 available drops plus 2 for wireless except Main Office

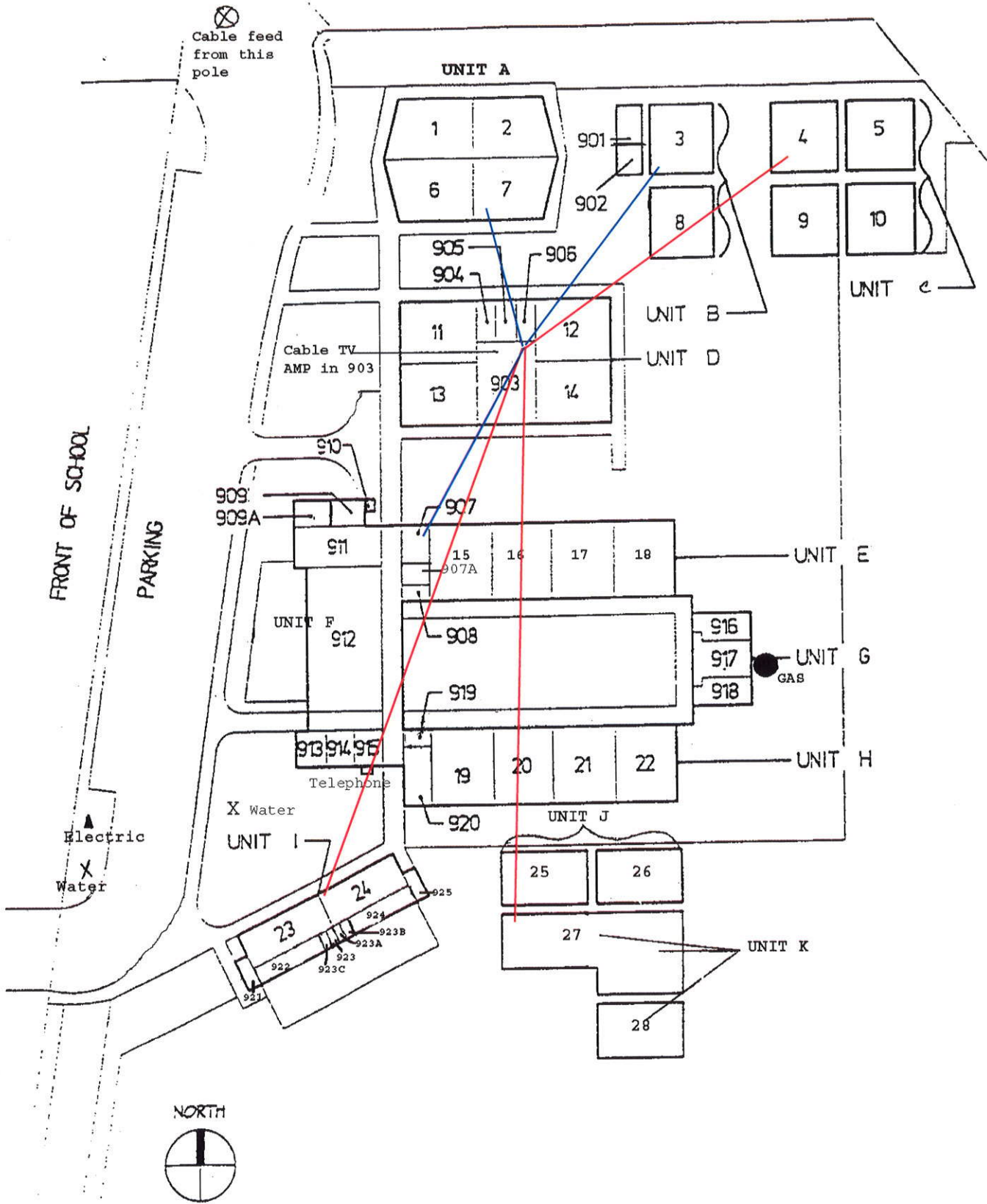

# CHAPMAN ELEMENTARY SCHOOL

Updated 9/2006

# McManus

Room	MDF/IDF Location	Switches	Used/ports	Copper Uplink	Fiber Uplink	New Wireless AP	New Cat 6 Cabling	New Fiber	New Data Cabinet
922	MDF	WS-3550-12G	12/12	6					
922	MDF	(2) WS-C3550-48	73/100		6				
925	LIB						14		
907	MPR	WS-C3550-48	26/50		1	1		upgrade 50u	
912	Office	WS-C3550-48	23/50		1			upgrade 50u	
Hall	Unit C	WS-C3550-48	50/50	1				upgrade 50u	
Hall	Unit C	WS-C3550-24	26/26	1					
20	Lab	(2) WS-C3550-48	91/100		1	1	48	upgrade 50u	
20	Lab	WS-C3550-24	24/26		1				
3A	Class	WS-C3550-48	25/50		1		10	upgrade 50u	
25	Class	WS-C3550-48	41/50		1		48	upgrade 50u	
29	Class	WS-C3550-48	32/50		1	1	14	upgrade 50u	
1						1	14		
2							14		
3							14		
4							14		
5						1	14		
6							14		
7							14		
8						1	14		
9							14		
10							14		
11							14		
12						1	14		
13							14		
14							14		
15							14		
16						1	14		
17							14		
18							14		
19							14		
21							14		
22							14		
23							14		
24						1	14		
26						1	14		
27							14		
28							14		
30							14		
31							14		
Main Office							18		
925						1	12		
909							4		
MPR							6		
904						1	2		
<b>Total</b>							<b>568</b>		

**Notes:**

- All existing fiber upgraded to 50u
- IDF in Hall (Unit C) upgrade existing copper to 50u fiber
- New Wireless AP's get two Cat 6 drops each
- Demo existing CAT 5 and CAT5e and replace with CAT6
- Rooms to have 12 available drops plus 2 for wireless except Main Office

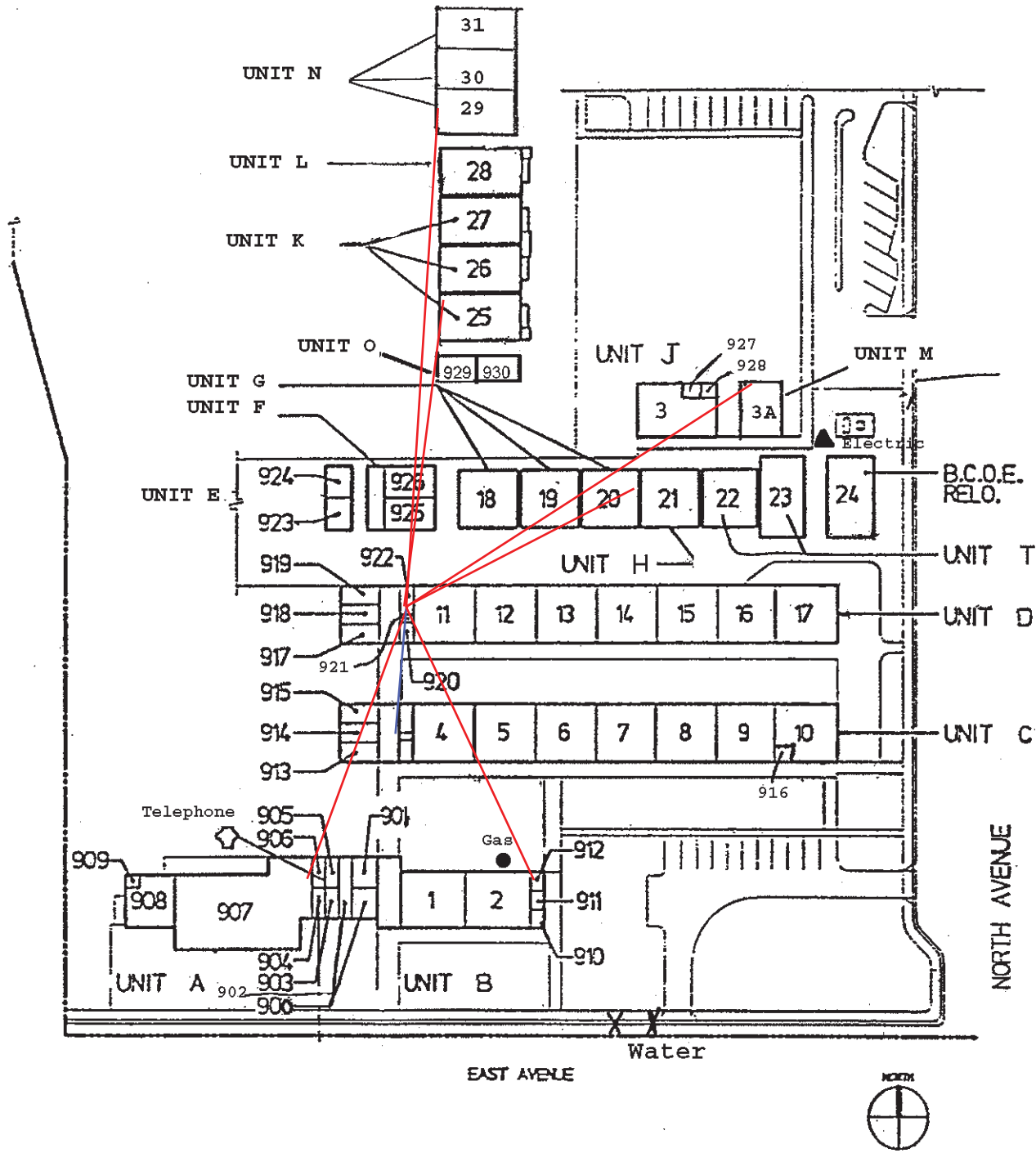

# JOHN McMANUS ELEMENTARY SCHOOL

Updated 9/2006

# Fairview/AFC/CAL

Room	MDF/IDF Location	Switches	Used/ports	Copper Uplink	Fiber Uplink	New Wireless AP	New Cat 6 Cabling	New Fiber	New Data Cabinet
19	IDF	Procurve 2910al	21/26		1	1	14	upgrade to 50u	
12	IDF	Procurve 5406	50/50		1	1	14	upgrade to 50u	
8	IDF	Procurve 5406	17/26		1		14	upgrage to 50u	
10	IDF	Procurve 2910al	40/50	1		1	14	new upgrade to 50u	
4	IDF	Procurve 5406	19/26		1	1	14	upgrade to 50u	
2	IDF	Procurve 2910al	19/50		1	1	14	upgrade to 50u	
911	MPR					1	6		
16	Class room						14		
918	MDF		11/12	5	6		8		
918	MDF		83/100	2					
918	MDF								
909	admin						4		
1							14		
3							14		
5							14		
6						1	14		
7							14		
9							14		
11							14		
13							14		
14							14		
15						1	14		
917							40		
17							14		
18							14		
20							14		
21						1	2		
22							2		
23	IDF	Procurve 5406			1		2		
24						1	2		
25							2		
Shop	IDF	Procurve 2910al			1	1	6		
Total							354		

Notes:

- All existing fiber upgraded to 50u
- New Fiber homerun to Room 10 IDF
- Room 12 and 4 switches are daisy chained via copper
- MDF switch should have module to support 10GIG single mode back to District Office (will need a 10GIG GBIC at FV and DO)



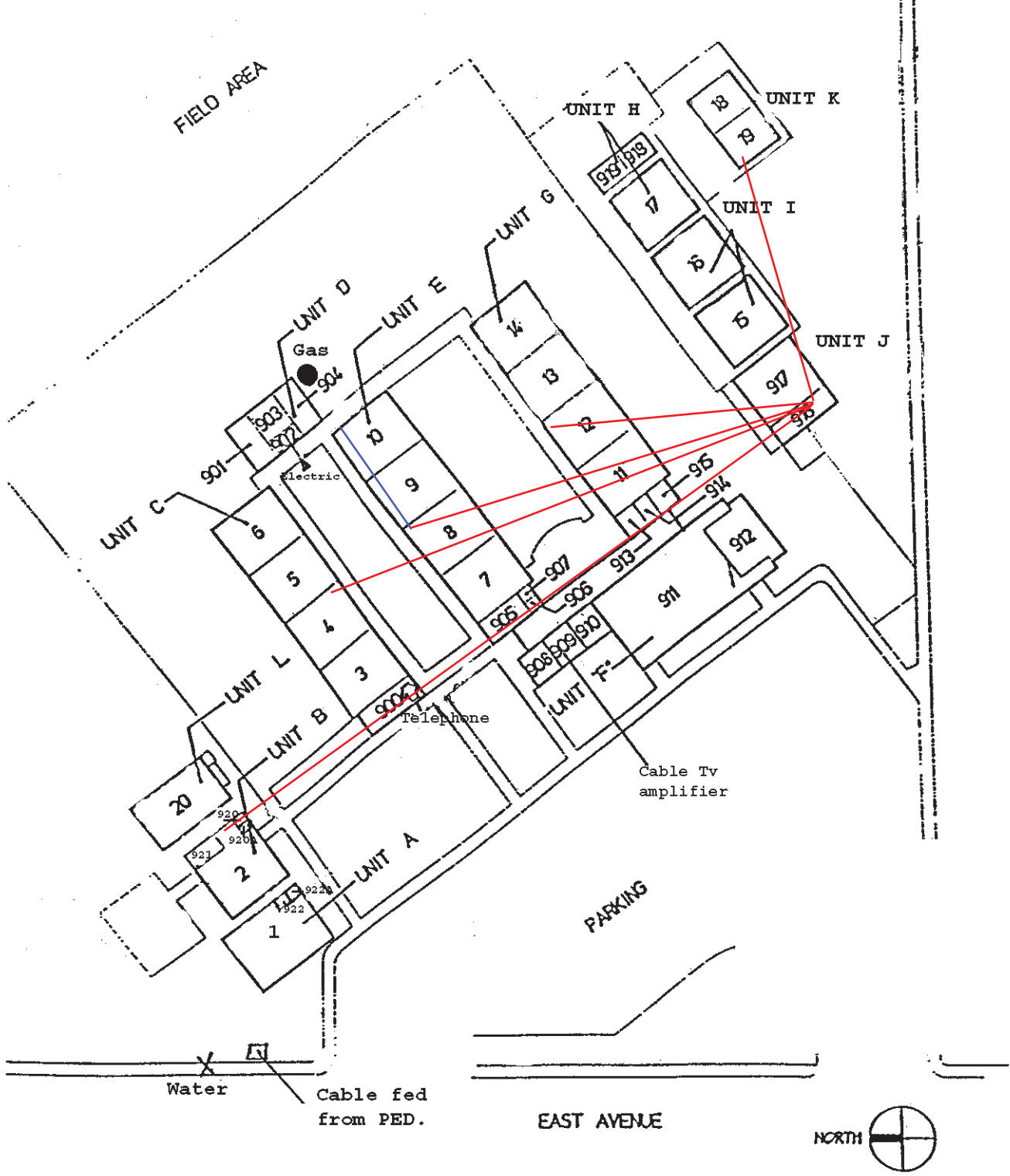

**FAIR VIEW HIGH SCHOOL**  
 (at Jay Partridge site)

Updated 9/2006