

Gas shut off
located in
front of
Sherwin Williams

Water Shut Off
located at
street

Building B

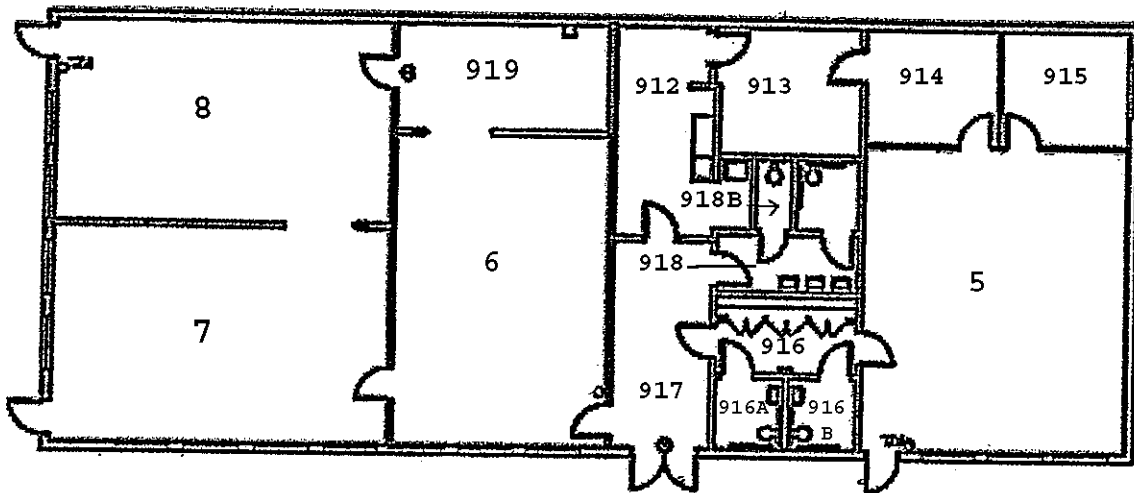

X Water

● Gas

ACADEMY FOR CHANGE

5/06

Leased Facility

Updated 9/2006

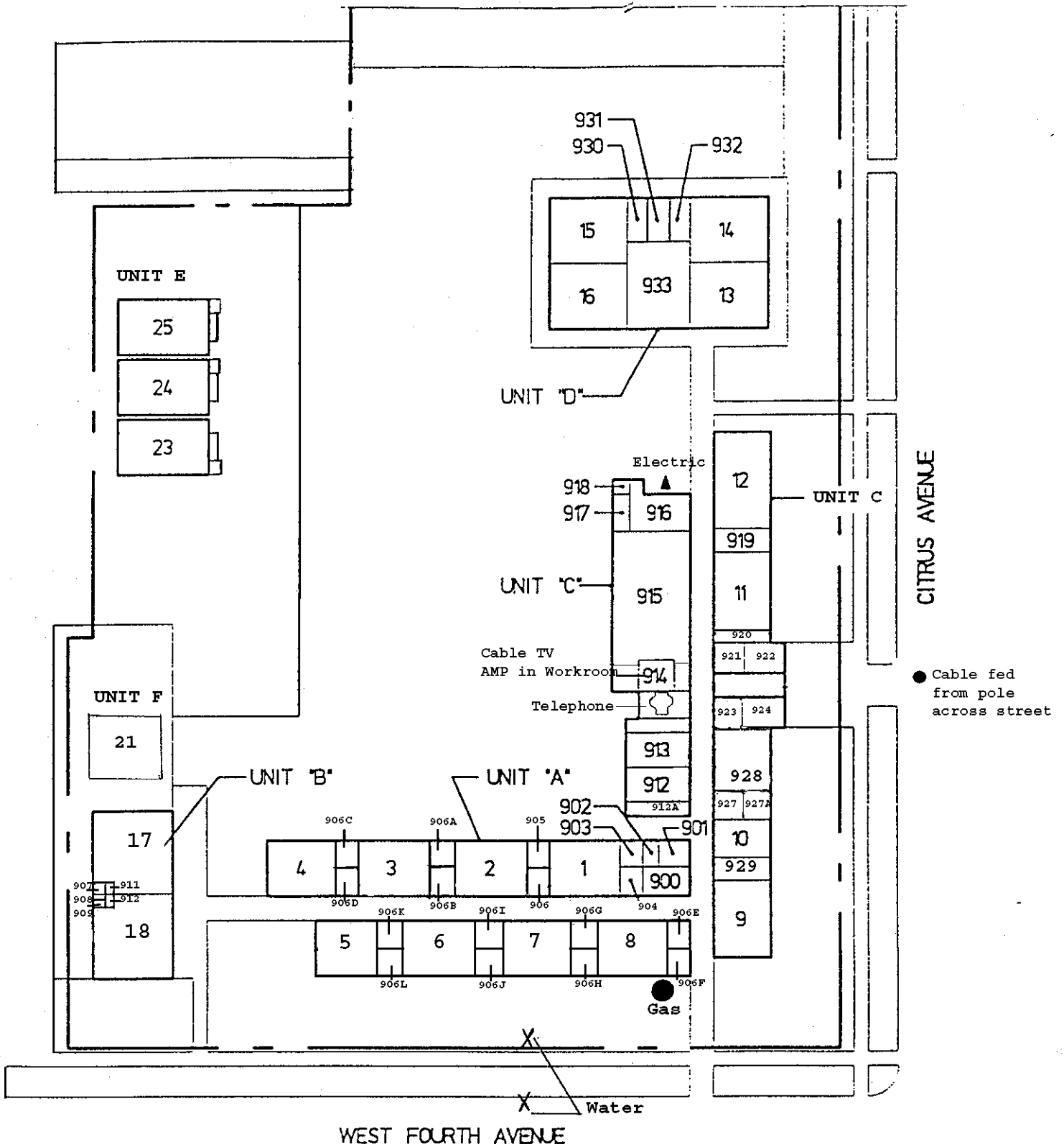

CITRUS ELEMENTARY SCHOOL

Updated 9/2006

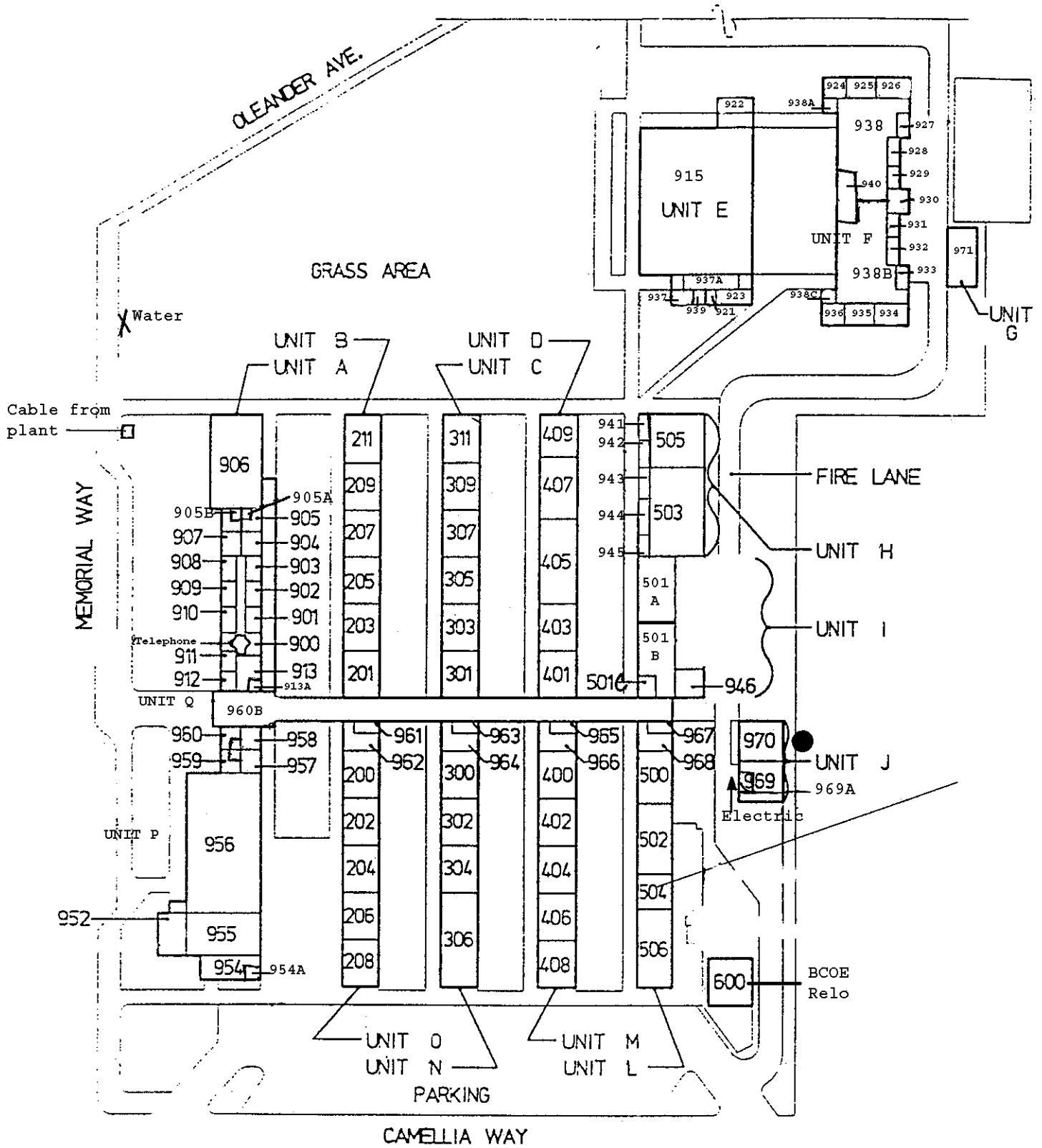

CHICO JR. HIGH SCHOOL

Updated 9/2006

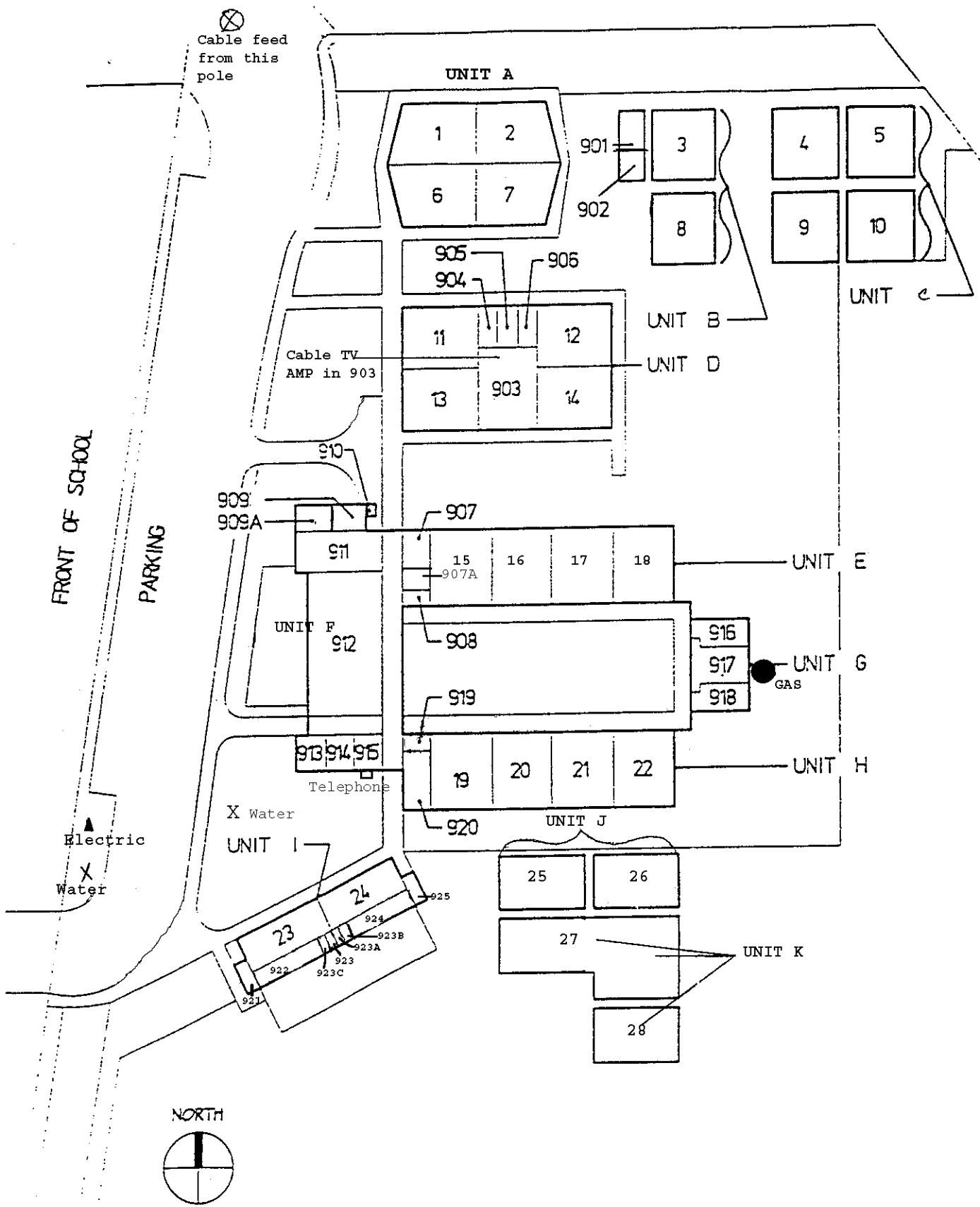

CHAPMAN ELEMENTARY SCHOOL

Updated 9/2006

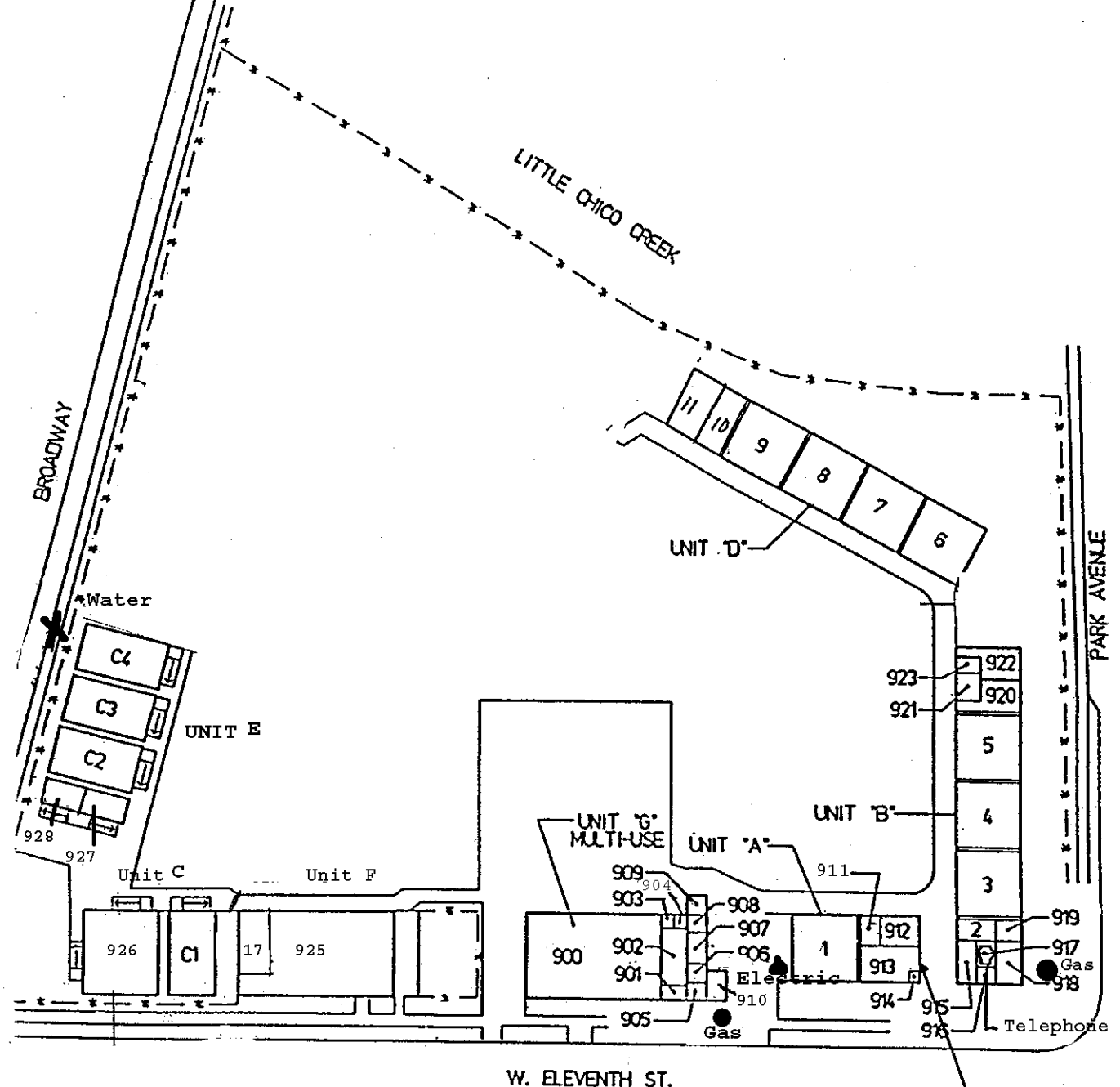

CHICO COUNTRY DAY SCHOOL
 (at old Fair View Site)

Updated 9/2006



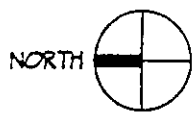
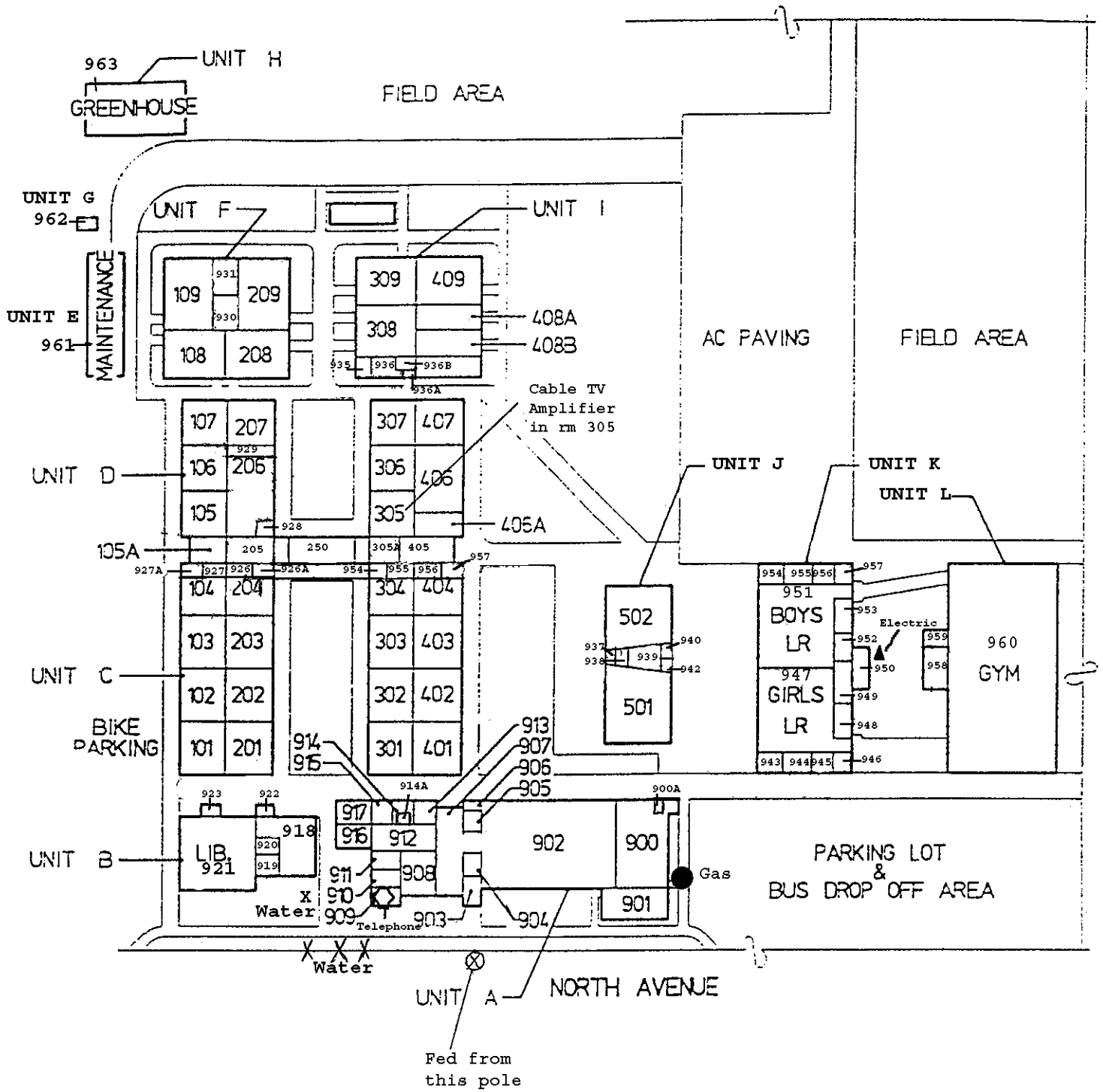

BIDWELL JR. HIGH SCHOOL

Updated 9/2006

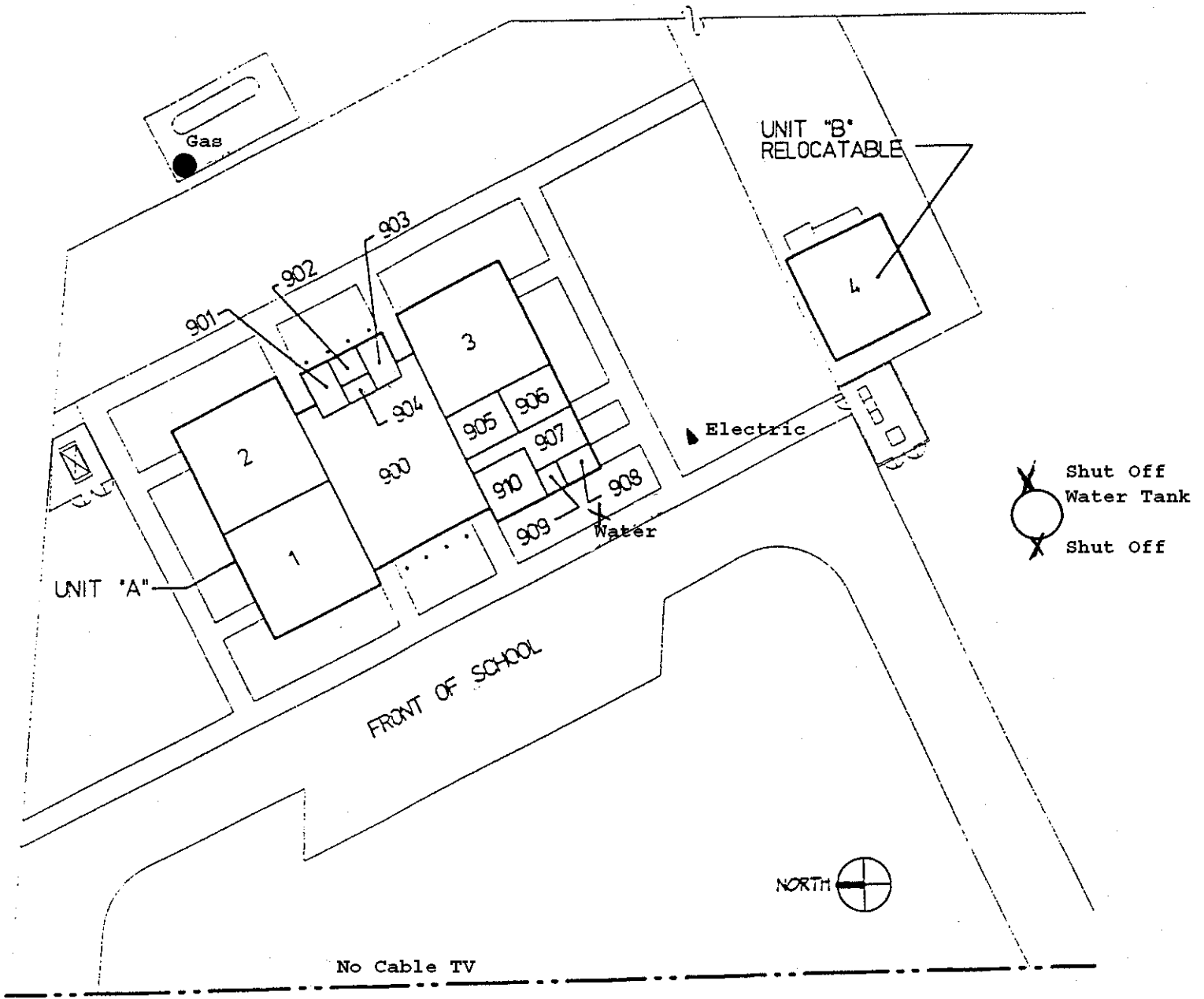

COHASSET ROAD

COHASSET ELEMENTARY SCHOOL

Updated 9/2006

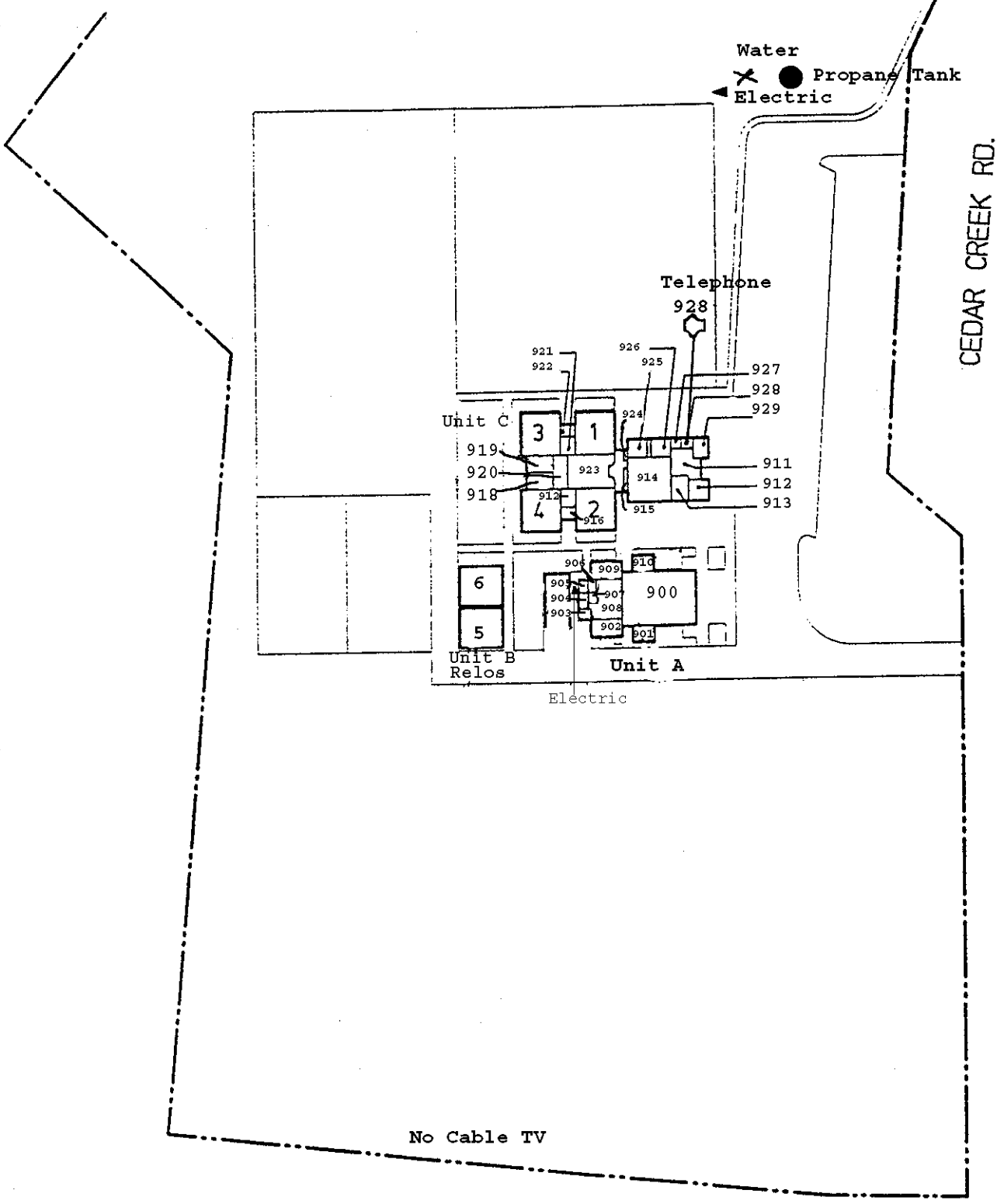

FOREST RANCH ELEMENTARY SCHOOL

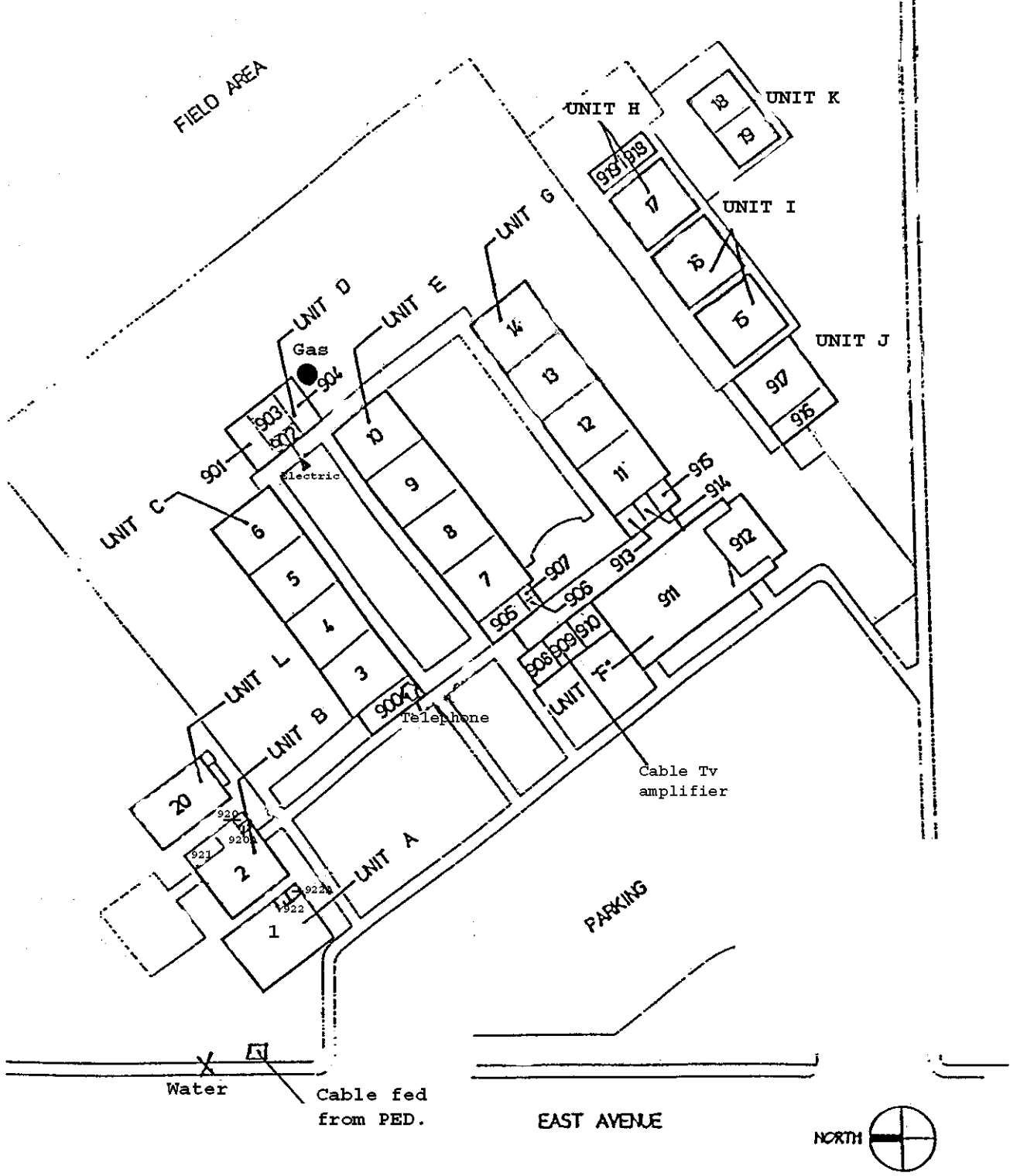

FAIR VIEW HIGH SCHOOL
 (at Jay Partridge site)

Updated 9/2006

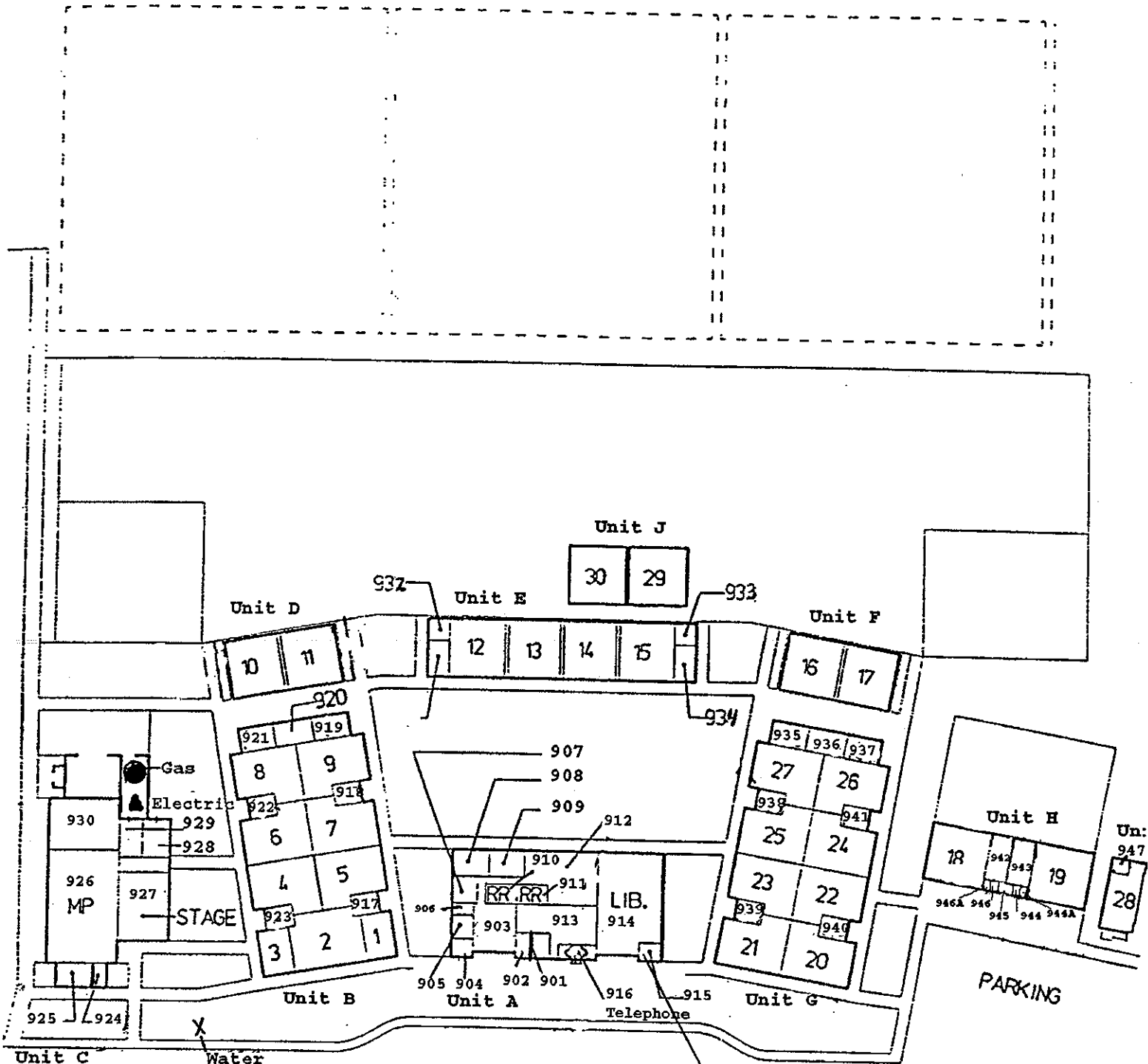

W. 8th AVENUE

Cable TV
 Amp in work room.
 Cable fed underground
 from pole across street.

EMMA WILSON ELEMENTARY SCHOOL

ESPLANADE

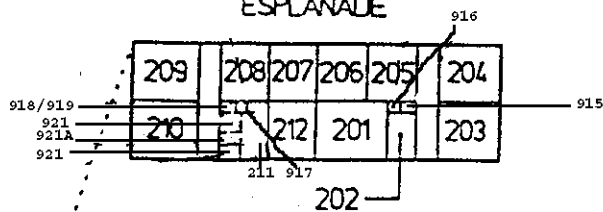

Cable TV
Amp in Custodial closet on 2nd floor-Cable on roof.

UNIT A
1st FLOOR

2nd FLOOR - UNIT A

X Water

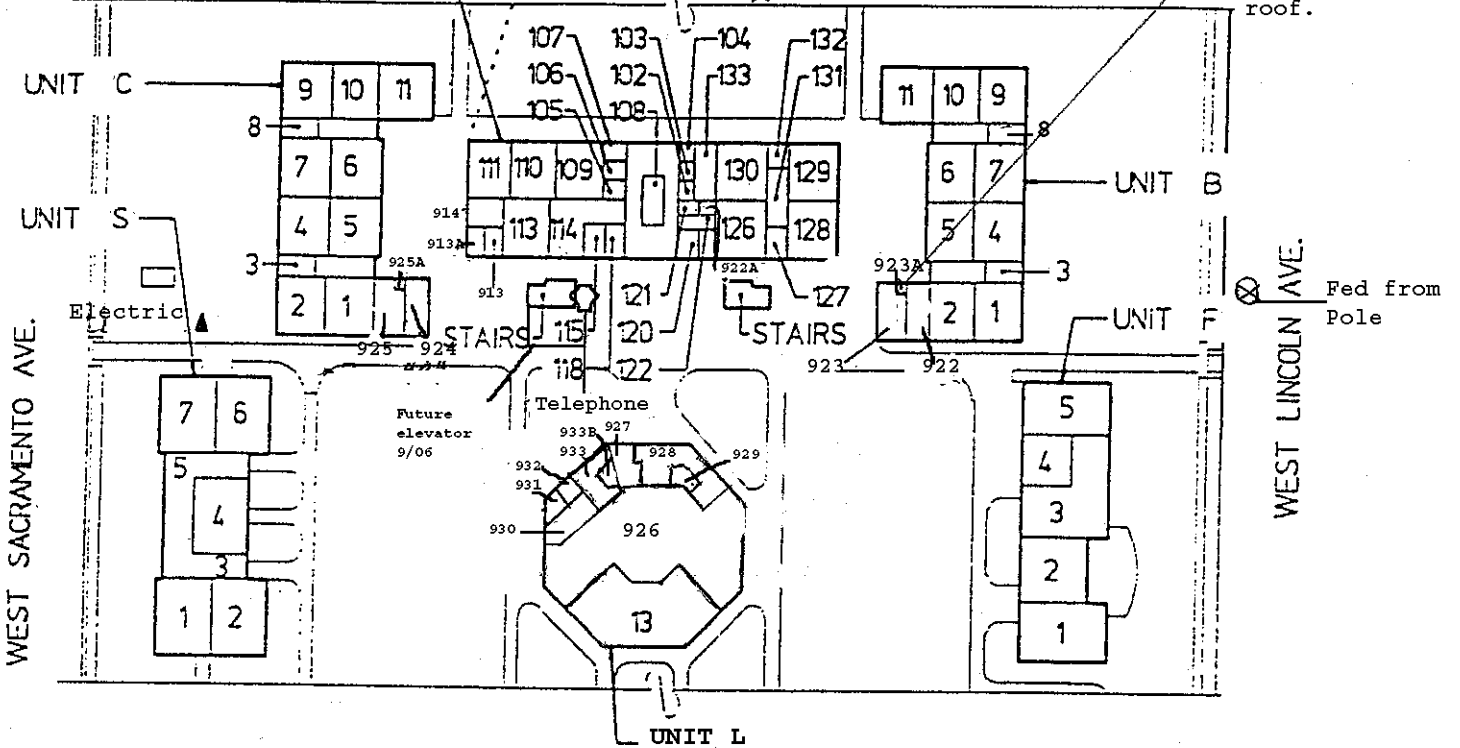

2 OF 2 SHEETS

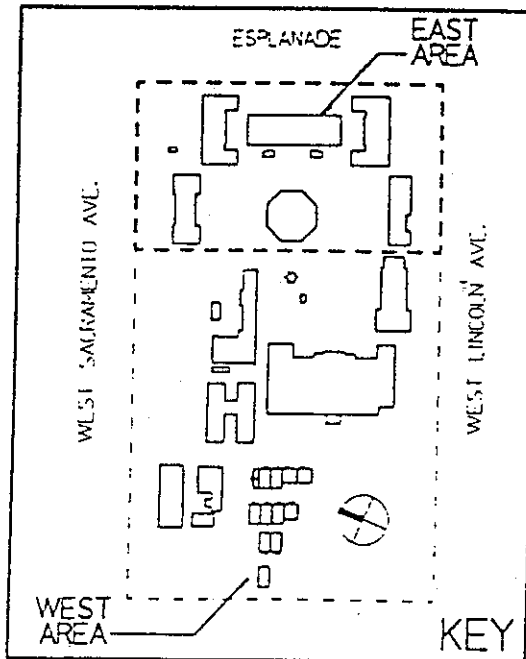

CHICO SR. HIGH SCHOOL - EAST

Updated 9/2006

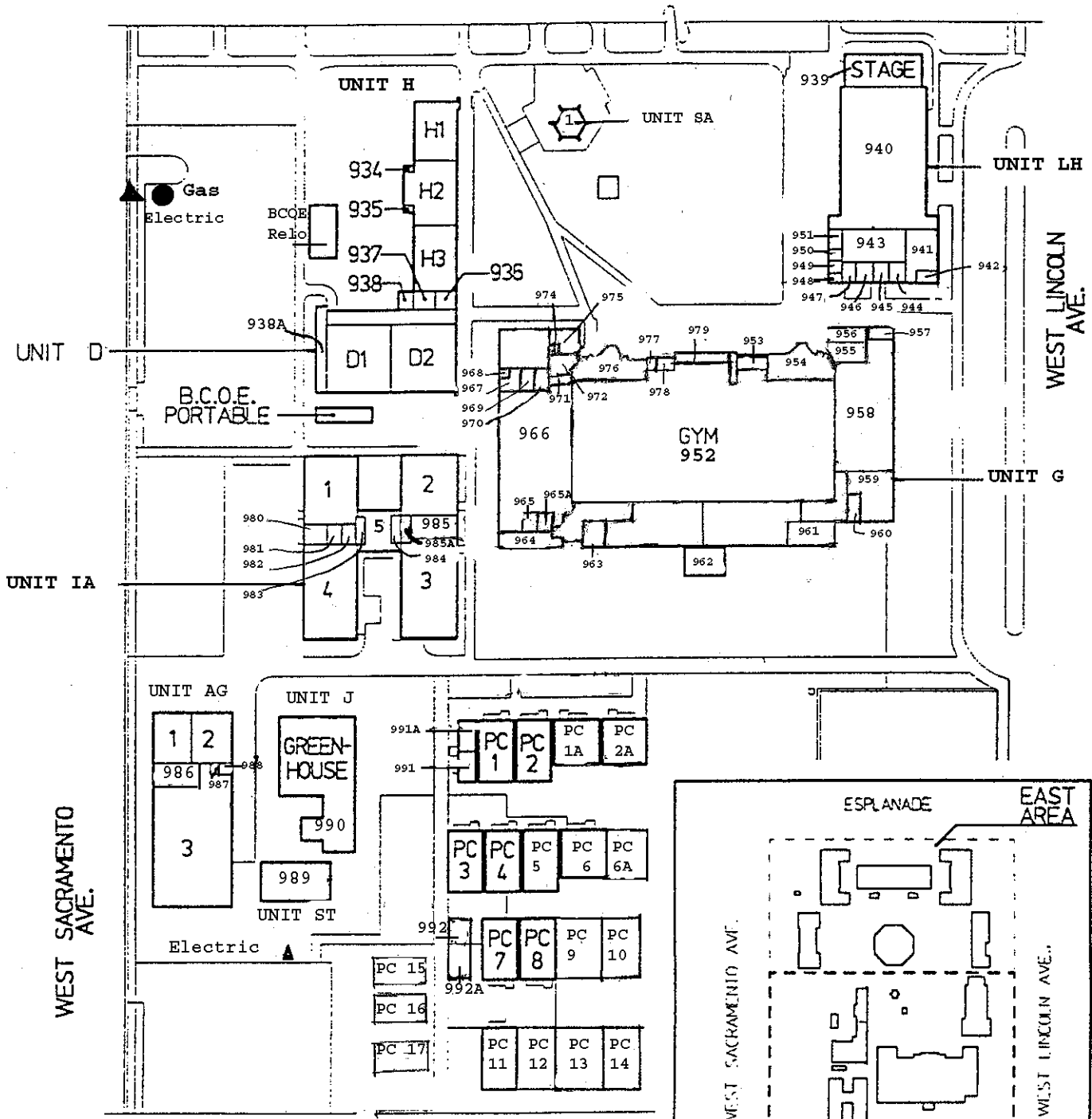

WEST SACRAMENTO AVE.

WEST LINCOLN AVE.

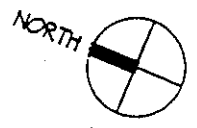

1 OF 2 SHEETS
SEE KEY

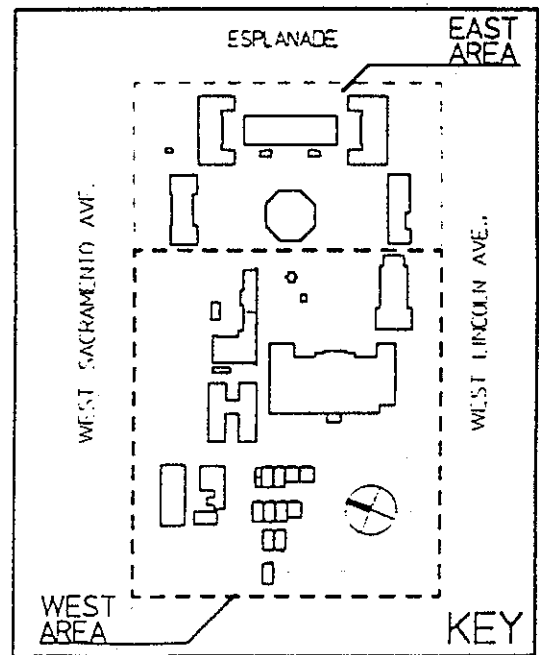

CHICO SR. HIGH SCHOOL - WEST

Updated 9/2006

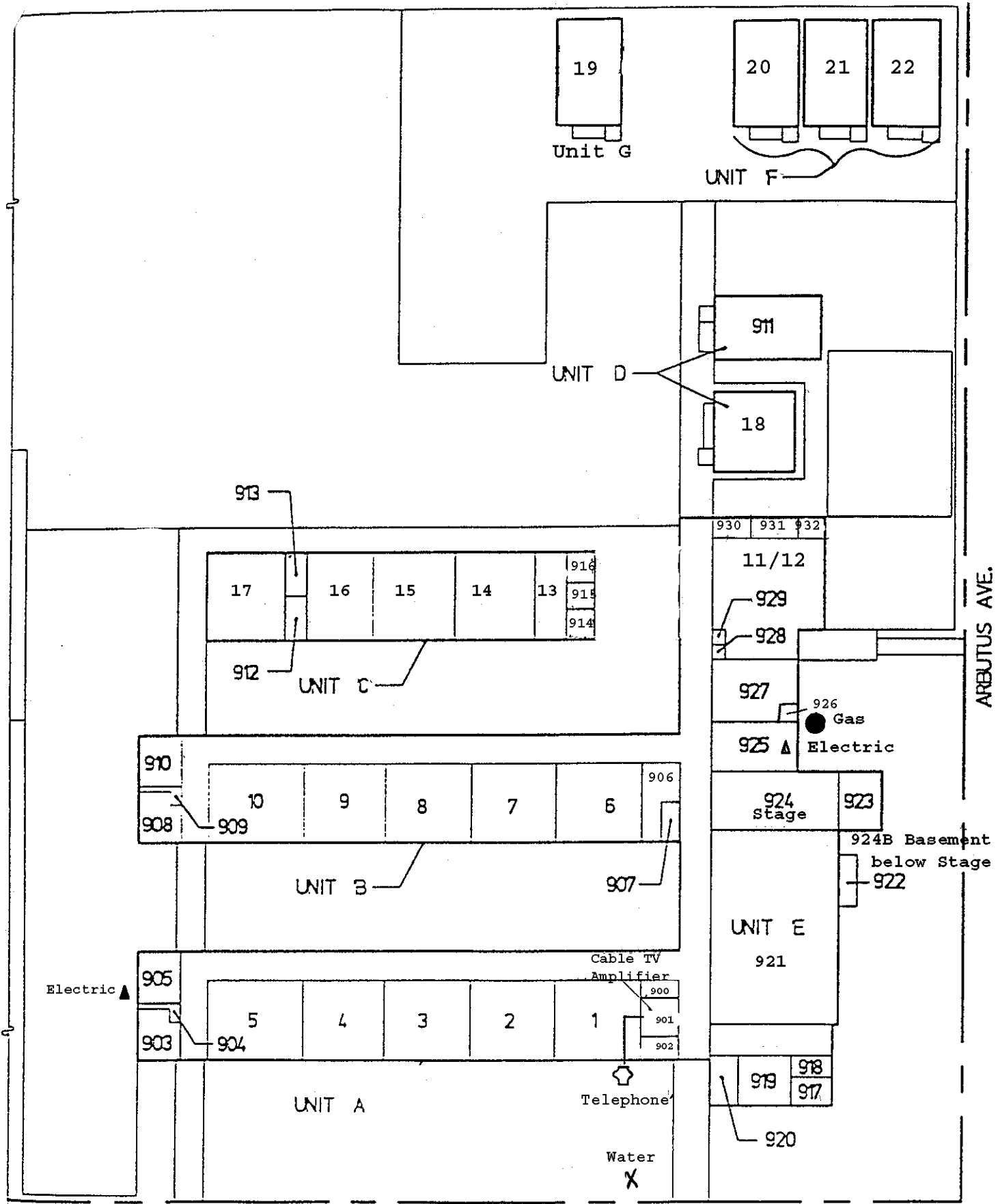

3rd AVE.

ARBUTUS AVE.

HOOKER OAK ELEMENTARY SCHOOL

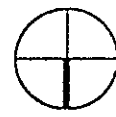

NORTH

⊗ Cable fed from here.

Updated 9/2006

No Cable Feed
into school

NOC 9/30/91

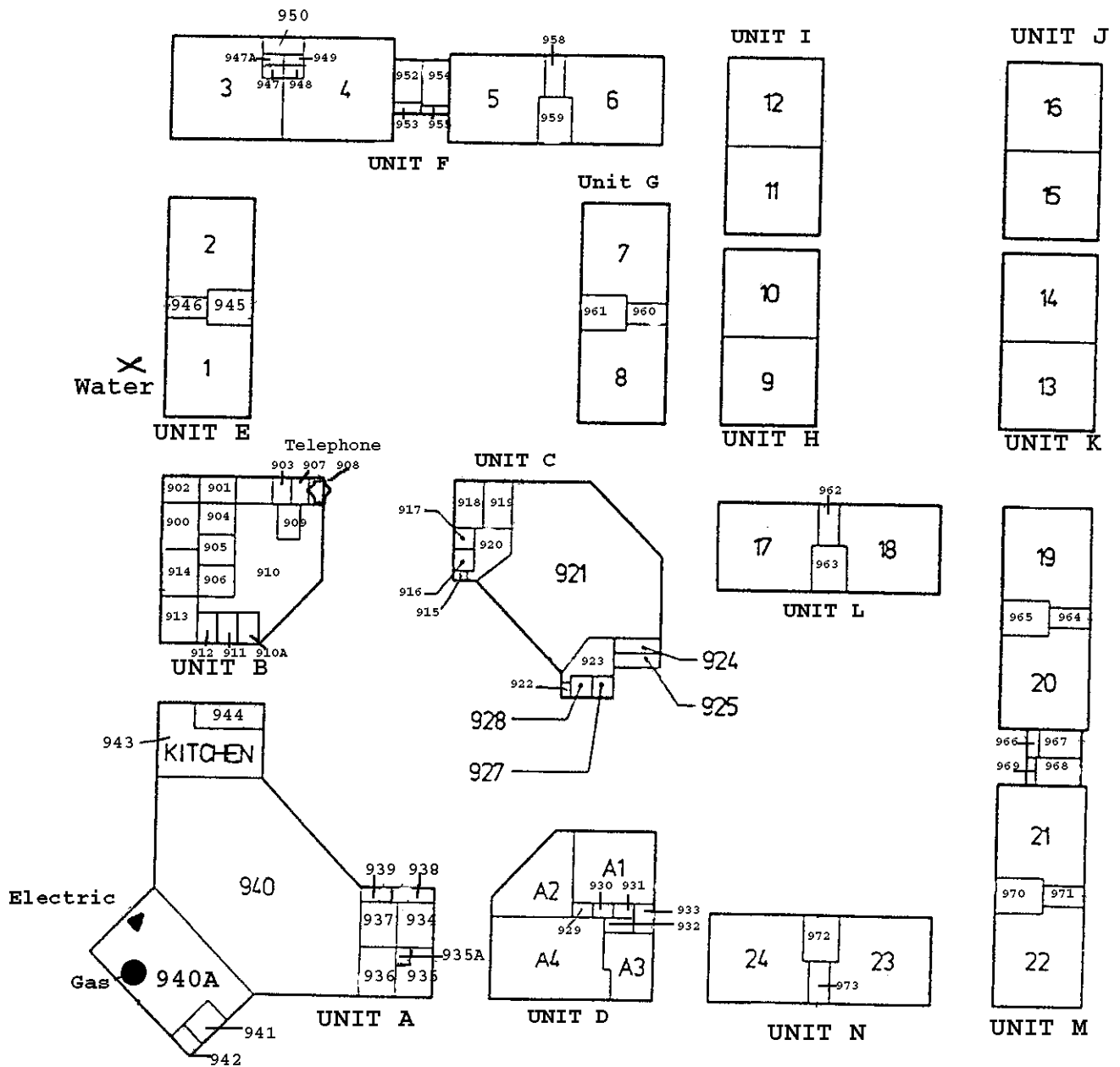

LITTLE CHICO CREEK ELEMENTARY SCHOOL

Updated 9/2006

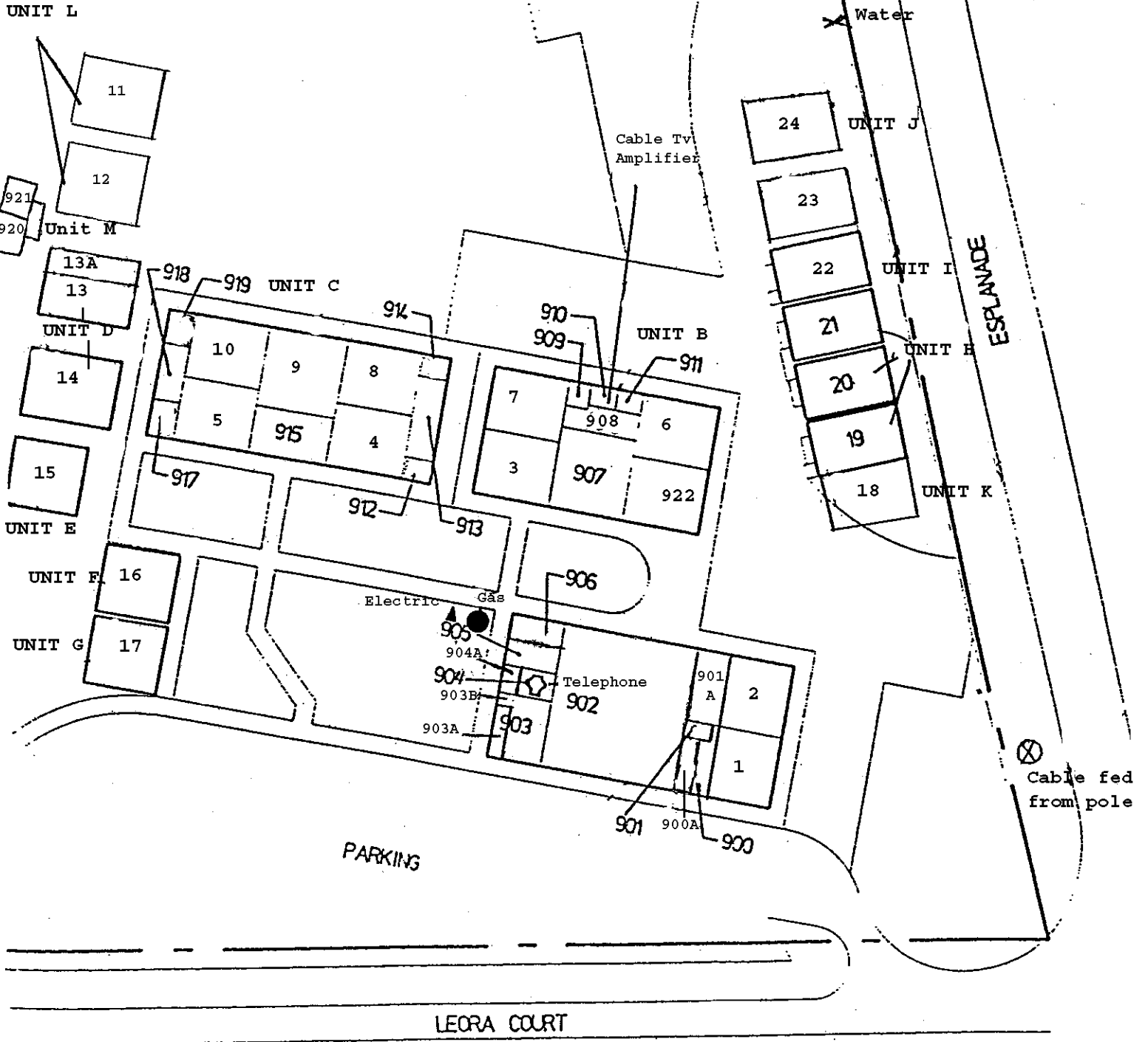

SHASTA ELEMENTARY SCHOOL

Updated 9/2006

UNIT G

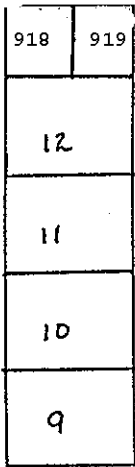

UNIT F

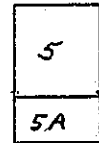
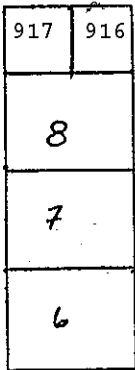

UNIT E

Cable TV Amplifier in closet

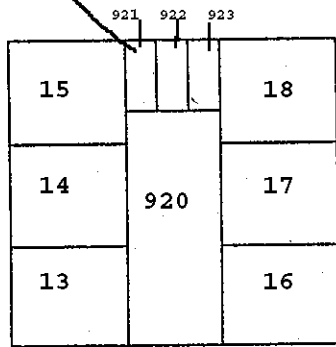

UNIT H

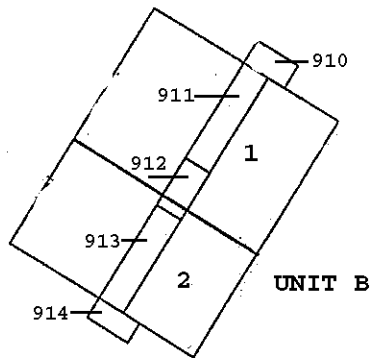

UNIT B

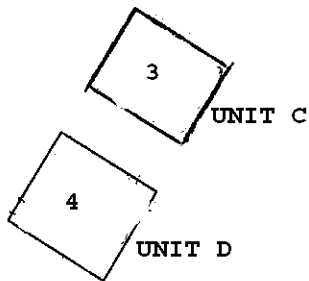

● Gas

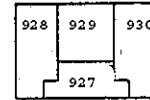

UNIT J

UNIT I

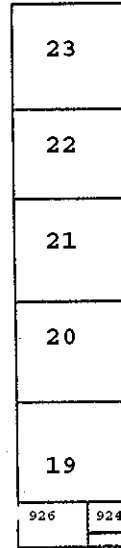

UNIT K

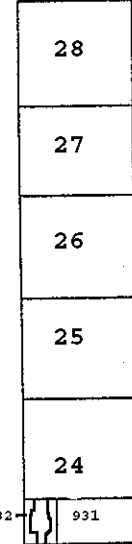

▲ Electric

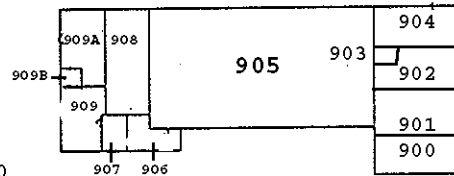

UNIT A

X Water

ROSEDALE ELEMENTARY

Updated 9/2006

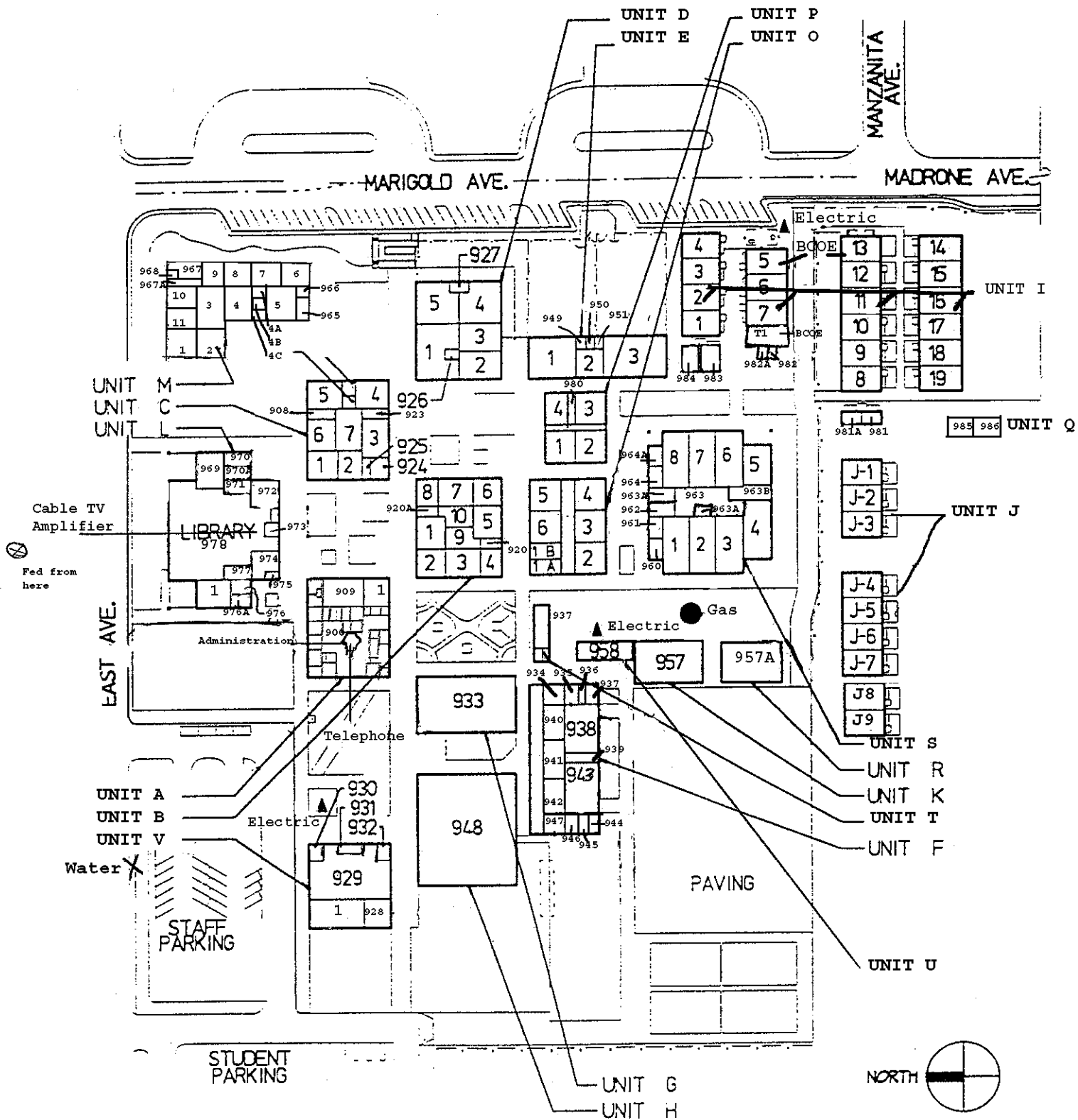

PLEASANT VALLEY HIGH SCHOOL

Updated 9/2006

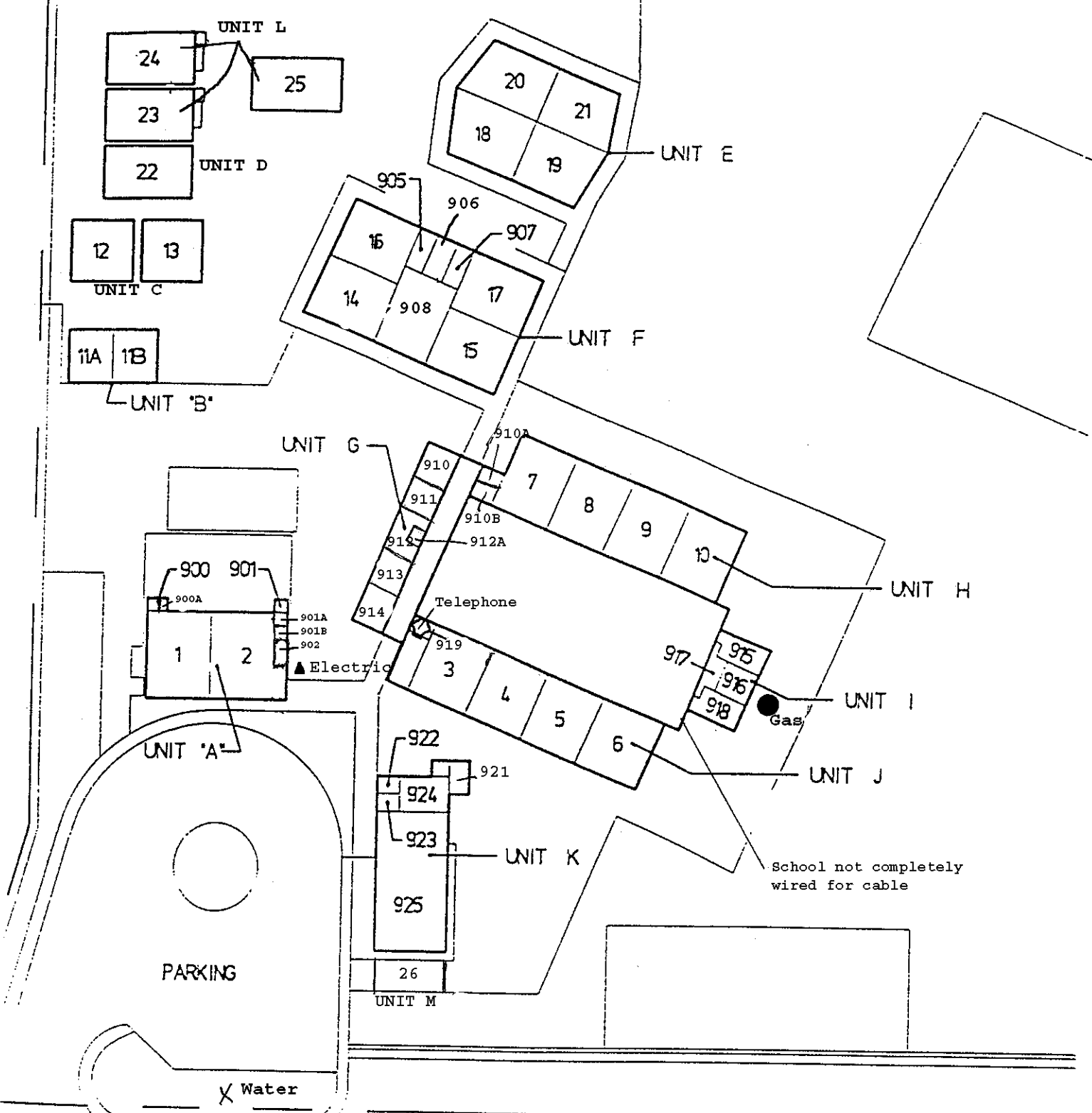

PARKVIEW ELEMENTARY SCHOOL

Updated 9/2006



⊗ Cable fed with one drop

School not completely wired for cable

⊗ Water

Telephone

Gas

▲ Electric

PARKING

UNIT L

UNIT D

UNIT C

UNIT 'B'

UNIT G

UNIT 'A'

UNIT E

UNIT F

UNIT H

UNIT I

UNIT J

UNIT K

UNIT M

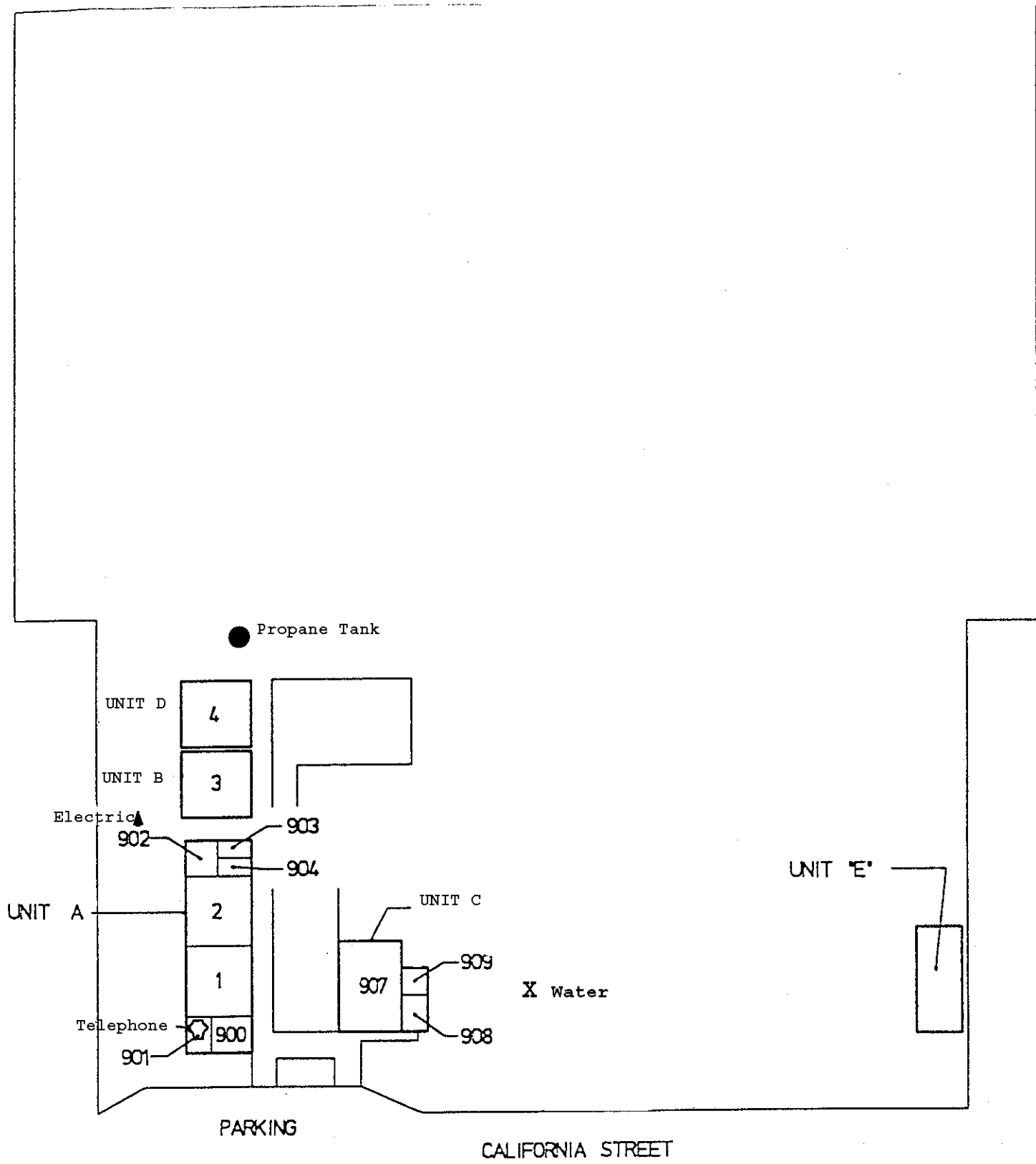

NORD ELEMENTARY SCHOOL

Updated 9/2006



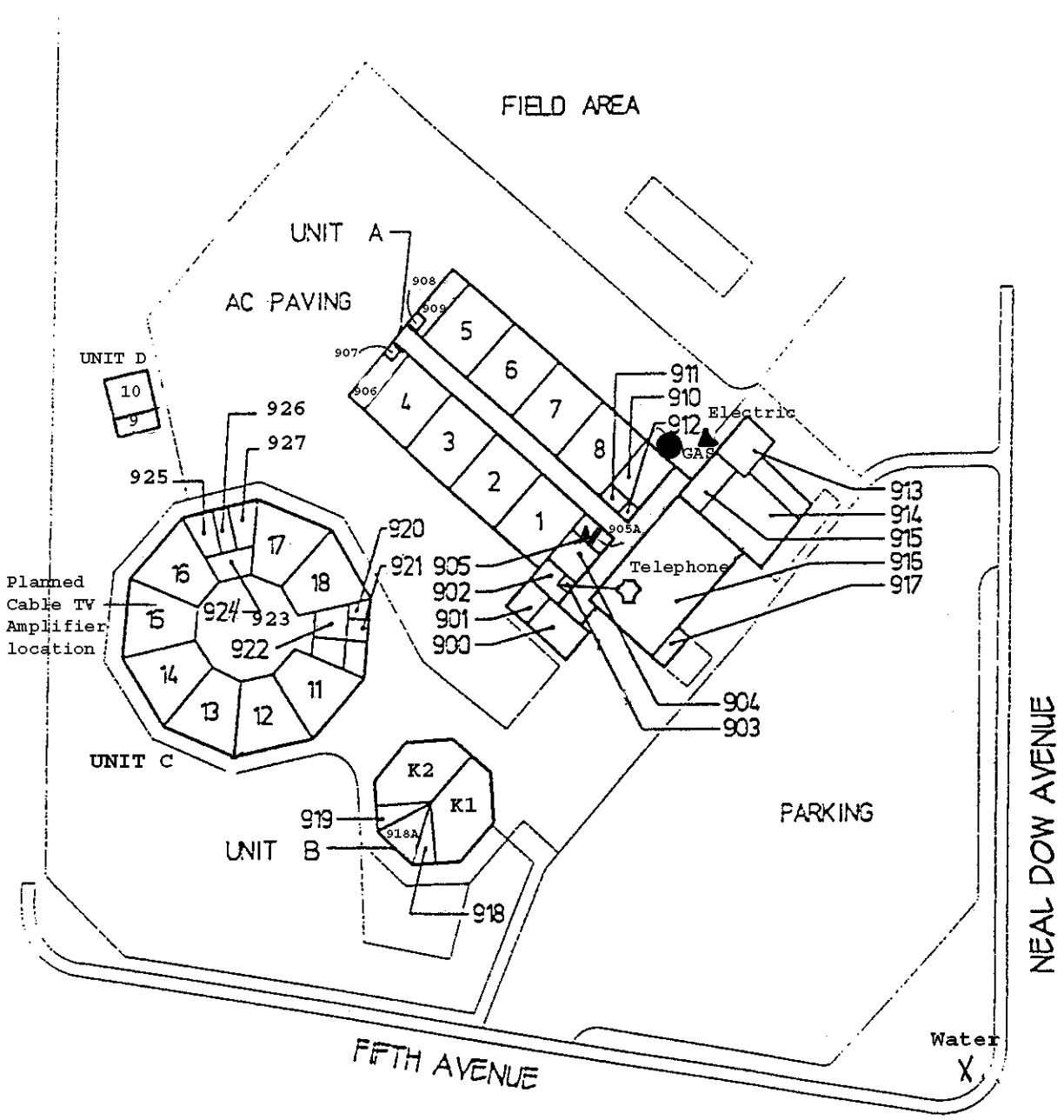

NEAL DOW ELEMENTARY SCHOOL

Updated 9/2006

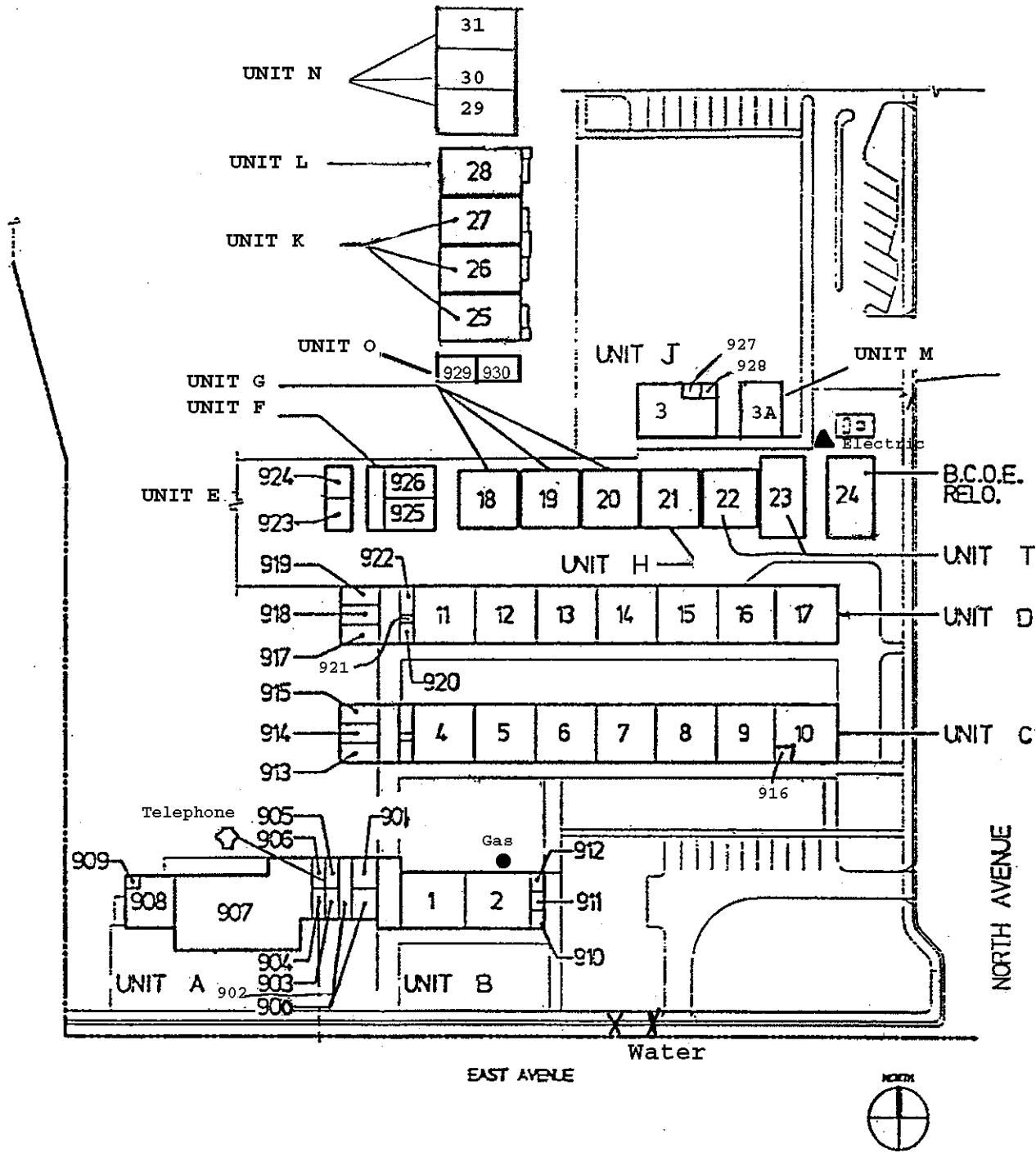

JOHN McMANUS ELEMENTARY SCHOOL

Updated 9/2006

**Marsh Junior High School
2253 Humboldt Road
Chico, CA 95928**

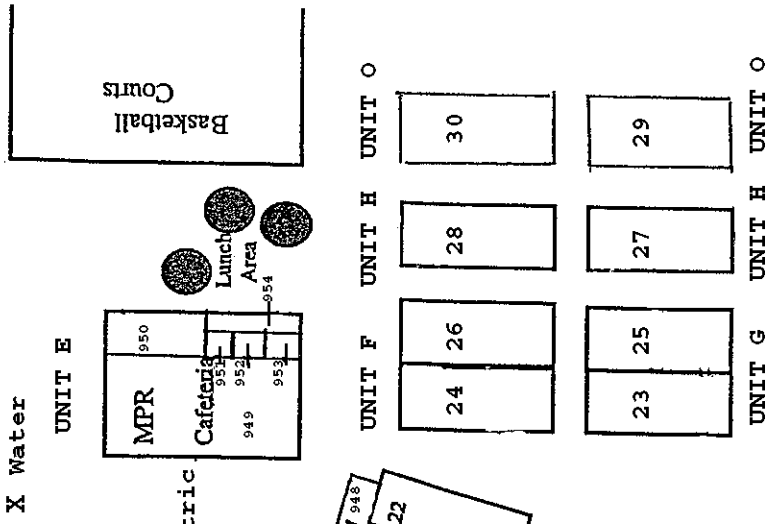

Humboldt Road

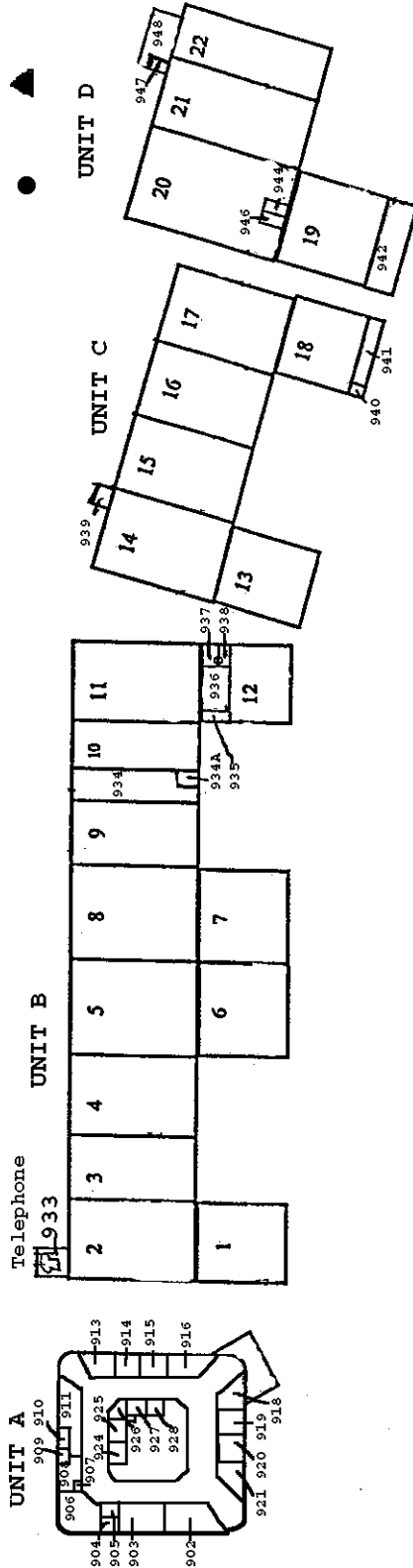

Note Dame Blvd

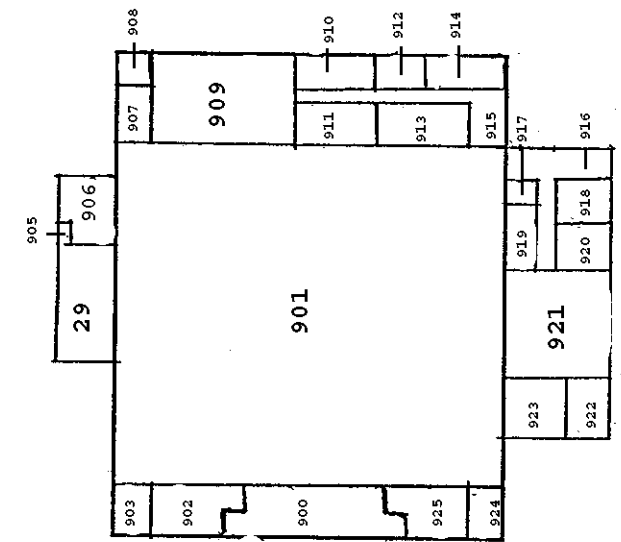

Updated 9/2006

UNIT L NOC 8/22/03

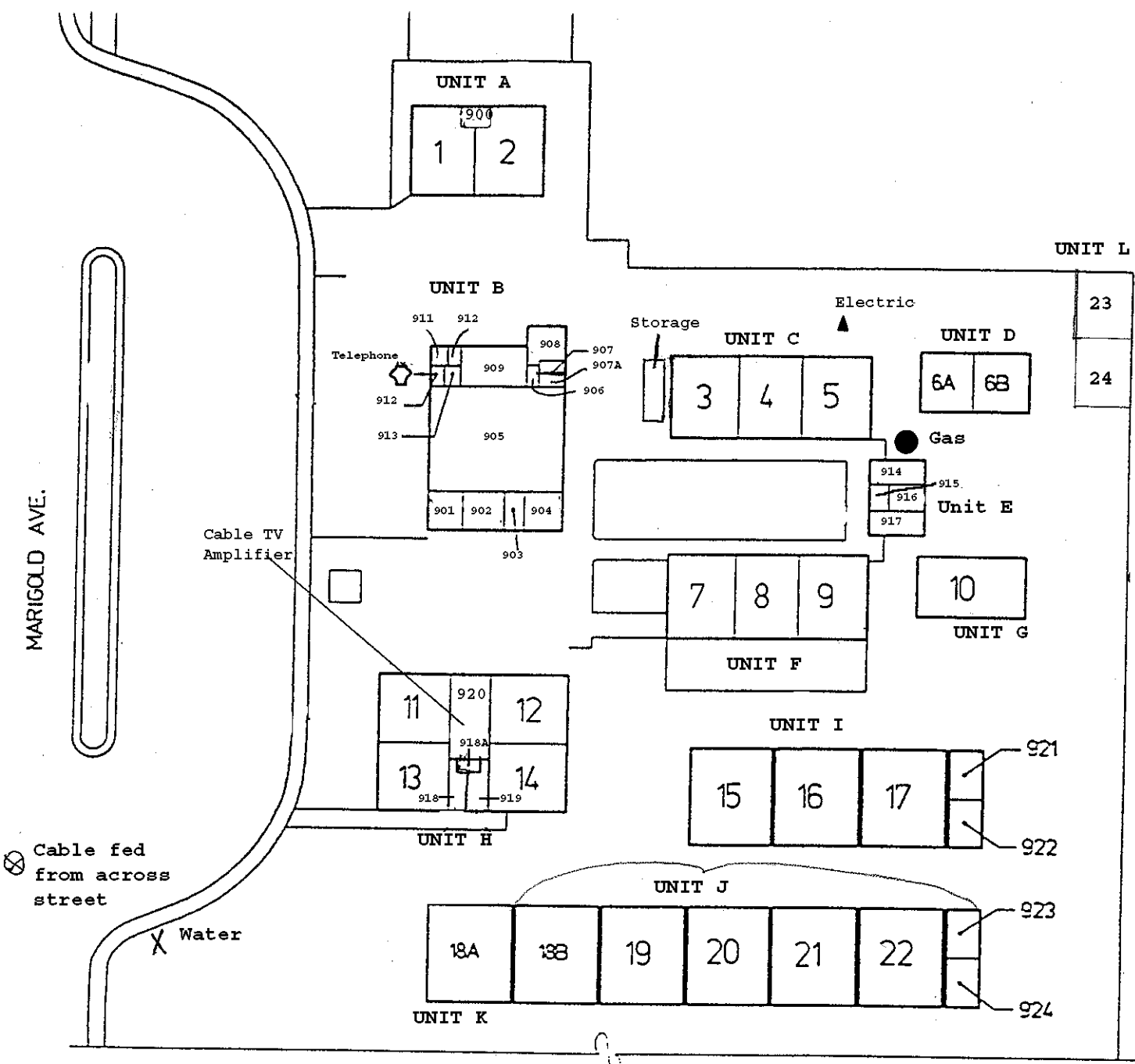

MARIGOLD ELEMENTARY SCHOOL

Updated 9/2006

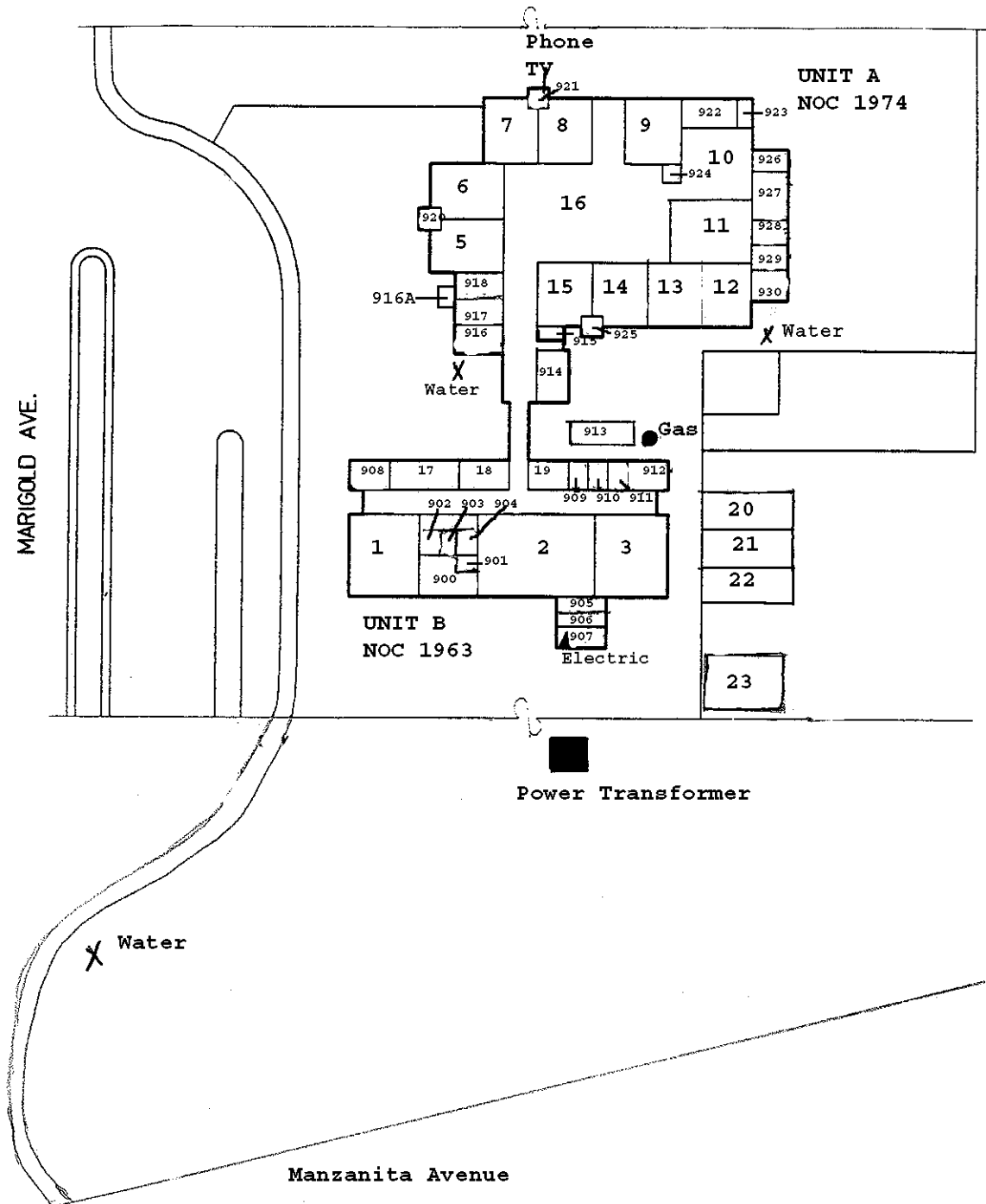

LOMA VISTA SCHOOL

Updated 9/2006

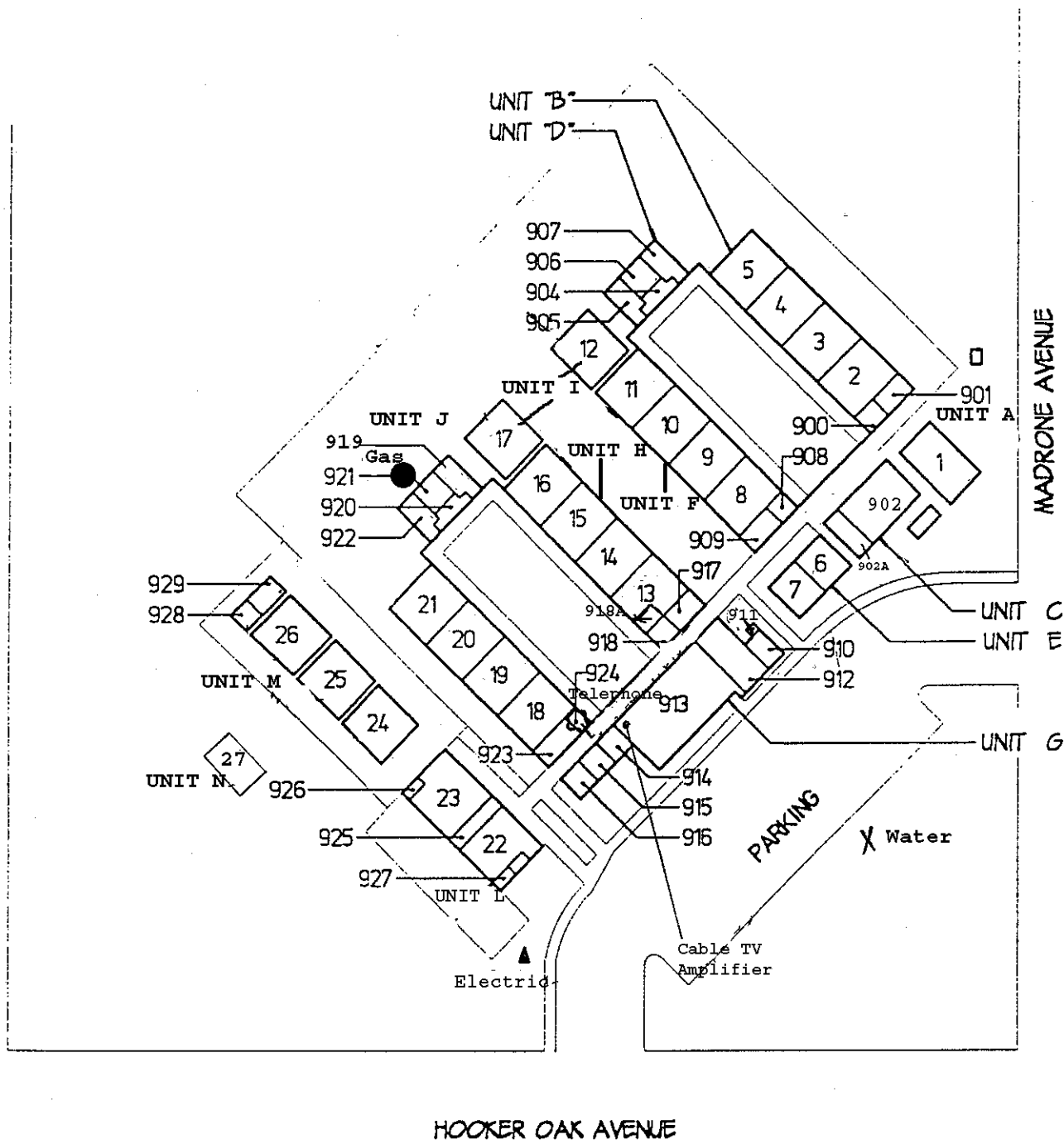

SIERRA VIEW ELEMENTARY SCHOOL

Updated 9/2006